

# Instruction Manual

## PowerLab 10W Wireless Charger with 4ft micro USB Cable

Model No.: 10411PL

### Package Contents:

1. Qi Wireless Charging Pad X 1
2. User Manual X 1

### Optional Accessory:

1. 4ft micro USB Cable

### How to Use:

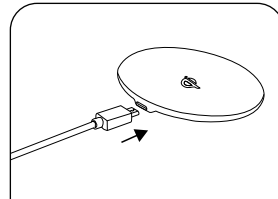

**Step 1:** Plug the cable into the Qi wireless charging pad .

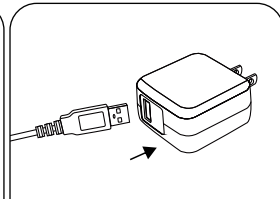

**Step 2:** Plug the USB connector into the USB power adapter.

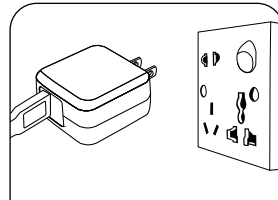

**Step 3:** Plug the AC power adapter into the corresponding power socket

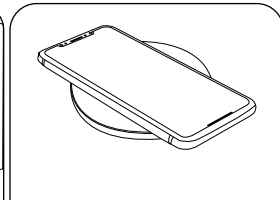

**Step 4:** Simply place the Qi device on top of the pad for wireless charge



Slim Case  
(Within 4mm)



Thickness Is  
Over 4mm  
Eg: Otter Box



Magnetic Pad  
On Phone Back



Metal Ring  
Case



Centrally  
Placed



Crookedly  
Placed



Don't Put Metal Foreign  
Object On The Pad

### LED Indicator:

- **Blue LED light ON:** Wireless charging
- **Blue LED off:** Full Charged
- **Blue LED Flicker:** Low voltage
- **Red LED always ON:** Abnormal working
- **Red LED Flicker:** Detection of foreign body

### Specifications:

#### Fast Charge Qi Wireless Charging Pad

**Input:** 9V 1.75A, 5V/1.65A  
**Charging Mode:** Samsung 10W /  
iPhone 7.5W / Qi 5W  
**Dimensions:**  $\varnothing 90 \times 7$ mm  
**Weight:** 70  $\pm$ 3 g

#### QC3.0 Adapter

**Input:** 100-240V, 50/60Hz, 0.8A  
**Output:** 5V/3A, 9V/2A, 12V/1.5A

### Caution:

1. Please use our standard QC 2.0 / QC3.0 AC adapter for power input , if you used an un-normal AC adapter , it may cause the charging pad work un-property .
2. We strong recommend to use a branded AC adapter while charging.
3. Please do not attempt to disassemble this product, it may result in short-circuit or even damage.
4. The product should be kept in dry and ventilated environment, do not store in an area of high humidity and high temperature.
5. Please do not use organic solvent to clean product surface.

### FCC WARNING

This device complies with part 15 of the FCC Rules. Operation is subject to the following two conditions: (1) this device may not cause harmful interference, and (2) this device must accept any interference received, including interference that may cause undesired operation. Any changes or modifications not expressly approved by the party responsible for compliance could void the user's authority to operate the equipment.

**NOTE:** This equipment has been tested and found to comply with the limits for a Class B digital device, pursuant to Part 15 of the FCC Rules. These limits are designed to provide reasonable protection against harmful interference in a residential installation. This equipment generates, uses and can radiate radio frequency energy and, if not installed and used in accordance with the instructions, may cause harmful interference to radio communications. However, there is no guarantee that interference will not occur in a particular installation. If this equipment does cause harmful interference to radio or television reception, which can be determined by turning the equipment off and on, the user is encouraged to try to correct the interference by one or more of the following measures:

- Reorient or relocate the receiving antenna.
  - Increase the separation between the equipment and receiver.
  - Connect the equipment into an outlet on a circuit different from that to which the receiver is connected.
  - Consult the dealer or an experienced radio/TV technician for help.
- To maintain compliance with FCC's RF Exposure guidelines, This equipment should be installed and operated with minimum distance between 20cm the radiator your body: Use only the supplied antenna.

Size: 400x80mm

材质: 80克书纸

黑色双面印刷