

## DCPS660

### DEWALT POWERSHIFT® 60 kg Rammer

FR  
SP

Fig. A

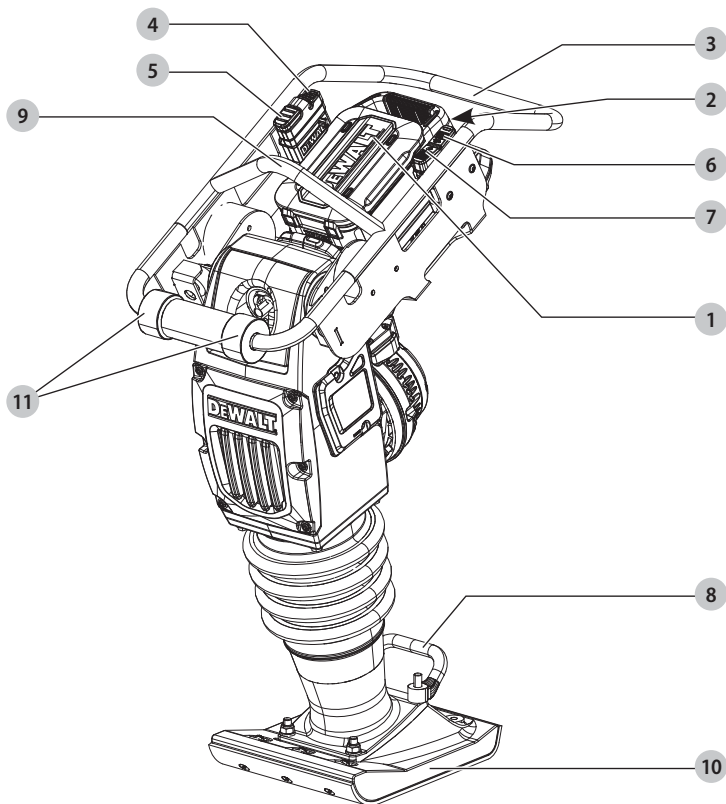

- 1 Battery
- 2 Battery release
- 3 Guide bar
- 4 Dual action switch
- 5 Stop button
- 6 Low speed
- 7 High speed
- 8 Transportation handle
- 9 Designated lifting point
- 10 Padfoot
- 11 Rollers

If you have questions or comments, contact us.  
Pour toute question ou tout commentaire, nous contacter.  
Si tiene dudas o comentarios, contáctenos.

[www.DEWALT.com](http://www.DEWALT.com)  
1-800-4-DEWALT

 **WARNING: Read all safety warnings, instructions, illustrations, and specifications in this manual, including the battery and charger sections provided in an original tool manual or the separate Batteries and Chargers manual.**

Manuals can be obtained by contacting Customer Service as described elsewhere in this manual. Failure to follow the warnings and instructions may result in electric shock, fire and/or serious injury.

## Definitions: Safety Alert Symbols and Words

This instruction manual uses the following safety alert symbols and words to alert you to hazardous situations and your risk of personal injury or property damage.

 **DANGER:** Indicates an imminently hazardous situation which, if not avoided, **will** result in **death or serious injury**.

 **WARNING:** Indicates a potentially hazardous situation which, if not avoided, **could** result in **death or serious injury**.

 **CAUTION:** Indicates a potentially hazardous situation which, if not avoided, **may** result in **minor or moderate injury**.

 (Used without word) Indicates a safety related message.

**NOTICE:** Indicates a practice not related to personal injury which, if not avoided, **may** result in **property damage**.

 **AVERTISSEMENT : lire tous les avertissements de sécurité, les instructions, les illustrations et les caractéristiques de ce manuel, y compris les sections sur les piles et les chargeurs fournies dans un manuel d'origine de l'outil ou dans le manuel séparé sur les piles et les chargeurs.** Les manuels peuvent être obtenus en contactant le service à la clientèle comme indiqué ailleurs dans ce manuel. Le fait de ne pas suivre les avertissements et les instructions peut entraîner un choc électrique, un incendie et/ou des blessures graves.

## Définitions : symboles et termes d'alarmes sécurité

Ces guides d'utilisation utilisent les symboles et termes d'alarmes sécurité suivants pour vous prévenir de situations dangereuses et de risques de dommages corporels ou matériels.

 **DANGER :** indique une situation dangereuse imminente qui, si elle n'est pas évitée, **entraînera la mort ou des blessures graves**.

 **AVERTISSEMENT :** indique une situation potentiellement dangereuse qui, si elle n'est pas évitée, **pourrait entraîner la mort ou des blessures graves**.

 **ATTENTION :** indique une situation potentiellement dangereuse qui, si elle n'est pas évitée, **pourrait** entraîner des **blessures légères ou modérées**.

 (Si utilisé sans aucun terme) Indique un message propre à la sécurité.

**AVIS :** indique une pratique ne posant **aucun risque de dommages corporels** mais qui par contre, si rien n'est fait pour l'éviter, **pourrait** poser des **risques de dommages matériels**.

 **ADVERTENCIA: Lea todas las advertencias de seguridad, instrucciones, ilustraciones y especificaciones de este manual, incluyendo las secciones sobre la batería y el cargador proporcionadas en un manual original de la herramienta o en el manual de Baterías y Cargadores por separado.** Los manuales se pueden obtener poniéndose en contacto con el Servicio de atención al cliente como se describe en otra parte de este manual. La falla en seguir las advertencias e instrucciones puede resultar en descarga eléctrica, incendio y/o lesiones serias.

## Definiciones: Símbolos y Palabras de Alerta de Seguridad

Este manual de instrucciones utiliza los siguientes símbolos y palabras de alerta de seguridad para alertarle de situaciones peligrosas y del riesgo de lesiones corporales o daños materiales.

 **PELIGRO:** Indica una situación de peligro imminente que, si no se evita, **provocará la muerte o lesiones graves**.

 **ADVERTENCIA:** Indica una situación de peligro potencial que, si no se evita, **podría** provocar **la muerte o lesiones graves**.

 **ATENCIÓN:** Indica una situación de peligro potencial que, si no se evita, **posiblemente** provocaría **lesiones leves o moderadas**.

 (Utilizado sin palabras) indica un mensaje de seguridad relacionado.

**AVISO:** Se refiere a una práctica **no relacionada a lesiones corporales** que de no evitarse **puede** resultar en **daños a la propiedad**.

---

English (**original instructions**)

4

---

Français (*traduction de la notice d'instructions originale*)

18

---

Español (*traducido de las instrucciones originales*)

32

---

Fig. B

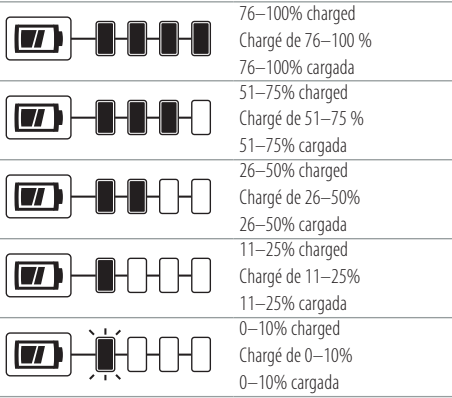

Fig. C

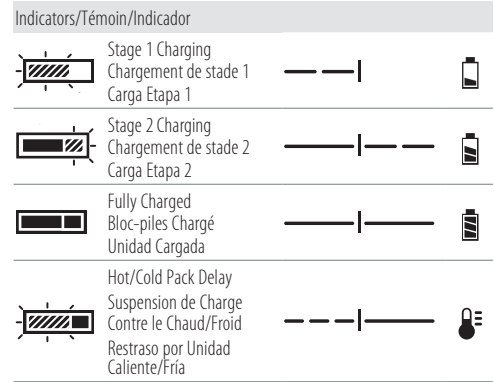

Fig. D

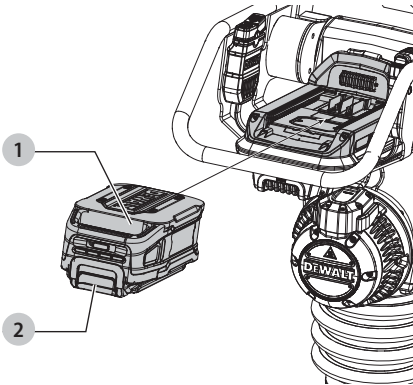

Fig. E

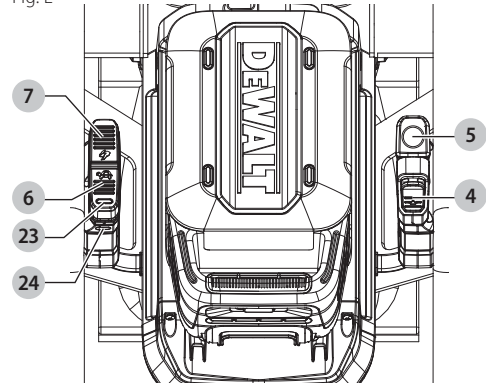

Fig. F

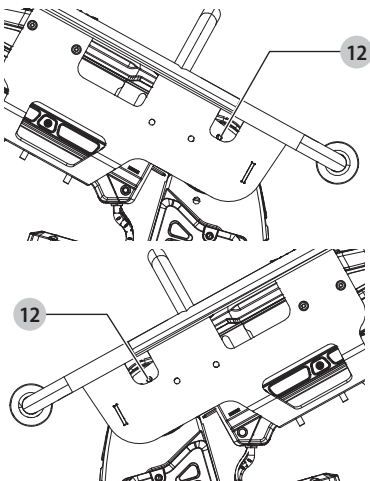

Fig. G

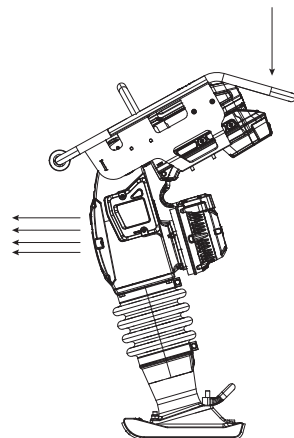

Fig. H

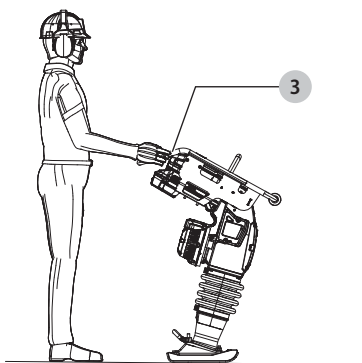

Fig. I

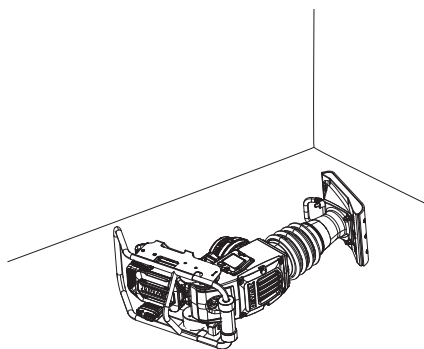

Fig. J

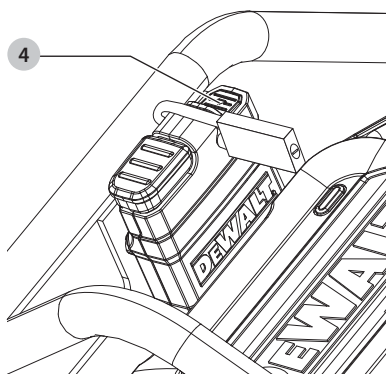

Fig. K

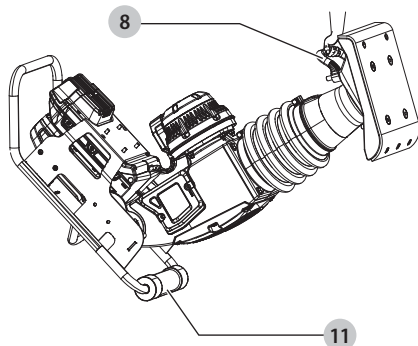

Fig. L

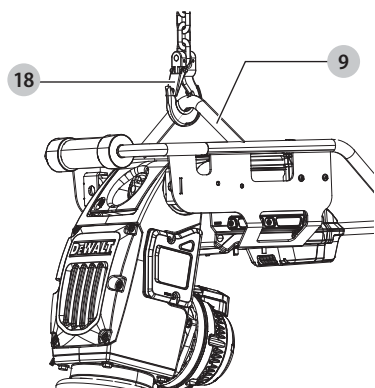

Fig. M

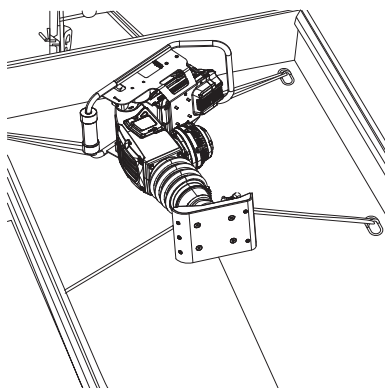

Fig. N

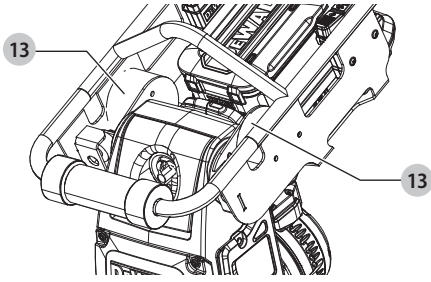

Fig. O

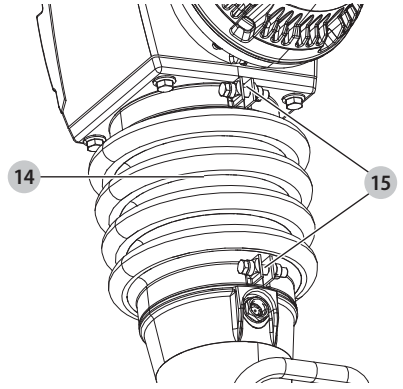

Fig. P

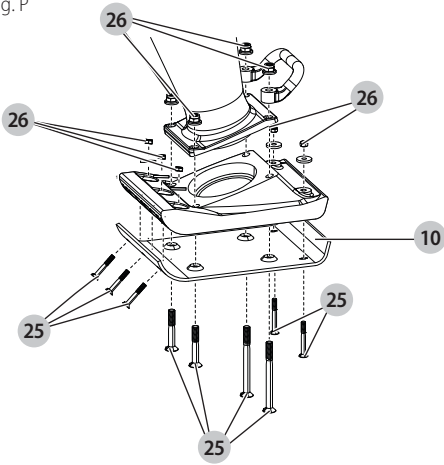

Fig. Q

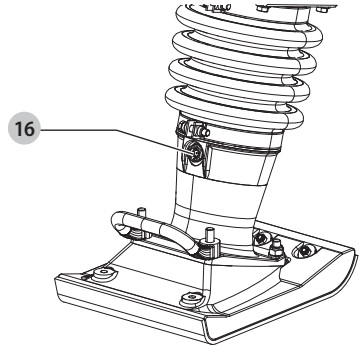
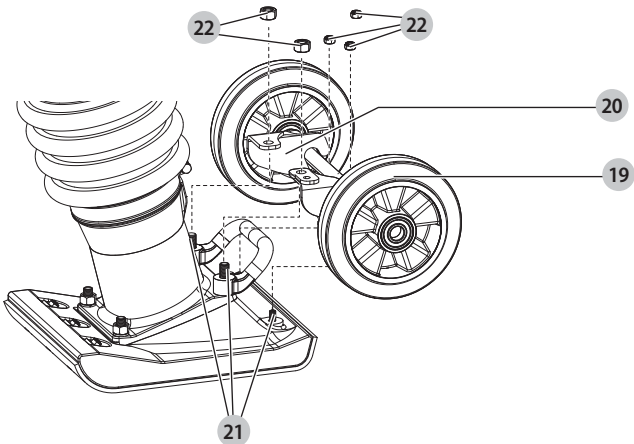

Fig. R



## Intended Use

The DCPS660 DEWALT POWERSHIFT® 60 kg Rammer is designed for the light compaction of sand, gravel, mixed soil, cohesive soil, and humid soil. Application examples include compaction in a confined area, asphalt & paving applications, pipeline, plumbing, and electrical trenchwork, landscaping, light to medium patch work, and other forms of earthwork.

Use caution on sloping embankments! Slipping hazard from rolling material and slick surfaces.

Do not work on concrete or hardened surfaces.

**DO NOT** use under wet conditions or in the presence of flammable liquids or gases.

**DO NOT** let children come into contact with the tool.

Supervision is required when inexperienced operators use this tool.

## GENERAL POWER TOOL SAFETY WARNINGS

**▲ WARNING:** Read all safety warnings, instructions, illustrations and specifications provided with this power tool. Failure to follow all instructions listed below may result in electric shock, fire and/or serious injury.

### SAVE ALL WARNINGS AND INSTRUCTIONS FOR FUTURE REFERENCE.

The term "power tool" in the warnings refers to your mains-operated (corded) power tool or battery-operated (cordless) power tool.

#### 1) Work Area Safety

- a) **Keep work area clean and well lit.** Cluttered or dark areas invite accidents.
- b) **Do not operate power tools in explosive atmospheres, such as in the presence of flammable liquids, gases or dust.** Power tools create sparks which may ignite the dust or fumes.
- c) **Keep children and bystanders away while operating a power tool.** Distractions can cause you to lose control.

#### 2) Electrical Safety

- a) **Power tool plugs must match the outlet. Never modify the plug in any way. Do not use any adapter plugs with earthed (grounded) power tools.** Unmodified plugs and matching outlets will reduce risk of electric shock.
- b) **Avoid body contact with earthed or grounded surfaces, such as pipes, radiators, ranges and refrigerators.** There is an increased risk of electric shock if your body is earthed or grounded.
- c) **Do not expose power tools to rain or wet conditions.** Water entering a power tool will increase the risk of electric shock.
- d) **Do not abuse the cord. Never use the cord for carrying, pulling or unplugging the power tool. Keep cord away from heat, oil, sharp edges or moving parts.** Damaged or entangled cords increase the risk of electric shock.
- e) **When operating a power tool outdoors, use an extension cord suitable for outdoor use.** Use of a cord suitable for outdoor use reduces the risk of electric shock.
- f) **If operating a power tool in a damp location is unavoidable, use a ground fault circuit interrupter (GFCI) protected supply.** Use of a GFCI reduces the risk of electric shock.

#### 3) Personal Safety

- a) **Stay alert, watch what you are doing and use common sense when operating a power tool. Do not**

**use a power tool while you are tired or under the influence of drugs, alcohol or medication.** A moment of inattention while operating power tools may result in serious personal injury.

- b) **Use personal protective equipment. Always wear eye protection.** Protective equipment such as a dust mask, non-skid safety shoes, hard hat, or hearing protection used for appropriate conditions will reduce personal injuries.
  - c) **Prevent unintentional starting. Ensure the switch is in the off position before connecting to power source and/or battery pack, picking up or carrying the tool.** Carrying power tools with your finger on the switch or energizing power tools that have the switch on invites accidents.
  - d) **Remove any adjusting key or wrench before turning the power tool on.** A wrench or a key left attached to a rotating part of the power tool may result in personal injury.
  - e) **Do not overreach. Keep proper footing and balance at all times.** This enables better control of the power tool in unexpected situations.
  - f) **Dress properly. Do not wear loose clothing or jewelry. Keep your hair, clothing and gloves away from moving parts.** Loose clothes, jewelry or long hair can be caught in moving parts.
  - g) **If devices are provided for the connection of dust extraction and collection facilities, ensure these are connected and properly used.** Use of dust collection can reduce dust-related hazards.
  - h) **Do not let familiarity gained from frequent use of tools allow you to become complacent and ignore tool safety principles.** A careless action can cause severe injury within a fraction of a second.
- #### 4) Power Tool Use and Care
- a) **Do not force the power tool. Use the correct power tool for your application.** The correct power tool will do the job better and safer at the rate for which it was designed.
  - b) **Do not use the power tool if the switch does not turn it on and off.** Any power tool that cannot be controlled with the switch is dangerous and must be repaired.
  - c) **Disconnect the plug from the power source and/or remove the battery pack, if detachable, from the power tool before making any adjustments, changing accessories, or storing power tools.** Such preventive safety measures reduce the risk of starting the power tool accidentally.
  - d) **Store idle power tools out of the reach of children and do not allow persons unfamiliar with the power tool or these instructions to operate the power tool.** Power tools are dangerous in the hands of untrained users.
  - e) **Maintain power tools and accessories. Check for misalignment or binding of moving parts, breakage of parts and any other condition that may affect the power tool's operation. If damaged, have the power tool repaired before use.** Many accidents are caused by poorly maintained power tools.
  - f) **Keep cutting tools sharp and clean.** Properly maintained cutting tools with sharp cutting edges are less likely to bind and are easier to control.
  - g) **Use the power tool, accessories and tool bits, etc. in accordance with these instructions, taking into account the working conditions and the work to be performed.**

Use of the power tool for operations different from those intended could result in a hazardous situation.

h) **Keep handles and grasping surfaces dry, clean and free from oil and grease.** Slippery handles and grasping surfaces do not allow for safe handling and control of the tool in unexpected situations.

## 5) Battery Tool Use and Care

a) **Recharge only with the charger specified by the manufacturer.** A charger that is suitable for one type of battery pack may create a risk of fire when used with another battery pack.

b) **Use power tools only with specifically designated battery packs.** Use of any other battery packs may create a risk of injury and fire.

c) **When battery pack is not in use, keep it away from other metal objects, like paper clips, coins, keys, nails, screws or other small metal objects, that can make a connection from one terminal to another.** Shorting the battery terminals together may cause burns or a fire.

d) **Under abusive conditions, liquid may be ejected from the battery; avoid contact. If contact accidentally occurs, flush with water. If liquid contacts eyes, additionally seek medical help.** Liquid ejected from the battery may cause irritation or burns.

e) **Do not use a battery pack or tool that is damaged or modified.** Damaged or modified batteries may exhibit unpredictable behavior resulting in fire, explosion or risk of injury.

f) **Do not expose a battery pack or tool to fire or excessive temperature.** Exposure to fire or temperature above 265 °F (130 °C) may cause explosion.

g) **Follow all charging instructions and do not charge the battery pack or tool outside the temperature range specified in the instructions.** Charging improperly or at temperatures outside the specified range may damage the battery and increase the risk of fire.

## 6) Service

a) **Have your power tool serviced by a qualified repair person using only identical replacement parts.** This will ensure that the safety of the power tool is maintained.

b) **Never service damaged battery packs.** Service of battery packs should only be performed by the manufacturer or authorized service providers.

## Safety Instructions for Rammers

This DEWALT machine has been designed and constructed in conformance with current standards and directives. This machine can constitute a danger to persons and property how ever if:

- It is not used for the intended purpose.
- It is not operated by trained personnel.
- **It is not correctly modified or converted.**
- The safety requirements are not observed.

For this reason, all persons concerned with operation, maintenance and repair of the machine must read and follow the safety requirements.

The following also apply:

- The pertinent regulations for the prevention of accidents
- Generally recognised safety rules and road traffic regulations
- Country-specific requirements

## Conversions and Changes to the Machine

Unauthorized changes to the machine are not permitted for safety reasons.

Original parts and accessories have been specially designed for the machine. It should be noted that parts and special equipment not supplied by DEWALT are not approved by DEWALT. The installation and/or the use of such products can also affect the active and/or passive safety.

The manufacturer disclaims all liability for any damage caused by using non-original parts or special equipment.

## Additional Safety Information

**▲ WARNING:** Never modify the power tool or any part of it. Damage or personal injury could result.

**▲ WARNING: ALWAYS** use safety glasses. Everyday eyeglasses are NOT safety glasses. Also use face or dust mask if cutting operation is dusty. **ALWAYS WEAR CERTIFIED SAFETY EQUIPMENT:**

- ANSI Z87.1 eye protection (CAN/CSA Z94.3),
- ANSI S12.6 (S3.19) hearing protection,
- NIOSH/OSHA/MSHA respiratory protection.

**▲ WARNING:** Some dust created by power sanding, sawing, grinding, drilling, and other construction activities contains chemicals known to the State of California to cause cancer, birth defects or other reproductive harm. Some examples of these chemicals are:

- lead from lead-based paints,
- crystalline silica from bricks and cement and other masonry products, and
- arsenic and chromium from chemically-treated lumber.

Your risk from these exposures varies, depending on how often you do this type of work. To reduce your exposure to these chemicals: work in a well ventilated area, and work with approved safety equipment, such as those dust masks that are specially designed to filter out microscopic particles.

• **Wear protective clothing and wash exposed areas with soap and water.** Allowing dust to get into your mouth, eyes, or lay on the skin may promote absorption of harmful chemicals. Direct particles away from face and body.















• **Air vents often cover moving parts and should be avoided.** Loose clothes, jewelry or long hair can be caught in moving parts. Always avoid wearing jewelry or loose fitting clothes that may snag on the controls or moving parts as this can cause serious injury.

**▲ CAUTION:** When not in use, place tool on a stable surface.

The label on your tool may include the following symbols. The symbols and their definitions are as follows:

V .....	volts	sfpm .....	surface feet per minute
Hz .....	hertz	SPM .....	strokes per minute
min .....	minutes	A .....	amperes
— or DC .....	direct current	W .....	watts
⚠ .....	Class I Construction (grounded)	Wh .....	watt hours
.../min .....	per minute	Ah .....	amp hours
BPM .....	beats per minute	~ or AC .....	alternating current
IPM .....	impacts per minute	⚡ or AC/DC .....	alternating or direct current
OPM .....	oscillations per minute	⊞ .....	Class II Construction (double insulated)
RPM .....	revolutions per minute		

## ENGLISH

$n_0$ .....	no load speed		.....	wear hearing protection
$n$ .....	rated speed		.....	wear protective shoes
PSI .....	pounds per square inch		.....	read all documentation
	.....		.....	do not use high pressure water
	.....		.....	hot surface
	.....		.....	do not touch
	.....		.....	lifting hook
	.....		.....	pinch hazard
	.....			

## **WARNING**

- **INGESTION HAZARD:** This product contains a button cell or coin battery.
- **DEATH** or serious injury can occur if ingested.
- A swallowed button cell or coin battery can cause **Internal Chemical Burns** in as little as **2 hours**.
- **KEEP** new and used batteries **OUT OF REACH** of CHILDREN.
- **Seek immediate medical attention** if a battery is suspected to be swallowed or inserted inside any part of the body.



Remove and immediately recycle or dispose of used batteries according to local regulations and keep away from children. Do NOT dispose of batteries in household trash or incinerate. Even used batteries may cause severe injury or death. Call a local poison control center for treatment information. Tool Connect™ uses a CR2450 type battery of nominal 3V voltage. Non-rechargeable batteries are not to be recharged. Do not force discharge, recharge, disassemble, heat above 140 °F (60 °C), or incinerate. Doing so may result in injury due to venting, leakage or explosion resulting in chemical burns.

**▲ WARNING:** *Danger of explosion if battery is incorrectly replaced.*  
Product contains non-replaceable battery except by qualified service center. Do not attempt to replace the coin cell battery yourself.

## Batteries and Chargers

The battery pack is not fully charged out of the carton. Before using the battery pack and charger, read the safety instructions below and then follow charging procedures outlined. When ordering replacement battery packs, be sure to include the catalog number and voltage.

### READ ALL INSTRUCTIONS

#### Important Safety Instructions for All Battery Packs

- ▲ **WARNING:** *Read all safety warnings, instructions, and cautionary markings for the battery pack, charger and product. Failure to follow the warnings and instructions may result in electric shock, fire and/or serious injury.*
- **Do not charge or use the battery pack in explosive atmospheres, such as in the presence of flammable liquids, gases or dust.** Inserting or removing the battery pack from the charger may ignite the dust or fumes.

- **NEVER force the battery pack into the charger. DO NOT modify the battery pack in any way to fit into a non-compatible charger as battery pack may rupture causing serious personal injury.** Consult the chart at the end of this manual for compatibility of batteries and chargers.
- **Charge the battery packs only in DeWALT chargers.**
- **DO NOT splash or immerse in water or other liquids.**
- **DO NOT allow water or any liquid to enter battery pack.**
- **Do not store or use the tool and battery pack in locations where the temperature may reach or exceed 104 °F (40 °C) (such as outside sheds or metal buildings in summer).** For best life store battery packs in a cool, dry location.
- NOTE: Do not store the battery packs in a tool with the trigger switch locked on. Never tape the trigger switch in the ON position.**

- **Do not incinerate the battery pack even if it is severely damaged or is completely worn out.** The battery pack can explode in a fire. Toxic fumes and materials are created when lithium-ion battery packs are burned.
- **Do not expose a battery pack or appliance to fire or excessive temperature.** Exposure to fire or temperature above 265 °F (130 °C) may cause explosion.
- **Follow all charging instructions and do not charge the battery pack or appliance outside of the temperature range specified in the instructions.** Charging improperly or at temperatures outside of the specified range may damage the battery and increase the risk of fire.
- **If battery contents come into contact with the skin, immediately wash area with mild soap and water.** If battery liquid gets into the eye, rinse water over the open eye for 15 minutes or until irritation ceases. If medical attention is needed, the battery electrolyte is composed of a mixture of liquid organic carbonates and lithium salts.
- **Contents of opened battery cells may cause respiratory irritation.** Provide fresh air. If symptoms persist, seek medical attention.
- **Battery liquid may be flammable if exposed to spark or flame.**
- **Never attempt to open the battery pack for any reason. If the battery pack case is cracked or damaged, do not insert into the charger.** Do not crush, drop or damage the battery pack. Do not use a battery pack or charger that has received a sharp blow, been dropped, run over or damaged in any way (e.g., pierced with a nail, hit with a hammer, stepped on). Damaged battery packs should be returned to the service center for recycling.

## Storage Recommendations

The best storage place is one that is cool and dry, away from direct sunlight and excess heat or cold. Store the fully charged battery pack out of the charger.

## Battery Pack Cleaning Instructions

Dirt and grease may be removed from the exterior of the battery pack using a cloth or soft non-metallic brush. Do not use water or any cleaning solutions.

## Fuel Gauge Battery Packs (Fig. B)

Some battery packs include a fuel gauge. When the fuel gauge button is pressed and held, the LED lights will indicate the approximate level of charge remaining. This does not indicate tool functionality and is subject to variation based on product components, temperature, and end-user application.



## Transportation

**▲ WARNING: Fire hazard. Do not store, carry, or transport the battery pack so that metal objects can contact exposed battery terminals.** For example, do not place the battery pack in aprons, pockets, tool boxes, product kit boxes, drawers, etc., with loose nails, screws, keys, coins, hand tools, etc. When transporting individual battery packs, make sure that the battery terminals are protected and well insulated from materials that could contact them and cause a short circuit. **NOTE:** Li-ion battery packs should not be put in checked baggage on airplanes and must be properly protected from short circuits if they are in carry-on baggage.

### Shipping the DEWALT POWERSHIFT® Battery Pack

Your DEWALT POWERSHIFT® battery pack of 600 Wh or less has a shipping card that should be used when shipping POWERSHIFT® batteries.



Attach the card to the battery pack to ready it for shipping. This converts the battery pack to three separate batteries. The three batteries have the Watt hour rating labeled "Shipping" on the battery pack for US ground shipments. If shipping without the card, the pack is one battery at the Watt hour rating labeled "Use."

Example battery pack label:

**USE: 554 Wh SHIPPING: 3 x 184.5 Wh**

In this example, the battery pack is three batteries with 184.5 Watt hours each when using the card. Otherwise, the battery pack is one battery with 554 Watt hours.

## Battery Recycling

It is important to recycle lithium ion batteries at end of life as they contain valuable materials that can be reused for new purposes. Do not discard lithium ion batteries in the trash as they can be crushed and start a fire during processing. The batteries that are supplied with this equipment are considered "High Energy Batteries" which mean that have an energy greater than 300 Wh and need to be recycled in a different a program than other lower energy rechargeable battery packs. Please see the following website for more information regarding battery recycling: [dewalt.com/high-energy-battery-info](http://dewalt.com/high-energy-battery-info).

## IMPORTANT SAFETY INSTRUCTIONS FOR ALL BATTERY CHARGERS

**▲ WARNING: Read all safety warnings, instructions, and cautionary markings for the battery charger, battery pack, and product.** Failure to follow the warnings and instructions may result in electric shock, fire and/or serious injury.

- **SAVE THESE INSTRUCTIONS** - This manual contains important safety and operating instructions for DEWALT battery chargers.
- **Before using battery charger, read all instructions and cautionary markings on battery charger, battery, and product using the battery.**
- **To reduce risk of injury, charge only DEWALT DCBPS-series Li-ion batteries.** Other types of batteries may burst causing personal injury and damage.

- **Do not expose the charger to rain or snow.**
- **Do not allow water or any liquid to enter charger.**
- **Pull by the plug rather than the cord when disconnecting the charger.** This will reduce the risk of damage to the electric plug and cord.
- **Make sure that the cord is located so that it will not be stepped on, tripped over or otherwise subjected to damage or stress.**
- **Do not use an extension cord or power strip unless it is absolutely necessary.** Use of improper extension cord or power strip could result in risk of fire, electric shock or electrocution.
- **When operating a charger outdoors, always provide a dry location and use an extension cord or power strip suitable for outdoor use.** Use of a device suitable for outdoor use reduces the risk of electric shock.
- **When using a power strip, be sure that its current rating is not exceeded by the sum of the individual device's current ratings.**
- **An extension cord must have adequate wire size (AWG or American Wire Gauge) for safety.** The smaller the gauge number of the wire, the heavier the cord and thus the greater its capacity. An undersized cord will cause a drop in line voltage resulting in loss of power and overheating. The following table shows the correct size to use depending on total length of all extension cords plugged together, and nameplate ampere rating. If in doubt, use the next heavier gauge.

Minimum Gauge for Cord Sets

Volts	Total Length of Cord in Feet (meters)				
	120V	25 (7.6)	50 (15.2)	100 (30.5)	150 (45.7)
Ampere Rating		American Wire Gauge			
More Than	Not More Than				
0	6	18	16	16	14
6	10	18	16	14	12
10	12	16	16	14	12
12	16	14	12	Not Recommended	

- **Do not place any object on top of the charger or place the charger on a soft surface that might block the ventilation slots and result in excessive internal heat.** Place the charger in a position away from any heat source. The charger ventilates through left and right side vents adjacent to the pad printed "DEWALT" logo on the top cover.
- **Do not operate the charger with a damaged cord or plug.** Have them replaced immediately.
- **Do not operate the charger if it has received a sharp blow, been dropped or otherwise damaged in any way.** Take it to an authorized service center.
- **Do not disassemble the charger; take it to an authorized service center when service or repair is required.** Incorrect reassembly may result in a risk of electric shock, electrocution or fire.
- **The charger is designed to operate on standard 120V household electrical power. Do not attempt to use it on any other voltage.** This does not apply to the vehicular charger.
- **Foreign materials of a conductive nature, such as, but not limited to, grinding dust, metal chips, steel wool, aluminum foil or any buildup of metallic particles should be kept away from the charger cavities and ventilation slots.**

- **Always unplug the charger from the power supply when there is no battery pack in the cavity.**
- **The rated output current for this charger is the maximum charging rate when used with DEWALT battery packs designed to charge at this rate.**

### Charging a Battery (Fig. A, B)

**NOTE:** To ensure maximum performance and life of Li-ion battery packs, charge the battery pack fully before first use.

1. Plug the charger into an appropriate outlet before inserting battery pack.
2. Insert the battery pack **1** into the charger, making sure the battery pack is fully seated in the charger. The red (charging) light will blink repeatedly indicating that the charging process has started.
3. The Stage 1 charging blink indicator represents the charge process that charges the majority of the battery's capacity. Stage 2 charging blink indicator represents the remainder, or top off charge process, for the battery to reach full capacity.
4. The completion of charge for Stage 1 or Stage 2 will be indicated by the stage's light remaining ON continuously. The battery pack is fully charged when both Stage 1 and Stage 2 charging lights remain ON continuously.
5. To remove the battery pack, press the battery pack release button **2**.

The charger will not charge a faulty battery pack. The charger refusing to light could indicate a problem with the charger or a faulty battery pack. Discontinue use and take both to an authorized service center.

**▲ WARNING:** Only charge when battery temperature is over 40 °F (4.5 °C) and below 104 °F (40 °C).

### Hot/Cold Pack Delay

When the charger detects a battery pack that is too hot or too cold, it automatically starts a Hot/Cold Pack Delay, suspending charging until the battery pack has reached an appropriate temperature. The charger then automatically switches to the pack charging mode. This feature ensures maximum battery pack life.

A cold battery pack may charge at a slower rate than a warm battery pack.

The hot/cold pack delay will be indicated by the left indicator light continuously blinking red and the right indicator light continuously yellow. Once the battery pack has reached an appropriate temperature, the yellow light will turn OFF and the charger will resume the charging procedure.

### Fan-Cooled Chargers

Your chargers is equipped with an internal fan. The fan will turn on automatically when the battery pack is charging. Never operate the charger if the fan does not operate properly or if ventilation slots are blocked. Do not permit foreign objects to enter the interior of the charger.

### Electronic Protection System

POWERSHIFT® tools are designed with an Electronic Protection System that will protect the battery pack against overloading, overheating or deep discharge. The tool will automatically turn off and the battery pack will need to be recharged.

### Important Charging Notes

1. Longest life and best performance can be obtained if the battery pack is charged when the air temperature is

between 65 °F–75 °F (18 °C–24 °C). DO NOT charge when the battery pack is below 40 °F (4.5 °C), or above 104 °F (40 °C). This is important and will prevent serious damage to the battery pack.

2. The charger and battery pack may become warm to the touch while charging. This is a normal condition, and does not indicate a problem. To facilitate the cooling of the battery pack after use, avoid placing the charger or battery pack in a warm environment such as in a metal shed or an uninsulated trailer.

3. If the battery pack does not charge properly:
  - a. Check operation of receptacle by plugging in a lamp or other appliance;
  - b. Check to see if receptacle is connected to a light switch which turns power off when you turn out the lights;
  - c. If charging problems persist, take the tool, battery pack and charger to your local service center.
4. You may charge a partially used pack whenever you desire with no adverse effect on the battery pack.

### Charger Cleaning Instructions

**▲ WARNING:** Shock hazard. Disconnect the charger from the AC outlet before cleaning. Dirt and grease may be removed from the exterior of the charger using a cloth or soft non-metallic brush. Do not use water or any cleaning solutions.

### Wall Mounting

Some DEWALT chargers are designed to be wall mountable or to sit upright on a table or work surface. If wall mounting, locate the charger within reach of an electrical outlet, and away from a corner or other obstructions which may impede air flow. Mount the charger securely using at least size #10 exterior wood screws (purchased separately) at least 2" (50.8 mm) long, with a screw head diameter of 0.28–0.35" (7–9 mm), screwed into wood through the mounting holes.

### SAVE THESE INSTRUCTIONS FOR FUTURE USE

### DEWALT Tool Connect™ Integrated Connectivity

Tool Connect™ Integrated Connectivity is powered by an internal coin cell. The internal coin cell battery, when necessary, should be replaced by your local DEWALT authorized service center. Do not attempt to replace the coin cell battery yourself.

DEWALT Tool Connect™ products are capable of connecting with devices that support Bluetooth® technology using the DEWALT Site Manager application.

DEWALT Site Manager is a web and mobile application and is compatible with most popular devices.

Bluetooth® capability is provided by the Site Manager app. Additional subscription charges and third-party data charges may apply.

DEWALT Tool Connect™ integrated connectivity is designed to support tracking, locating, and providing product data using the DEWALT Site Manager app. To learn more and for a full list of features, visit: [www.DEWALT.com/en-us/jobsite-solutions/tool-connect](http://www.DEWALT.com/en-us/jobsite-solutions/tool-connect).

### Getting Started with DEWALT Tool Connect™

**NOTE:** The DEWALT Site Manager app is governed by separate terms and conditions available for viewing through the mobile or web application.

Step 1: Download the DEWALT Site Manager application at:



Step 2: Follow the instruction in the app to create your account or log into an existing Site Manager account.

Step 3: Connect your product with the DeWALT Site Manager app by going to the Inventory screen and selecting "+ Tool", then following the steps in app.

**NOTE:** Your device is enabled with an optimized pairing process. Simply select "Add via QR or Barcode" to connect your Bluetooth® enabled product to your account.

For more information on DeWALT Tool Connect™ functionality and features, visit [www.DeWALT.com/en-us/jobsite-solutions/tool-connect](http://www.DeWALT.com/en-us/jobsite-solutions/tool-connect) or call 1-800-4-DEWALT.

## ASSEMBLY AND ADJUSTMENTS

**▲ WARNING:** To reduce the risk of serious personal injury, turn unit off and remove the battery pack before making any adjustments or removing/installing attachments or accessories. An accidental start-up can cause injury.

### Before Using

**▲ DANGER:** Failure to follow this manual and all the safety instructions it contains can result in death, injury or property damage. Carefully read and follow this manual, especially the safety instructions.

**▲ DANGER:** Failure to observe the following instructions can result in death, injury or property damage. Failure to observe the following instructions can result in overheating, fire, bursting, explosion or electric shock.

**▲ DANGER:** Death or injury hazard from damaged cables or contacts. Have them replaced by technical personnel or the manufacturer.

**▲ WARNING:** Failure to use personal protective equipment (PPE) or using unsuitable equipment, may harm health or cause injury. Personal protective equipment includes: eye protection, hearing protection, safety shoes, work gloves, and respiratory protection.

Determine and prepare the right personal protective equipment for the job. Use only personal protective equipment that is in proper condition and offers effective protection. Adjust the personal protective equipment to the person, such as to body size.

**▲ WARNING:** Use only DeWALT batteries.

Before starting the machine, familiarize yourself with the operating and control elements and mode of operation of the machine and the working area.

Set the machine on an even surface.

- Check:
  - oil level through site glass. Refer to **Checking the Oil Level** for instructions.
  - the machine for any noticeable defects.
  - bellows for damage and leaks.
  - screw connections for tightness.
  - all protective devices are securely in place.
  - the control elements function properly.
  - conditions of the motor and the machine.
  - that the machine is free from oily and ignitable material.
  - all handles to make sure they are free from grease, oils, fuels, dirt, snow and ice.

Only use machines that have been regularly maintained and free from defects.

## OPERATION

**▲ WARNING:** To reduce the risk of serious personal injury, turn unit off and remove the battery pack before making any adjustments or removing/installing attachments or accessories. An accidental start-up can cause injury.

**▲ DANGER:** Death hazard from tilting or sliding the machine. Unstable material, unstable edges and slippery surfaces can cause the machine to tip over. This can cause severe injury or death.

- Navigate slopes carefully, and always drive upward in a straight direction.
- Drive up steep slopes backwards to keep from tipping the machine.
- Keep adequate distance from trench edges and embankments.
- Refrain from any manner of working that threatens the machine's stability.
- Make sure to position operator in a location during use so that if the machine were to tip over, the operator would be clear.
- Do not move over hard concrete, hardened bitumen surfaces, frozen ground or ground that does not have an adequate load capacity.

**▲ CAUTION:** Accident hazard. The machine drives off immediately after start-up. Keep a strong hold on the machine.

**▲ NOTICE:** Beware of property damage. When compacting interlocking paving stones, it is recommended that wear-protection plates (optional equipment) be used to prevent damage to the machine and compaction materials.

## Operational Rules for Rammers

### Transport

During transport of the machine, there is a crushing hazard from the machine's own weight. Improper handling can crush or severely injure parts of people's body. Therefore, heed the following instructions:

- Always remove the battery before loading and transport.
- Follow the loading and transport instructions in this document.
- Use only suitable transport and lifting equipment with adequate load-bearing capacity!
- Attach suitable slinging equipment to the slinging points provided.
- Secure the machine against tipping over or slipping.
- Never walk or stand under suspended loads. This may pose a death hazard!
- Secure the machine on the transport vehicle against rolling, sliding or tipping over.
- Remove the battery before loading and stow it securely.

### Operation

During the machine's operation, various residual hazards exist that are caused by the purpose of the machine's use and cannot be eliminated by design. Therefore, heed the following instructions:

## Before Starting

- *Wear personal safety equipment (eye protection, safety shoes, hearing protection, etc.).*
- *Become familiar with the operation and control elements and the manner of working with the machine.*
- *Check that all of the safety devices are securely installed in place.*
- *Never start the machine with defective instruments or controls. This may cause injury!*
- *Examine your work environment and prepare it for the work. This includes, among other things:*
  - *Removing obstacles in the work area.*
  - *Checking the ground's load capacity.*
  - *Providing necessary safeguards.*
- *The points listed here are frequently occurring activities in relation to the machine's area of application. This list is not complete, and depends on the specific work environment. Always adapt it to your own work environment.*

## Starting

- *It is forbidden to start and operate the machine in a potentially explosive environment! Power tools create sparks which may ignite dust or fumes.*
- *Abide by the switching-on and switching-off procedures and that the control displays are as per the operating manual.*

## Installing and Removing the Battery Pack (Fig. D)

**▲ WARNING:** *Ensure the machine is in the off position before inserting the battery pack.*

**NOTE:** For best results, make sure your battery pack is fully charged.

1. To install the battery pack **1** into the machine, align the battery pack with the rails inside the machine and slide it in, until the battery pack is firmly seated in the machine and ensure that it does not disengage.
2. To remove the battery pack from the machine, press the battery pack release button **2** and firmly pull the battery pack out of the machine.

## Proper Hand Position (Fig. H)

**▲ WARNING:** *To reduce the risk of serious personal injury, ALWAYS use proper hand position as shown.*

**▲ WARNING:** *To reduce the risk of serious personal injury, ALWAYS hold securely in anticipation of a sudden reaction.*

Proper hand position requires both hands on the guide bar **3**.

## Working with the Rammer (Fig. H)

**▲ WARNING:** *Guide the machine only with the guide bar, and don't lift it during operation. Always keep an eye on the machine when its motor is running.*

**▲ WARNING:**

- *Guide the machine so that hands do not come against fixed objects; risk of injury.*
- *Guide the machine so that the operator can not be crushed between the machine and hard objects.*
- *Listen for any abnormal noises. Locate the cause and have the damage repaired.*
- *Never release the machine with the motor running.*
- *Keep feet away from the rammer base plate.*

The operator's position is in the forward facing direction behind the machine. (Fig. H)

- *Select high speed for maximum performance.*
- *Select low speed to increase control over the unit when maneuvering around tight areas, e.g. around a pipe, in a corner, over a pipe.*
- *The dumping height of the material to be compressed should not be higher than the rammer can drive over.*
- *To get uniform operating performance, depending on the ground condition and density, select low or high speed.*

## On/Off Switch (Fig. E)

**▲ WARNING:** *When ever the machine is running, keep both hands securely on the machine.*

- To switch the machine on, press the the dual action switch **4** forward then down. It can take up to five seconds before the machine starts once the dual action switch is engaged.
- To switch the machine off, press the stop "O" button **5**. Once the machine is shut off, the user should wait a short period of time before switching the machine on again.

## Speed Controls (Fig. A, E)

The speed of the machine can be controlled by the speed selection button.

Pressing the high speed button **7** increases the speed of the machine. Pressing the low speed button **6** decreases the speed of the machine.

The speed control panel has a hot motor warning **23** in the center and a low speed indicator **24** in the speed selection button.

- **Low speed indicator constantly illuminated:** low speed /slow.
- **Hot motor warning constantly illuminated:** Machine is not able to run due to hot motor. *Allow the machine time to cool down.*
- **Hot motor warning blinking:** If the hot motor warning LED is blinking, the operator must stop using the machine immediately and have it serviced, otherwise there is risk of damaging the machine.

## Setting the Working Height of the Guide Bar (Fig. A, F)

Using the rammer with the guide bar set out of the optimal working position can increase hand/arm vibration. This must be considered when determining the exposure period.

- Loosen the screws **12** enough so that the bracket moves up and down. Do not take them completely out.
- *Set the working height by raising or lowering the guide bar **3**.*
- Tighten the screws **12**.

## Rate of Advance (Fig. A, G)

- The rate of advance can be influenced in two ways:
  - By changing the tilt:
    - Forward tilt = forward quickly.
    - Rearward tilt = forward slowly.
  - By putting weight on the guide bar:
    - No weight = forward slowly.
    - Heavy weight = forward quickly.
- *Switch speeds from low to high using the low speed **6** and high speed **7** buttons.*

## Parking the Rammer (Fig. I, J)

- If possible, park the machine on a level, firm surface (Fig I).
- Before leaving the machine, secure the machine to prevent it from tilting over.
- If the machine is left unattended, the machine shall be locked against unauthorised use by removing the battery or locking the dual action switch 4 (Fig. J).

## Transporting and Loading (Fig. K–M)

- ▲ **WARNING:** *The machine is heavy. Do not lift by hand.*
- ▲ **DANGER:** *Death hazard from suspended load! The machine is heavy, 143 lbs (65 kg) without battery. Improperly transporting the machine can cause it to fall and injure people.*
- Always shut off the motor when loading and transporting.
- Secure the machine to prevent it tilting or slipping.
- Persons may not go near hanging loads or stand under hanging loads or ride on a hanging load.
- Ensure that no persons will be endangered.
- Only use sufficiently strong and secure loading ramps when loading.
- The machine may swing when suspended.
- Check the contact points (frame, lifting rings) before use for damage and wear. Immediately replace damaged parts.
- Secure the machine against rolling or slipping off and against tipping over.
- When loading, lashing down and lifting the machine always use the provided lifting points.

To transport the machine or lift it with a crane, do as follows:

1. Always remove the battery before loading and transport.
2. Make sure that the motor has cooled and the battery has been removed.
3. Hang the crane hook 18 from the designated lifting point 9.
4. Load the machine onto the transport vehicle.
5. Remove the crane hook from the designated lifting point.
6. Secure the machine to the transport lugs with straps and load it correctly.
  - a. After loading the rammer on the vehicle, lay the machine down on its side, and tie it down through the guide bar and handle.
  - b. Strong metal parts on the rammer can be used for tying. Do not use the belt where any wiring or plastic parts are stressed.
  - c. It is in the responsibility of the transporter to choose sufficient methods for securing the product.
7. At the destination, loosen the transport locks.
8. Hang the crane hooks into the designated lifting point.
9. Lift the machine with a crane and unload it.
10. Place the machine on a level floor and prepare it for operation.

## Transport over Short Distances (Fig. K)

Over short distances, transport the rammer using the rollers 11, with the motor shut off.

Pull the rammer by using the carrying handle 8 while rolling on the rollers.

## MAINTENANCE

▲ **WARNING:** *To reduce the risk of serious personal injury, turn unit off and remove the battery pack before making any adjustments or removing/installing attachments or accessories. An accidental start-up can cause injury.*

Your DEWALT power tool has been designed to operate over a long period of time with a minimum of maintenance. Continuous satisfactory operation depends upon proper tool care and regular cleaning.

## General Maintenance Information

- Observe the safety regulations!
- Only qualified, authorized persons may carry out repairs.
- In the event of faults, refer to the **Operation** and **Maintenance** instructions for correct operation and maintenance.
- If the fault can not be located, refer repairs to an authorized DEWALT service center.
- Always first check items that are easily accessible (fuses, LEDs, etc.).
- Avoid contact with rotating parts.
- Only carry out maintenance with the motor switched off.
- Before carrying out maintenance work, remove the battery.
- Clean the motor and machine prior to carrying out maintenance work.
- Park the machine on a level surface and secure to prevent rolling and slipping.
- Ensure that lubricants and replacement parts are disposed of in a safe and environmentally acceptable manner.
- Avoid short-circuits on current-carrying cables.
- After washing, blow components dry with compressed air to prevent creepage currents.
- Rammers must be tested for safety depending on the operating conditions required, at least once a year by an authorized DEWALT service center.

## Tightening Torque

Ø	8.8		10.9		12.9	
	Nm	ft lb	Nm	ft lb	Nm	ft lb
M4	3	2	4.4	3	5	4
M5	6	4	8.7	6	10	7
M6	10	7	15	11	18	13
M8	25	18	36	26	43	31
M10	49	36	72	53	84	61
M12	85	62	125	92	145	106
M14	135	99	200	147	235	173
M16	210	154	310	228	365	269
M18	300	221	430	317	500	368
M20	425	313	610	449	710	523
M22	580	427	830	612	970	715
M24	730	538	1050	774	1220	899
M27	1050	774	1480	1092	1774	1308
M30	1420	1047	2010	1482	2400	1770

Strength grades for screws with untreated, unlubricated surfaces.

## ENGLISH

The values show 90% use of the yield strength; at a friction coefficient of  $\mu_{\text{tot}} = 0.14$ .

Tightening torque is controlled with torque wrenches.

The values given do not apply when MoS2 lubrication is used.

**IMPORTANT:** Replace all self-locking nuts after each disassembly.

### Screw Connections

With vibrating devices, it is important to intermittently check the screw connections for tightness. Pay attention to the tightening torque.

### Checking the Rubber Buffers (Fig. N)

Check the rubber buffers **13** for tears and outbreaks, as well as for secure fit. If they are damaged, replace them immediately.

### Checking the Bellows (Fig. O)

- Check the bellows **14** for condition and secure fit. Replace defective bellows immediately.
- Check mounting clips **15** for secure fit.

### Padfoot (Fig. P)

If the padfoot **10** becomes worn, it can be replaced.

1. Place the bolts **25** through the foot of the machine.
2. Use a wrench to twist the nuts **26** of the padfoot replacement kit clockwise to desired torque.

Checking and tighten the bolts regularly to the desired torque

### Checking the Oil Level (Fig. Q)

1. Set the rammer aside horizontally.

**IMPORTANT:** Let the rammer stand for a little while so that the oil can run back into the housing.

2. Clean the oil sight glass **16**.
3. Check the oil level.
4. The oil must be at least up to the upper edge of the sight glass. If the oil level is low, take the rammer to an authorized DEWALT service center to have the oil topped off or replaced. The oil should also be replaced after 200 hours or service or once annually.

## Storage

### Preparation for Storage

If the machine is to be shut down for an extended time (longer than six weeks), it should be placed stably on a pallet on a firm, even surface. **If the machine is stored standing up, it should be secured from tipping over.**

- The storage area should be dry and protected.
- The ambient temperature should be between 32 °F (0 °C) and 113 °F (45 °C).
- Before storing the machine
  - Clean it thoroughly
  - Check for leaks and damage, and fix any problems.
  - Cover it with a protective tarpaulin.

### Returning the Machine to Service

Before returning the machine to service, check the machine for:

- leaks,
- defective or leaky hydraulic hoses,

- any other damage.

Check all screw joints and tighten them.

## Cleaning

**▲ WARNING:** Blow dirt and dust out of all air vents with clean, dry air at least once a week. To minimize the risk of eye injury, always wear ANSI Z87.1 approved eye protection when performing this procedure.

**▲ WARNING:** Never use solvents or other harsh chemicals for cleaning the non-metallic parts of the tool. These chemicals may weaken the plastic materials used in these parts. Use a cloth dampened only with water and mild soap. Never let any liquid get inside the tool; never immerse any part of the tool into a liquid.

**▲ WARNING:** Never clean the machine with the motor running.

**▲ WARNING:** DO NOT allow water to splash onto the battery rail and terminal block area. Wipe all battery interface components dry.

**▲ WARNING:** Risk of fire and explosion caused by inflammable substances. For cleaning, do not use any flammable or aggressive materials.

**▲ WARNING:** Clean the bottom area of the machine with only low pressure water, being careful to stay away from motor, battery port and electronics.

**▲ NOTICE: Property damage hazard to the machine from high pressure water.**

**IMPORTANT:** Clean the machine daily.

1. Remove the battery.
  2. Install the safety cap on the battery plug.
  3. **Protect the motor well from water.**
  4. Wipe the machine dry with a clean, dry cloth.
  5. **Dry any damp spots on the machine that may have occurred during cleaning.**
  6. After cleaning, check the cables, wires and screw joints for leaks, loose connections, chafe marks and other damage and for contamination of the plug contacts.
- Eliminate any problems immediately.

## Accessories

**▲ WARNING:** Since accessories, other than those offered by DEWALT, have not been tested with this product, use of such accessories with this product could be hazardous. To reduce the risk of injury, only DEWALT-recommended accessories should be used with this product.

Recommended accessories for use with your product are available at extra cost from your local dealer or authorized service center. If you need assistance in locating any accessory, please contact DEWALT. Call **1-800-4-DEWALT (1-800-433-9258)** or visit our website: **www.dewalt.com**.

### Installing and Removing the Wheel Kit (Fig. R)

**▲ WARNING:** Do not operate the rammer with the wheel kit installed. The wheel kit should only be used to transport the rammer.

#### To Install the Wheel Kit

1. Place the bolts **21** through the foot of the machine.
2. Align the bracket **20** and the wheel set **19** as shown in Fig. R.
3. Use a wrench to twist the nuts **22** of the wheel kit clockwise to desired torque.

## To Remove the Wheel Kit

1. Use a wrench to twist the nuts of the wheel kit counterclockwise and remove them from the bolts.
2. Once removed, lift the bracket and the wheel set from the machine.

## Repairs

The charger and batteries are not serviceable. There are no serviceable parts inside the charger or battery pack.

**▲ WARNING:** To assure product SAFETY and RELIABILITY, repairs, maintenance and adjustment (including brush inspection and replacement, when applicable) should be performed by a factory service center or an authorized service center. Always use identical replacement parts.

- Only qualified and authorized persons may carry out repairs.
- If the machine should break down, hang a warning sign on the control arm.

## Register Online

Thank you for your purchase. Register your product now for:

- **WARRANTY SERVICE:** Registering your product will help you obtain more efficient warranty service in case there is a problem with your product.
- **CONFIRMATION OF OWNERSHIP:** In case of an insurance loss, such as fire, flood or theft, your registration of ownership will serve as your proof of purchase.
- **FOR YOUR SAFETY:** Registering your product will allow us to contact you in the unlikely event a safety notification is required under the Federal Consumer Safety Act.
- Register online at [www.dewalt.com/account-login](http://www.dewalt.com/account-login).

## Three-Year Limited Warranty

For warranty terms, go to

[www.dewalt.com/support/warranty](http://www.dewalt.com/support/warranty).

To request a written copy of the warranty terms, contact: Customer Service at DeWALT Industrial Tool Co., 701 East Joppa Road, Towson, MD 21286 or call **1-800-4-DeWALT (1-800-433-9258)**.

**LATIN AMERICA:** This warranty does not apply to products sold in Latin America. For products sold in Latin America, see country-specific warranty information contained in the packaging, call the local company or see website for warranty information.

**FREE WARNING LABEL REPLACEMENT:** If your warning labels become illegible or are missing, call **1-800-4-DeWALT (1-800-433-9258)** for a free replacement.

**Compatible battery packs and chargers / Blocs-piles et chargeurs compatibles /  
Baterías y cargadores compatibles**

<b>POWERSHIFT®</b>	Battery Packs	
	Blocs-piles	DCBPS0554
	Baterías	
<b>POWERSHIFT®</b>	Chargers	
	Chargeurs	DCBPSC0550
	Cargadores	
<b>FLEXVOLT®</b>	Battery Packs	
	Blocs-piles	DCB606, DCB609, DCB609G, DCB612, DCB615
	Baterías	
<b>FLEXVOLT®</b>	Chargers	
	Chargeurs	DCB094, DCB102, DCB103, DCB104, DCB107, DCB112, DCB113, DCB115, DCB118, DCB132, DCB1102, DCB1104, DCB1106, DCB1112
	Cargadores	

The DCPS660 DeWALT POWERSHIFT® 60 kg Rammer is compatible with the mentioned FLEXVOLT® batteries when those batteries are put into the DCAFVPS FLEXVOLT® Adaptor.

Le support de carottage DCPS660 DeWALT POWERSHIFT® 6.375IN est compatible avec les batteries FLEXVOLT® mentionnées lorsque ces batteries sont placées dans l'adaptateur DCAFVPS FLEXVOLT®.

El soporte de perforación hueca DCPS660 DeWALT POWERSHIFT® 6.375IN es compatible con las baterías FLEXVOLT® mencionadas cuando esas baterías se colocan en el adaptador DCAFVPS FLEXVOLT®.

\* Maximum initial battery voltage (measured without a workload) is 120 volts. Nominal voltage is 54.

\* La tension initiale maximum du bloc-piles (mesurée à vide) est de 120 volts. La tension nominale est de 54.

\* El máximo voltaje inicial de la batería (medido sin carga de trabajo) es 60 voltios. El voltaje nominal es de 54.

**▲ WARNING:** Use of any other battery packs may create a risk of injury and fire.

**▲ AVERTISSEMENT :** utiliser d'autres blocs-piles peut créer un risque de blessure ou d'incendie.

**▲ ADVERTENCIA:** El uso de cualquier otro paquete de batería puede crear un riesgo de lesiones e incendio.

**NOTE:** DO NOT charge when the battery pack is below 40° F (4.5° C) or above 104° F (40° C). Do not store or use the tool and battery pack in locations where the temperature may reach or exceed 104° F (40° C).

**REMARQUE :** NE PAS charger lorsque le bloc-piles est en dessous de 4,5° C (40° F) ou au-dessus de 40° C (104° F). Ne pas entreposer ou utiliser l'outil et le bloc-piles dans des endroits où la température peut atteindre ou excéder 40° C (104° F).

**NOTA:** NO cargue cuando el paquete de batería esté debajo de 4,5° C (40° F), o arriba de 40° C (104° F). No almacene ni use la herramienta y el paquete de baterías en lugares donde la temperatura pueda alcanzar o exceder los 40° C (104° F).

PART NUMBER

DeWALT Industrial Tool Co., 701 East Joppa Road, Towson, MD 21286  
Copyright © 2024

The following are trademarks for one or more DeWALT power tools: the yellow and black color scheme, the "D" shaped air intake grill, the array of pyramids on the handgrip, the kit box configuration, and the array of lozenge-shaped humps on the surface of the tool.