

TANK XTREME 5.0 LTE

Quick Guide



ATTENTION

- For instructions or any questions pertaining to phone usage, please click on the BLU Help icon on the home screen of the phone. Also included in BLU Help is a product registration link and technical support. You may also access the BLU help page by visiting the following address: **manuals.bluproducts.com**
- Para obtener instrucciones o preguntas relacionadas con el uso del teléfono, por favor haga clic en el icono de BLU Help en la pantalla principal del teléfono. También se incluye en BLU Help un enlace para registro del producto y soporte técnico. Usted también puede acceder la página de BLU Help visitando la siguiente dirección: **manuals.bluproducts.com**
- Para obter instruções ou perguntas relacionadas ao uso do telefone, por favor, clique no ícone BLU Help na tela principal do telefone. Também incluído no BLU Help um link para registrar o produto e suporte técnico. Você também pode acessar a página de BLU Help visitando o seguinte endereço: **manuals.bluproducts.com**
- Pour des instructions ou pour toutes questions sur l'utilisation du téléphone, veuillez cliquer sur l'icône Aide BLU sur l'écran d'accueil du téléphone. L'Aide BLU comprend un lien pour enregistrer le produit et pour le soutien technique. Vous pouvez aussi accéder à la page aide BLU en visitant l'adresse suivante : **manuals.bluproducts.com**

SAFETY INFORMATION

Transportation Safety

Please observe all transportation laws and regulations.

PLEASE DRIVE RESPONSIBLY - DO NOT TEXT & DRIVE

Hospital Safety

Please follow hospital rules and limitations.

Please turn off your mobile phone when near medical instruments.

Airport Safety

Remember to follow all airport and flight safety regulations.

Water Hazard

Your phone is not waterproof. Keep your phone away from water or liquid to avoid damage.

Emergency Calls

Make sure your mobile phone is switched on and in a service area. In home screen, tap the phone key and dial the emergency number.

Battery Usage

For better performance and longer battery life, it is recommended that you charge the battery fully before using the mobile phone for the first time and that you initially complete two to three charge cycles.

BLJ_470_V01

KEY FUNCTIONS



Rear Camera

Flash



Power On / Off	Used to power on/off the device and to lock the screen. > Long press the power button to power on > While the phone is powered on, long press to access the power off menu or click to lock the screen
Volume	Adjusts the ringer volume, call volume, and multimedia volume.
Home	The home button pauses any current action and returns to the home screen.
Recent Apps	Opens a list of recently opened applications that allows you to switch conveniently between them. This option can also close any open applications by swiping to the side.
Back	Returns to the previous screen; Closes the keyboard, any open program, or any menu option.
USB Port	Charges the device and transfers data such as documents, music, and video between your device and a PC.
Headset Port	Connect earphones to this port for hands-free capabilities. You may also listen to music or FM radio.
Front Camera	A high-resolution front camera to take pictures and video. This option is ideal for self-portraits.
Rear Camera	A high-resolution rear camera to take pictures and video.
Flash	Provides light for pictures in low-light conditions. It may also be used as a flashlight.

Installation of the SIM Card

Warning: Please keep the SIM card out of the reach of children. The SIM card and its contact are easily damaged due to scratching or bending. Please use caution when carrying, installing, or taking out the SIM card. **Note:** Please contact your cellular phone service provider directly to obtain your SIM card.

To insert SIM card:

- Remove the SIM tray with the tool provided. Insert the SIM card.
- Insert the SD card (For additional storage capacity).

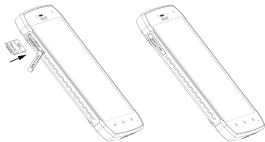
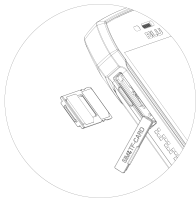

SIM & Memory Card Slot

- Insert the SIM tray and power on the phone.

DEVICE CONFIGURATION

When you initially power on your phone, there will be a series of steps to set up basic features.

INSERT SIM

Insert your SIM card so the phone can register to the network.

SELECT LANGUAGE

While on the Welcome screen, please scroll to select your language.

SELECT WI-FI

This process allows the device to connect to the internet. Click on the desired Wi-Fi network that the device that will be connected. Please note that any unsecured Wi-Fi networks can be connected to without credentials and any secured Wi-Fi networks require a password for credentials prior to connection. It is recommended that you connect to a Wi-Fi network to check for software updates prior to startup.

ADD YOUR ACCOUNT

Sign in to your Google™ account in order to keep accounts streamlined with Google services. Your Gmail™ account will be used for some Google programs that include Google Play™ Store, Google Drive™, Google +™ and Google Wallet™. If you do not have a Google account, click to create a new account.

GOOGLE SERVICES

Click to add or remove Google services that include Backup, Location Service, and Google Now™. In this step, you can also setup payment info if desired.

RESTORE APPS & DATA

You can restore your previous applications and data that was stored from another device. You also have the option to setup the phone as a brand new device.

Google, Google Play and other marks
are trademarks of Google Inc.

Labelling requirements.

This device complies with part 15 of the FCC Rules. Operation is subject to the condition that this device does not cause harmful interference.

Information to user.

Any Changes or modifications not expressly approved by the party responsible for compliance could void the user's authority to operate the equipment.

Information to the user.

Note: This equipment has been tested and found to comply with the limits for a Class B digital device, pursuant to part 15 of the FCC Rules. These limits are designed to provide reasonable protection against harmful interference in a residential installation. This equipment generates uses and can radiate radio frequency energy and, if not installed and used in accordance with the instructions, may cause harmful interference to radio communications. However, there is no guarantee that interference will not occur in a particular installation. If this equipment does cause harmful interference to radio or television reception, which can be determined by turning the equipment off and on, the user is encouraged to try to correct the interference by one or more of the following measures:

- Reorient or relocate the receiving antenna.
- Increase the separation between the equipment and receiver.
- Connect the equipment into an outlet on a circuit different from that to which the receiver is connected.
- Consult the dealer or an experienced radio/TV technician for help.

Specific Absorption Rate (SAR) information:

This **Mobile Phone** meets the government's requirements for exposure to radio waves. The guidelines are based on standards that were developed by independent scientific organizations through periodic and thorough evaluation of scientific studies. The standards include a substantial safety margin designed to assure the safety of all persons regardless of age or health.

FCC RF Exposure Information and Statement The SAR limit of USA (FCC) is 1.6 W/kg averaged over one gram of tissue. Device types: TANK XTREME PRO(FCC ID: YHLBLUTKXTPRO) has also been tested against this SAR limit. The highest SAR value reported under this standard during product certification for use at the ear is 0.53W/kg and when properly worn on the body is 0.99W/kg. This device was tested for typical body-worn operations with the back of the handset kept 10mm from the body. To maintain compliance with FCC RF exposure requirements, use accessories that maintain a 10mm separation distance between the user's body and the back of the handset. The use of belt clips, holsters and similar accessories should not contain metallic components in its assembly. The use of accessories that do not satisfy these requirements may not comply with FCC RF exposure requirements, and should be avoided.

Body-worn Operation

This device was tested for typical body-worn operations. To comply with RF exposure requirements, a minimum separation distance of 1.0 cm must be maintained between the user's body and the handset, including the antenna. Third-party belt-clips, holsters, and similar accessories used by this device should not contain any metallic components. Body-worn accessories that do not meet these requirements may not comply with RF exposure requirements and should be avoided. Use only the supplied or an approved antenna.