

PURE XL User Guide



Contents

| | |
|---------------------------------------------|----------|
| 1. For your safety | 1 |
| 2. Learn about the phone | 2 |
| ● Overview | 2 |
| ● Function Keys | 2 |
| 3. Before using | 2 |
| ● Insert SIM cards and SD card | 2 |
| ● Charge the Battery | 3 |
| 4. Getting started..... | 3 |
| ● Basic Function | 3 |
| ● Home screen..... | 4 |
| ● Touch screen | 5 |
| 5. Communication | 6 |
| ● Make a call | 6 |
| ● Incoming call | 6 |
| ● Send a Message | 7 |
| 6. Multimedia..... | 7 |

| | |
|------------------------------|----|
| ● Camera | 7 |
| ● Gallery | 8 |
| ● Music | 9 |
| 7. Connection..... | 9 |
| ● Airplane mode | 10 |
| ● Mobile Network..... | 10 |
| ● WLAN..... | 10 |
| ● Bluetooth..... | 10 |
| ● USB | 11 |
| 8. Advanced Functions..... | 11 |
| ● Fingerprint Security | 11 |
| ● Extreme mode | 12 |
| ● Chameleon | 12 |
| ● Smart Gestures | 13 |
| ● Touchless wake-up | 15 |
| ● Suspend option | 18 |
| 9. Warnings and notes..... | 18 |

1. For your safety

Please read this manual before using the cell phone to ensure safe and proper use.



SWITCH OFF IN HOSPITALS

Please abide by relevant provisions or regulations. Please turn off your mobile phone near medical equipment.



SWITCH OFF WHEN REFUELING

Don't use the phone at a refueling point. Don't use near fuel or chemicals.



MICRO SIM CARDS AND SD CARD ARE PORTABLE

Keep your phone, phone parts and accessories out of children's reach.



BATTERY

Please do not destroy or damage the battery, it can be dangerous and cause fire.

Please do not throw battery in fire to avoid hazard.

When battery cannot be used, please dispose in safe environment.

Do not try to dismantle the battery.

If the battery or the charger is broken or old, please stop using them, and replace with certified genuine battery



USE QUALITY EQUIPMENT

Use authorized equipment to avoid danger



ROAD SAFETY COMES FIRST

Give full attention while driving, Park before using your phone. Please follow traffic rules of local city town.



INTERFERENCE

All wireless devices may be susceptible to cause interference, which could affect performance.



SWITCH OFF IN AIRCRAFT

Wireless devices can cause interference in aircraft. It's not only dangerous but also illegal to use mobile phone in an aircraft.

2. Learn about the phone

Overview

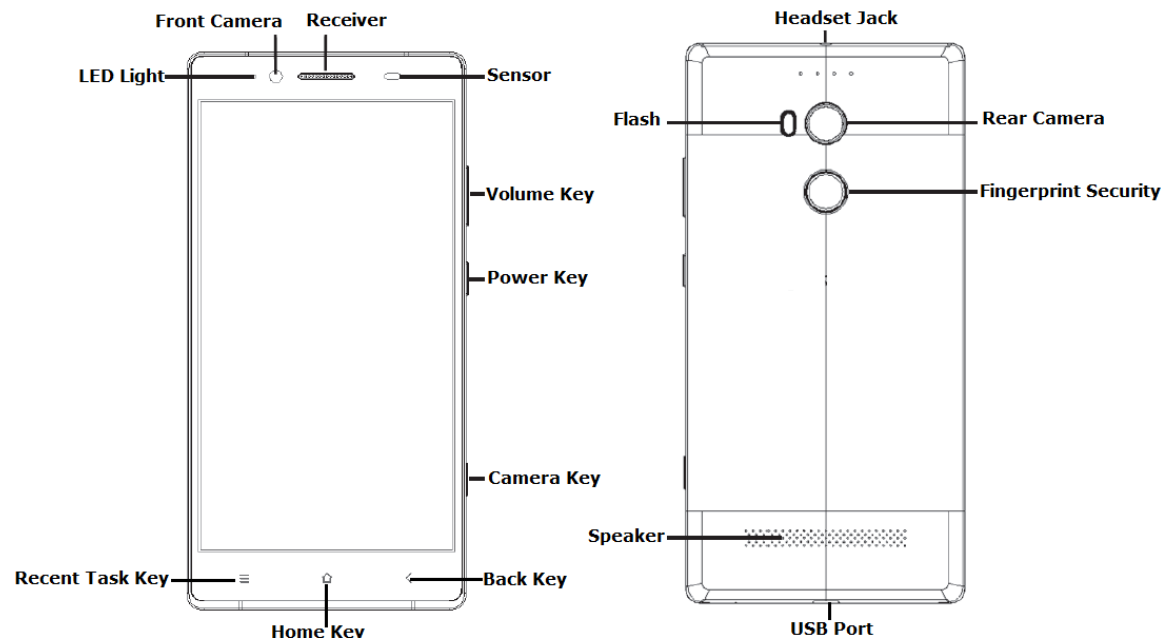

Function Keys

| Keys | Functions |
|-----------------|--------------------------------------------------------------------------------------------------------|
| Power key | a) Press to Turn on/off the screen. b) Long press to open a menu for power off the phone or reboot. |
| Volume key | Press to adjust the volume of device. |
| Camera key | a) Double press to capture 5 photos at once. b) Long press to access camera screen. |
| Recent task key | Tap to open the list of recent used apps. |
| Home key | Tap to return to Home screen. Long press to access Google™ search. |
| Back key | Tap to return to the previous screen. |

3. Before using

The phone is a Dual SIM mobile and allowed you to use two mobile networks.

Insert SIM cards and SD card

1. Switch off the mobile phone. Then remove the cover as shown in figure.

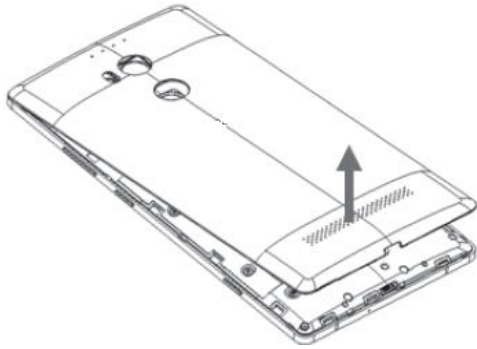

2. Insert the Micro SIM cards and SD card to the card slots correctly.

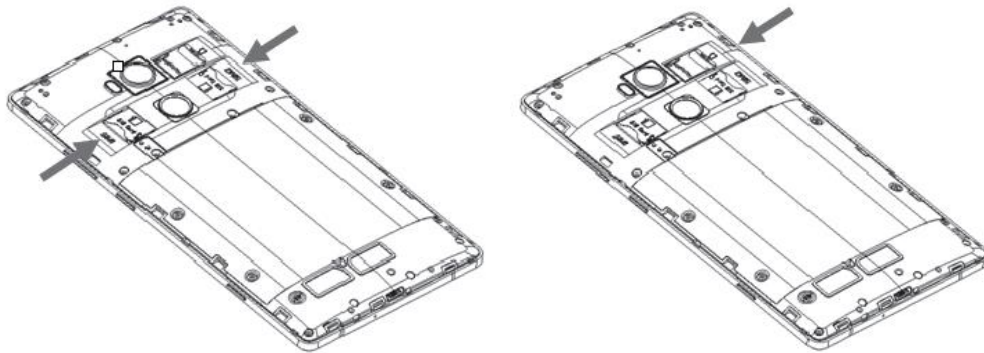

3. Put back the cover.

✓ **Notice:**

- Only Micro SIM cards are available to this device.
- Micro SIM cards are supported to hot plugging but not for SD card.
- Do not remove the Micro SIM cards and SD card while the device is transferring data. Doing so may cause data to be lost or damage to the cards and device.
- The SIM card is a small part. Please keep away from Children to avoid swallowing the card by accident.
- Do not touch the metal surface of SIM cards and SD card away from electromagnetic field to avoid damage data.

 **Charge the Battery**

Charge the battery before using it. Connect the USB cable to the USB power adaptor, and then plug the end of the USB cable into the USB Port.

✓ **Notice:**

The battery of mobile phone is fixed. It cannot remove.

4. Getting started

 **Basic Function**

- Turn on the phone
Press and hold a while of power key to turn on the phone.
- Turn off the phone

Long press the power key until a menu will show. Choose “Power off” to turn off the phone.

- Restart the phone

Option 1: Long press the power key until a menu will show. Choose “Reboot” to restart the phone.

Option 2: Long press the power key till 12 seconds to auto restart the phone.

- Lock the screen

Option 1: Press the power key to turn off the screen and lock it

Option 2: In the Home screen, double tap the screen will lock it.

Option 3: The screen will auto lock if you don't use the phone for a while.

- Unlock the screen

Press the power key, and then slide to top for unlocking.

Home screen

The Home screen is your starting point to access all the features on your phone. It displays application icons, widgets, and other features.

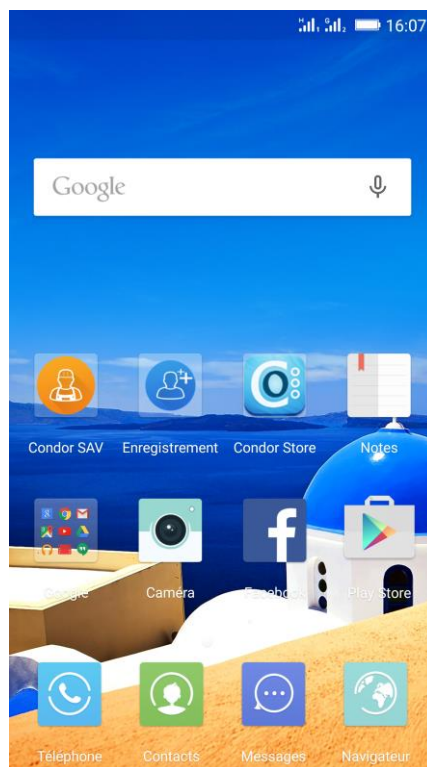

- Status Bar

At the top of the screen, it displays the time, signal, battery information, and icons for notifications that you've received.

- Notification Center

Swipe down from the top edge to see more detail of the new notification, such as messaging, missed call, Wi-Fi connection. Tap the notification and drag to left or right

to delete it.

- Control Center

Swipe up from the bottom edge. In the control center, it's quick to turn on / off Bluetooth, Wi-Fi, Data connection, Regional screenshot, Voice, Vibrate, Extreme mode.

Tap "more" to show Hidden shortcut buttons.

You can also adjust the brightness or tap "A" for auto adjustment.

- Move an application

Touch & hold the icon you want to move. Drag the icon to move or cross at the edge of the screen to move into another screen.

- Uninstall an application

Touch & hold the icon you want to uninstall. The top / bottom of the icon will appear "Uninstall". Tap it to uninstall.

- Creating a folder

Drag an icon on the top of another one to create a folder. Open the folder and then touch & hold the folder name to rename it.

Touch screen

The main way to control Android™ 5.1 features is by using your finger to touch icons, buttons, menu items, the onscreen keyboard, and other items on the touch screen.

- Touch: To act on items on the screen, such as application and settings icons, to type letters and symbols using the onscreen keyboard, or to press onscreen buttons, you simply touch them with your finger.
- Touch & hold: Touch & hold an item on the screen by touching it and not lifting your finger until an action occurs.
- Drag: Touch & hold an item for a moment and then, without lifting your finger, move your finger on the screen until you reach the target position. You drag items on the Home screen to reposition them and you drag to open the Notification panel.
- Swipe or slide: To swipe or slide, you quickly move your finger across the surface of the screen, without pausing when you first touch (so you don't drag an item instead). For example, you slide the screen up or down to scroll a list, and in some Calendar views you swipe quickly across the screen to change the range of time visible.
- Pinch: In some applications (Such as Maps, Browser, and Gallery) you can zoom in and out by placing two fingers on the screen at once and pinching them together (to zoom out) or spreading them apart (to zoom in).
- Rotate the screen: On most screens, the orientation of the screen rotates with the phone as you turn it from upright to its side and back again. You can turn this feature on and off.

5. Communication

Make a call

Touch the phone icon on the Home screen. Enter the phone number you want to dial. And then, touch the phone icon for calling.

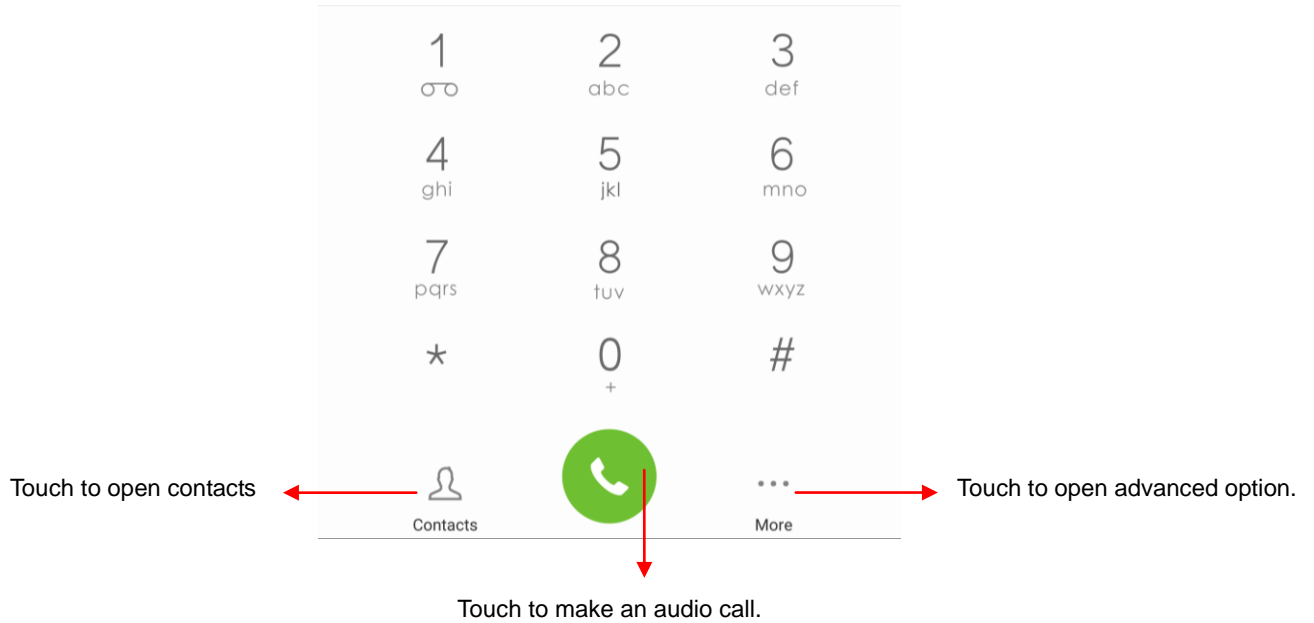

Incoming call

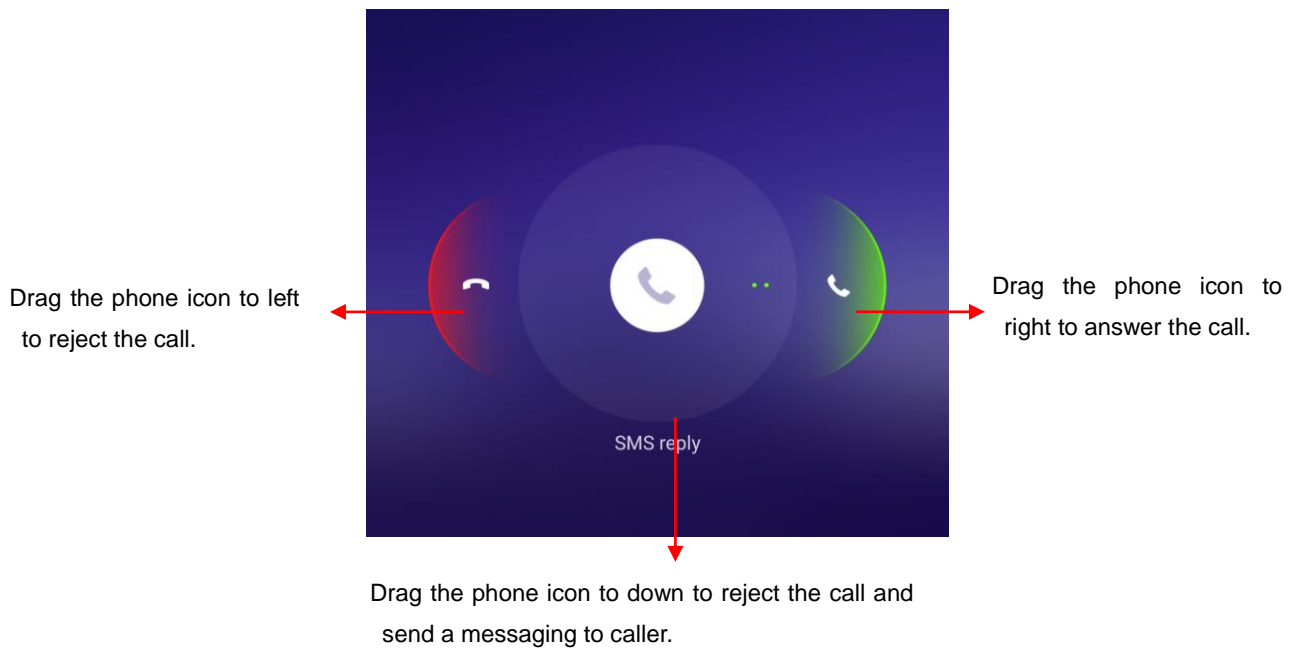

✚ Send a Message

You can use this phone to exchange text messages and multimedia messages with others. The messages from the same contact will be grouped into one conversation list. So you can see your entire message history with a person conveniently.

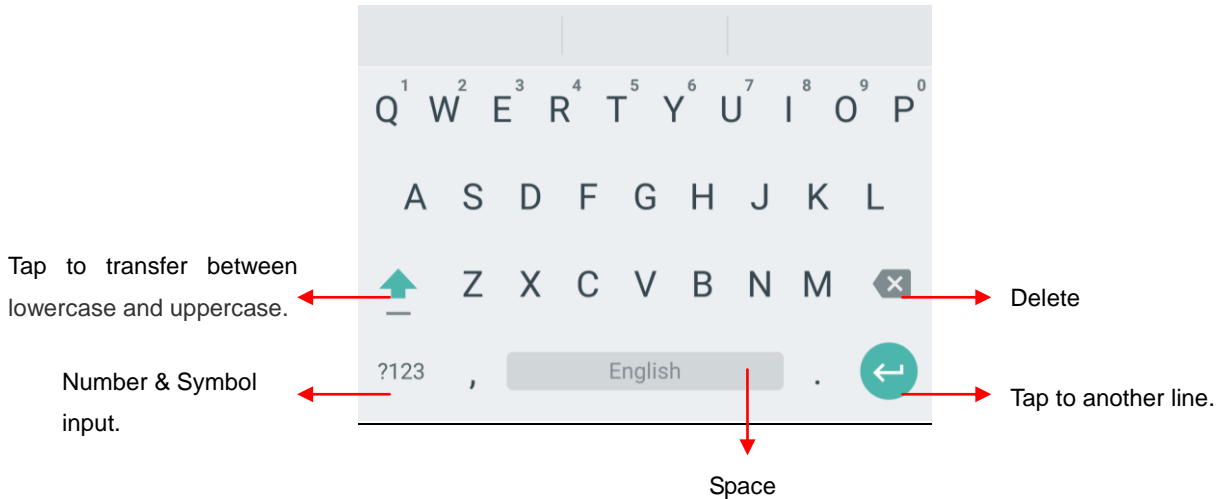

6. Multimedia

✚ Camera

Camera is a combination of camera and camcorder that you use to shoot and share pictures and videos.

Take a photo

- **Normal** Take a photo as usually.
- **Professional** Change the clarity and focus mode. For Rear camera only.
- **Face Beauty** DIY your face with Smoother, Whitening, Slimming, Enlarger. Drag the slider to adjust it.
- **Take anytime**
 - Best shot, recommend the best photo.
 - Tracks, record the object movement trail and then merge into a picture.
 - Best face will focus on the best facial expressions while taking a group photo.
 - Motion blur, make the moving object clear as the background is fuzzy.
 - Eraser, remove the moving objects from the photos.
- **Magic Focus** The effect will be better if closed-range and long-range object included.
- **Filter** Multiple filters can choose. Normal, LOMO, Hazy, Bokeh, Time, Cate, Beauty, Sweet, Vintage, B&W.
- **HDR** High-Dynamic Range mode will improve the light and the shadow effect at the same time. For Rear camera only.
- **Panorama** Press camera button and move the phone on one direction slowly. For Rear camera only.
- **Night** Through nightscape noise reduction, we see the thing in the photo as it actually is. For Rear camera only.
- **Pic Note** Intelligent crop and optimize the text photo once shooting. For Rear camera

only.

- **Ultra pixel** Take the HD photos in a size of 5 times as larger as the maximum pixel.
- **Smart scene** Change camera mode of night, HDR, fog/flare, auto base on the view.

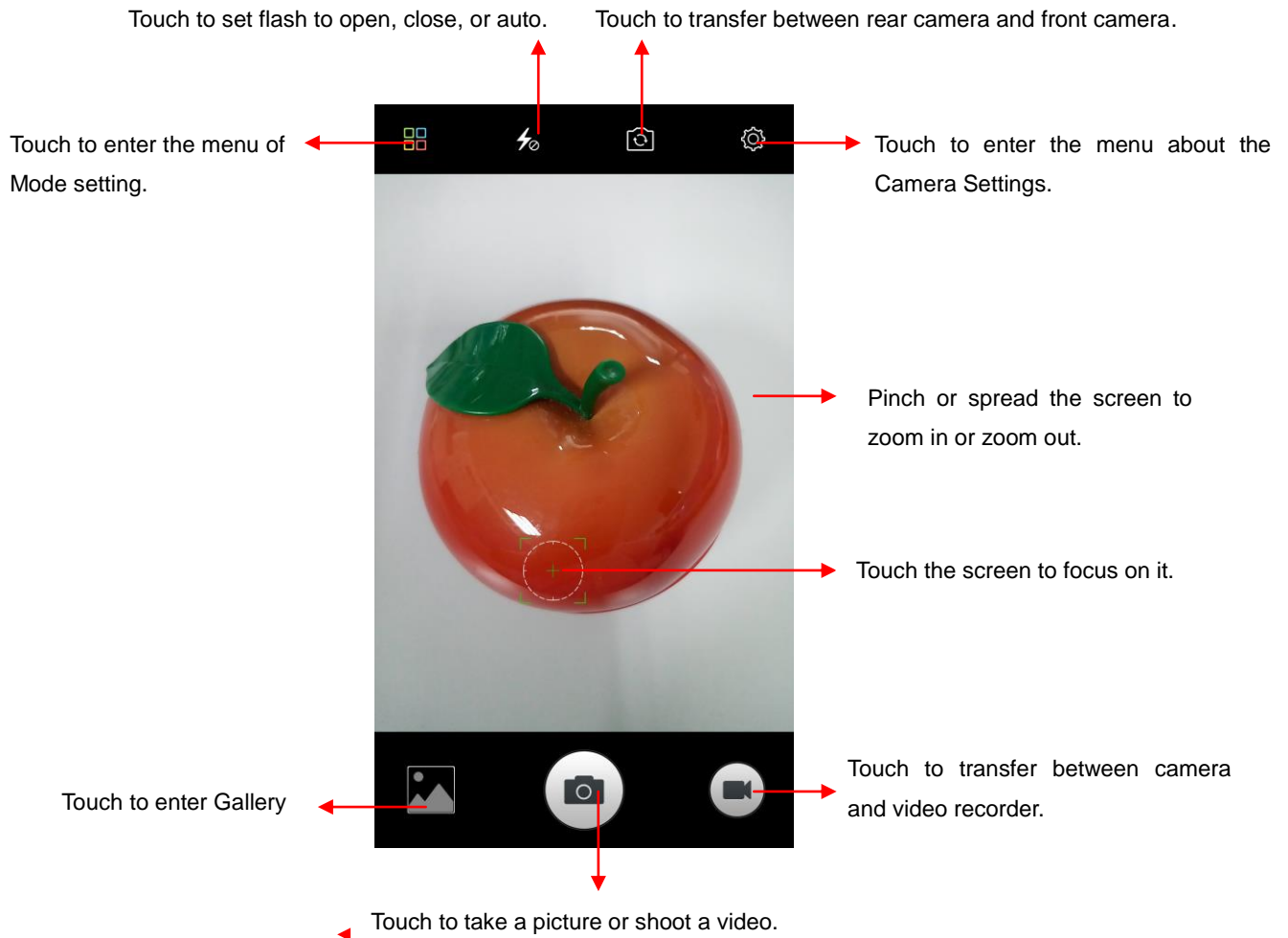

Shoot a Video

Tap video icon to transfer from camera mode to video mode. Adjust the quality and other settings if you wish. Touch video icon for shooting and pausing.

Gallery

Touch the Gallery icon in the Launcher to view albums of your pictures and videos which you've taken with camera. You may share the pictures and videos with your friends by Messaging, Email, Bluetooth and so on.

For the private photo, you can encrypt it. And save it on:

File Explorer --> File --> Phone storage --> Picture --> More --> Show hidden files --> Gallery Safe

Music

You use Music player to organize and listen to music and other audio files that you transfer to your phone from your computer.

- Hi-Fi Switch

Hi-Fi audio only effects in Headset mode. The quality of sound can be improved when you play songs in Hi-Fi mode.

- 1) **Settings-->Sound and vibration-->HIFI MUSIC** to turn it on.
- 2) Tap to “Music” icon on the home screen, and then tap “HIFI” as appointed as below to turn it on.

- ✓ Notices:

DTS function will be auto closed once you turn on the Hi-Fi function to achieve the best effect.

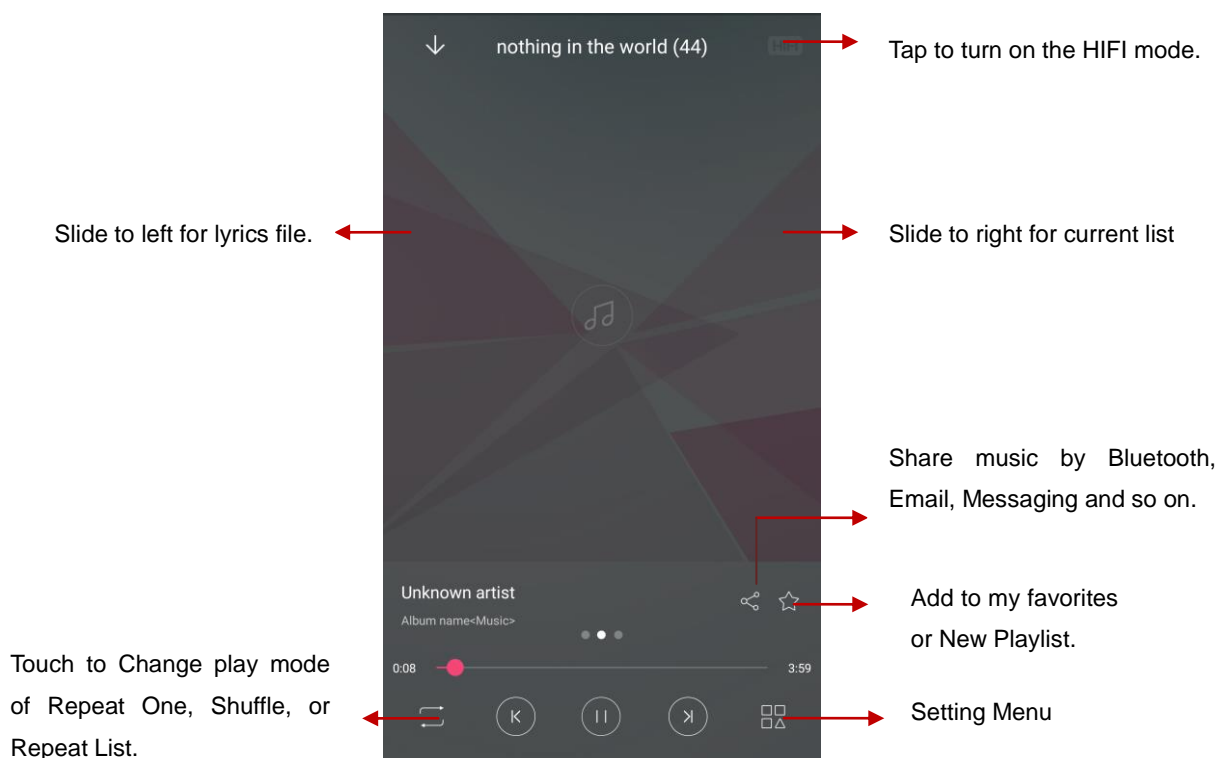

7. Connection

Your phone can connect to a variety of networks and devices, including mobile networks for voice and data transmission, WLAN data networks, and Bluetooth devices, such as headsets. You can also connect your phone to a computer, to transfer files from your phone storage, and share your phone’s mobile data connection via USB or as a portable WLAN hotspot.

Airplane mode

Settings-->Airplane mode to turn it on

Some locations may require you to turn off your phone's Cellular network, WLAN, and Bluetooth wireless connections. You can turn off all these wireless connections at once by placing your phone in Airplane mode.

Mobile Network

When you assemble your phone with a SIM card from your wireless service provider, your phone is configured to use your provider's mobile networks for voice calls and for transmitting data. Transfer data over your mobile network may result in extra fees. For more information, please contact your mobile network operator.

Settings-->Mobile Networks-->Network operators

The name of the wireless service provider you're currently registered with is selected in the list.

WLAN

WLAN is a wireless networking technology that can provide internet access at distance of up to 100 meters, depending on the WLAN router and your surroundings. You can configure the WLAN as follow:

- **Settings-->WLAN** to turn it on.

The device scans for available WLAN networks and displays the names of those it finds. Tap one of the listed networks and enter the password, if asked to join in.

Bluetooth

Bluetooth is a short-range wireless communications technology that devices can use to exchange information over a distance of about 10 meters. The most common Bluetooth devices are headphones for making calls or listening to music, hands-free kits for cars, and other portable device, including laptops and cell phones.

To send a file

Settings--> Bluetooth to turn it on.

Enter **File Explorer** to select a file, Select **Share--> Bluetooth**.

Touch **Scan for devices**, the phone will scan for and display the names of all available Bluetooth devices in range.

Touch the names of the other device in the list to pair them. After paired, the file will be sent.

To receive a file

Settings--> Bluetooth turn it on. Ensure your Bluetooth has been connected within visibility time.

You can receive files from the devices which are paired with yours. The file you received will be saved to the "Bluetooth" folder in the File Explorer.

To connect to a Handsfree device

- **Settings-->Bluetooth**, Select “**Search for devices**”;
- Turn on the Handsfree device, Select the Handsfree device in the list to pair.
- After paired, you can use the Handsfree device to listen to music and receive call.

USB

You can connect the phone to your computer with a USB cable to transfer music, pictures, and other files.

Turn on USB connection

1. Connect the phone to your computer with a USB cable.
2. Open the notification center and tap **Connected as a media device** to access files on this device.
3. Other USB options can be chosen.

Charge Phone, connected as a USB for charging.

View photos, connected as a camera to browse photos on PC only.

✓ **Notice:**

Do not disconnect the USB cable from the phone when you are transferring files. Doing so may cause data loss or phone damage.

NFC

Near field communication (NFC) is a technology of smartphones and other devices to establish radio communication with each other by touching the devices together or bringing them into proximity to a short distance.

Settings-->More-->NFC to turn it on.

- [NFC Exchange](#)
In touch with other equipment can exchange contact, picture, music, video, webpage, file and so on.
- [NFC Mark](#)
Put the NFC tag near the phone as shown. The quick settings of tag will be appeared.

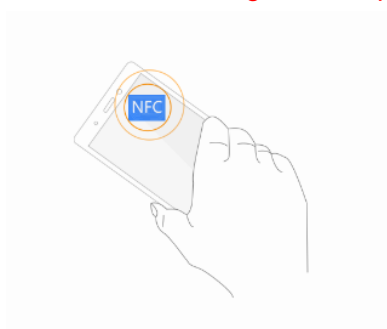

8. Advanced Functions

Fingerprint Security

You can use the fingerprint security in the rear cover to read your fingerprint instead of

enter password to unlocking in the lock screen or view the encrypted file.

- Add a fingerprint
Settings-->Security-->Fingerprint-->Put your finger on the fingerprint security and follow the instruction to repeat steps. At most 5 fingerprint data can be registered on the device.
- Rename a fingerprint
Settings-->Security-->Fingerprint-->Choose the fingerprint you want to rename and then tap it. You can name it left thumb or right forefinger for distinction.
- Delete a fingerprint
Settings-->Security-->Fingerprint-->Choose the fingerprint you want to delete and then tap it. Touch "Delete fingerprints" to delete it.

Extreme mode

Extreme mode let mobile phone enter the minimalist desktop to extend standby time. But it only available for phone, contacts, messaging and clock can be used during this time.

Access to extreme mode

- 1) **Settings--> Power Management--> Power Manager-->Select Extreme mode**
- 2) **Home screen-->Control center-->Tap Extreme mode**

Tap to exit the extreme mode

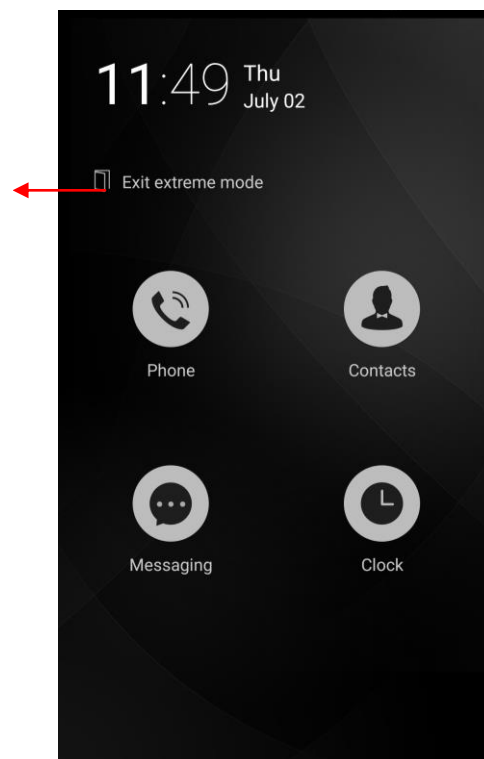

Chameleon

Color your phone. Take any scene, move the circles. Get any color randomly. The chosen

colors will come to your phone table.

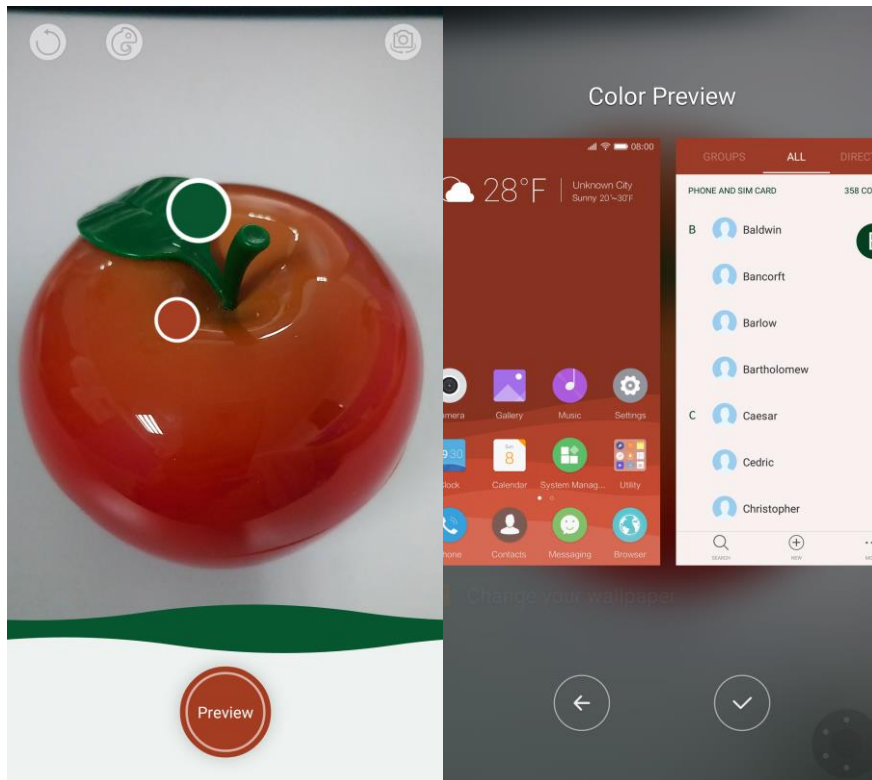

Smart Gestures

Settings-->Advanced Settings--> Smart Gestures to turn it on.

The smart gestures system supports a variety of experience and control, through gesture can be more convenient operation. Some of the smart gesture functions will not work while flip cover is closed.

- Smart dial

Settings-->Advanced Settings--> Smart Gestures --> Select Smart dial

In message content page, contacts detail page or call history details page, dial the number automatically after pick up the phone to your ear.

In contact detail page, directly dial the first number if you have many numbers.

Dual card mobile phone, please set default dial card from Settings→Dual card settings→Calls at first.

①

②

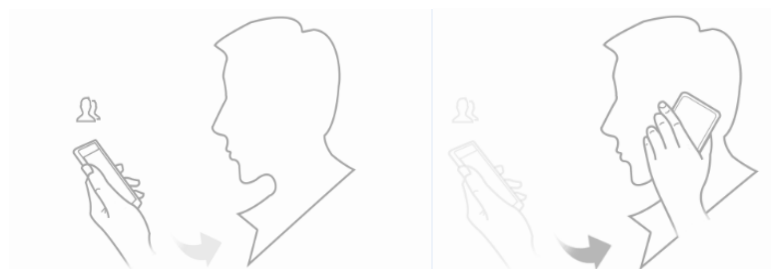

- Smart answer

Settings--> Advanced Settings--> Smart Gestures-->Select Smart answer

Pick up the phone to your ear so it will answer the incoming call automatically.

①

②



- Pause alarm

Settings--> Advanced Settings-->Smart Gestures-->Select Pause alarm

Flip back the phone to pause the on-going alarm.

①

②

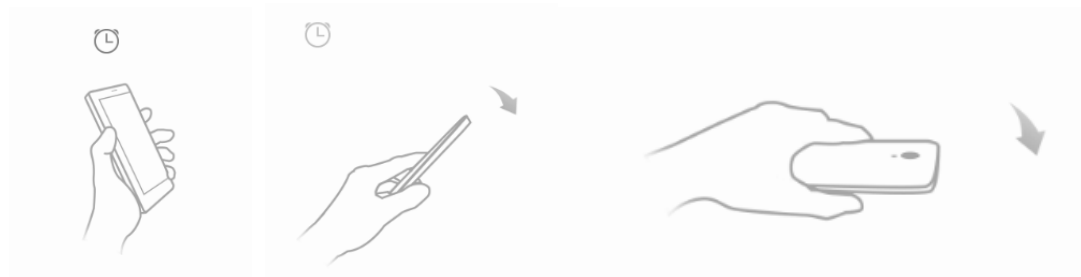

- Black screen gestures

Settings--> Advanced Settings--> Smart Gestures-->Select Black screen gestures

Draw pattern to access menu quickly while phone is in sleep mode.

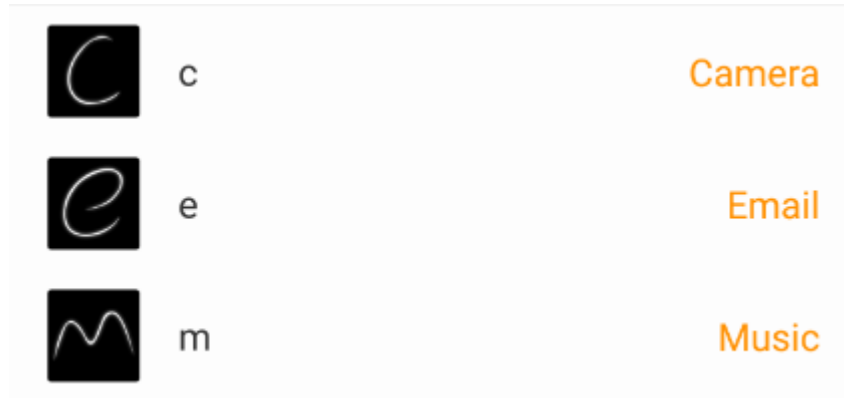

- Smart vibration remind

Settings--> Advanced Settings--> Smart Gestures-->Select Smart vibration remind

Phone vibrate to remind the unread message or missed call notification in sleep mode.

①

②

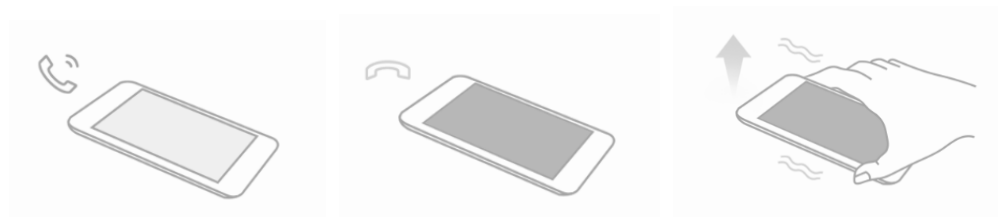

- Smart bright screen

Settings--> Advanced Settings--> Smart Gestures-->Select Smart bright screen

When front camera detects you are viewing screen, the screen can be maintained normally. Enable this function, the status bar will display this icon .

The following scenario, the function maybe failure:

- User doesn't face on the screen
- The light is too strong or too dark
- Front camera in use by other applications

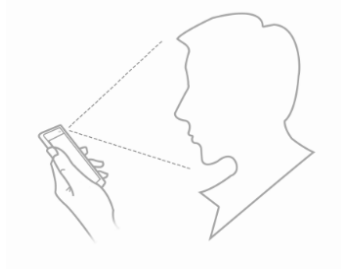

- Double click wake

Settings--> Advanced Settings--> Smart Gestures-->Select Double click wake

In sleep screen, quick double tapping can wake up the mobile phone.

①

②

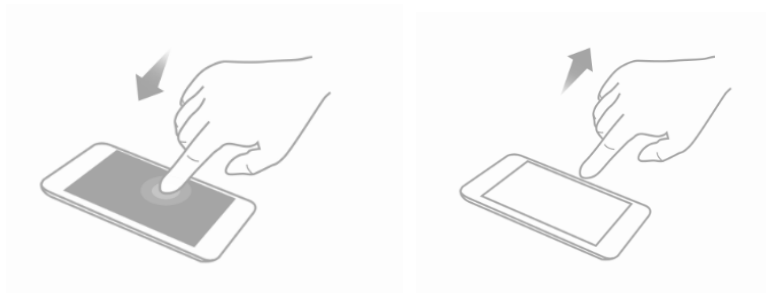

-  **Touchless wake-up**

Settings-->Advanced Settings-->Smart Gestures-->Touchless wake-up to turn it on.

You can slide to unlock, view image, control volume without touch screen.

- Air gesture

Settings--> Advanced Settings--> Smart Gestures-->Touchless wake-up -->Select Air gesture

In sleep screen, palm wave slowly over the phone can wake up the screen.

①

②

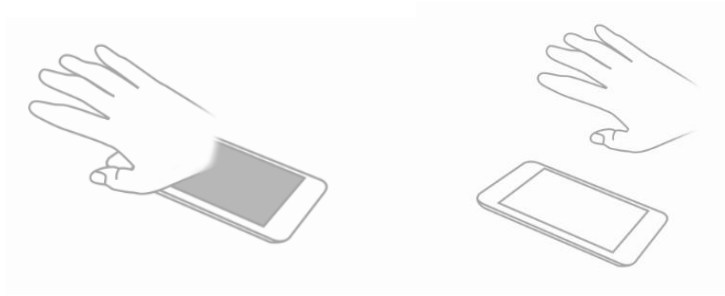

- Touchless unlock

Settings--> Advanced Settings--> Smart Gestures-->Touchless wake-up -->Select Touchless unlock

In wake-up screen, palm wave slowly over the phone can unlock the screen.

①

②

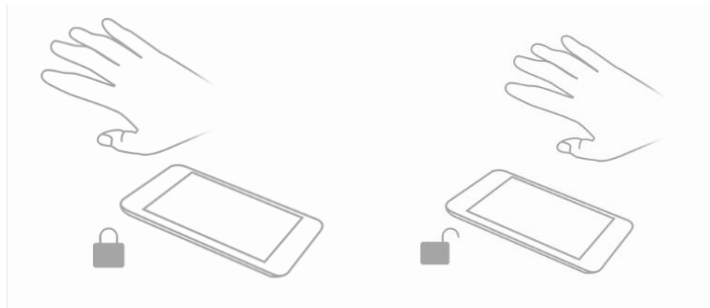

- Touchless desktop control

Settings--> Advanced Settings--> Smart Gestures-->Touchless wake-up -->Select Touchless desktop control

When it is on the system desktop mode, and a left or right waving palm to make the desktop slid to the corresponding direction.

①

②

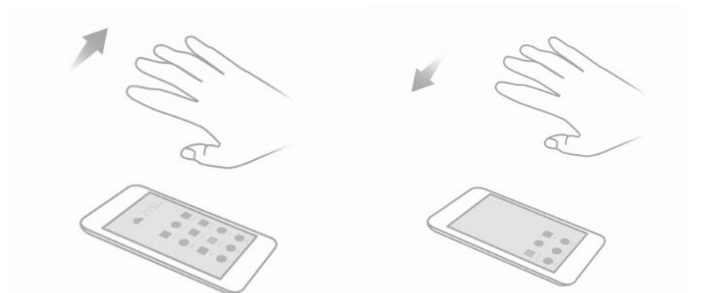

When it is on the system desktop mode, wave palm downward from the top of the mobile phone will make the screen get locked.

①

②

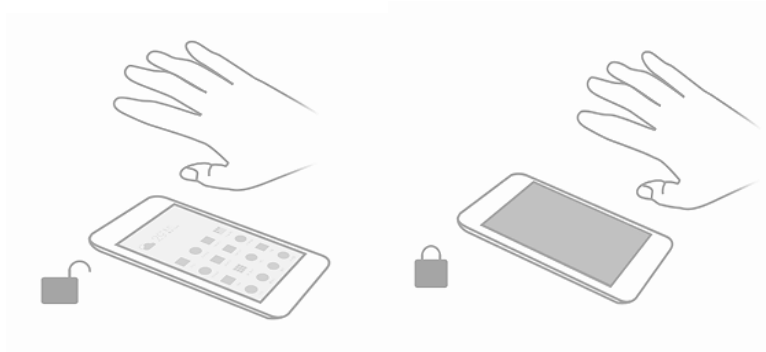

When it is on the system desktop mode, wave palm upward from the bottom of the mobile phone will go to the wallpaper view page.

①

②

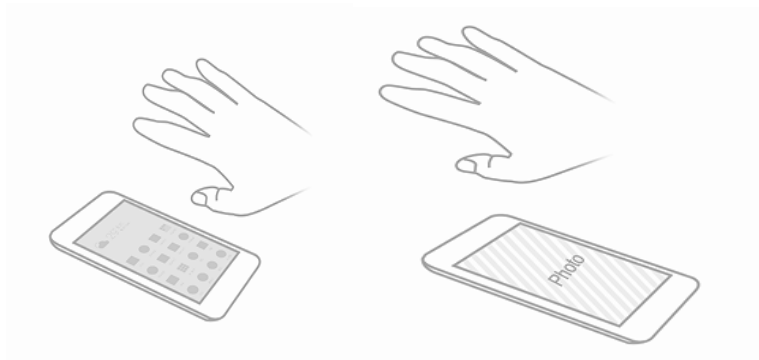

- Touchless image browsing

Settings--> Advanced Settings--> Smart Gestures-->Touchless wake-up -->Select Touchless image browsing

Wave your palm left/right slowly over the top of the phone to view the previous/next image.

①

②

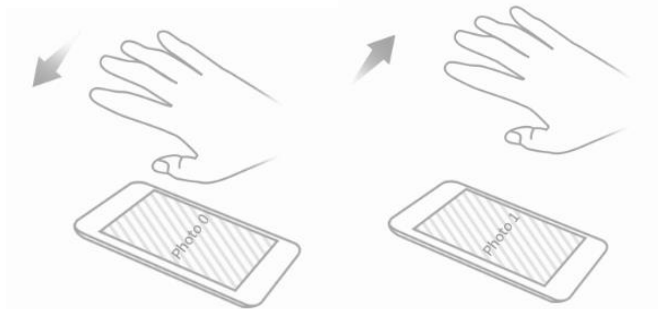

- Touchless video control

Settings--> Advanced Settings--> Smart Gestures-->Touchless wake-up -->Select Touchless video control

Wave your palm left/right slowly over the top of the phone to play/pause playing. Wave up/down to control volume up/down.

①

②

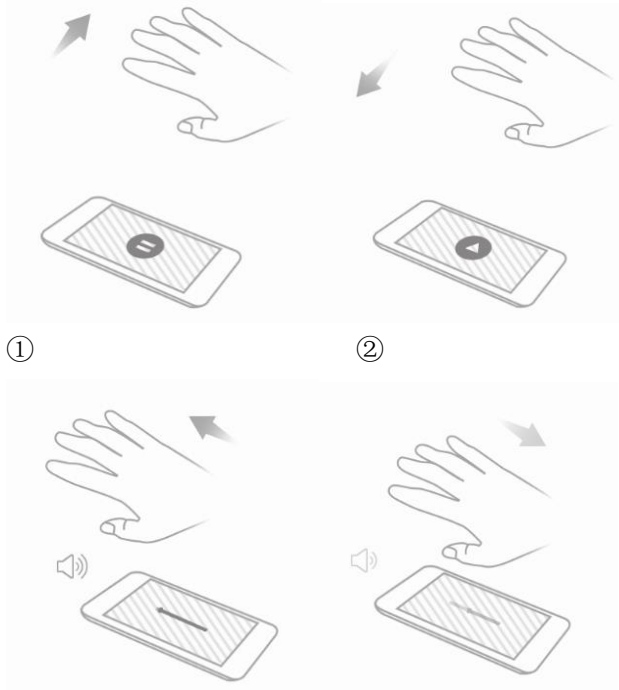

✚ Suspend option

Suspend option helps you to use the mobile phone without press the key. You can do the action just by tapping the screen.

Settings--> Advanced Settings--> Suspend option to turn it on.

Long press can be hidden in the notification bar.

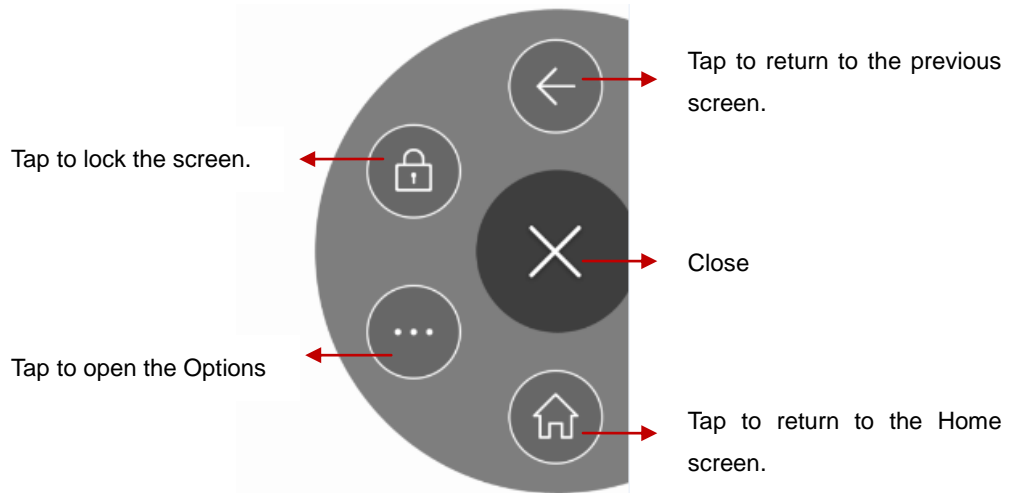

9. Warnings and notes

Operational Warnings

IMPORTANT INFORMATION ON SAFE AND EFFICIENT OPERATION. Read this information before using your phone. For the safe and efficient operation of your phone, observe these guidelines:

Potentially explosive at atmospheres: Turn off your phone when you are in any areas with a potentially explosive atmosphere, such as fueling areas (gas or petrol stations,

below deck on boats), storage facilities for fuel or chemicals, blasting areas and areas near electrical blasting caps, and areas where there are chemicals or particles (Such as metal powders, grains, and dust) in the air.

Interference to medical and personal Electronic Devices: Most but not all electronic equipment is shielded from RF signals and certain electronic equipment may not be shielded against the RF signals from your phone.

Audio Safety: This phone is capable of producing loud noises which may damage your hearing. When using the speaker phone feature, it is recommended that you place your phone at a safe distance from your ear.

Other Media Devices, hospitals: If you use any other personal medical device, consult the manufacture of your device to determine if it is adequately shielded from external RF energy. Your physician may be able to assist you in obtaining this information. Turn your phone OFF in health care facilities when any regulations posted in these areas instruct you to do so. Hospitals or health care facilities may be using equipment that could be sensitive to external RF energy.

Product statement on handling and use: You alone are responsible for how you use your phone and any consequences of its use.

You must always switch off your phone wherever the use of a phone is prohibited. Use of your phone is subject to safety measures designed to protect users and their environment. Always treat your phone and its accessories with care and keep it in a clean and dust-free place

Do not expose your phone or its accessories to open flames or lit tobacco products.

Do not expose your phone or its accessories to liquid, moisture, or high humidity.

Do not drop, throw, or try to bend your phone or its accessories

Do not use harsh chemicals, cleaning solvents, or aerosols to clean the device or its accessories.

Do not attempt to disassemble your phone or its accessories; only authorized personnel must do so.

Do not expose your phone or its accessories to extreme temperatures, minimum 32°F and maximum 113°F (0°C to 45°C).

Battery: Your phone includes an internal lithium-ion or lithium-ion polymer battery. Please note that use of certain data applications can result in heavy battery use and may require frequent battery charging. Any disposal of the phone or battery must comply with laws and regulations pertaining to lithium-ion or lithium-ion polymer batteries.

Faulty and damaged products: Do not attempt to disassemble the phone or its accessory. Only qualified personnel must service or repair the phone or its accessory. If your phone or its accessory has been submerged in water, Punctured, or subjected to a severe fall, do not use it until you have taken it to be checked at an authorized service center.

FCC Regulations:

This mobile phone complies with part 15 of the FCC Rules. Operation is subject to the following two conditions: (1) This device may not cause harmful interference, and (2) this device must accept any interference received, including interference that may cause undesired operation.

This mobile phone has been tested and found to comply with the limits for a Class B digital device, pursuant to Part 15 of the FCC Rules. These limits are designed to provide reasonable protection against harmful interference in a residential installation. This equipment generates, uses and can radiated radio frequency energy and, if not installed and used in accordance with the instructions, may cause harmful interference to radio communications. However, there is no guarantee that interference will not occur in a particular installation. If this equipment does cause harmful interference to radio or television reception, which can be determined by turning the equipment off and on, the user is encouraged to try to correct the interference by one or more of the following measures:

- Reorient or relocate the receiving antenna.
- Increase the separation between the equipment and receiver.
- Connect the equipment into an outlet on a circuit different from that to which the receiver is connected.
- Consult the dealer or an experienced radio/TV technician for help.

FCC Note:

Caution: Changes or modifications not expressly approved by the party responsible for compliance could void the user's authority to operate the equipment.

RF Exposure Information (SAR)

This phone is designed and manufactured not to exceed the emission limits for exposure to radio frequency (RF) energy set by the Federal Communications Commission of the United States.

During SAR testing, this device was set to transmit at its highest certified power level in all tested frequency bands, and placed in positions that simulate RF exposure in usage against the head with no separation, and near the body with the separation of 10 mm. Although the SAR is determined at the highest certified power level, the actual SAR level of the device while operating can be well below the maximum value. This is because the phone is designed to operate at multiple power levels so as to use only the power required to reach the network. In general, the closer you are to a wireless base station antenna, the lower the power output.

The exposure standard for wireless devices employing a unit of measurement is known as the Specific Absorption Rate, or SAR.

The SAR limit set by the FCC is 1.6W/kg.

This device is complied with SAR for general population /uncontrolled exposure limits in ANSI/IEEE C95.1-1992 and had been tested in accordance with the measurement methods and procedures specified in IEEE1528.

The FCC has granted an Equipment Authorization for this model phone with all reported SAR levels evaluated as in compliance with the FCC RF exposure guidelines. SAR information on this model phone is on file with the FCC and can be found under the Display Grant section of www.fcc.gov/oet/ea/fccid after searching on FCC ID: YHLBLUPURL.

For this device, the highest reported SAR value for usage against the head is 1.08 W/kg, for usage near the body is 1.19 W/kg.

While there may be differences between the SAR levels of various phones and at various positions, they all meet the government requirements.

SAR compliance for body-worn operation is based on a separation distance of 10 mm between the unit and the human body. Carry this device at least 10 mm away from your body to ensure RF exposure level compliant or lower to the reported level. To support body-worn operation, choose the belt clips or holsters, which do not contain metallic components, to maintain a separation of 10 mm between this device and your body. RF exposure compliance with any body-worn accessory, which contains metal, was not tested and certified, and use such body-worn accessory should be avoided.

IC Notice

This device complies with Industry Canada license-exempt RSS standard(s). Operation is subject to the following two conditions:

- (1) this device may not cause interference, and
- (2) this device must accept any interference, including interference that may cause undesired operation of the device.

Le présent appareil est conforme aux CNR d'Industrie Canada applicables aux appareils radio exempts de licence. L'exploitation est autorisée aux deux conditions suivantes:

- (1) l'appareil ne doit pas produire de brouillage, et
- (2) l'utilisateur de l'appareil doit accepter tout brouillage radioélectrique subi, même si le brouillage est susceptible d'en

This Class B digital apparatus complies with Canadian ICES-003.

Cet appareil numérique de la classe B est conforme à la norme NMB-003 du Canada.

IC: 11492A-PUREXL

IC Radiation Exposure Statement

This EUT is compliance with SAR for general population/uncontrolled exposure limits in IC RSS-102 and had been tested in accordance with the measurement methods and procedures specified in IEEE 1528 and IEC 62209. This equipment should be installed and operated with minimum distance 1.0 cm between the radiator and your body. This device and its antenna(s) must not be co-located or operating in conjunction with any other antenna or transmitter.

Cet appareil est conforme aux limites d'exposition DAS incontrôlée pour la population générale de la norme CNR-102 d'Industrie Canada et a été testé en conformité avec les méthodes de mesure et procédures spécifiées dans IEEE 1528 et IEC 62209.

Cet appareil doit être installé et utilisé avec une distance minimale de 1.0 cm entre l'émetteur et votre corps. Cet appareil et sa ou ses antennes ne doivent pas être co-localisés ou fonctionner en conjonction avec tout autre antenne ou transmetteur.