

## **BLU ARIA POD+** **Quick Guide**

## Dual-ear mode: Initial use of headsets

Take out both left and right earphones from the charging box when using it for the first time. Tear off the film. Put both earphones back into the charging box. The two earphone indicator lights is on. The headset is activated.

## Basic Operations

Automatic power on/off: Open the lid of the charging box, the headset will automatically turn on and the TWS connection is successful. The headsets automatically shut down after 3 minutes of pairing timeout. Put the earphone back into the charging box and close the charging cover. The earphone will automatically shut down after disconnecting the phone and enter the charging state.

## Product overview

1. Headsets
2. Multifunction key
3. Charging contacts
4. Sound hole
5. Microphone
6. Charging box
7. Charging interface
8. Indicator light

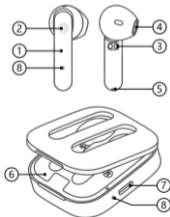

**Connection:** After the left and right earphones are paired, open the cover of the charging box, the white LED of the earphone is flashing quickly. Search for the pairing name on your mobile phone, click Connect, and the phone will have an electronic alert tone if it is successfully connected.

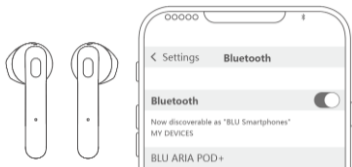

## Apparel

Please follow the diagram to penetrate the earphone into the ear, press the R<> right ear and LRR<> ear correspondence. Please rotate the headset slightly and adjust to a comfortable angle to ensure that the headset is stable and tight to prevent the headset from falling off.

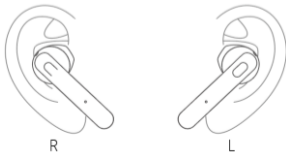

**Receive a call:** When there is an incoming call, you can double-tap either the left earphone (L) or the right earphone (R) to receive the call.

**Terminate a call:** During a call, you can double-tap the left earphone (L) or right earphone (R) to terminate the call.

**Cancel outgoing call:** When the call is made, double-tap the left earphone (L) or right earphone (R) to cancel the outgoing call.

**Music play/pause:** When the music is being played, you can double-tap the left earphone (L) or right earphone (R) to pause the music, or repeat the same action to start playing the music again.

**Previous Track:** Long touch the left earphone (L) for 3 seconds.

**Next Track:** Long touch the right earphone (R) for 3 seconds.

**Game mode:** Touch the headset 3 times to turn on the low-latency mode, accompanied by a "beep-beep" tone, repeat the operation to turn off the low-latency mode, accompanied by a "beep-beep-beep" tone.

**Automatic re-connection:** After the earphone are powered

on, they are actively re-connected to the last paired one devices.

**iOS battery level display:** After the earphone is connected to the iOS, the battery level of the earphone can be displayed.

### **Charger and Battery**

Before using any charger to charge this earphone, check whether the specifications of the charger meet requirements. The recommended output voltage of the charger is DC5V $\pm$ 0.25V, and the recommended output current is 100 mA to 500 mA. An over-high charging voltage may damage the earphone.

**Warning:** Use the recommended charger whenever possible. Use of other types of chargers may violate the warranty terms of the equipment and results in danger. If the charging cable is delivered with the earphone, connect the cable to a CCC-certified charger or computer to charge the earphone.

### **Charging the Battery**

The earphone use embedded charging battery that cannot be removed. Do not attempt to remove the battery from the earphone or the charging box;

otherwise, the earphone may be damaged. If the earphone

is not used in a long time, keep it in a cool and well-ventilated place, and charge the earphone once every two months.

1. When the white LED light of the connected headset flashes with a "beep" tone, it indicates that the headset is low on power. If you continue to use it, it will automatically shut down. At this time, you need to put the headset back into the charging box to charge.

2. If both the earphone and charging box are out of power, plug in the cable of the charger into the TYP-C USB port on the charging box, and plug the charger into the AC socket. The charging box and earphone will be charged simultaneously.

3. The earphones are charged in the charging box through two metal contacts. The white LED lights of the earphones are on when charging. It may take about 2 hours to fully charge the battery. After the battery is fully charged, the white LED lights are off. The earphones are ready for use at this time. When the charging box is charging, the white LED light flashes. It may take about 2 hours to fully charge the battery. After the battery is fully charged, the white LED light is always on. At this time, disconnect the charger from the power socket and the charging box.

4. A fully charged battery of earphone can provide about 3.9 hours of talk time, or 94 hours of standby time. The actual

talk time and standby time may vary with cell phones, settings, use methods, and environment.

### **FCC Caution.**

This device complies with part 15 of the FCC Rules. Operation is subject to the following two conditions:

- (1) This device may not cause harmful interference, and
- (2) this device must accept any interference received, including interference that may cause undesired operation.

Any Changes or modifications not expressly approved by the party responsible for compliance could void the user's authority to operate the equipment.

Note: This equipment has been tested and found to comply with the limits for a Class B digital device, pursuant to part 15 of the FCC Rules. These limits are designed to provide reasonable protection against harmful interference in a residential installation. This equipment generates uses and can radiate radio frequency energy and, if not installed and used in accordance with the instructions, may cause harmful interference to radio

communications. However, there is no guarantee that interference will not occur in a particular installation. If this equipment does cause harmful interference to radio or television reception, which can be determined by turning the equipment off and on, the user is encouraged to try to correct the interference by one or more of the following measures:

- Reorient or relocate the receiving antenna.
- Increase the separation between the equipment and receiver.
- Connect the equipment into an outlet on a circuit different from that to which the receiver is connected.
- Consult the dealer or an experienced radio/TV technician for help.

The device has been evaluated to meet general RF exposure requirement. The device can be used in portable exposure condition without restriction.