

Center of sensor coverage

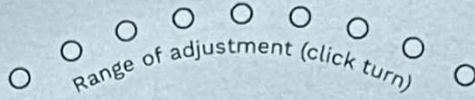

Range of adjustment (click turn)



Mini FXPORT
12V or 24V DC
Connect to Class 2 source

Match either arrow shown here
with the arrow on the twist-lock cover
plate then insert the tabs into
the slots. Twist until
ratchet action
indicates engagement.



Place MAC Address Here

NXSMDT-OMNI

US Patents: 10009979, 10299350, 10380870, 10416631, 10564613, 10783767, 11073809, 11188041

FCC ID: YH9NXSMDT-OMNI

IC: 9044A-NXSMDTOMNI



Current®

800-888-8006

Made in China

93164950



Do Not Remove Label

Center of sensor coverage



Center of sensor coverage

Range of adjustment (click turn)

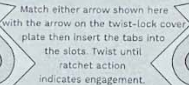

Match either arrow shown here with the arrow on the twist-lock cover plate then insert the tabs into the slots. Twist until ratchet action indicates engagement.

MAXIMUM PORT
12V 1.5A DC
Connect to power source

Place MAC Address Here

NXSM-DT-OMNI

US Patents: 10009979, 10299350, 10390870, 10416631, 10564613, 10783767, 11073809, 11188041
FCC ID: YH0NXSM-DT-OMNI
IC: 9044A-NXSM-DTOMNI

NX LIGHTING CONTROLS
Current



800-888-8006
Made in China
93164950

Do Not Remove Label

Center of sensor coverage

NX
NXSM-DT-OMNI
Lighting Control
Made in China



