

# Supplementary Remarks Photos

Size of the Tablet: 236mm(Length) \*145mm(Width)\* 12.19mm(thickness)

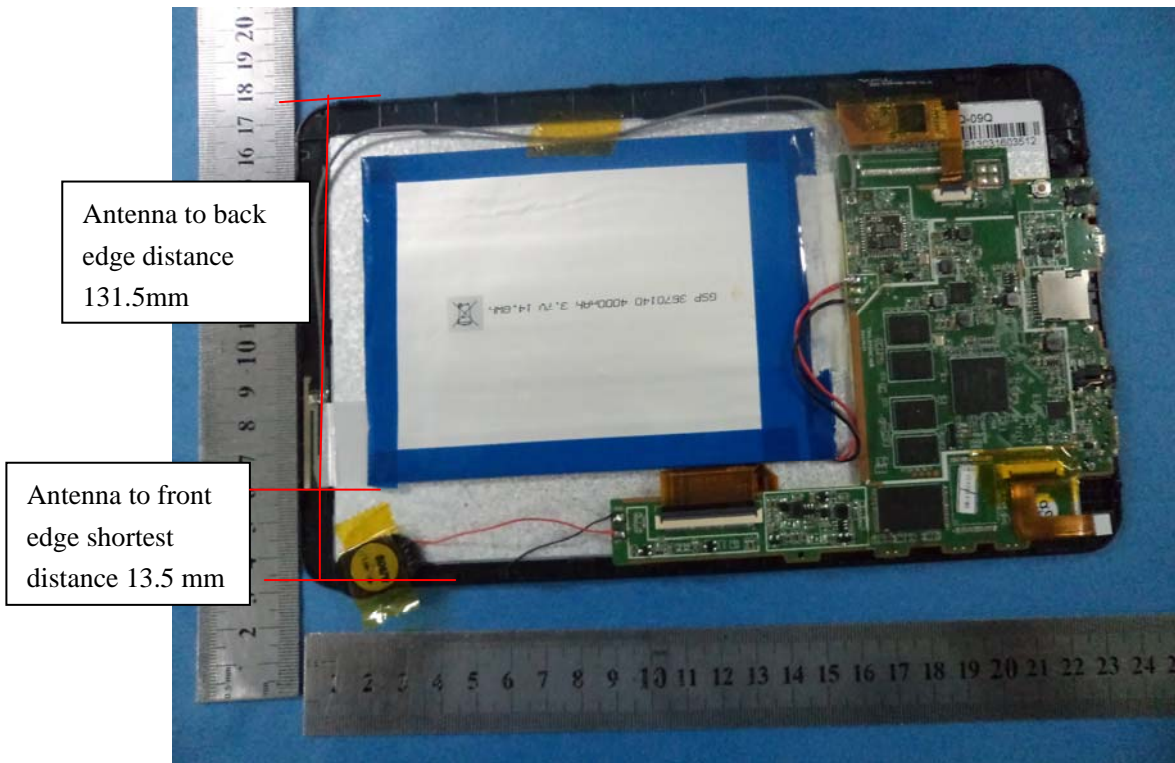

12.19mm(thickness)



Antenna to top edge exact shortest distance 5.97 mm



So Antenna to bottom edge exact shortest distance  $12.19 - 5.97 \text{ mm} = 6.22 \text{ mm}$

Antenna to side edge exact shortest distance 6mm

