

# 2JZ0102

## (Datasheet)

<b>Type</b>	MIMO Wifi antenna
<b>Specific PN:</b>	2JZ0102-008/137-UFL_013/137-UFL
<b>Frequencies</b>	WIFI / BLUETOOTH (2.4 GHz) WIFI (5.1 - 5.9 GHz)
<b>Mounting</b>	Embedded
<b>Revision</b>	00

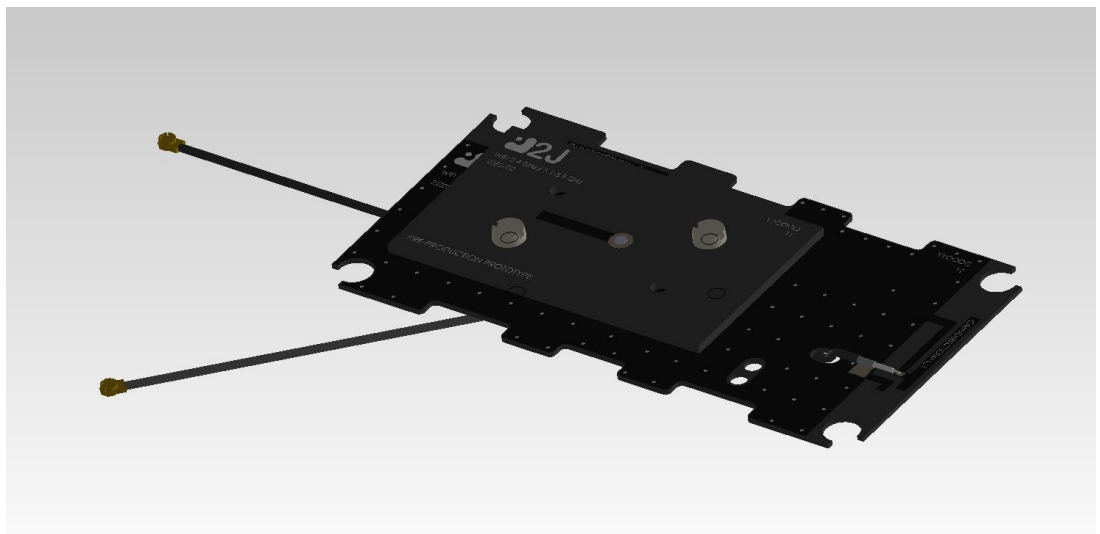

# 1. SPECIFICATION

## 1.1. Electrical Specifications

### Directional Antenna (Cable 1)

Frequencies	WIFI (2.4 GHz) WIFI (5.1 - 5.9 GHz)
Impedance	50 Ohms
Polarization	Right Hand Circular
Gain	5 dBi Peak
Efficiency	70 % max.
VSWR	<2:1
Power Handling	10 W
Cable Length	80 mm
Material	Isola FR408

### Omnidirectional Antenna (Cable 2)

Frequencies	WIFI (2.4 GHz) WIFI (5.1 - 5.9 GHz)
Impedance	50 Ohms
Polarization	Linear
Gain	2 dBi (Peak)
Efficiency	60% max.
VSWR	<2:1
Power Handling	10 W
Cable Length	130 mm
Material	FR4

### General Specification

Operating temperature	-40°C to +85°C
-----------------------	----------------

## 1.2. Connection Specifications

### Cable 1:

Connector type: UFL  
 Cable: Microcoax 1.37  
 Cable length: 80 mm

### Cable 2:

Connector type: UFL  
 Cable: Microcoax 1.37  
 Cable length: 130 mm

### 1.3. Mechanical Specifications and Dimensions

Max. dimensions: 13mm x 102,5mm x 113mm (H x W x L)  
 Weight: 18 g 'weight counted with cable above'  
 Colour: Black

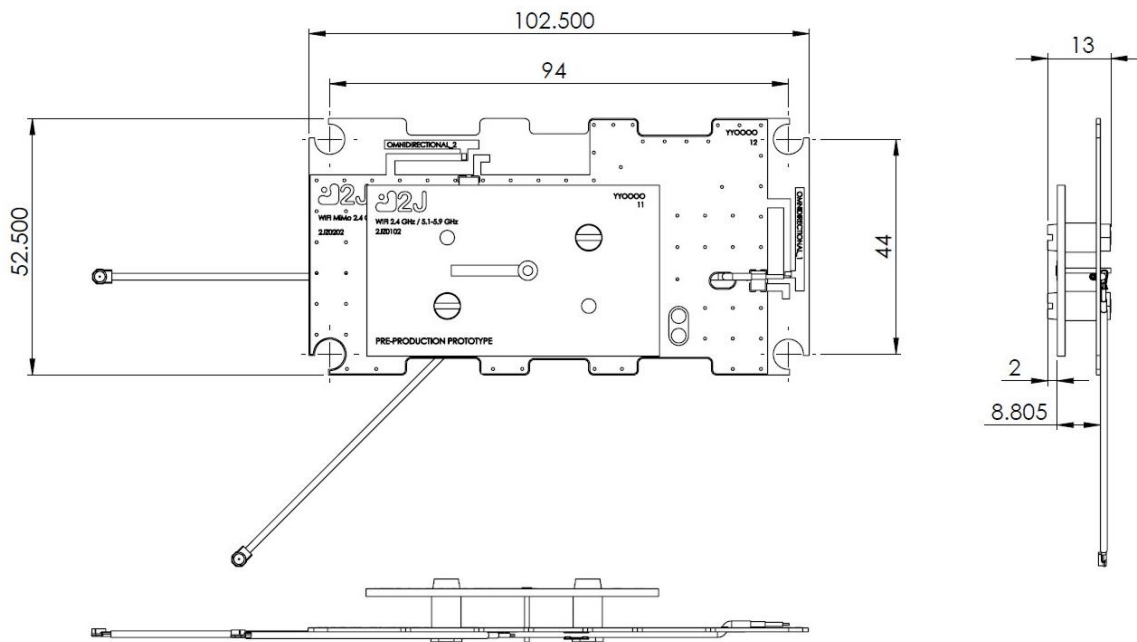

## 2. MEASUREMENT

### 2.1. Directional Antenna – Cable 1

#### 2.1.1. S11 Log Mag

Log Mag 10.00dB/ Ref 0.000dB

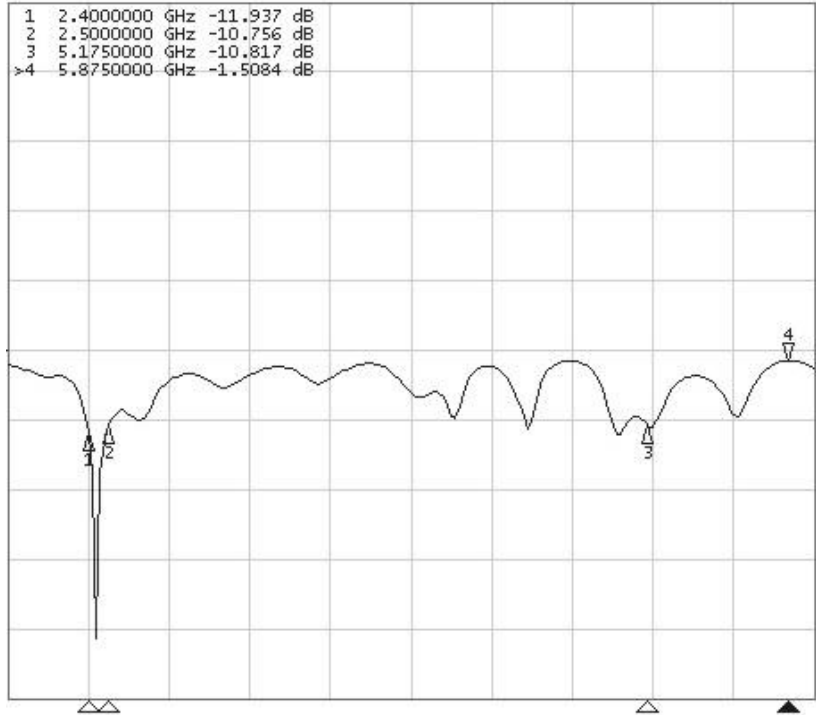

#### 2.1.2. Radiation pattern

Freq = 2.44GHz Az= 45 EL= 45

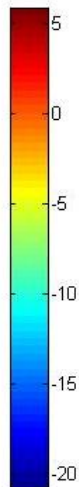
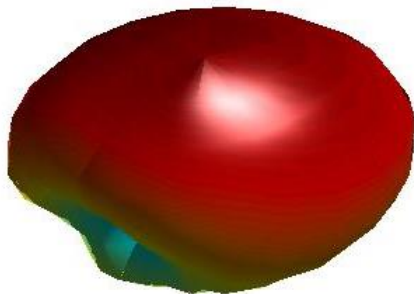

Freq = 5.8000GHz Az= 45 EL= 45

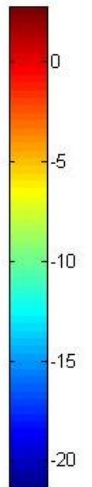
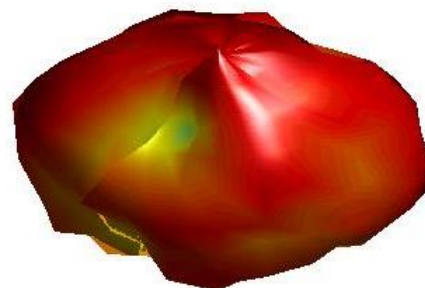

## 2.2. Omnidirectional Antenna - Cable 2

### 2.2.1. S11 Log Mag

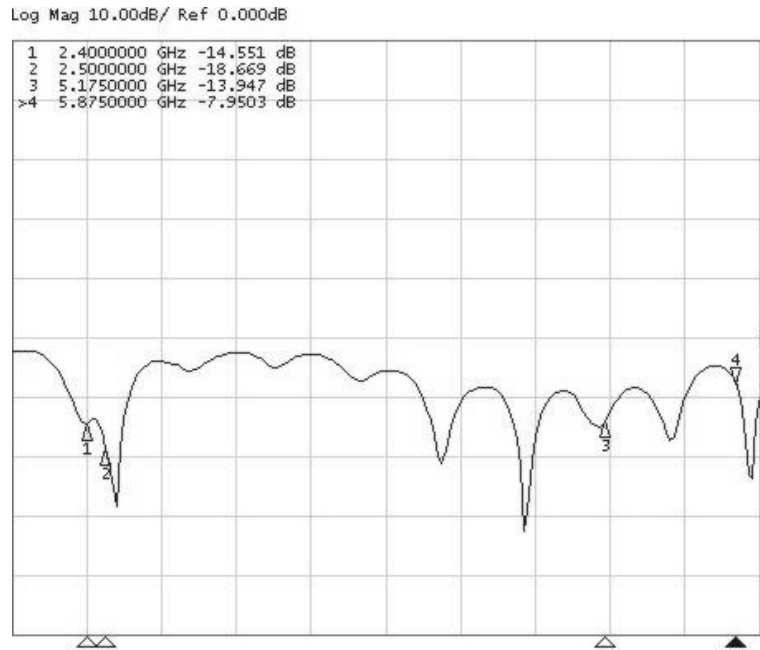

### 2.2.2. Radiation pattern

Freq = 2.44GHz Az= 45 EL= 45

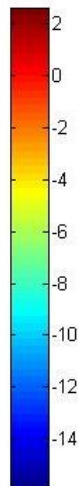
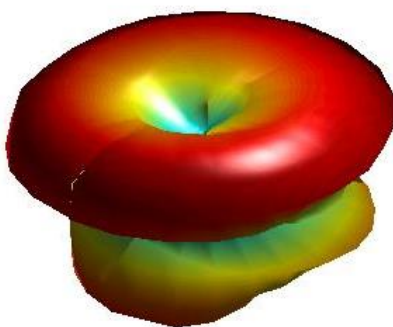

Freq = 5.8000GHz Az= 45 EL= 45

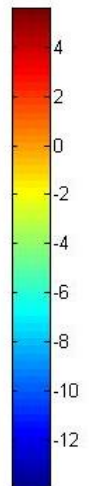
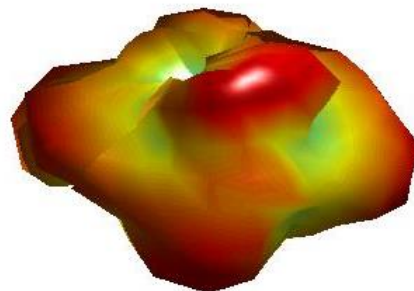

### 3. IMAGES

