

# INSTRUCTION MANUAL PROFESSIONAL WIRELESS MICROPHONE

PLL multi channel system



In uses the before, please read the instruction manual carefully and keep the instruction manual properly in order to need in the future

As the product is constantly improving, these won't be any further notice for the modification.

# UHF

## Wireless microphone system

### Foreword

Welcome to choose our company wireless microphone system, and join our term. Our company produce wireless microphone through professional design and production, with the perfect professional sound quality. We are use the advanced PLL Much channel compose technical, UHF ultrahigh frequency channel, the left and right channel afford 100pcs channel for choise respectively, it can avoide each kind disturb, let the system work more stable, transfers more credible. And infrared automatic channel tracing locking and system locking etc, these innovative designs can make you use the system more conveniently, operation simply. Our final design target is to achieve the perfet function of sound system.

### Catalog

1. Wireless receiver function.....2-3
2. Handle transmitter function.....4
3. Bodypack transmitter function.....5-6
4. Infrared of frequency.....7
5. Operation notice items.....8
6. Malfunction elimination.....9
7. Technical parameter .....10-11

## Wireless microphone system

### Wireless transmitter function

#### \* Transmitter panel board and transmitter LCD explanation

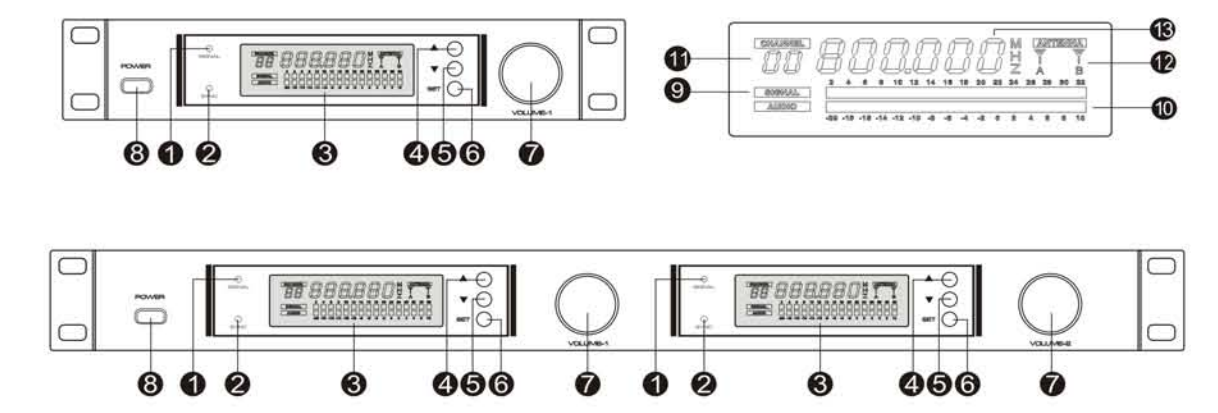

1. Signal indicator light
2. Infrared transmitter light
3. LCD :show frequency, channel, receiver signal level, sound level etc.
4. Frequency channel UP function switch(press it can control the frequency channel up, press the SET switch for confirm)
5. Frequency channel DOWN function switch(press it can control the frequency channel down, press the SET switch for confirm)
6. Confirm/match channel (SET) switch(after confirm the frequency channel, press it can go to match channel)
7. Sound knob
8. Power on-off switch: turn on the power, LCD light: press the power switch 2 second, the transmitter will be colse.
9. Signal level display
10. Audio level display
11. channel display
12. Antenna diversity choise display(choose the strong signal antenna autokinetically between A & B, reduce to use the place with no signal)
13. Frequency display

## Wireless microphone system

### Wireless transmitter function

#### Receiver back panel explanation & connect

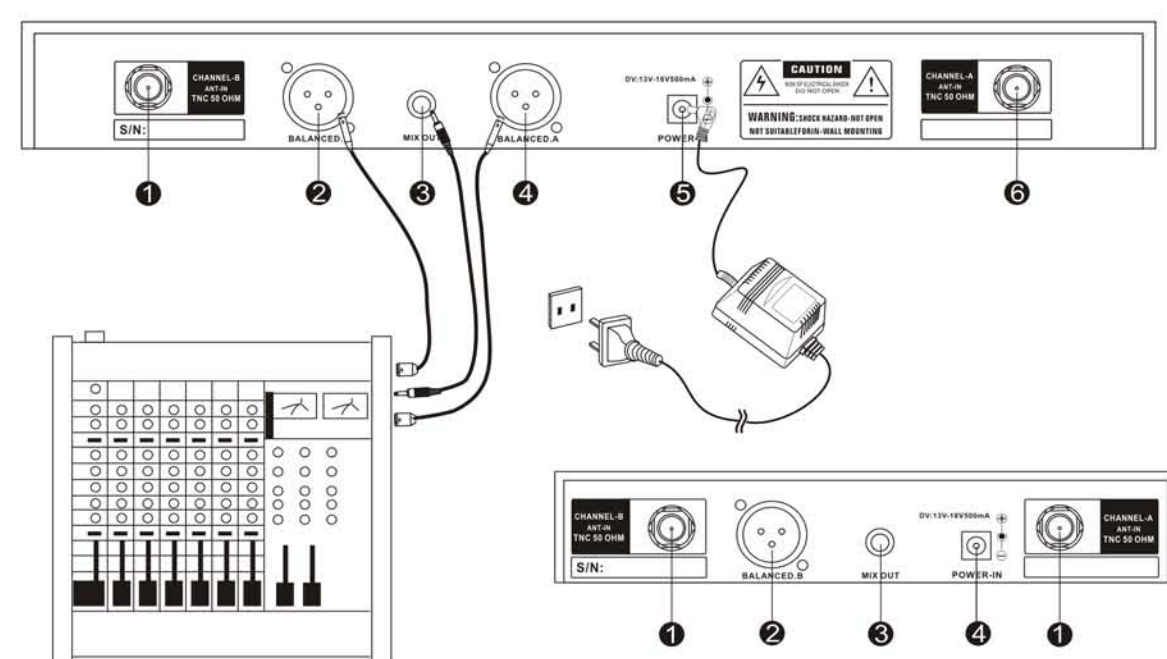

1. Antenna plug
2. Audio lever output: use XLR plug, two channel signal output respectively
3. Audio mix output: let the two signal mix together then output
4. Power plug: 13V-18V DC power input plug: the center of plug connect with positive electricity

## Wireless microphone system

### Handle transmitter function

#### \* Handle transmitter control explanation

1. Sound inlet basket
2. Power/low voltage display light
3. LCD: show frequency, channel, battery capacity
4. Transmitter switch: power switch, up or down
5. Battery position
6. IR port: match receive SET switch, send the frequency parameter to transmitter

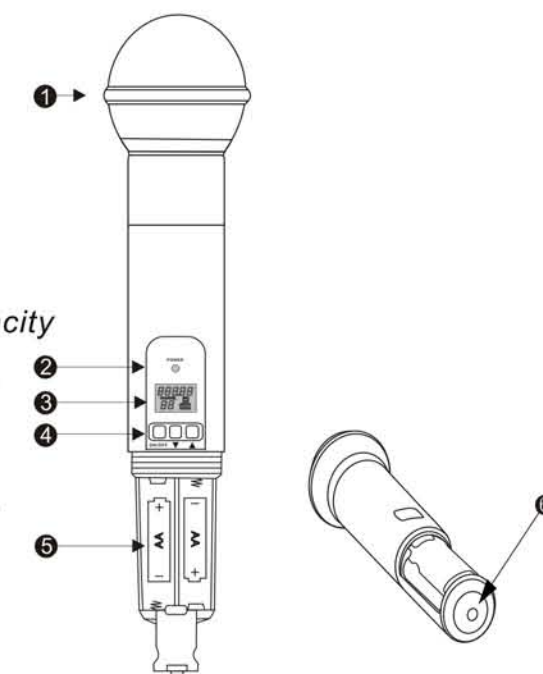

#### Transmitter change battery explanation

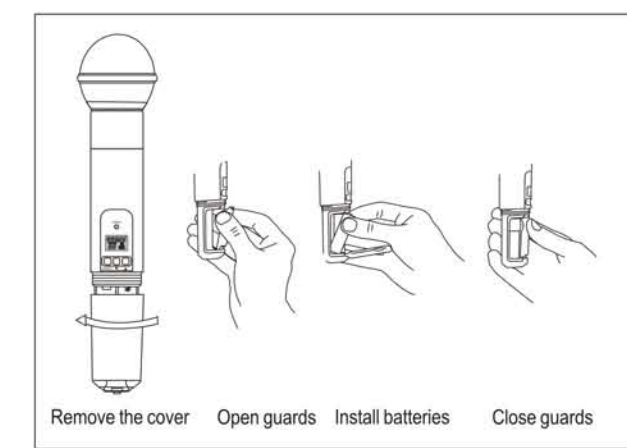

1. Take out the cover of phone battery
2. Open battery protection cover
3. Put into 2pcs battery and make sure the correct electrode
4. Close the battery cover

#### Handle transmitter LCD explanation

1. Show the current work frequency
2. Show the current work channel
3. Show the current battery capacity

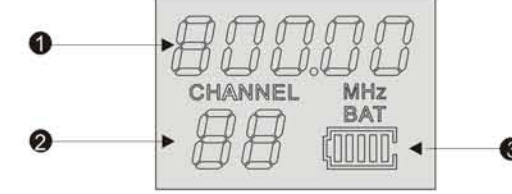

#### Handle transmitter Instructions

Keep to press the transmitter power switch then open the power, LCD show frequency, channel, battery capacity. If you need to change the channel, you should change the receiver channel, then use the transmitter aim at the IR port of receiver, and press the SET switch of receiver to operation, the new channel parameter will be send to transmitter. Or press UP & DOWN switch and the frequency of receiver, then press power switch.

## Wireless microphone system

### Bodypack transmitter function

#### \* Bodypack transmitter control explanation

1. Microphone input plug
2. Mute switch: press the mute switch (LCD show: exchange from the frequency and A/OFF), then press the close
3. Power/low voltage LCD display light. When the red light glows red, the battery teries should be replaced immediately.
4. Transmitting antenna
5. Transmitter clip: it can more easy to keep the min microphone on the belt, can be rotated 180 degrees.
6. LCD display: show the current work frequency, channel and battery capacity
7. Power switch (please keep to press more than 5 second when on or off)
8. Transmitter port: match receiver SET switch, send the frequency parameter to transmitter
9. Battery compartment: put 2pcs AA alkaline batteries
10. Down switch
11. UP switch
12. Confirm channel switch (SET)

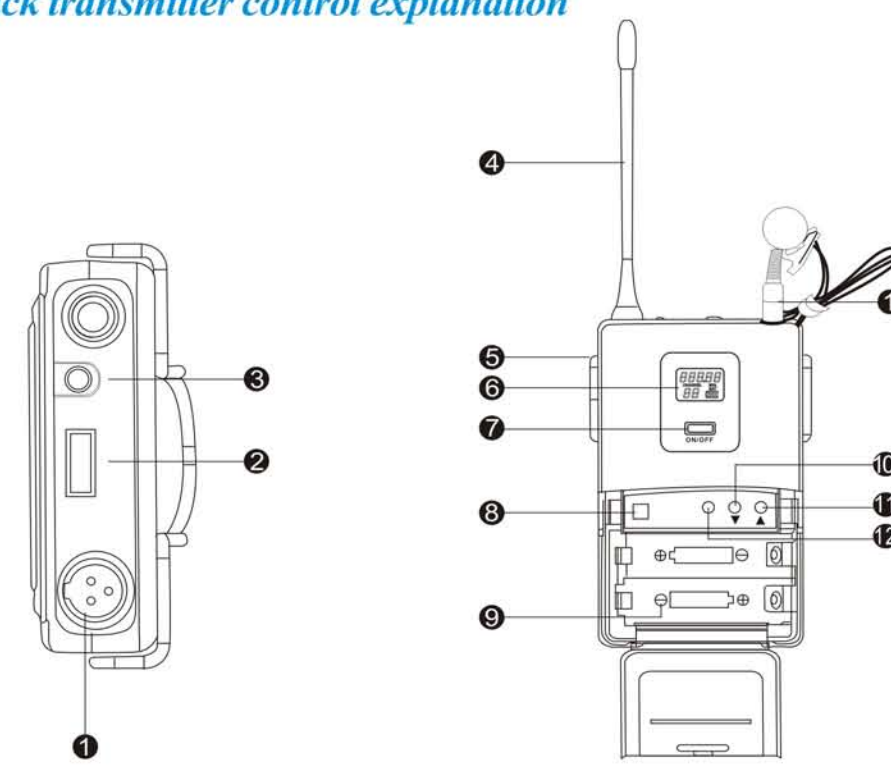

## Wireless microphone system

### \* Bodypack transmitter operation explanation

Operation way & handle transmitter

#### \* Bodypack transmitter's battery fixing

1. Press the middle of top side of battery cover then pull it down can be opened the battery compartment, as the following pictures :

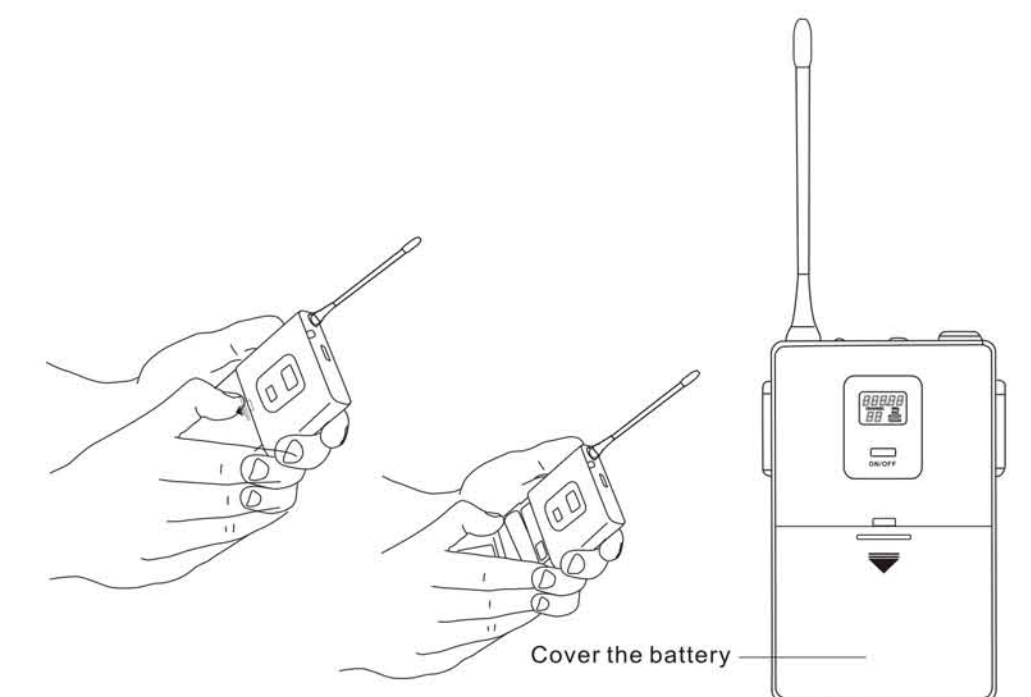

2. Put into 2pcs new AA alkaline batteries. Make sure the battery's polarity (follow the battery compartment's polarity)
3. Close the battery cover

## Wireless microphone system

### Wireless receiver function

#### \* Infrared of frequency explanation

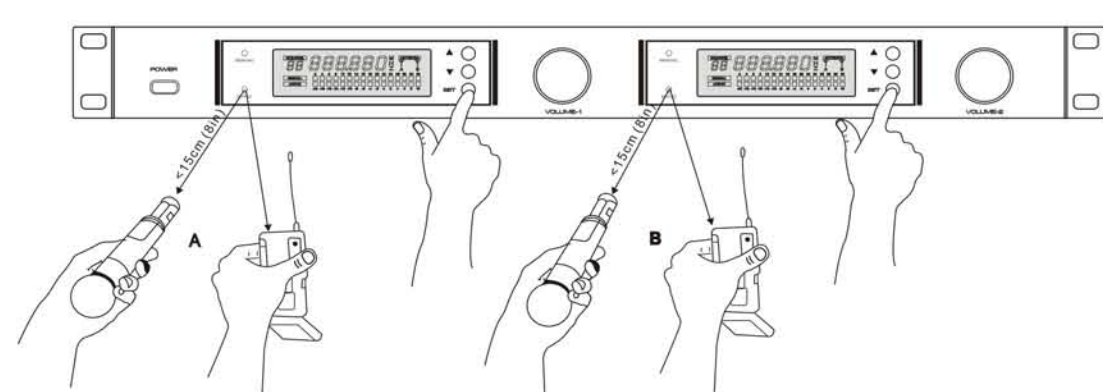

1. Open transmitter power
2. Open transmitter battery compartment, appear at the IR receiver port
3. Open receiver power
4. Press UP switch or DOWN switch, choose the channel then press SET switch for confirm
5. When the transmitter IR receiver port aim at the receiver IR, when the light glows, press the SET switch
6. A transmitter only can match the receiver A channel. B transmitter only can match the receiver B channel.
7. If there have interference when are using, please choose the channel without interference

## Wireless microphone system

### Operation notice items

- \* Should be choose the channel without any interference to use
- \* Receiver and transmitter must be set on the same channel frequency
- \* It should be have the less remoras between the receiver and transmitter, it is the best if it would be see directly.
- \* When transmitter use orientation antenna, antennae should have 0.5mm distance from the wall, at the same time should be far from any metal
- \* After use the transmitter, shoube be turn off the power. If haven't use it for long time, should be take out the battery.
- \* When use the handle transmitter, hand should be on the middle of microphone, if near the mic head, would be effect the sound effect, if near the end of antennae, would be reduce the emission efficiency, reduce the use of distance.
- \* Adjust the distance between the microphone and mouth, can be increase or decrease in high and low.
- \* Bodypack transmitter use 1/4 wave whip antenna, the antenna don't contact with human body directly, and don't wrapped around microphone connected together, otherwise it will reduce the use of results.
- \* Using the bodypack transmitter, should adjust the sensitivity depend on the power and microphone
- \* Using the Lavalier Mic, in order to reduce the sound caused by mic head rotation by ups and downs, lavalier mic should be close to the middle position, connect the microphone should also be fix, in order to avoid friction noise.
- \* When Lavalier mic for live-sound reinforcement, should use directional sound head, speaker selection and layout should be to reduce the sound feedback for principle, if necessary, should be choose feedback suppressor.
- \* Wearing microphone usually located in the corner of mouth, it can increase or decrease the high and low level through adjust the distance between the corner of mouth and mic -head.
- \* If long time no use the system, please unplug the receiver plug, take out the transmitter battery.
- \* For the plant into electronic mechanical heart or related electronic equipment should be observe the following items: any RF source in use may interfere with the normal function of such devices. All owned by the wireless microphone transmitter, its transmitter power are very small (under 0.05W output) Generally will not cause interference, particularly when the distance from wireless microphone to electronic mechanical heart more than several inch, in use of this system or any other radio frequency devices. If you encountered any problem, please contact your local dealer.

## Wireless microphone system

### Troubleshooting

Questions	Solution
Receiver haven't indication	Contact well the receiver power supply
The receiver can receive when the transmitter is not open, have redundant noise, frequency signal distortion	Remove nearby RF interference sources (as CD, computer, digital devices, ear monitoring systems etc) change the transmitter electric level through to change the different frequency from receiver and transmitter.
Receiver no sound	Check the receiver and the volume of amplification devices, check the audio connection cable.
Receiver no RF signal	Receiver should be use the same frequency with sending, check if beyond the acceptable range.
Can't open transmitter	Replace the transmitter battery.
Effective range is short	To avoid the complex environment, if there have large metal objects or brick wall between the transmitter and receive, large crowds, will be effect the effective range.

**Note:** If the fault is not in the above list, please contact the local maintenance technicians or manufacturers. Equipment can't be raining or placed in moist environment, can't be placed in places where have strong sunlight, high temperature environment, can't be collision, fling, vibration. Don't open the machine casing automatically, in order to avoid an electric shock or damage the machine, so that quality assurance failures, and maybe cause the system error control. Noted that only can using the power adapter be provided by this machine, be make sure that the power voltage Consistent with the adapter requirement, if using the power adapter supply from other supplier, it may damage the equipment.

## Wireless microphone system

### System parameters

Work frequency: 575-600MHz  
Debug mode: FM  
Adjustable range: 25MHz  
Channel Number: 100  
Channel spacing: 250KHz  
Frequency stability: ±0.005%  
Dynamic Range: 100dB  
Maximum excursion: ±45KHz  
Audio frequency response: 80Hz-18KHz (±3dB)  
Integrated SNR (signal noise ratio): >105dB  
Comprehensive Distortion: <0.5%  
Working distance: About 100mm  
Working temperature: -10°C--+40°C

### Receiver indication

Receiver mode: double-conversion superheterodyne  
intermediate frequency: 110MHz, 10.7MHz  
Antenna Access: BNC/50Ω  
Sensitivity: 12dBμV (80dB/5N)  
Spurious suppression: >75dB  
Maximum Output Level: +10dBV

### Transmitter indication

Antenna: handle microphone build-in helical antenna/bodypack transmitter use 1/4 wave whip antenna  
Output power: high-power 30mW, low-power 3mW  
Spurious suppression: -60dB  
Power supply: 2pcs No.5 AA alkaline batteries  
Battery life: 30mW about 10 hours, 3mW about 15 hours



This device complies with part 15 of the FCC rules. Operation is subject to the following two conditions: (1) this device may not cause harmful interference, and (2) this device must accept any interference received, including interference that may cause undesired operation.

NOTE: The manufacturer is not responsible for any radio or TV interference caused by unauthorized modifications to this equipment. Such modifications could void the user's authority to operate the equipment.

NOTE: This equipment has been tested and found to comply with the limits for a Class B digital device, pursuant to part 15 of the FCC Rules. These limits are designed to provide reasonable protection against harmful interference in a residential installation. This equipment generates uses and can radiate radio frequency energy and, if not installed and used in accordance with the instructions, may cause harmful interference to radio communications. However, there is no guarantee that interference will not occur in a particular installation.

If this equipment does cause harmful interference to radio or television reception, which can be determined by turning the equipment off and on, the user is encouraged to try to correct the interference by one or more of the following measures:

- Reorient or relocate the receiving antenna.
- Increase the separation between the equipment and receiver.
- Connect the equipment into an outlet on a circuit different from that to which the receiver is connected.
- Consult the dealer or an experienced radio/TV technician for help.