

# DT Research Rugged Tablet



## BASIC OPERATION GUIDE

# DT300Q11

### INTRODUCTION

Thank you for acquiring the DT311Q, part of DT Research's line of Rugged Tablets. Featuring a slim yet robust enclosure, the DT300Q11 with 11.6" TFT display is powered by the Qualcomm octa-core processor, offering optimal combinations of performance and power savings. The DT311Q is available with Android operating system. The software operating system features web browser, client/ server computing software, media player, accessories, and applications support.

### PACKAGE CONTENTS

- One DT300Q11 with Battery Pack and Handstrap
- AC-DC Power Adapter with Power Cord
- Basic Operation Guide

\* If your DT311Q contains camera or barcode scanner, please refer to the Tablet Modules Basic Operation Guide for detailed operation.

## DT311Q:



### Input/ Output Ports

- A** Headphone Jack
- B** LAN Port
- C** USB 3.0 Port
- D** USB Type-C Port (power input)
- E** USB 2.0 Port

### Button Functions

BUTTON	ACTION
<b>1</b>	power button
<b>2</b>	programmable buttons
<b>3</b>	<b>Battery Latch</b> <ul style="list-style-type: none"> <li>• Push the switch to unlock the latch, then slide the latch to left to remove the battery.</li> </ul>

## PRECAUTIONS

- Always exercise care when operating and handling the DT300Q11.
- Do NOT apply excessive pressure to the display screen.
- We recommend using the Digital Pen (optional) to keep the screen clean.
- Avoid prolonged exposure of the display panel to any strong heat source. Wherever possible, the DT300Q11 should face away from direct light to reduce glare.
- If the AC-DC power adapter is used to recharge or power the tablet, do NOT use any AC-DC adapter other than the one provided or acquired from the manufacturer or its partners.
- In the unlikely event that smoke, abnormal noise, or strange odor is present, immediately power off the DT300Q11 and disconnect all power sources. Report the problem to your device provider immediately.
- Never attempt to disassemble the DT300Q11, as this will void the warranty.

### NOTE:

To obtain protection consistent with any IP rating for the device, the I/O (audio, power, USB, card reader, etc.) port doors must be closed. If the IP protection is compromised by mishandling or misuse, such as by leaving port doors open or improperly closed, any resulting product damage will not be covered under any DT Research warranty.

## BASIC FEATURES

The DT300Q11 rugged tablet integrates a bright display, USB ports, and embedded networking elements such as wireless LAN and Bluetooth. A DT300Q11 typically integrates an 802.11ac wireless LAN (WLAN) adapter that may connect to other wireless devices or access points. If your DT300Q11 does not come with such a network adapter, please consult your device provider to establish the desired network connectivity.

# OPERATION

## Powering ON and OFF

To activate the DT300Q11, push and quickly release the Power Button. The display will come on in a few seconds. To put the DT300Q11 in Standby mode, push and quickly release the Power Button. To turn the DT300Q11 off for extended storage, power off safely using any software function that “shuts down computer” provided in the software operating system.

### NOTE:

The battery pack shipped with your tablet may be low in power—please use the AC-DC adapter with the DT300Q11 when setting up for the first time to fully charge the battery pack, or use the optional battery charger kit.

### NOTE:

When the battery pack is charging, the blue-colored Battery LED should blink slowly. If plugging in the AC-DC adapter does not trigger this blinking activity and the LED stays dark, the battery pack(s) may have been drained substantially. Try unplugging/ replugging the AC-DC adapter to the DT300Q11 a few times to activate the charging process.

### NOTE:

To conserve power, use (push and quick release) the Power Button to put the tablet in “Standby” mode while not in use. Pushing briefly on the same button will wake up the system within seconds.

## Start Up

If the power up (from Standby mode or otherwise) is successful, the appropriate interface will be displayed after a launch sequence of several seconds. The wireless LAN connection may take 10-15 seconds to be established.

## Configuring the Mobile Tablet

The DT300Q11 may be configured using the utilities and methods dictated by the software operating system. The DT300Q11 should be configurable for various properties such as user profiles, network features, and several system elements.

## Wireless Networking

### Wireless LAN

The DT300Q11 is often delivered with an embedded (user-inaccessible) 802.11ac WLAN adapter equipped with a hidden custom antenna.

- Through the support of typical WLAN adapters, the DT300Q11 should be able to detect all 802.11 access points in the vicinity for you to select the access point of your choice for connection.
- The SSID and WEP/WPA/WPA2 (if enabled) parameters on the DT300Q11 and the access points have to match. The SSID is case-sensitive and it is recommended that you enable WEP/WPA/WPA2 encryption (or advanced alternatives) for secure access.
- When WEP/WPA/WPA2 is enabled, you may need to consult your network administrator or your networking equipment literature to properly configure associated settings such as Authentication mode, etc.
- Refer to the access point operating manuals for setting up the 802.11 access points.

## Bluetooth

The Bluetooth configuration application is enabled from the Android Settings APP. Follow the instructions and options provided within the application to configure and invoke Bluetooth connectivity with the corresponding peripherals.

# USING THE MOBILE TABLET

## Peripherals Support

Through its USB ports, the DT300Q11 supports a wide range of USB-based peripherals. These peripherals are applicable for software installation, applications storage, data storage, and system software recovery and updates.

## Peripherals Support

1. Slide the battery latch to the unlocked position.
2. Lift the battery pack off the compartment.
3. Fit another battery pack into place.
4. Slide the latch to the locked position.
5. If you want to purchase extra battery packs, please contact your dealers, or visit our Support page:  
<https://www.dtresearch.com/en/Support/contact.html>

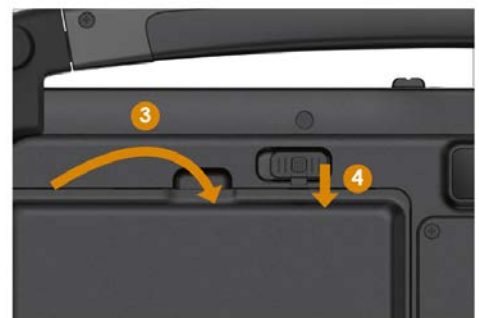
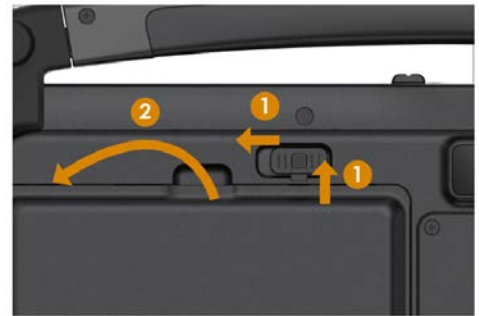

### CAUTION:

There is danger of explosion if the battery is incorrectly replaced. Replace the battery only with the Tablet manufacturer's battery. Discard used batteries according to the dealer's instructions.

### CAUTION:

Do not attempt to disassemble the battery pack.

## For More Support

Users can download the Tablet Modules Basic Operation Guides from the DT Research website.



### **To Hold the Tablet**

Left hand: grip the left back side of the tablet with your left hand four index fingers, with thumb resting on the top of the back side of the tablet and palm securely against the back.

Right hand: grip the right back side of the tablet with your right hand four index fingers, with thumb resting on the top of the back side of the tablet and palm securely against the back.

## Specifications:

Item	DT300Q11
<b>System</b>	
CPU	Qualcomm Octa-Core, 2.0GHz
RAM	4GB
Storage	64GB
Operating System	Android 9.0 and 10
Display	11.6" LED-backlight, high-brightness (1000 nits) screen with capacitive touch, outdoor viewable
Display Resolution	1920 x 1200
Network Interface	Wi-Fi 802.11ac, 2.4GHz/ 5GHz dual band; Bluetooth 4.2 LE
Control Switch and Buttons	1 power button, 2 brightness control buttons, 5 programmable buttons
Indicator	1 power/ battery status LED
Speaker	Built-in speaker
<b>I/O Ports</b>	
USB port	USB 2.0 x 1, USB 3.0 x 1, USB Type C x 1 (data transmitting and charging)
Headset Jack	1 (3.5mm)
SD Slot	1 micro SD card slot
Ethernet	Ethernet 10/ 100/ 1000MB Base-T LAN
<b>Mechanical and Environmental</b>	
AC/DC Adapter	<b>Input:</b> 100 – 240V AC; <b>Output:</b> 20V DC, 3.25A
Battery Pack	Hot swappable battery, 7.6V, 6000mAh
Enclosure	ABS + PC plastics and magnesium-aluminum alloy
Dimensions (H x W x D)	8.3 x 12.4 x 0.86 in/ 212 x 316 x 21.9 mm
Weight	3.5 lbs/ 1.6 kg
Regulatory	FCC Class B, CE, RoHS compliant
Operating Temperature	Operation: -10°C to 50°C (-14°F to 122°F) Storage: -55°C to 70°C (-67°F to 158°F)
Humidity	0% – 90% non-condensing

### FCC Regulatory Compliance

Warning: changes or modifications not expressly approved by the party responsible for compliance could void the user's authority to operate the equipment.

Note: This equipment has been tested and found to comply with the limits for a Class B digital device, pursuant to Part 15 of the FCC Rules. These limits are designed to provide reasonable protection against harmful interference in a residential installation. This equipment generates, uses and can radiate radio frequency energy and, if not installed and used in accordance with the instructions, may cause harmful interference to radio communications. However, there is no guarantee that interference will not occur in a particular installation.

If this equipment does cause harmful interference to radio or television reception, which can be determined by turning the equipment off and on, the user is encouraged to try to correct the interference by one or more of the following measures:

- Reorient or relocate the receiving antenna.
- Increase the separation between the equipment and receiver.
- Connect the equipment into an outlet on a circuit different from that to which the receiver is connected.
- Consult the dealer or an experienced radio/TV technician for help.

### RF Exposure Compliance

This equipment complies with FCC radiation exposure limits set forth for an uncontrolled environment.



The device has been tested for use against the body with 0mm separation in Specific Absorption Rate (SAR) testing.

User must follow the specific operating instructions for satisfying RF exposure compliance. This transmitter must not be co-located or operating in conjunction with any other antenna or transmitter.

This device complies with Part 15 of the FCC Rules. Operation is subject to the following two conditions: (1) this device may not cause harmful interference, and (2) this device must accept any interference received, including interference that may cause undesired operation.

Supplier's Declaration of Conformity

47 CFR § 2.1077 Compliance Information

**Unique Identifier** Trade Name  Model No.: DT300Q11

**Responsible Party – U.S. Contact Information**

**DT Research, Inc.**

2000 Concourse Drive, San Jose, CA 95131

<http://www.dtresearch.com>

**FCC Compliance Statement**

This device complies with Part 15 of the FCC Rules. Operation is subject to the following two conditions: (1) This device may not cause harmful interference, and (2) this device must accept any interference received, including interference that may cause undesired operation.

FCC ID Label is in battery compartment, it could be easily found by removing the battery cover.

**RF Exposure Information(RED)**

This device was tested for typical body-worn operations. To comply with RF exposure requirements, a minimum separation distance of 0cm must be maintained between the user's body and the handset, including the antenna. The band 5150-5350 MHz for this device are restricted to indoor use only within all European Union countries.

Hereby, [DT Research, Inc.] declares that the radio equipment type [DT300QY01] is in compliance with Directive 2014/53/EU. The full text of the EU declaration of conformity is available at the following internet address:

<http://www.dtresearch.com>.



**DT Research, Inc.**

2000 Concourse Drive, San Jose, CA 95131 <http://www.dtresearch.com>

Copyright © 2020, DT Research, Inc. All Rights Reserved.