

Manufactured by:



XXXXXXXX XXXXX XXXXX X XXXX XXX XXX XXX



PART NO. X XXX XXX XXX

Production Date: XX.XXXX

Mounting Screws

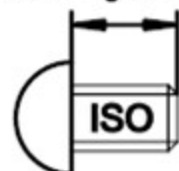

M5x8 max.



LASER CLASS 1

NISSAN PART NO.

XXXXXXXXXXXX

Model name: XXXXXXXXXXXX

DNN: XXXXXX

MH:XXX

HW:XXX

SW:XXXX

Index:X

CNC ID: C-16073

Anatel: XXX-XX-XXXX

NOM



IF:XXXXXXXXXXXXXXXXXXXXX
Marca: Bosch Modelo:XXXXXXXXX

FCC ID: YBN-LCN2K70D10

This device complies with Part 15 of the FCC Rules.

Operation is subject to the following two conditions:

- (1) this device may not cause harmful interference, and
- (2) this device must accept any interference received, including interference that may cause undesired operation.

TRA
REGISTERED No:
XXXXXXXXXX/XX
DEALER No:
XXXXXXXXXX/XX



TRC/XXX/200X/XXX

Complies with 21 CFR 1040.10 and
1040.11

Complies with 21 CFR Chapter 1,
Subchapter J

F1c grease
+
Switch PCB (cete)

D-Sample

Part can only be used for trial builds and must not be used for mass production.

Manufactured by:
BOSCH

XXXXXXXX XXXXX XXXXX X XXXX XXX XXX XXX

X

PART NO. X XXX XXX XXX

Production Date: XX.XXXX

Mounting Screws



NISSAN PART NO.
XXXXXXXXXXXX



Model name: LCN2K70D10
DNN: XXXXXX
MH:001 HW:051
SW:FD62 Index:H
CNC ID: C-16073
Anatel: XXXX-XX-XXXX



FCC ID: YBN-LCN2K70D10
This device complies with Part 15 of the FCC Rules.
Operation is subject to the following two conditions:
(1) this device may not cause harmful interference, and
(2) this device must accept any interference received,
including interference that may cause undesired operation.

TRA REGISTERED No. XXXXXXXXXX
DEALER No. XXXXXXXXXX



Complies with 21 CFR 1040.10 and 1040.11

TRC/XXX/200X/XXX

Complies with 21 CFR Chapter 1, Subchapter J