

USER MANUAL

Key Function On Receiver

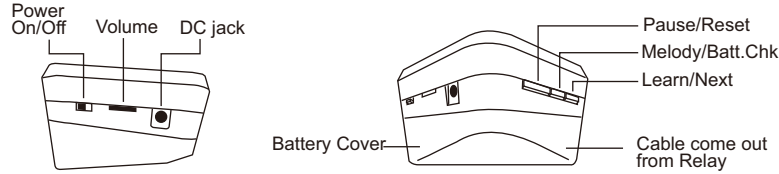

Power on/off : To switch on or switch off the receiver using this switch.

Volume: To adjust the volume level by rotating volume

DC jack: The AC/DC adaptor plug to this jack

Pause/Reset: Pause - Temporarily stop the receiver bypass and hold this button 3 sec.

Reset - Clear the sound and light on the receiver by press this button once

Melody / Batt. chk: See the chapter of **learn** and **Check which sensor in battery low**

Learn/Next: See the chapter of **learn** and **Check which sensor in battery low**

Bottom on Receiver

Remove the battery cover for setting the connection / time delay.

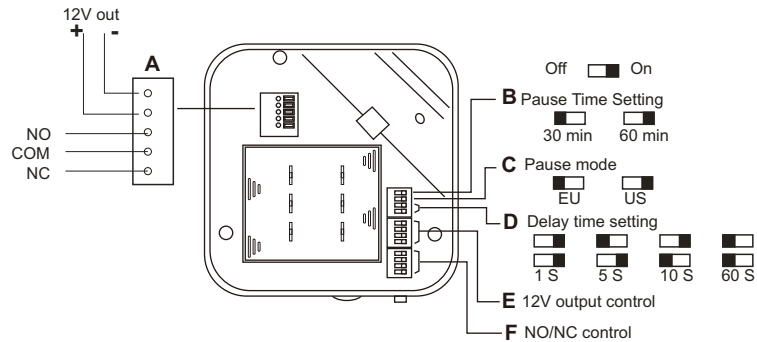

A Output terminal: Connect to the device that you wanted control, such as Gate opener, Door release or external alarm speaker

--- **12V out** : this terminal output 12v 300mA when the select zone has been trigger. (This terminal can not output 12V when using the backup battery.) This output cooperate with "E". you can select which zone relayed to this output by slide the DIP witch 1,2,3,4 on or off.

--- **NO** (Normal Open): this terminal output short circuit when the select zone has been trigger.

--- **NC** (Normal Close): this terminal output open circuit when the select zone has been trigger. The NO and NS outputs cooperate with "F". you can select which zone relayed to these output by slide the DIP witch 1,2,3,4 on or off.

B. Pause timer setting: Select the pause time 30 min or 60 min

C. Pause mode: EU mode: auto turn on when the pause time is over.

US mode: the receiver generat a beep tone when the pause time is over.

D. Delay time setting: These switch adjust the output time of the output terminal.

E. 12V output control: To choose which zone connect to the 12V output.

F. NC/NO output control: To choose which zone connect to NO/NC output.

Indications on Receiver

* **AC Power Operate**: Light up blur LED while using AC adaptor

* **Back up Battery Operate**: Light red LED while operated by battery

* **RX Battery Low**: Flashes red LED with 0.3 sec. On / 5 sec. Off and sounds "beep" every half minute

* **Remote Sensor Battery low**: Flash red LED with 0.3 sec. On / 5 sec. Off and sound "beep"

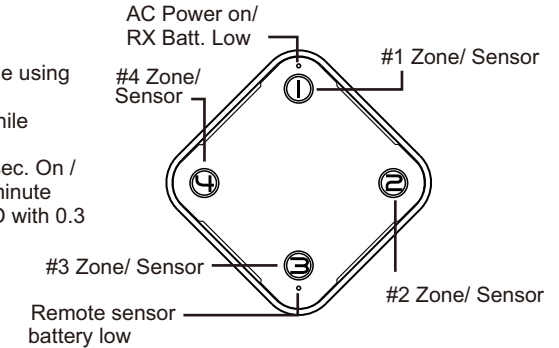

Power & Setting

Although this receiver operate with AC/DC adaptor, we still need to install battery for backup.

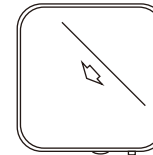

Slide to open the battery cover

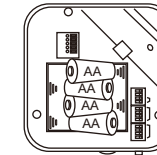

Install the 4 AAA batteries into the battery compartment as the indication on the compartment

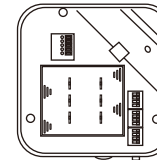

Adjust the dip switch as you need and Connect the wire to the device that you want to control

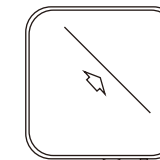

Replace the battery cover

The main power of this unit is 12V/500mA AC/DC adaptor

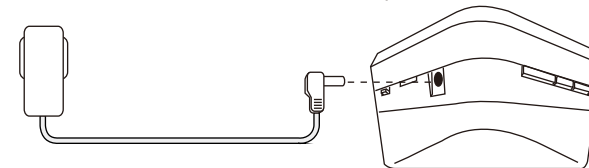

FCC Statement:

This equipment has been tested and found to comply with the limits for a Class B digital device, pursuant to part 15 of the FCC Rules. These limits are designed to provide reasonable protection against harmful interference in a residential installation. This equipment generates, uses and can radiate radio frequency energy and, if not installed and used in accordance with the instructions, may cause harmful interference to radio communications.

However, there is no guarantee that interference will not occur in a particular installation. If this equipment does cause harmful interference to radio or television reception, which can be determined by turning the equipment off and on, the user is encouraged to try to correct the interference by one or more of the following measures:

* Reorient or relocate the receiving antenna.

* Increase the separation between the equipment and receiver.

* Connect the equipment to an outlet on a circuit different from that to which the receiver is connected.

This device complies with part 15 of the FCC rules. Operation is subject to the following two conditions: (1) This device may not cause harmful interference, and (2) this device must accept any interference received, including interference that may cause undesired operation.

Note: Modifications to this product will void the user's authority to operate this equipment.

Switch inside the transmitter

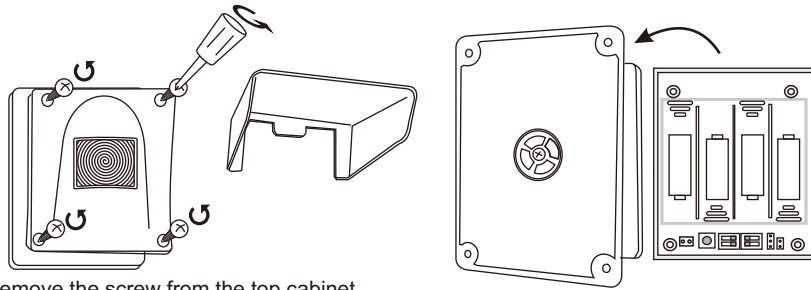

Remove the screw from the top cabinet.

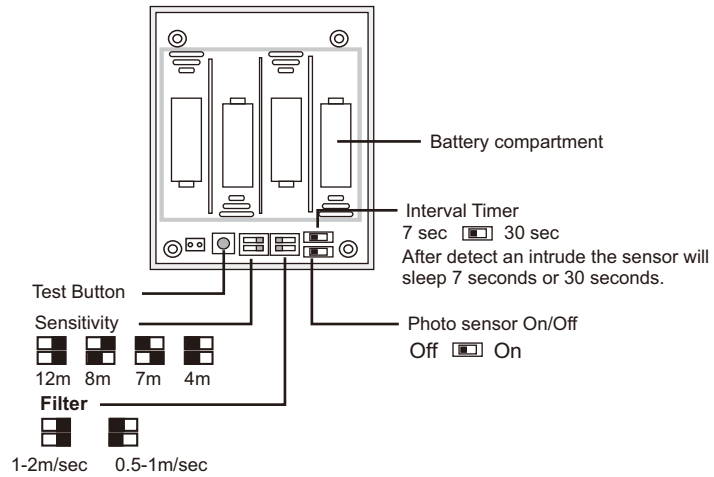

Battery Installation

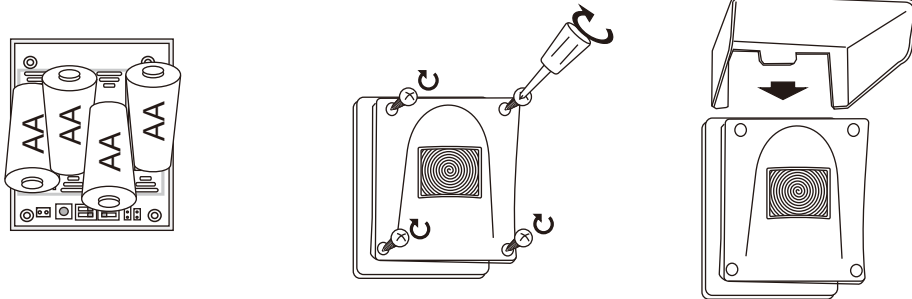

Install the 4 AA batteries into the battery compartment as the indication on the compartment

Replace the cover and lock screw

Replace the sun blocker

Installation

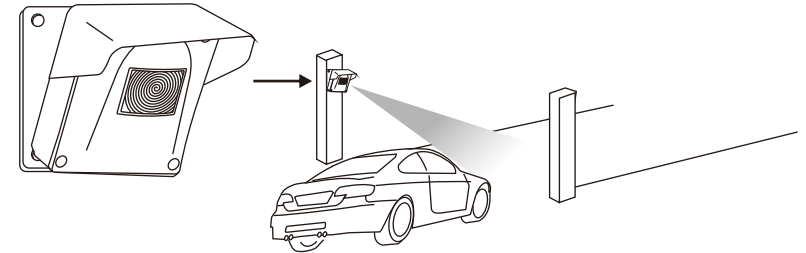

Mount the transmitter on the wall 1.5m from the ground and slightly toward the ground and point to the target sensing area.

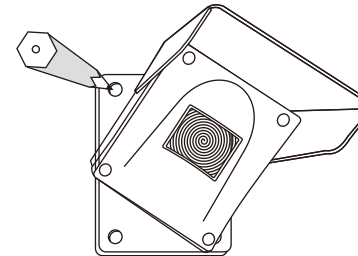

Mark the 4 hole on the wall using a pencil.

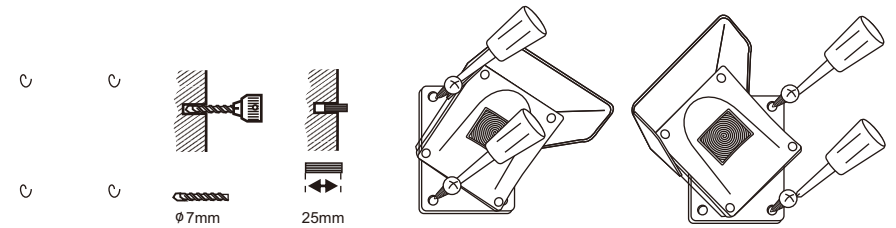

Requires an electric drill for holes to fix the Sensor with the provided ram plug and screws.

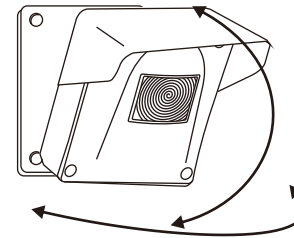

Adjust the sensor to make a good operation angle

Learn (Pairing with remote sensor)

1. Press "learn" button and hold 3 second to entering to "learn mode"

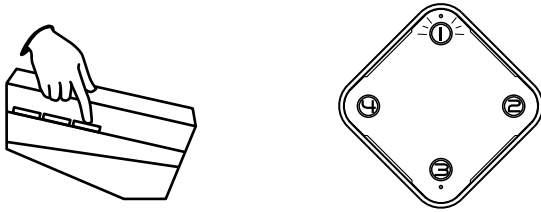

2. Press "learn" button to select the preferred zone

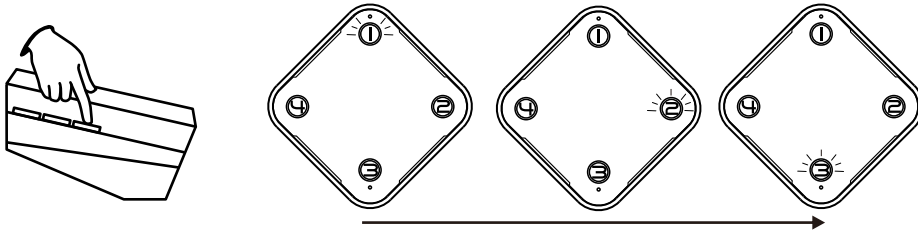

3. After select the zone then press "melody" button to select the preferred melody for the sensor going to be paired

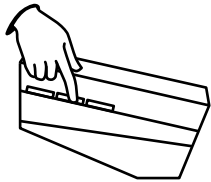

Melody select sequence
Melody#1 >> Melody#2>> ...>>Melody#32 >> Melody#1

4. Trigger the sensor which going to be paired.

- * Sounds "Beep" whiled sussfully
- * If the Sensor paired with other Zone: there will not sound and show the Zone paired with the sensor for 3 sec., Then goes back to the selected Zone.
- * If all the space were occupied. 1,2,3,4 zone's LED flash 3 time.

Clean all the sensor in a zone

1. Press "Learn: button and hold 3 second to enter "learn mode"
2. Press "next button" to select which zone going to unpair the sensors.
3. Press "Pause/Reset" button for 3 sec. To unpair all the sensors in the zone.
4. Press "Next button" untill exit the mode.

How to Pause the system

If you want to disable the system Temporary:

1. Choose the pause time (30 or 60 minutes)
2. Press "Pause" button and hold 3 second and release while the four zone LED lit.
3. The four zone LED will lit up in succession to indicate the receiver is in pause mode.

The receiver will not receive any signal while the receiver is in pause mode

4. Press the pause button again to exit the pause mode.

Pause mode: EU mode: auto turn on (Exit the pause mode) when the pause time is over.

US mode: the receiver generat a beep tone when the pause time is over.

Press the pause button to exit the pause mode

Battery low

Receiver

The "RX Batt. Low" LED (Red) will blink every 5 second and beep every 15 minute to indicate the backup batter low or no battery installed

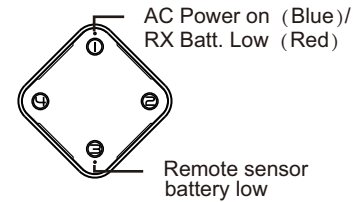

Battery Low Indication

Power			Indication	
AC Power	Battery Normal	Battery Low	LED Indication	Beep sound every 30 minutes
✓	✓		Blue	
✓	No Battery installed		Blue + Red Flash	
✓		✓	Blue + Red Flash	
	✓		Red	
		✓	Red Flash	✓

Sensors

The "Remote sensor battery Low" LED will blink every 5 second and beep every 30 minute to indicates sensor(s) batter low.

Check which sensor in battery low

1. Press "Battery Check" button and hold 3 second to entering to "check mode". The sensor battery low LED will light up after enter the battery check mode.

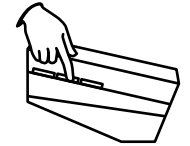

2. Press "Next button" to switch between the zones, light up Zone 1 first, Press again the "Next button" to switch zone 2 > zone 3 > zone4

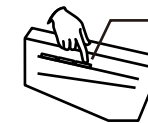

If going to chk, zone 2.
Press 2 time "next button"
make the LED stop at Zone2

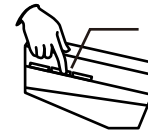
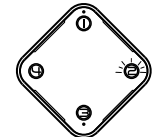

Press and hold "battery chk" button
The LED 1,2,3,4 will show which
sensor/sensors are battery low.

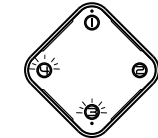

* Release "battery chk" button and press "Next" to check next zone.

* zone 1 >> zone 2 >> zone 3 >> zone 4 >> exit the battery mode

How to clean the battery low signal

BATT. LOW alert will not off until replace the battery.

Code Conflict

If the PIR sensor coding is the same as another transmitter you must change the code. When you have changed the code, you need to repair the PIR sensor.

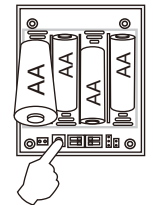

Press and hold the test button, insert the battery and hold the button 5 seconds. The LED will flash 5 time when a new code is generated