

## Product Specification

	Door Unit	Answering Unit
Maximum Channels	1	
Communication Range	300 metres in open space	
Resolution	640 × 480 (VGA)	
Operating Temperature	-10°C~+40°C	
Operating Voltage	DC 5V / 1A	DC 5V / 1A
Current Consumption	680mA(max)	680mA(max)
Night Vision	3 m	
Dimension	116 × 60 × 32mm	130 × 90 × 27mm

## Storage Media Management

SD Card Capacity	Recording Time
1G	130 Minutes
2G	270 Minutes
8G	1050 Minutes
16G	2100 Minutes

## User's Manual

**Model No.: 70204**

## MOBICAM DXR

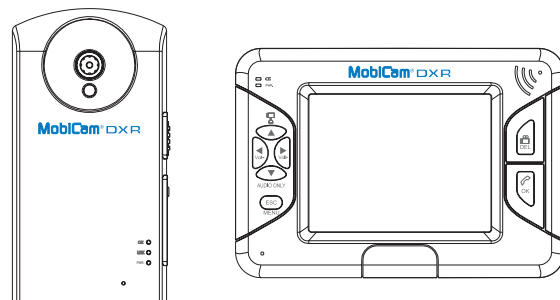

### PLEASE READ CAREFULLY AND SAVE

This manual contains important information about this product's operation. If you are installing this product for others, you must leave this manual-ora copy- with the end user.

- What You Get
- Safety Precaution and Hazard Notice / FCC Warning / Disposal
- Knowing Devices Parts
- Getting Started
  - Step 1: Knowing the System Connection and Installation
  - Step 2: Basic Operation
    - Knowing Camera Function Buttons and Indicators
    - Knowing Receiver Function Buttons and Indicators
  - Step 3: Advanced Operation
    - Knowing Screen Icon
    - Knowing the Main Menu
- About Digital Wireless Technology
- Trouble Shooting Table
- Product Specification

What You Get

- (1) Digital wireless camera
- (1) 3.5 "LCD digital wireless receiver
- (2) 5V 1A power adaptor for camera and receiver
- (1) Camera stand
- (1) Mounting kit
- (1) USB cable
- (1) Manual

Trouble Shooting Table

Before requesting service, please make the below checks. If you are in doubt about some of the check points, or if the remedies indicated in the chart do not solve the problem, please contact us.

Problem	Possible Causes	Remedies
System Message shows "NO Signal"	No power supply to camera (Battery low)	check power adapter and power cable connection or battery been run out.
	Camera is not paired with receiver	See pairing operation for detail.
	Service out of range	Draw the camera near the receiver
	Signal been blocked	If possible, remove major obstacles in between camera and receiver. Or relocate the camera to proper location.
Low signal or unstable signal	Antenna directional limitation	Adjust camera and receiver position.
	Signal been blocked	If possible, remove major obstacles in between camera and receiver. Or relocate the camera to proper location.
	Strong radio signal near by	Keep WIFI router away from the camera and/or receiver.
	Strong electromagnetic interference near by	Keep working motors (hair dryer / heat fan / air conditioner / water pump) or microwave oven away from the camera and/or receiver
Recording does not work	No SD card	Insert SD card to SD card slot
	SD Card locked	Unlock the SD card
Black screen & Buttons no function	Power save mode on	Press power key to resume receiver image, please refer to [Power Saving] section at page 12 for details.
Audio feedback	Camera and receiver are too close	The camera has a high sensitivity microphone Keep the camera at least 10 feet away from the receiver. If the camera must be within 10 feet of the receiver, keep the volume down
VOX Record&Alarm does not work	VOX Menu set to "OFF"	Set VOX Sensitivity/VOX Alarm/VOX Record to ON

## About Digital Wireless Technology

This section offers some helpful information to overcome most of the problems you may encounter. We hope this section can help you to enjoy a pleasant setup.

### Problems Diagnosis

#### About 2.4GHz Digital Wireless Signal

This innovative digital wireless solution integrates advance Frequency Hopping Spread Spectrum (FHSS) technology. This technology greatly reduce the interference that comes from other devices using the same radio frequency (2.4GHz), e.g. WIFI, Bluetooth, Zigbee, cordless phone...etc. You now can enjoy a more pleasant wireless surveillance quality without flicking and noisy image. However, weaker signal (lag or still image) can be observed yet from time to time, depending on the environment where the system is installed.

Complied with FCC part 15.247, ETSI (EN) 300 328, audio / video signals transmitted out about or over 500 foot / 150 metre in line of sight should be supported. Line of sight installation, though, is usually not a common practice. Factors affecting transmission include microwave ovens or other high frequency electromagnetic waves. Reinforced concrete walls, large scale metal products and metal furniture should not be located near the door unit or the answering unit. Water creates an obstacle and should not be placed near. Human bodies such as a person passing through may cause unstable signal quality

#### How to improve the wireless signal quality?

If possible, remove obstacles in between camera or the receiver that might reflect the signal. These could include furniture, cabinets, and walls. If you feel the wireless signal is not good enough, place the receiver at a new angle or readjust its position to make an improvement. Or simply relocate the camera closer to the receiver.

#### Why Image Compression?

In order to provide a private and interference free wireless service, this digital wireless solution works on a 2Mb narrow hopping band. Different from traditional 2.4GHz analog signal, this digital wireless signal is compressed and presented as Motion JPEG (MJPEG) format. By digitalizing and compressing the raw analog data, the bandwidth is used more efficiently and securely. Consequentially, you might observe an indent image line on a larger display monitor or plasma TV.

**WELCOME,**  
Dear user, thanks for purchasing this product.  
Much investment in time and effort has gone into its development,  
We now presenting you ZERO interference digital wireless security camera  
and it is our hope that it will bring you many years of trouble-free peace-in-mind service.  
Please read this user manual carefully before installing or using these units.

### Important Safety Precautions

Please read before installing and using this product

Damages caused by non-compliance with this operating manual will void the warranty! We will not assume any liability for damages to items or persons caused by improper handling or non-compliance with the safety notices! Any warranty claim will be null and void in such cases.

1. Do not drop, puncture or disassemble the camera or receiver; otherwise the warranty will be voided.
2. Avoid all contact with water, and dry hands before using.
3. Never tug on the power cords. Use the plug to unplug it from the wall outlet.
4. Do not expose the camera or receiver to high temperature or leave it in direct sunlight. Doing so may damage the camera or cause camera temporary malfunction.
5. Use the devices with care. Avoid pressing hard on the camera or receiver body.
6. For your own safety, avoid using the camera or power off the camera when there is a storm or lightning.
7. Remove the power adapter during long periods between usages.
8. Use only the accessories and power adapters supplied by the manufacturer.
9. To meet the regulations pertaining to parental responsibility, keep the devices out of the reach of infants.
10. Check power cables, do not get crushed or damaged by sharp edges whenever the devices are in operation.



#### FCC Compliance Statement:

This device complies with Part 15 of the FCC Rules.

Operation is subjected to the following two conditions:

- (1) this device may not cause harmful interference, and
- (2) this device must accept any interference received, including interference that may cause undesired operation.



Products with CE Marking comply with EMC

Directive (2004/108/EC), Low Voltage Directive

(73/23/EEC), R&TTE (1999/5/EC) issued by the

Commission of the European Community. Compliance

with these directives implies conformity to the following

European Norms:

EMC: EN 301 489

LVD: EN 60965

Radio: EN 300 328

#### FCC/CE WARNING

This equipment has been tested and found to comply with limits for a Class B digital device, pursuant to Part 15 of the FCC rules and ETSI (EN) 300 328. These limits are designed to provide reasonable protection against harmful interference in residential installations. This equipment generates, uses, and can radiate radio frequency energy, and if not installed and used in accordance with the instructions, may cause harmful interference to radio communications.

However, there is no guarantee that interference will not occur in a particular installation. If this equipment does cause interference to radio or television equipment reception, which can be determined by turning the equipment off and on, the user is encouraged to try to correct the interference by one or more of the following measures:

- Reorient or relocate the receiving antenna.
- Move the equipment away from the receiver.
- Plug the equipment into an outlet on a circuit different from that to which the receiver is connected.
- Consult the dealer or an experienced radio/television technician for additional suggestions.

You are cautioned that any change or modifications to the equipment not expressly approved by the party responsible for compliance could void Your authority to operate such equipment.

#### Disposal

If the camera system no longer functions or can no longer be repaired, it must be disposed of according to the valid statutory regulations. Disposal of spent batteries / accumulators:

You are required by law (Battery Ordinance) to return all spent batteries and accumulators. Disposing of spent batteries/accumulators with common household waste is prohibited! Batteries/accumulators that contain hazardous substances are marked with the symbols on the side. These symbols indicate that it is prohibited to dispose of these batteries/ accumulators in the household waste.



The abbreviations for the respective heavy metals are: Cd= cadmium, Hg= mercury, Pb= lead. You can return spent batteries and accumulators that can no longer be charged to the designated collection points in your community, outlets or wherever batteries or accumulators are sold. Following these instructions will allow you to fulfill the legal requirements and contribute to the protection of our environment!

## Knowing Devices Parts

### Camera

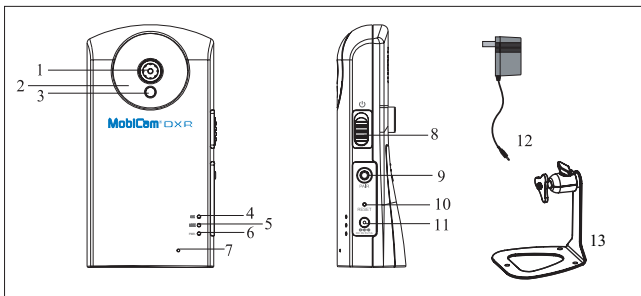

- |                      |                    |                   |
|----------------------|--------------------|-------------------|
| 1. Lens              | 5. Link indicator  | 9. Pairing key    |
| 2. IR LED            | 6. Power indicator | 10. Reset         |
| 3. EDS               | 7. Microphone      | 11. DC IN jack    |
| 4. Battery indicator | 8. Power key       | 12. Power adaptor |
|                      |                    | 13. Camera stand  |

### Receiver

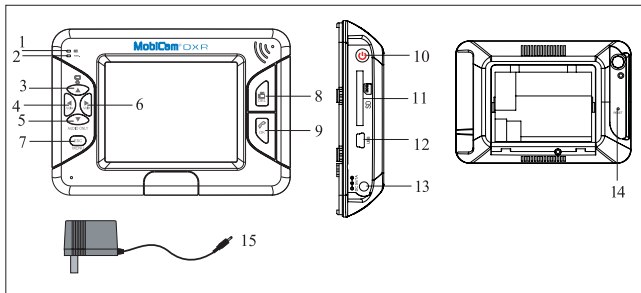

- |                              |                                                         |
|------------------------------|---------------------------------------------------------|
| 1. Battery indicator         | 9. PTT button/Confirm                                   |
| 2. Power indicator           | 10. Power button                                        |
| 3. Cursor up/Channel switch  | 11. SD card slot                                        |
| 4. Cursor left/ Volume down  | 12. USB port(For FW upgrade/<br>AP software connection) |
| 5. Cursor down/ Audio switch | 13. DC IN jack                                          |
| 6. Cursor right/ Volume up   | 14. Reset                                               |
| 7. Enter/Exit menu           | 15. Power adaptor                                       |
| 8. Record/Delete             |                                                         |

## Alarm Setup



Press **OK** to shift to on /off. Press **◀/▶** to move between the items.

**VOX alarm ON:** The receiver will give an alarm for 15 seconds when the camera is triggered by voice.

**Battery low alarm ON:** The receiver will give an alarm for 15 seconds when the camera battery is low.

**Out of range alarm ON:** The receiver will give an alarm for 15 seconds when the receiver and camera is out of wireless transmitting range.

## Event List



### Play back Mode

1. Press **OK** to enter Record Folder.
2. Continue to press **OK** to Play/Pause file.
3. Press **▶** to fast forward video clip, press **◀** to back reverse video clip; press **ESC** to Stop/Exit.

### Event List

1. Use **▲ ▼** to select the record file you need to delete.
2. Press **DEL** to enter deletion mode.
3. Press **◀ ▶** to select YES or NO. 4. Press **OK** to delete.

**⚠** Recording file will be reserved every 30 sec if recording time exceeds 30 sec. 12

## VOX Sensitivity



Use ◀/ ▶ to adjust VOX sensitivity level.  
 OFF --VOX function will be disabled.  
 level 3 means high sensitivity, level 1 means low sensitivity  
 VOX Activate Recording



System will auto record for 30 sec once camera is triggered by voice when set "VOX activate recording" to ON.  
 ⚠ Please set VOX sensitivity to level 1~3 before proceed with this function.  
 Brightness



Press Ⓚ to enter camera brightness adjustment bar, press ◀/ ▶ to adjust brightness of current channel.

## Getting Started

### Step 1: Knowing the System Connection and Installation

#### Camera Connection

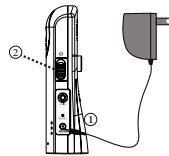

- ① Connect power cable to camera's DC IN then plug on switching power supply adaptor to wall outlet.
  - ② Push [Power Button] once to turn ON the camera.
- ⚠ Built-in Lithium battery charging process starts automatically by plugging in switching power supply. To have full capacity, please charge battery full until green [Battery Indicator] goes off.
  - ⚠ Only use 5V/1A power adaptor provided in the package.

#### LCD Monitor Connection

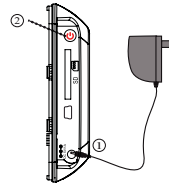

- ① Connect power cable to Receiver's DC IN then plug its on its power adaptor to wall outlet.
  - ② Press [Power Button] to turn ON the receiver.
- ⚠ Built-in Lithium battery charging process starts automatically by plugging in switching power supply. To have full capacity, please charge battery before operating the receiver without charger for portable use.
  - ⚠ When [Battery Indicator] lights up red, plugging in power adaptor to charge battery.
  - ⚠ Only use 5V/1A power adaptor provided in the package.

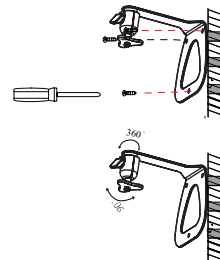

- ① Select the position for the camera and secure the camera stand. Screws and anchors are supplied. Use an appropriate screw type for the mounting surface.

- ② Screw the camera onto the bracket

- ③ Adjust camera to the proper view angle. Make sure the lens is upright relative to your subject. Tighten the nut. Adjust the antenna to an upright position.

## Step 2: Basic Operation

### I. Knowing Camera Function Buttons and Indicators

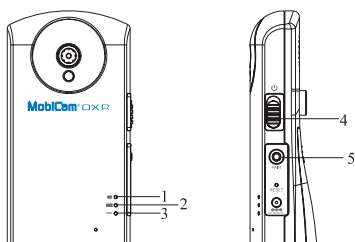

#### ① [Battery Indicator]

Green LED = Battery Charging; please charge battery until Green LED goes off.

Red LED = Battery Low; Camera is turning OFF in 3-minute time, please plug on switching power supply for charging and continuous use.

LED OFF = Battery Fully Charged.

#### ② [Link Indicator]

Blinking LED = Pairing sequence is in processing. See [Advanced Operation – Pairing Camera] section as a guide.

Blue LED = Camera is picked up by the receiver.

LED OFF = Camera is in stand-by mode.

#### ③ [Power Indicator]

LED goes ON when camera is powered ON.

#### ④ [Power Button]

Push once to power ON the camera. To power OFF the camera, hold button for 2 seconds until [Power Indicator] goes off.

#### ⑤ [Link Key]

Press to pair camera with receiver. See [Advanced Operation –Pairing Camera].

### Pairing Camera



1. Use ◀ ▶ to select a channel.

2. Press Ⓚ to start system countdown from 60 seconds.

3. Within 60-second countdown, press PAIR at the camera side. Image will display when pairing is complete.

### Power Saving



Use ◀ / ▶ to turn [Power Saving] mode On/Off.

⚠ By setting [Power Saving] mode On, both receiver and camera will enter standby mode after 2-minute idle time and speaker volume will be mute. Press power key of the receiver to resume monitor and camera .

### SD Card Format

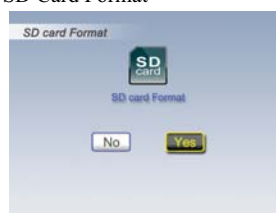

Press ◀ / ▶ to select No or Yes.

⚠ For first time use, it is strongly recommended to format the SD card.

## Camera On/Off



Use ◀ / ▶ to select the camera you need to turn off,  
press Ⓚ to change ON/OFF status.

⚠ Make sure available cameras are set to ON for SCAN or QUAD mode

## Scan Period



Use ◀ / ▶ to change Scan Time interval from OFF / 5 sec / 15 sec / Quad,  
press Ⓚ to confirm the settings.

⚠ To leave QUAD display, simply press directional keys to enter  
single channel.

▲ = CAM1; ▼ = CAM2; ◀ = CAM3; ▶ = CAM4;

⚠ When system enter into power save mode from QUAD, press any key  
to resume monitor

## II. Know Receiver Function Buttons and Indicators

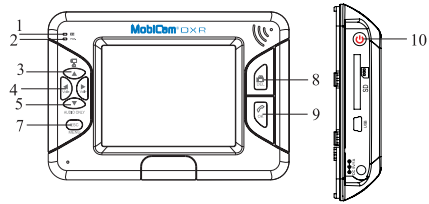

### ① [Battery Indicator]

Green LED = Battery Charging; please charge battery until Green LED goes off.

Red LED = Battery Low; Camera is turning OFF in 3-minute time, please plug on switching power  
supply for charging and continuous use.

LED OFF = Battery Fully Charged.

### ② [Power Indicator]

LED goes ON when camera is powered ON.

⚠ LED remains ON while monitor is OFF in [Power Save] Mode.

③ (Menu Mode) [Cursor UP] / (View Mode) [Manual Channel Switch] / (QUAD View Mode) [Hot key CH1]

④ (Menu Mode) [Cursor Left / Vol-] / (QUAD View Mode) [Hot key CH3]

⑤ (Menu Mode) [Cursor DOWN] / (QUAD View Mode) [Hot key CH2] /  
(View Mode) [Turn on/off audio]

⚠ Press to turn on/off audio when setting VOX sensitivity to OFF.

⑥ (Menu Mode) [Cursor Right / Vol+] / (QUAD View Mode) [Hot key CH4]

⑦ (Menu Mode) [Menu / Enter Button]

⑧ (View Mode) [Manual Record] / (Menu Mode) [Delete Record File]

⑨ (View Mode) [Push to Talk] / (Menu Mode) [Confirm]

### ⑩ [Power Button]

Push button to power on, then hold it for 2 seconds to power OFF the monitor.

## Step 3: Advanced Operation

### I. Knowing Screen Icons

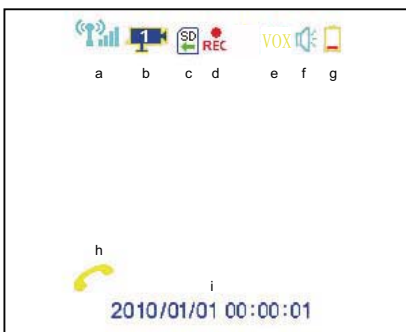

- Signal indicator
- Current display channel indicator
- SD card available
  - SD card locked(flashing)
  - SD card full(flashing)
  - SD card error(flashing)
- Recording indicator(flashing)
- VOX (Voice-activation) triggering record ON
- VOX (Voice-activation) triggering alarm ON
- Camera battery low indicator
- Push-to-talk indicator
- System time

## II. Knowing the Main Menu

### Time Setting



Press OK to enter time setting, use ▲ / ▼ / ◀ / ▶ to change setting, press OK again to save.

### Set to Factory Default



Use ◀ / ▶ to select between No and Yes.



The antenna used for this transmitter must be installed to provide a separation distance of at least 20 cm from all persons and must not be co-located or operated in conjunction with any other antenna or transmitter.

FCC NOTE:

This device complies with Part 15 of the FCC Rules. Operation is subject to the following two conditions: (1) this device may not cause harmful interference, and (2) this device must accept any interference received, including interference that may cause undesired operation.

The manufacturer is not responsible for any radio or TV interference caused by unauthorized modifications to this equipment. Such modifications could void the user's authority to operate the equipment.

This equipment has been tested and found to comply with the limits for a Class B digital device, pursuant to Part 15 of the FCC Rules. These limits are designed to provide reasonable protection against harmful interference in a residential installation. This equipment generates, uses and can radiate radio frequency energy and, if not installed and used in accordance with the instructions, may cause harmful interference to radio communications. However, there is no guarantee that interference will not occur in a particular installation. If this equipment does cause harmful interference to radio or television reception, which can be determined by turning the equipment off and on, the user is encouraged to try to correct the interference by one or more of the following measures:

- Reorient or relocate the receiving antenna
- Increase the separation between the equipment and receiver.
- Connect the equipment into an outlet on a circuit different from that to which the receiver is connected.
- Consult the dealer or an experienced radio/TV technician for help.

IC NOTE:

Operation is subject to the following two conditions: (1) this device may not cause interference, and (2) this device must accept any interference, including interference that may cause undesired operation of the device."