



DV-9812

INSTALLATION/OWNER'S MANUAL

Car Audio



Table of Contents..... 1

Preparation..... 2

Precautions.....3 - 5

Notes on installation 6 - 8

Wire connection diagram.....9

Control Locations – Receiver.....10

General Operation 11

DVD/VCD/CD Operation 12-13

BLUETOOTH Operation14

Specification.....15

Please read all instructions carefully before attempting to install or operate .

Due to its technical nature, it is highly recommended that your BENZER DV-9812 is installed by a professional installer of an authorized dealer. This product is only for use in vehicles with 12VDC negative ground only.

To get the best from your product, understand its capabilities and avoid all possible risks, we recommend that you take time to read this manual very carefully before handling the product

Preparation

Be sure you test all connections first and then follow these steps

Before installing the unit, make sure your vehicle is connected to 12V DC negative grounded electrical system.

The negative battery terminal must be disconnected before making connections which can reduce damage to the product due to short circuit.

Be sure to connect the color coded leads correctly according to the diagram. Incorrect wiring connections may cause the product to malfunction or damage the vehicle's electrical system.

When extending the ignition, battery or ground cables, make sure to use automotive grade cables or other cables with an area of 0.75mm(AWG 18) or more to prevent voltage drops &/or fluctuations.

Be sure to connect the speaker (-) leads to the speaker (-) terminal. Never connect the left and right channel speaker cables with each other or to the vehicle body. Do not block vents or radiator panels. Blocking them will cause heat to build up inside and may result in fire

After the completion of the installation and commencement of operation of the product (includes replacing the battery), press the RESET button (1) on the front panel with pointed objects (ball pen etc.,) to set the unit to original factory settings.

DO NOT OPERATE THE PRODUCT IF THE TEMPERATURE INSIDE THE VEHICLE IS UNDER - 20 OR OVER + 60 DEGREES CELCIUS .



Precautions

USE THIS PRODUCT SAFELY

When Driving

Keep the volume level low enough to be aware of road and traffic conditions.

When Car Washing

Do not expose the product to water or excessive moisture. This could cause electrical short circuit, burned or other damage.

When Parked

Parking in direct sunlight can produce very high temperatures inside your vehicle. Give the interior a chance to cool down before starting playback.

Use the Proper Power Supply

This product is designed to operate with a 12 volt DC, negative ground battery system.

Protect the Disc Mechanism

Avoid inserting any foreign objects into the slot of this player.

Failure to observe this may cause malfunction due to the precise mechanism of this unit.

For Installation

The unit should be installed in a horizontal position with the front end up at a convenient angle, but not more than 30°.

- Do not attempt to disassemble or adjust this precision sensitive product.
- Do not attempt to modify the unit. Unit modification may cause malfunction.
- To enjoy the optimum audio& video while playing, please handle the disc as following:

1. Disc Handling

- Attempting to use non-standard discs or non standard shape discs (example : square , star and heart shaped discs) may damage the unit. Be sure to use good quality standard round shaped discs only for this product
- Dirt, dust, scratches and bending the disc will cause malfunction.
- Do not place stickers, adhesive tape or make scratches on discs.
- Do not bend discs.
- A disc should always be kept in its protective cover when not in use to prevent from damaging .
- Do not place discs in the following places :
 - 1). Direct sunlight or sources of heating
 - 2). Dirty, dusty and damp areas
 - 3). Near car heaters or air conditioners
 - 4). On the seats or dashboard

Note: Do not use any solvents such as petrol or thinning agents. Commercially available cleaning substances of antistatic spray will damage the device.

Precautions



2. Disc Cleaning

Use a dry soft cloth to wipe the surface. If the disc is quite dirty, use a soft slightly damp cloth with isopropyl (rubbing) alcohol. Never use solvents such as benzene, thinner or conventional record cleaners as they may mar the surface of the disc.

Before playing a disc, please wipe it off with a clean, dust-free cleaning cloth.

Wipe the disc in the direction of the arrow.



Precautions

Always insert the disc with the label side facing upwards.

If the disc is inserted with the printed side facing downwards, the device can be damaged.



Precautions

Note: If there is already a disc in the disc slot, do not try to insert a second disc. This may damage the device.

Always hold discs by the edge. In order to keep the disc clean do not touch the surface. Pull out the disc as follows.



Note: A disc may become somewhat scratched (although not enough to make it unusable) depending on the conditions under the environment & the way it has been handled. These scratches are not an indication of any problem with the product.

Choose the mounting location where the unit will not interfere with the normal driving function of The driver;

Before finally install the unit , connect the wiring and make sure it is all connected up properly, and The unit & the system work properly.

Use only the parts included with the unit to ensure proper installation. The use of unauthorized Parts can cause malfunctions.

Consult with your nearest dealer if installation requires the drill of holes or other modifications of The vehicle.

Install the unit where it does not get in the driver's way and cannot injure the passenger if there Is a sudden stop, like an emergency stop or excessive brakes is applied.

If installed angle exceeds 30 degrees from horizontal, the unit might not giver its optimum Performance.



Avoid installing the unit where it would be subject to high temperature such as direct sunlight, hot Air, heater or where it would be subject to dust, dirt or excessive vibration.

Notes on Installation

DIN FRONT-MOUNTING METHOD(METHOD A)

Installing the unit

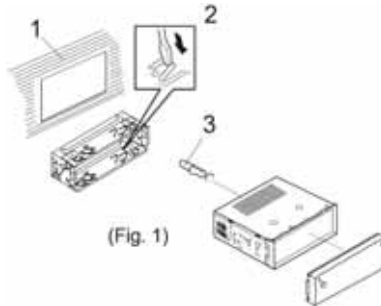

1. Dashboard

2. Holder

After inserting the holder into the dashboard, select the appropriate tab according to the Thickness of the dashboard material and bend them inwards to secure the holder in place.

3. Screw

Notes on Installation

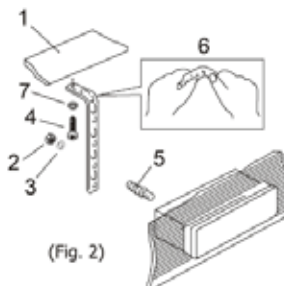

1. Dashboard 2. Nut(5mm) 3. Plan washer 4. Screw (5x25mm) 5. Screw
6. Strap

Be sure to use the strap to secure the back of the unit in place. The strap can be bent by hand to the desired angle.

Removing the unit

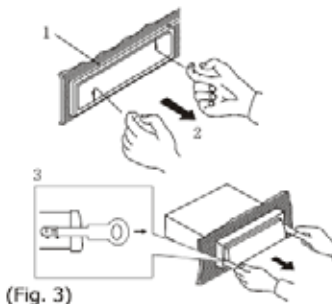

1. Frame
2. Insert fingers into the groove in the front of frame and pull out to remove the frame.
(When reattaching the frame, point the side with a groove downwards and attach it.)

3. Lever
Insert the levers supplied with the unit into the grooves at both sides of the unit as shown in figure. Until they click, pulling the levers makes possible to remove the unit from the dashboard.

DIN REAR-MOUNTING METHOD(METHOD B)

Installation using the screw holes on the sides of the unit

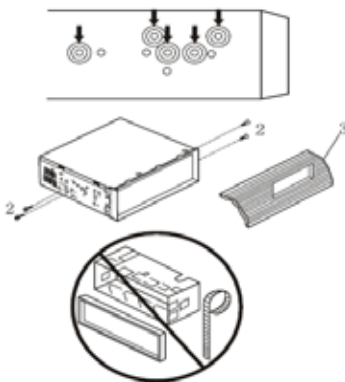
Notes on Installation

Fastening the unit to the factory radio mounting bracket:

1. select a position where the screw holes of the bracket and screw holes of the main unit become Aligned (are fitted). And tighten the screws at 2 places on each side.
Use either truss screws (5 x 5mm) or flush surface screws (4 x 5mm)
2. Screw ("T" Position)
3. Dashboard or console

NOTE: The mounting box, outer trim ring, and half-sleeve are not used for method b installation

Wire Connection Diagram

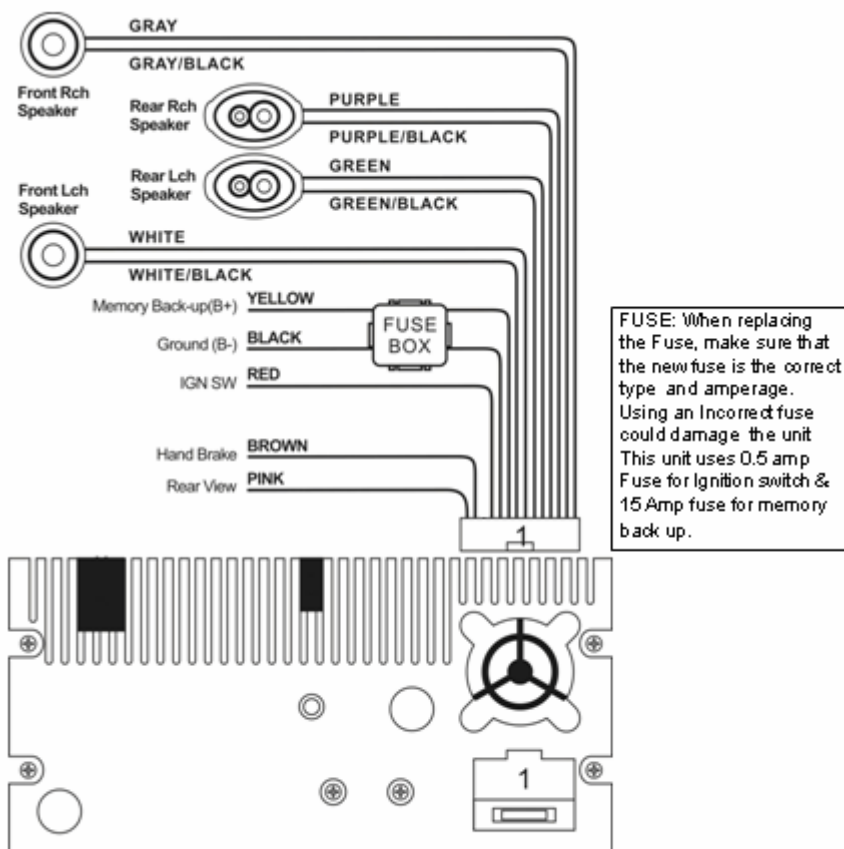

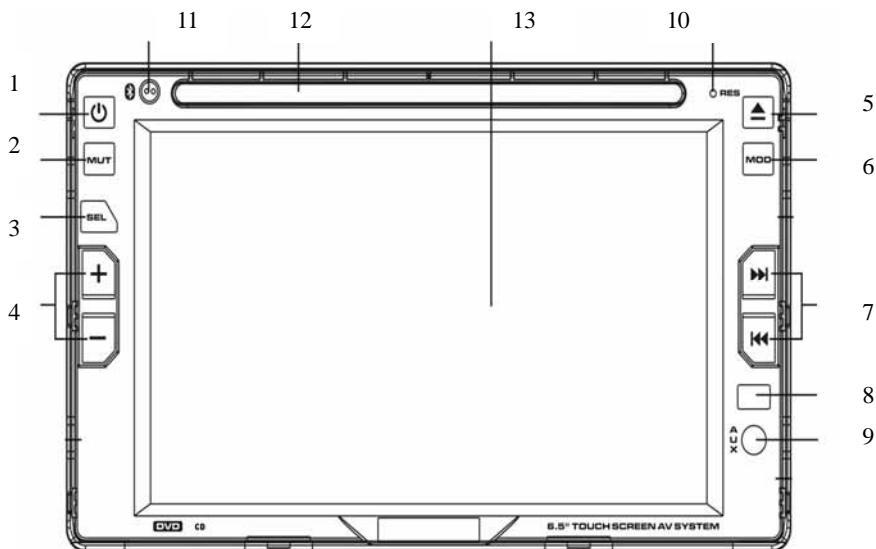
Control Locations – Receiver

- 1. Power Selector
- 2. Mute Selector
- 3. SEL Selector
- 4. Volume Control
- 5. Eject Button
- 6. MODE Selector
- 7. Forward/ Rewind Button

- 8. Remote Control Sensor
- 9. AUX IN Jack
- 10. Reset
- 11. Bluetooth
- 12. Disc slot
- 13. TFT Display

General Operation

Power Selector (1)	Press PWR button to turn on the unit on, and press it again to turn the unit off Note: After the unit is off, if the volume level is higher than it is in initial setting, it will Resume to initial status; if it is lower than that in initial status, the unit will automatically still store in level which you set.
Mute Selector (2)	Press Mute Button to cut down the sound output, (press it again to revert to Previous volume level).
SEL Selector (3)	Press SEL button repeatedly to select the desired mode in the following order: <div style="text-align: center;">  </div>
Volume Control (4)	For Volume Control 3 , rotate VOL knob clockwise to increase the sound Level, and rotate it anti-clockwise to decrease the sound level.
Eject Button (5)	Press it to eject the disc.
Mode Button (6)	Press it repeatedly to select , DISC, CARD, AUX IN mode.
Tuning Selecting tacks (7)	Press it continuously to select a station upward or downward respectively. Press and hold it more than 2 seconds, the radio automatically searches a station upward or downward respectively and plays when a station with a broadcast signal is found.
Remote Control Sensor (8)	Infra remote sensor to receive commands from remote handset.
AUX IN Jack (9)	For Connection to an auxiliary external audio device with 3.5mm plug.
Reset (10)	<p>RESET button (Reset) is placed on the housing and must be activated with either a ball point pen or thin metal object. (DO NOT use sharp object to avoid damaging the button.) The RESET button (Reset) is to be activated for the following reasons:</p> <ul style="list-style-type: none"> - Initial installation of the unit when all wiring is completed. - All the function buttons do not operate. - Error symbol on the display. <p>NOTE: If the problem continues to persist after RESET button (Reset) is pressed, it is recommended to use a cotton swab soaked in isopropyl alcohol to clean pin connector socket on the back of the front panel.</p>
Bluetooth (11)	
Disc Slot (12)	Insert the disc to play.
TFT Display (13)	6.5" TFT Colour LCD Display

DVD/VCD/CD Operation**PLAY DISC****1. Mute Key**

Press it to cut off the sound output, Press it again to cancel the MUTE function.

2. PLAY/PAUSE Key

Press it to pause the playback, and press it again to resume to normal playback.

3. Downward/upward key

Press it to select track downward/upward.

DVD/VCD/CD Operation

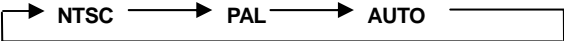
- | | |
|--------------------------|--|
| 4. STOP key | Press it to stop the playback, and Press it again to start playback from the beginning. |
| 5. BACK key | Press it to return to main menu. |
| 6. PAGE key | Press it to turn to next operating page. |
| 7. RPT key | Repeat function. Press it to repeat the current track/chapter; Press it again to repeat the title. |
| 8. RDM key | Press it to play the disc in random, press it again to resume to normal playback. |
| 9. OSD key | |
| 10. L/R key | Press it to switch between R+R/L+L/STEREO. |
| 11. N/P key | Press it to switch the video system:
<div style="text-align: center; margin-top: 10px;"><pre>graph LR; NTSC --> PAL; PAL --> AUTO;</pre></div> |
| 12. MENU key | |
| 13. Direction key | Press it to choose your desired track and press OK key to start. |
| 14. OK key | |

Bluetooth Operation**BLUETOOTH MENU**

Before you read this bluetooth instruction please note follow points:

- A) The bluetooth function is optional, you can use this function which you bought the unit including bluetooth function.
- B) The initial secret code is "0000"
During any mode, setting your mobile as "Bluetooth connect", when it Successes, the screen will show a "CONNECT OK" word.

- 1. Operation status display zone**
- 2. Dial key**
- 3. Number button**
Keyboard zone, when you touch the key in the area , will display the corresponding operation.
- 4. DEL:** When you input the incorrect Character, press it to delete The Incorrect Character.
- 5. CONNECT:** To pair mobile with the player.
- 6. PLAY/PAUSE key**
- 7. Redial button**
- 8-9. Select tracks downward/upward**
- 10. Volume +/-**
- 11. Back to main menu**
- 12. CNT:** Bluetooth can be switched on or off by pressing this button after the pairing is connected.
- 13. Hung up key**

Specification

Specification**GENERAL**

Power Requirements.....	12V DC
Load Impedance	4
Max. Power Output	50 Watts x 4 Channels
Tone Controls:	± 8dB(Bass 100Hz, Treble 10KHz)
Dimensions	Approx.192x178x100mm(DxWxH)
Mounting Dimensions.....	Approx.169x182x103 mm(DxWxH)
Weight	Approx.3.0kg

FCC NOTE:

THE MANUFACTURER IS NOT RESPONSIBLE FOR ANY RADIO OR TV INTERFERENCE CAUSED BY UNAUTHORIZED MODIFICATIONS TO THIS EQUIPMENT. SUCH MODIFICATIONS COULD VOID THE USER'S AUTHORITY TO OPERATE THE EQUIPMENT.

This device complies with Part 15 of the FCC Rules. Operation is subject to the following two conditions:1. This device may not cause harmful interference, and 2. This device must accept any interference received, including interference that may cause undesired operation.