

**AUVIO**  
THE PERFORMANCE YOU NEED®

## Bluetooth® Music Receiver

Please read this user's guide before using  
your new receiver.

User's Guide

1500476



### Package Contents

- Bluetooth Music Receiver
- AC Adapter
- 1/8" (3.5mm) Audio Cable
- 1/8" (3.5mm) to RCA Cable
- User's Guide

### Use Your Receiver

1. Plug the supplied audio cable or the RCA cable into the **AUX** jack, **OR** plug an optical cable (not included) into the **OPTICAL** jack, then connect to your speaker or amplifier.
2. Connect the supplied power adapter to the **DC IN** jack, then plug into a standard AC outlet.
3. Press and hold **CONNECT** until the LED indicator lights red to turn on the receiver.

2

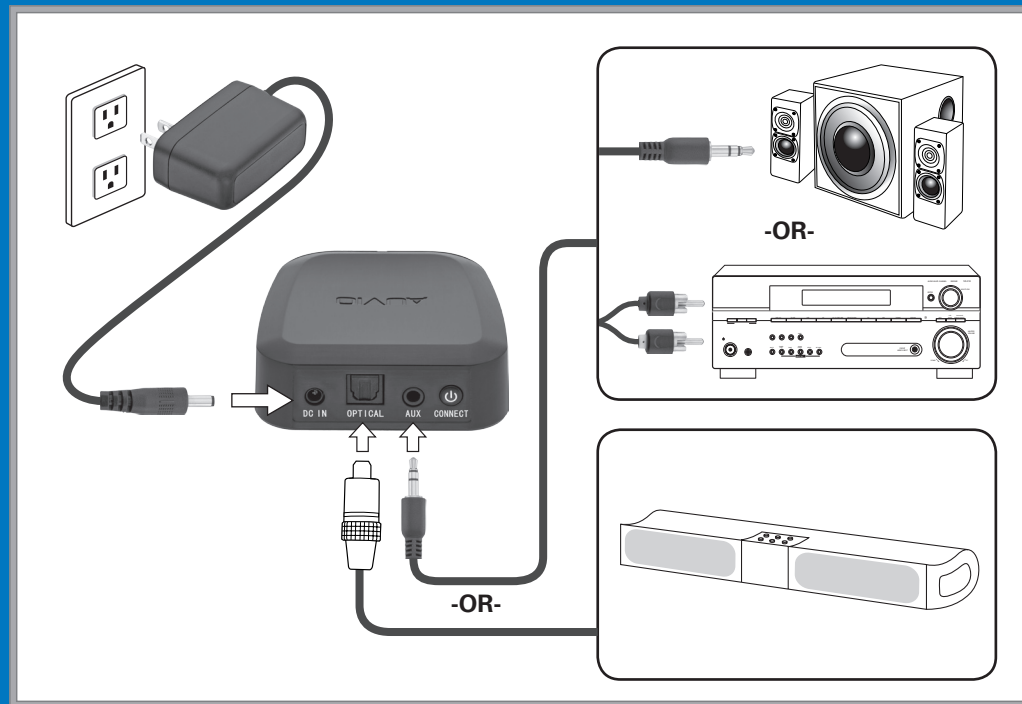

3

4. If the receiver has not been previously paired with a device, the LED indicator will light red. Press and hold **CONNECT** until the LED indicator flashes red and blue to enter pairing mode.
5. See instructions of your Bluetooth-enabled device to pair with the receiver. After successful pairing, the indicator lights blue. If you are prompted for a PIN, enter 0000.
6. Use the playback controls on your audio device.
7. Disconnect the Bluetooth connection after using; the indicator flashes red.
8. Press and hold **CONNECT** for 3 seconds to turn off the receiver.

#### Note:

- To avoid noise interference, always power off your amplifier or speaker before plugging or unplugging your cables.

5

- If the **AUX** and **OPTICAL** jacks are both connected, sound output will only be available from the **AUX** connection.
- If the connected device moves too far away from the receiver, the receiver disconnects from the device but resumes connection once the device is close.
- Using an adapter that does not meet the receiver's specifications could damage the receiver.

### NFC (Near Field Communication)

You can touch the receiver with a NFC-enabled device to connect or disconnect the Bluetooth communication. You may need to try different places on your phone as the NFC might be placed on either the back, top or bottom of the phone cabinet.

If you have two or more NFC devices, when you touch the second device to the receiver, it will automatically connect to the receiver, and the first device will automatically disconnect from the receiver.

6

## Specifications

Bluetooth Connection Range .....30ft. (9.14m)  
Main Unit .....ABS, with silicone foot pad  
Frequency ..... Band 2.402 – 2.483 GHz  
..... unlicensed ISM band  
Sensitivity..... - 84dBm  
Bluetooth Protocol.....V3.0+EDR, Class 2  
Power Input ..... 100 – 240 VAC  
..... 50/60 Hz, 300 mA  
Power Output .....5 VDC, 1000 mA

Specifications are subject to change and improvement without notice. Actual product may vary from the images found in this document.

## FCC Information

This equipment has been tested and found to comply with the limits for a Class B digital device, pursuant to Part 15 of the FCC Rules. These limits are designed to provide reasonable protection against harmful interference in a residential installation. This equipment generates, uses and can radiate radio frequency energy and, if not installed and used in accordance with the instructions, may cause harmful interference to radio communications. However, there is no guarantee that interference will not occur in a particular installation. If this equipment does cause harmful interference to radio or television reception, which can be determined by turning

7

the equipment off and on, the user is encouraged to try to correct the interference by one or more of the following measures:

- Reorient or relocate the receiving antenna.
- Increase the separation between the equipment and receiver.
- Connect the equipment into an outlet on a circuit different from that to which the receiver is connected.
- Consult the dealer or an experienced radio/TV technician for help.

Changes or modifications not expressly approved by the party responsible for compliance could void the user's authority to operate the equipment.

This device complies with Part 15 of the FCC Rules. Operation is subject to the following two conditions: (1) This device may not cause harmful interference, and (2) this device must accept any interference received, including interference that may cause undesired operation.

## Limited Warranty

Ignition L.P. warrants this product against defects in materials and workmanship under normal use by the original purchaser for **ninety (90) days** after the date of purchase. **IGNITION L.P. MAKES NO OTHER EXPRESS WARRANTIES.**

This warranty does not cover: (a) damage or failure caused by or attributable to abuse, misuse,

8

failure to follow instructions, improper installation or maintenance, alteration, accident, Acts of God (such as floods or lightning), or excess voltage or current; (b) improper or incorrectly performed repairs by persons who are not a Ignition L.P. Authorized Service Facility; (c) consumables such as fuses or batteries; (d) ordinary wear and tear or cosmetic damage; (e) transportation, shipping or insurance costs; (f) costs of product removal, installation, set-up service, adjustment or reinstallation; and (g) claims by persons other than the original purchaser.

Should a problem occur that is covered by this warranty, take the product and the sales receipt as proof of purchase date to the place of purchase. Ignition L.P. will, at its option, unless otherwise provided by law: (a) repair the product without charge for parts and labor; (b) replace the product with the same or a comparable product; or (c) refund the purchase price. All replaced parts and products, and products on which a refund is made, become the property of Ignition L.P. New or reconditioned parts and products may be used in the performance of warranty service. Repaired or replaced parts and products are warranted for the remainder of the original warranty period. You will be charged for repair or replacement of the product made after the expiration of the warranty period.

9

IGNITION L.P. EXPRESSLY DISCLAIMS ALL WARRANTIES AND CONDITIONS NOT STATED IN THIS LIMITED WARRANTY. ANY IMPLIED WARRANTIES THAT MAY BE IMPOSED BY LAW, INCLUDING THE IMPLIED WARRANTY OF MERCHANTABILITY AND, IF APPLICABLE, THE IMPLIED WARRANTY OF FITNESS FOR A PARTICULAR PURPOSE, SHALL EXPIRE ON THE EXPIRATION OF THE STATED WARRANTY PERIOD.

EXCEPT AS DESCRIBED ABOVE, IGNITION L.P. SHALL HAVE NO LIABILITY OR RESPONSIBILITY TO THE PURCHASER OF THE PRODUCT OR ANY OTHER PERSON OR ENTITY WITH RESPECT TO ANY LIABILITY, LOSS OR DAMAGE CAUSED DIRECTLY OR INDIRECTLY BY USE OR PERFORMANCE OF THE PRODUCT OR ARISING OUT OF ANY BREACH OF THIS WARRANTY, INCLUDING, BUT NOT LIMITED TO, ANY DAMAGES RESULTING FROM INCONVENIENCE AND ANY LOSS OF TIME, DATA, PROPERTY, REVENUE, OR PROFIT AND ANY INDIRECT, SPECIAL, INCIDENTAL, OR CONSEQUENTIAL DAMAGES, EVEN IF IGNITION L.P. HAS BEEN ADVISED OF THE POSSIBILITY OF SUCH DAMAGES.

Some states do not allow limitations on how long an implied warranty lasts or the exclusion or limitation of incidental or consequential damages, so the above limitations or exclusions may not apply to you. This warranty gives you specific

10

legal rights, and you may also have other rights which vary from state to state.

You may contact Ignition L.P. at: Ignition L.P.,  
3102 Maple Ave., Suite 450, Dallas, TX 75201  
02/09

For product support, call  
**1-866-315-0426**

11

**RoHS**  
COMPLIANT

Complies with the European Union's "Restriction of Hazardous Substances Directive," which protects the environment by restricting specific hazardous materials and products.

The Bluetooth® word mark and logos are owned by Bluetooth SIG, Inc. and any use of such marks by Ignition L.P. is under license. Other trademarks and trade names are those of their respective owners.

© 2013, Ignition L.P. All rights reserved.  
Auvio is a registered trademark used by Ignition L.P.  
Package and insert are recyclable. Insert contains recycled material.

Printed  
in China

1500476  
06A13

12