

NOTES:

- Traceability is required per 6300-0114.
- The assembly is not RoHS compliant.
- If newer labels are printed, they shall not be on top of an older label
- Carton Controlled by CM

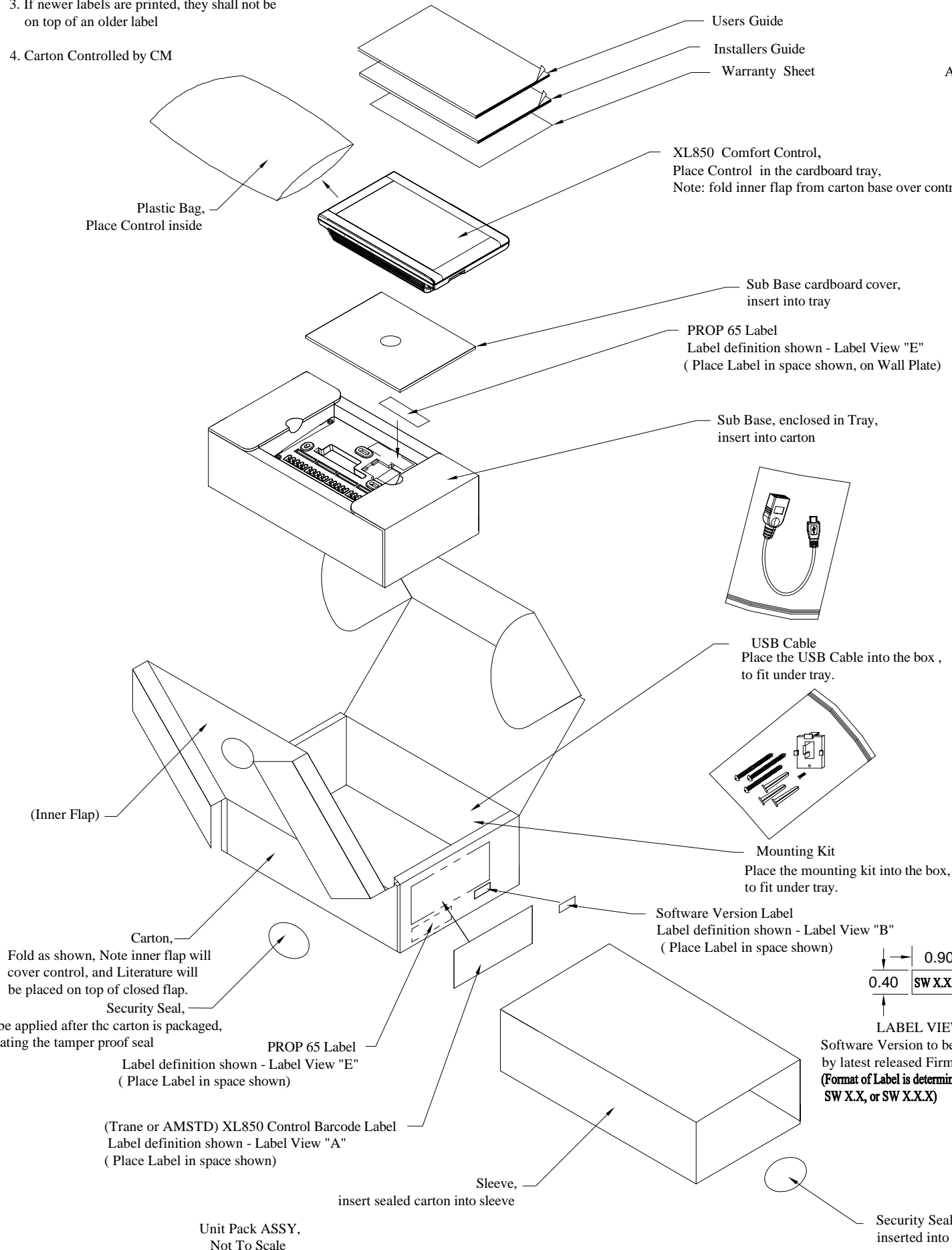

ALL DIMENSIONS ARE IN INCHES

UNLESS OTHERWISE SPECIFIED ALL DIMENSIONS ARE IN MILLIMETERS (INCHES)	TRANE	DO NOT SCALE PRINT	STL	DRAWING NO. D158444	REV. S
THIRD ANGLE PROJECTION	THIS DRAWING IS PROPRIETARY AND SHALL NOT BE COPIED OR ITS CONTENTS DISCLOSED TO OUTSIDE PARTIES WITHOUT THE WRITTEN CONSENT OF TRANE	DATE: 02/26/16	DESCRIPTION: TOP ASSY-XL850		
XX ± .03 XXX ± .010	APPROVAL	APPROVAL	CURRENT REVISION: 155872	REVISION DETAILS	
ANGLES: 1'	DATE: 02/26/16	DATE: 02/26/16	02/02/23	BOM CHANGE ONLY (UPDATE SLEEVES)	
CONFORMS TO ASME Y14.5 - 1994	APPROVAL	APPROVAL	DATE: 02/02/23		

ASSY GROUP NUMBERS		
D158444G03	TRANE VERSION	UNIT ASSY-XL850-2 TRANE
D158444G04	AMSTD VERSION	UNIT ASSY-XL850-2 AMSTD

APPLY COMPLIANCE LABEL IN LOCATION SHOWN

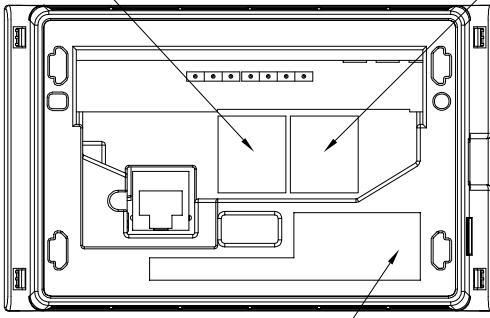

APPLY FCC LABEL IN LOCATION (FOR -G03, TRANE, USE D160242, LATEST REV. FOR -G04, AMSTD, USE D160243, LATEST REV.)

- LABEL NOTES:
- LABEL COLOR SHALL BE WHITE BACKGROUND WITH BLACK LETTERS.
 - LABEL MATERIALS:
FILM: NONE
BASE MATERIAL: 0.0035 inch (0.089 mm) WHITE PAPER STOCK
ADHESIVE: PERMANENT ACRYLIC
BACKING: 40 # PAPER, PEELABLE LINER
 - LABEL MUST WITHSTAND SERVICE TEMPERATURE RANGE OF -30° F TO +160° F
 - LABEL DIMENSIONS AND CHARACTER LOCATIONS TO BE AS SHOWN.
 - UNLESS OTHERWISE SPECIFIED ALL TEXT HEIGHT TO BE .100 INCHES.
 - DO NOT PRINT BORDERS OF AREAS RESERVED ON LABELS.
 - TEXT FONT TO BE 'ARIAL' OR SIMILAR.
 - THE ENCODING FOR SERIAL NUMBER DEFINITION ON PRODUCT IS DEFINED IN DS-0085 (SERIAL NUMBERS FOR RS COMFORT CONTROLS)
 - COUNTRY OF ORIGIN MAY BE CHINA, OR MALAYSIA, APPLICABLE MM CODES FOR THESE LOCATIONS ARE DEFINED IN EPI-00171, BARCODE SUPPLIER CODES FOR SERIALIZED PRODUCTS

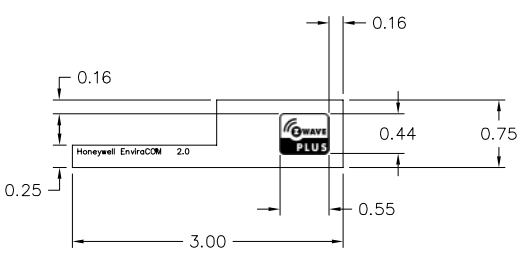

LABEL VIEW "C"
ZWAVE PLUS LABEL

- NOTES: ZWAVE PLUS LABEL
- LABEL COLOR SHALL BE WHITE BACKGROUND WITH BLACK LETTERS.
 - LABEL MATERIALS:
FILM: NONE
BASE MATERIAL: 50# UNCOATED WHITE PAPER STOCK
ADHESIVE: WHITE ACRYLIC, 1 MIL THICK, PERMANENT GENERAL PURPOSE BACKING: 40 # PAPER, PEELABLE LINER
 - LABEL MUST WITHSTAND SERVICE TEMPERATURE RANGE OF -30° F TO +160° F
 - LABEL DIMENSIONS AND CHARACTER LOCATIONS TO BE AS SHOWN.
 - DO NOT PRINT BORDERS OF AREAS RESERVED ON LABELS.

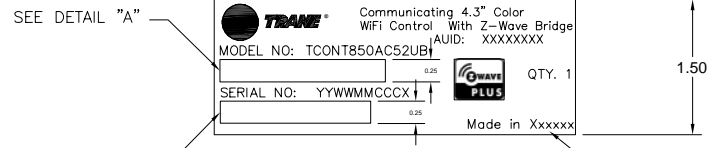

SEE DETAIL "A"
SEE DETAIL "B"

BARCODE DEFINITIONS

(CRITERIA FOR BARCODES TO BE PRINTED IN LOCATION DEFINED BY BOXES)

MODEL NUMBER: TCONT850AC52UB SERIAL NUMBER: YYWMMCCCX

- DETAIL "A"
MODEL NUMBER LABELS WILL BE '1P' + THE MODEL NUMBER ENCODED. FOR EXAMPLE: '1PTCONT850AC52UB'
- DETAIL "B"
SERIAL NUMBER WILL BE 'S' + YYWMMCCCX (FOR YYWMMCCCX DEFINITION, SEE NOTE 8 & 9)

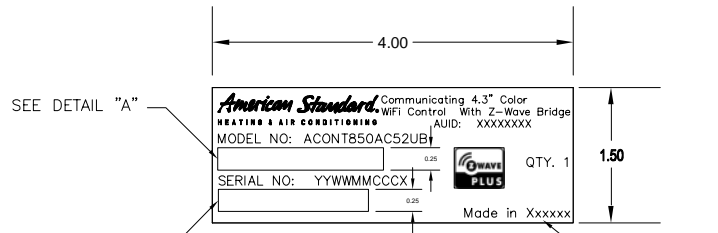

SEE DETAIL "A"
SEE DETAIL "B"

BARCODE DEFINITIONS

(CRITERIA FOR BARCODES TO BE PRINTED IN LOCATION DEFINED BY BOXES)

MODEL NUMBER: ACONT850AC52UB SERIAL NUMBER: YYWMMCCCX

- DETAIL "A"
MODEL NUMBER LABELS WILL BE '1P' + THE MODEL NUMBER ENCODED. FOR EXAMPLE: '1PACONT850AC52UB'
- DETAIL "B"
SERIAL NUMBER WILL BE 'S' + YYWMMCCCX (FOR YYWMMCCCX DEFINITION, SEE NOTE 8 & 9)

LABEL VIEW "A"

Label to be determined by group table shown above.

- NOTES:
- LABEL COLOR SHALL BE WHITE BACKGROUND WITH BLACK LETTERS, AND YELLOW WARNING SYMBOL.
 - LABEL MATERIALS:
BASE MATERIAL: Glossy White Polyester
ADHESIVE: Permanent Rubber Based
 - LABEL MUST WITHSTAND SERVICE TEMPERATURE RANGE OF -30° F TO +160° F
 - LABEL DIMENSIONS AND CHARACTER LOCATIONS TO BE AS SHOWN.
 - UNLESS OTHERWISE SPECIFIED TEST SIZE WILL BE .085 INCH MIN.
 - DO NOT PRINT BORDERS OF AREAS RESERVED ON LABELS.
 - TEXT FONT TO BE 'ARIAL' OR SIMILAR.

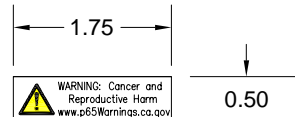

LABEL VIEW "E"
PROP 65 LABEL
(NOTE: QTY: 2)

PCB ASSY LABEL SEE DETAIL "F"

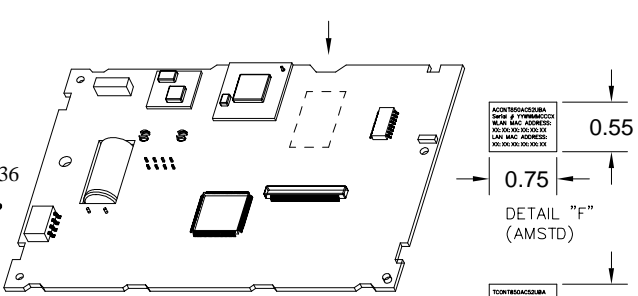

LABEL VIEW "B"
Software Version to be determined by latest released Firmware Dwg, D159136 (Format of Label is determined by software version, SW X.X, or SW X.X.X)

PCB ASSY VIEW REFERENCE ONLY (NOTE: PCB ASSY LABEL APPLIED BEFORE INSERTION IN PLASTICS)

Security Seal, to be applied after the carton is inserted into the sleeve, creating the tamper proof seal

RELEASED 03/Feb/2023 01:46:55 GMT