

1. Bevor Sie beginnen

Paketinhalte

- TEW-805UBH
- Kurzanleitung zur Installation
- CD-ROM (Treiber und Benutzerhandbuch)

Systemanforderungen

- Computer mit USB 2.0 port oder höher)
- Kompatibles Betriebssystem:
 - Windows® 10 , 8.1, 8, 7
 - Mac OS® 10.9 oder neuer

2. Windows® OS-Installation

1. Legen Sie die inbegriffene Installations-CD in das CD-ROM Laufwerk Ihres Computers ein.

Anmerkung: Falls Sie die inbegriffene CD-ROM nicht zur Verfügung haben, können Sie die Treiber herunterladen unter <https://www.trendnet.com/support>



2. Klicken sie im CD Autorun-Eingabeaufforderungsfenster auf "Autorun.exe ausführen".

Anmerkung: Falls das Autorun-Eingabeaufforderungsfenster nicht automatisch erscheint, öffnen Sie bitte die CD-Inhalte und doppelklicken Sie auf Autorun.exe

3. Klicken Sie im CD-ROM Hauptmenü auf "**Treiber installieren**".



4. Folgen Sie den Anweisungen des InstallShield Assistenten und starten Sie den Computer neu, nachdem die Installation abgeschlossen ist. Nachdem der Computer neu gestartet wurde, stecken Sie den TEW-805UBH in einen beliebigen USB-Port an Ihrem PC ein.

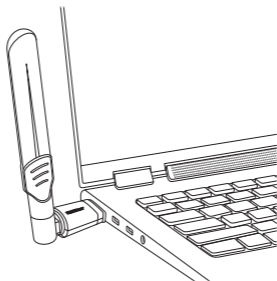

5. Klicken Sie auf das Wireless-Symbol in der Aufgabenleiste unten rechts.



6. Wählen Sie ein Wireless-Netzwerk aus und geben Sie den Wi-Fi Schlüssel ein (Passwort); klicken Sie dann auf **“Weiter”**.

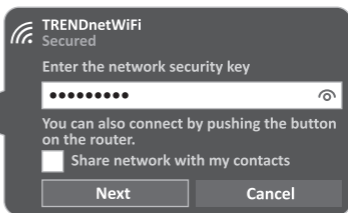

7. Der Status zeigt **“Verbunden”** an, wenn die Verbindung erfolgreich eingerichtet wurde.

Anmerkung: Wenn die Nachricht „Verbunden“ nicht erscheint, prüfen Sie bitte Ihren Wi-Fi Schlüssel (Passwort) und geben Sie ihn erneut ein.

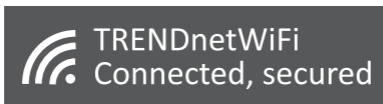

3. Mac® OS-Installation

1. Bitte besuchen Sie <https://www.trendnet.com/support> um den neuesten Treiber herunterzuladen und extrahieren Sie die Dateien per doppelten Mausklick; Sie finden die Dateien auch auf der mitgelieferten CD.

Hinweis: Mini CDs können nur von einem optischen Laufwerk gelesen werden; die Verwendung eines optischen Slots kann Ihren PC beschädigen.

2. Nachdem Sie die Dateien extrahiert haben, öffnen Sie die Datei **Installer.pkg** mit doppeltem Mausklick und folgen Sie den Schritten.



3. Nachdem die Installation abgeschlossen ist, werden Sie aufgefordert, den Computer neu zu starten.

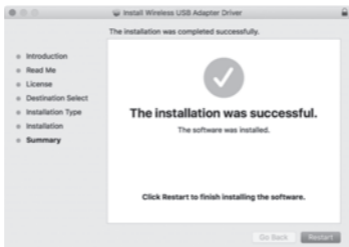

4. Nachdem Ihr Computer neu gestartet wurde, klicken Sie bitte auf das Wireless-Symbol in der Menüleiste ganz oben auf Ihrem Bildschirm.



5. Wählen Sie Ihr Wireless-Netzwerk aus.



6. Geben Sie den Wi-Fi Schlüssel (Passwort) ein und klicken Sie auf "Verbinden".



7. Wenn Sie erfolgreich eine Verbindung zu Ihrem Netzwerk hergestellt haben, ändert sich das Symbol in der Menüleiste zu der Signalstärke, die Ihnen zur Verfügung steht.



Hinweis: Wenn die Nachricht "Verbunden" nicht erscheint, doppelklicken Sie bitte auf Ihren Wi-Fi Schlüssel (Passwort) und geben Sie diesen erneut ein.

1. Antes de comenzar

Contenidos del Paquete

- TEW-805UBH
- Guía de instalación rápida
- CD-ROM (controlador y Guía del usuario)

Requisitos del sistema

- Ordenador con puerto USB 2,0 o superior
- Compatibilidad con sistemas operativos:
 - Windows® 10 , 8.1, 8, 7
 - Mac OS® 10.9 o posterior

2. Instalación bajo Windows® OS

1. Introduzca el CD de instalación incluido en la unidad de CD-ROM de su PC.

Nota: Si no dispone del CD-ROM incluido, puede descargar los controladores desde <https://www.trendnet.com/support>



2. En la ventana de ejecución automática del CD, haga clic en Run (ejecutar) Autorun.exe.

Nota: Si la ventana de ejecución automática no aparece automáticamente, acceda al contenido del CD y haga clic en Autorun.exe.

3. En el menú principal del CD-ROM, haga clic en **Install Drivers** (instalar controladores).



4. Siga las instrucciones del asistente de instalación InstallShield y reinicie la computadora una vez terminada la instalación. Una vez reiniciada la computadora, conecte el TEW-805UBH en un puerto USB de su computadora que esté disponible.

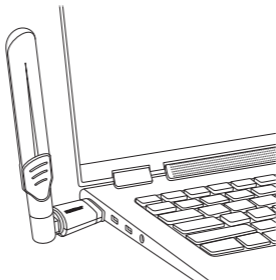

5. Haga clic en el icono wireless de la barra de tareas, en la esquina inferior derecha.



6. Seleccione una red wireless, indique la clave WiFi (contraseña) y haga clic en **Next** (siguiente).

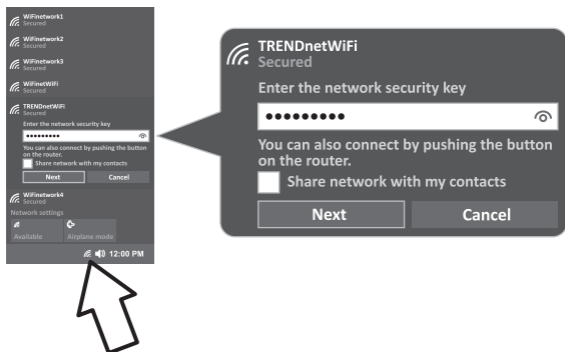

7. El estado será **“Connected”** (conectado) para confirmar que la conexión se ha realizado correctamente.

Nota: Si no aparece el mensaje que confirma la conexión, compruebe su clave WiFi (contraseña) e indíquela de nuevo.

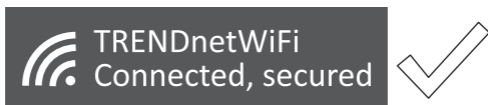

3. Instalación bajo Mac® OS

1. Visite <https://www.trendnet.com/support> para descargar el controlador más reciente y haga doble clic para extraer los archivos; también puede acceder a los archivos utilizando el CD incluido.

Nota: Los mini CD solamente pueden reproducirse con una bandeja óptica; el uso de una ranura óptica puede dañar su computadora.

2. Tras extraer los archivos, haga doble clic en el archivo **Installer.pkg** y siga los pasos.

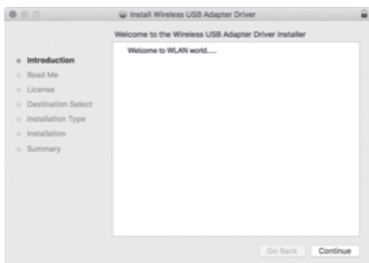

3. Una vez terminada la instalación, se le pedirá que reinicie la computadora.

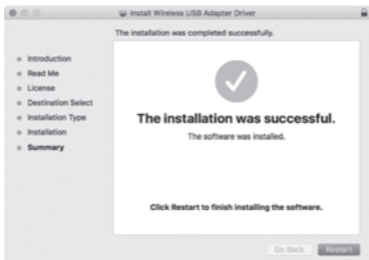

4. Una vez reiniciada, haga clic en el icono wireless situado en la barra de menú en la parte superior de la pantalla.



5. Seleccione su red wireless.



6. Introduzca la clave WiFi (contraseña) y haga clic en **Join** [Unirse].

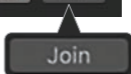

7. Tras conectarse a su red, el icono de la barra de menús cambiará para indicar la fuerza de la señal que tenga.



Nota: Si no aparece el mensaje que confirma la conexión, compruebe su clave Wi-Fi (contraseña) e indíquela de nuevo.

1. Antes de começar

Conteúdo da embalagem

- TEW-805UBH
- Guia de instalação rápida
- CD-ROM (Driver & Guia do Utilizador)

Requerimentos do Sistema

- Computador com porta USB 2.0 ou acima
- Compatibilidade com Sistemas Operacionais:
 - Windows® 10 , 8.1, 8, 7
 - Mac OS® 10.9 ou mais novo

2. Instalação com Windows® OS

1. Insira o CD de instalação incluso na unidade de CD-ROM do seu computador.

Nota: Se você não possui o CD-ROM incluído, você pode baixar os drivers de <https://www.trendnet.com/support>



2. Na janela de prompt de Autorun do CD, clique em executar Autorun.exe.

Nota: Se o prompt Autorun não aparecer automaticamente, abra o conteúdo do CD e clique duas vezes em Autorun.exe.

3. No menu principal do CD-ROM, clique em **Install Driver (Instalar Drivers)**.



4. Siga as instruções do Assistente de Instalação e reinicie o computador assim que a instalação estiver concluída. Após o reinício do computador, conecte o TEW-805UBH a uma porta USB disponível no seu computador.

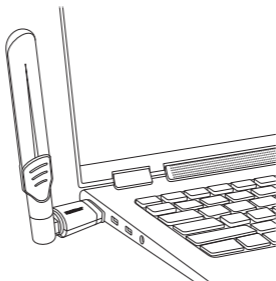

5. Clique no ícone sem fio na barra de tarefas localizada no canto inferior direito.

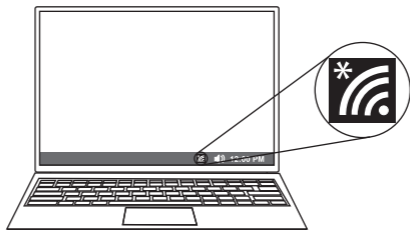

6. Selecione uma rede sem fio e, em seguida, digite a chave Wi-Fi (senha) e clique em **Avançar**.

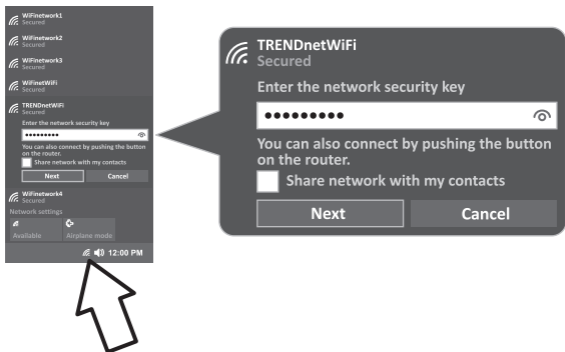

7. O status exibirá "**Conectado**" para indicar uma conexão bem-sucedida.

Nota: Se a mensagem conectada não for exibida, verifique sua chave Wi-Fi (senha) e volte a inseri-la.

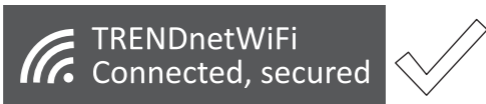

3. Instalação com Mac® OS

1. Acesse <https://www.trendnet.com/support> para baixar o driver mais recente e clique duas vezes para extrair os arquivos ou você pode acessar os arquivos no CD incluído.

Nota: Os Mini CD só podem ser lidos por uma bandeja óptica, o uso de um slot óptico pode danificar seu computador.

2. Depois de extrair os arquivos, clique duas vezes no arquivo **Installer.pkg** e siga as etapas.

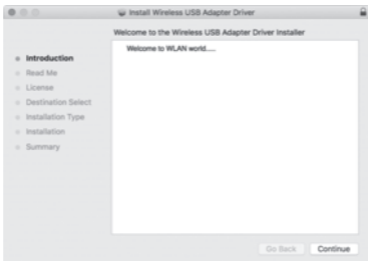

3. Após a conclusão da instalação, será solicitado que reinicie seu equipamento.

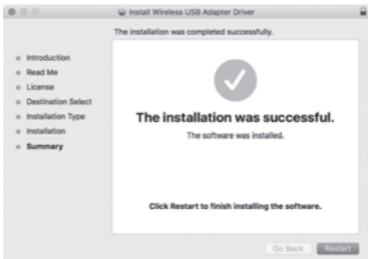

4. Depois que seu computador for reiniciado, clique no ícone sem fio localizado na barra de menu na parte superior da tela.



5. Selecione sua rede sem fio.

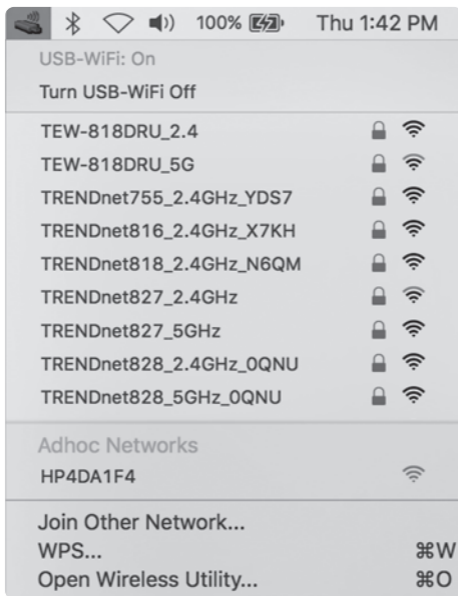

6. Digite a chave Wi-Fi (Senha) e clique em **Join**.



7. Depois de ter se conectado com sucesso à sua rede, o ícone na barra de menu mudará para a força do sinal da rede wi-fi que você selecionou.



Nota: Se a mensagem conectada não for exibida, verifique sua Chave de Wi-Fi (Senha) e volte a inseri-la.

1. Prima di cominciare

Contenuto della confezione

- TEW-805UBH
- Guida di installazione rapida
- CD-ROM (Driver e Guida Utente)

Requisiti di sistema

- Computer con porta USB 2.0 o superiore
- Compatibilità del Sistema operativo:
 - Windows® 10 , 8.1, 8, 7
 - Mac OS® o versione più recente

2. Installazione Windows® OS

1. Inserite il CD di installazione incluso all'interno del drive CD-ROM del vostro computer.

Nota: Se non disponi del CD-ROM incluso, puoi scaricare i driver da <https://www.trendnet.com/support/>



2. Quando si apre la finestra CD Autorun Prompt, clicca su Esegui Autorun.exe.

Nota: Se il prompt di Autorun non appare automaticamente, apri il contenuto del CD e fai doppio clic su Autorun.exe.

3. Nel menu principale del CD-ROM, clicca su **Installa Driver**.



4. Segui le istruzioni della Guida rapida InstallShield e riavvia il computer una volta che l'installazione è completata. Dopo che il computer si è riavviato, inserisci il TEW-805UBH nella porta USB disponibile sul tuo computer.

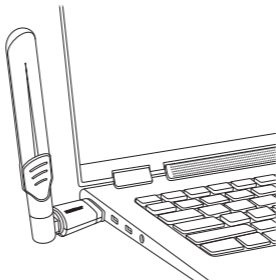

5. Clicca sull'icona wireless nella barra situata nell'angolo in basso a destra.

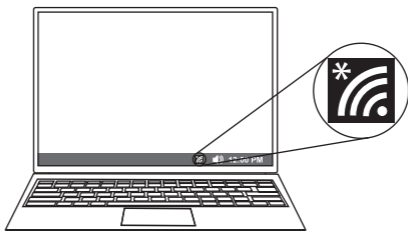

6. Seleziona una rete wireless, quindi digita la Chiave WiFi (password) e clicca su **Avanti**.

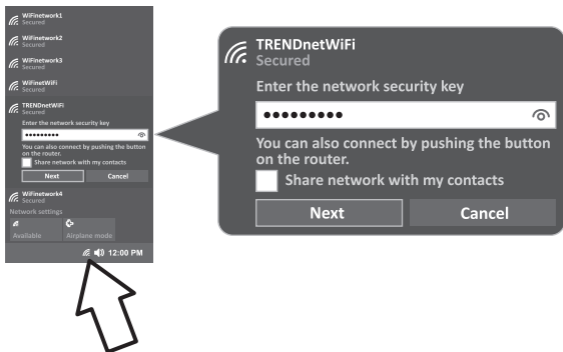

7. Lo stato mostrerà "**Connesso**" a indicare una connessione riuscita.

Nota: Se il messaggio Connesso non viene visualizzato, controlla nuovamente la chiave WiFi (password) e digitala nuovamente.

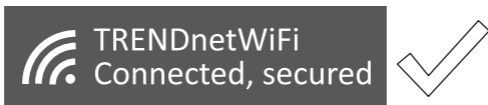

3. Installazione Mac® OS

1. Visita il sito <https://www.trendnet.com/support> per scaricare l'ultima versione del driver e doppio clic per estrarre il file o puoi accedere i file dal CD incluso.

Nota: Il mini CD può essere letto solo su un supporto ottico, utilizzando uno slot ottico puoi danneggiare il computer.

2. Dopo avere estratto i file, fai doppio clic sul file **Installer.pkg** e segui i passaggi indicati.

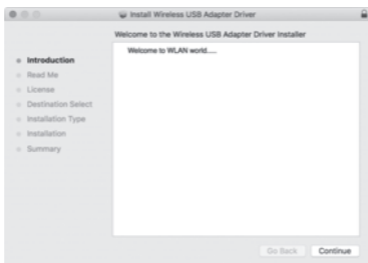

3. Dopo aver completato l'installazione, ti verrà richiesto di riavviare il PC.

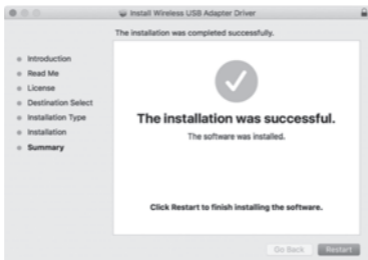

4. Dopo che il computer è stato riavviato, clicca sull'icona wireless presente nella barra del menu situata nella parte superiore della schermata.



5. Seleziona la rete wireless.



6. Inserisci la chiave d'accesso WiFi (Password) e clicca **Join** (Entra).

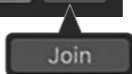

7. Dopo che hai connesso correttamente la tua rete, l'icona nella barra menu cambia in base all'intensità del segnale in uso.



Nota: Se il messaggio di connessione non viene mostrato, effettua un doppio controllo della della chiave d'accesso WiFi (Password) e inseriscila nuovamente.

1. Перед началом работы

Содержимое упаковки

- TEW-805UBH
- Руководство по быстрой установке
- CD-ROM (служебная программа и драйвером)

Требования к установке

- Компьютер с с портом USB 2.0 или выше
- Совместимость с операционной системой:
 - Windows® 10 , 8.1, 8, 7
 - Mac OS® 10.9 или новее

2. Установка Windows® OS

1. Вставьте прилагаемый компакт-диск в дисковод для компакт-дисков.

Примечание: Если у вас нет дисковода для компакт-дисков, вы можете загрузить драйверы с <https://www.trendnet.com/support>



2. В окне «Автозапуск компакт-диска» нажмите «Запустить файл Autorun.exe».

Примечание: Если окно автозапуска не появляется автоматически, откройте содержимое компакт-диска и дважды щелкните на файл Autorun.exe.

3. В главном меню компакт-диска нажмите «Установить драйвер».



4. Следуйте инструкциям InstallShield Wizard и перезагрузите компьютер после завершения установки. После перезагрузки компьютера подключите TEW-805UBH к свободному порту USB вашего компьютера.

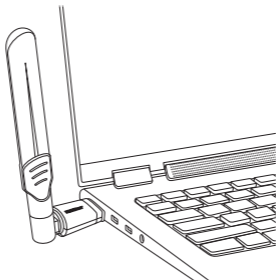

5. Нажмите на значок беспроводной сети на панели задач, расположенной в нижнем правом углу.

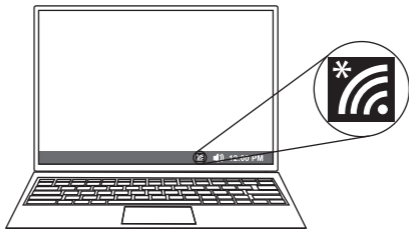

6. Выберите беспроводную сеть, затем введите ключ WiFi (пароль) и нажмите «Далее».

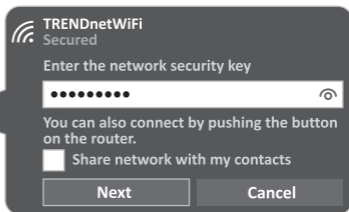

7. Индикатор состояния отобразит «Подключено», это означает, что соединение успешно завершено.

Примечание: Если сообщение о подключении не появляется, еще раз проверьте свой ключ WiFi (пароль) и повторно введите его.

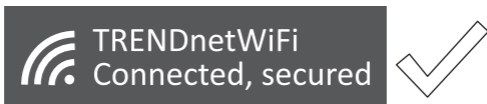

3. Установка Mac® OS

1. Перейдите по адресу <https://www.trendnet.com/support/> чтобы загрузить новейший драйвер, дважды щелкните, чтобы извлечь файлы. Вы также можете открыть файлы на прилагаемом компакт-диске.

Примечание: Мини компакт-диск можно считывать только с помощью оптического лотка, использование оптического слота может повредить ваш компьютер.

2. После того, как вы извлекли файлы, дважды щелкните на файл **Installer.pkg** и выполните дальнейшие инструкции.



3. После завершения установки вам будет **предложено** перезагрузить компьютер.

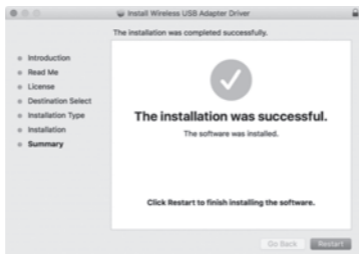

4. После перезагрузки компьютера щелкните на значок беспроводной сети, расположенный в строке меню в верхней части экрана.



5. Выберите свою беспроводную сеть.

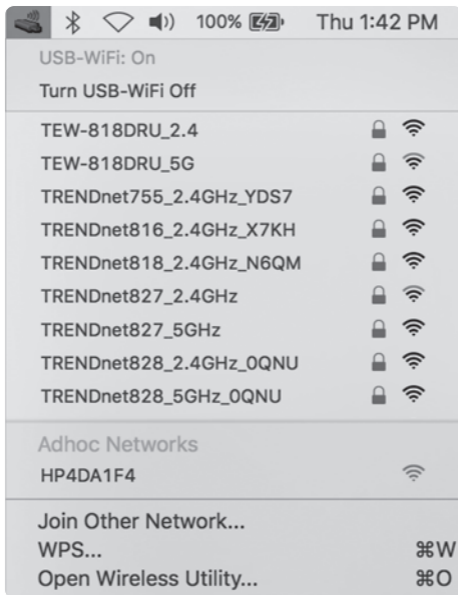

6. Введите ключ WiFi (пароль) и нажмите «Подключиться».



Find and join a Wi-Fi network.
Enter the name and security type of the network you want to join.

Network Name:

Security: WPA/WPA2 Personal

Password:

Show password

Remember this network

? Show Networks Cancel Join

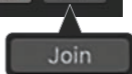

7. После того, как вы успешно подключились к сети, значок в строке меню изменится и будет показывать ваш уровень сигнала.



Примечание: Если сообщение о подключении не появляется, еще раз проверьте свой ключ WiFi (пароль) и повторно введите его.

Declaration of Conformity

TRENDnet®

Manufacturer's Name and Address

TRENDnet, Inc.
20675 Manhattan Place
Torrance, CA 90501 USA

Zwolsestraat 156 2587 WB
The Hague The Netherlands



Product Information:

Model Number: TEW-805UBH
Product Name: AC1200 High Gain Dual Band Wireless USB Adapter
Trade Name: TRENDnet

TRENDnet hereby declare that the product is in compliance with the essential requirements and other relevant provisions under our sole responsibility.

Safety EN 62368-1:2014+A11:2017

EMC EN 301 893 V2.1.1 (2017-05)
EN 301 489-17 V3.2.0 (2017-03)
ETSI EN 301 489-1 V2.2.3(2019-11)
Final draft ETSI EN 301 489-17 V3.2.3(2020-07)
EN 55032:2015+AC:2016-07
EN55035:2017
EN61000-3-2:2019
EN61000-3-3:2013+A1:2019

RF Standard ETSI EN 300 328 V2.2.2(2019-07)
ETSI EN 301 893 V2.1.1(2017-05)

This product is herewith confirmed to comply with the Directives

Directives: EMC Directive 2014/30/EU
Radio Equipment Directive (RED) 2014/53/EU
Low Voltage Directive 2014/35/EU
REACH Regulation (EU) No.1907/2006
RoHS Directive 2011/65/EU
WEEE Directive 2012/19/EU

Person responsible for this declaration.

Place of Issue: Torrance, California, USA

Date: November 12, 2020

Name: Sonny Su

Title: Director of Technology

Signature: _____

A handwritten signature in black ink, appearing to read 'Sonny Su', is written over a horizontal line.



Déclaration de conformité

TRENDNET®

Nom et adresse du fabricant

TRENDnet, Inc.
20675 Manhattan Place
Torrance, CA 90501 USA

Zwolsestraat 156 2587 WB
The Hague The Netherlands



Détails du produit:

Modèle: TEW-805UBH

Nom du produit: Adaptateur USB dual band WiFi AC1200 à gain élevé

Nom Commercial: TRENDnet

TRENDnet déclare par la présente que le produit est conforme aux exigences essentielles et aux autres dispositions pertinentes de la Directive en vertu de notre seule responsabilité.

Sécurité	EN 62368-1:2014+A11:2017
CEM	EN 301 893 V2.1.1 (2017-05) EN 301 489-17 V3.2.0 (2017-03) ETSI EN 301 489-1 V2.2.3(2019-11) Final draft ETSI EN 301 489-17 V3.2.3(2020-07) EN 55032:2015+AC:2016-07 EN55035:2017 EN61000-3-2:2019 EN61000-3-3:2013+A1:2019
RF Standard	ETSI EN 300 328 V2.2.2(2019-07) ETSI EN 301 893 V2.1.1(2017-05)

Ce produit est conforme à la directives suivante.

Directives:	EMC Directive 2014/30/UE Directive Radio Equipment (RED) 2014/53/UE Directive Low Voltage 2014/35/UE REACH Règlement (UE) N° 1907/2006 Directive RoHS 2011/65/UE Directive WEEE 2012/19/UE
--------------------	---

Personne responsable de cette déclaration.

Lieu de délivrance: Torrance, California, USA

Date: 12 Novembre, 2020

Nom: Sonny Su

Position: Director of Technology

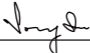
Signature: 



Certifications

This device complies with Part 15 of the FCC Rules. Operation is subject to the following two conditions:

- (1) This device may not cause harmful interference.
- (2) This device must accept any interference received. Including interference that may cause undesired operation.



	AT	BE	BG	HR	CY	CZ	DK
	EE	FI	FR	DE	EL	HU	IE
	IT	LV	LT	LU	MT	NL	PL
	PT	RO	SK	SI	ES	SE	UK

5V --- 900mA



Waste electrical and electronic products must not be disposed of with household waste. Please recycle where facilities exist. Check with your Local Authority or Retailer for recycling advice.

This device is restricted to indoor use

Applies to PoE Products Only: This product is to be connected only to PoE networks without routing to the outside plant.

Note

The Manufacturer is not responsible for any radio or TV interference caused by unauthorized modifications to this equipment. Such modifications could void the user's authority to operate the equipment.

Advertencia

En todos nuestros equipos se mencionan claramente las características del adaptador de alimentación necesario para su funcionamiento. El uso de un adaptador distinto al mencionado puede producir daños físicos y/o daños al equipo conectado. El adaptador de alimentación debe operar con voltaje y frecuencia de la energía eléctrica domiciliar existente en el país o zona de instalación.

Federal Communication Commission Interference Statement

Any changes or modifications not expressly approved by the party responsible for compliance could void your authority to operate the equipment.

This equipment has been tested and found to comply with the limits for a Class B digital device, pursuant to part 15 of the FCC Rules. These limits are designed to provide reasonable protection against harmful interference in a residential installation. This equipment generates, uses and can radiate radio frequency energy and, if not installed and used in accordance with the instructions, may cause harmful interference to radio communications. However, there is no guarantee that interference will not occur in a particular installation. If this equipment does cause harmful interference to radio or television reception, which can be determined by turning the equipment off and on, the user is encouraged to try to correct the interference by one or more of the following measures:

- Reorient or relocate the receiving antenna.
- Increase the separation between the equipment and receiver.
- Connect the equipment into an outlet on a circuit different from that to which the receiver is connected.
- Consult the dealer or an experienced radio/TV technician for help.

This equipment complies with FCC RF radiation exposure limits set forth for an uncontrolled environment. This device was tested for typical lap held operations with the device contacted directly to the human body to the back side of the notebook computer. To maintain compliance with FCC RF exposure compliance requirements, avoid direct contact to the transmitting antenna during transmitting.

Body SAR

This product meets applicable national SAR limits of 1.6W/kg.

This specific maximum SAR values can be found in the section of this user guide. When carrying the product or using it while worn on your body, maintain a distance of 5 mm from the body to ensure compliance with RF exposure requirements.

Technical Support

If you have any questions regarding the product installation, please contact our Technical Support.

Toll free US/Canada: **1-866-845-3673**

Regional phone numbers available at www.trendnet.com/support

Product Warranty Registration

Please take a moment to register your product online. Go to TRENDnet's website at: www.trendnet.com/register

TRENDnet

20675 Manhattan Place
Torrance, CA 90501
USA