

2D FILE:MECE-0092_Label ID-Battery compartment-Micro SD area

8 7 6 5 4 3 2 1

REVISIONS			
REV.	DESCRIPTION	DATE	APPROVED
P0	PRELIMINARY RELEASE	16 JUL 2012	EL
R0	INITIAL RELEASE	16 JUL 2012	EL

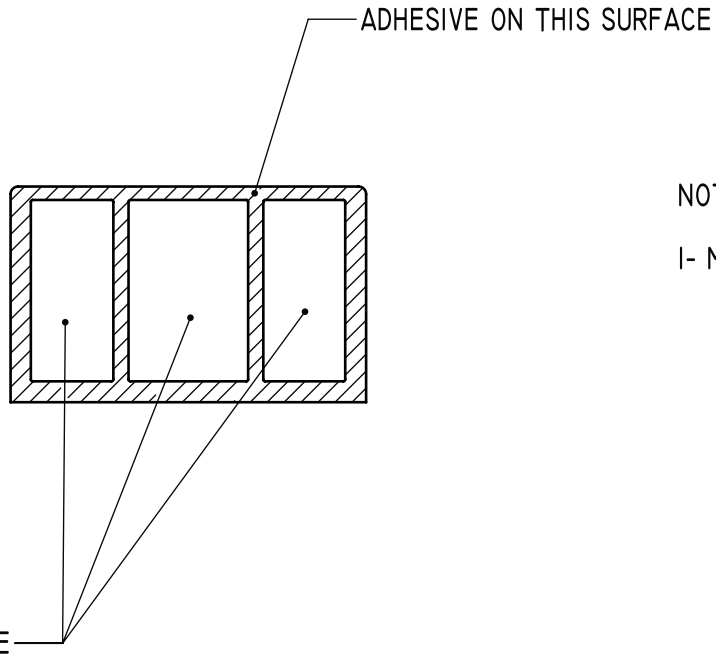
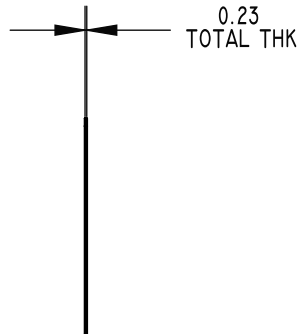
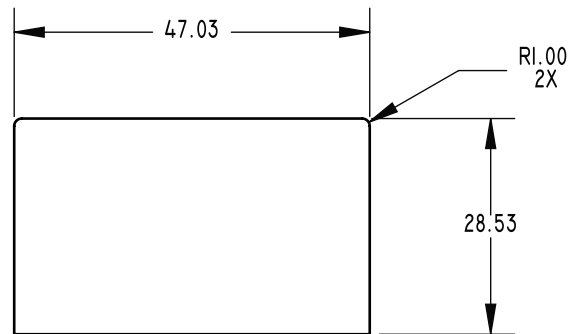
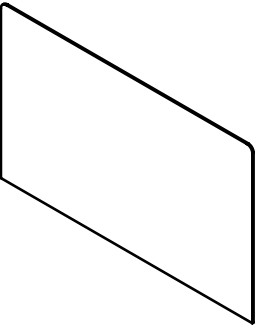

NOTES

- 1- MATERIAL:
 - A-LEXAN CLEAR FINISH (NO TEXTURE) OR APPROVED EQUIVALENT.
 - B-PERMANENT ADHESIVE 3M 467, 200 SERIES OR APPROVED EQUIVALENT.
 - C-THICKNESS OF LEXAN AND ADHESIVE MUST BE 0.25MM ±0.02MM
 - D-MATERIAL AND ADHESIVE SAMPLE TO BE APPROVED BY LB2 PRIOR TO START PRODUCTION.
- 2- PRINTED SAMPLE WITH ADHESIVE TO BE APPROVED BY LB2 PRIOR TO START PRODUCTION.

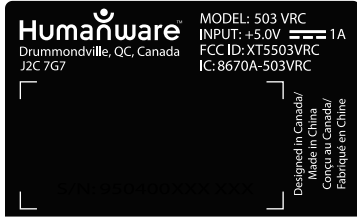

PROPRIETARY AND CONFIDENTIAL THE INFORMATION CONTAINED IN THIS DRAWING IS THE SOLE PROPERTY OF LB2 DESIGN INC. ANY REPRODUCTION IN PART OR AS A WHOLE WITHOUT THE WRITTEN PERMISSION OF LB2 DESIGN INC IS PROHIBITED.		
DESIGN	DATE	UNLESS OTHERWISE SPECIFIED DIM ARE IN MM TOL. ON ANGLE ±5° .X ±.4 MM .XX ±.13 MM THIRD ANGLE PROJECTION
LB2	10/07/2012	
DRAW	DATE	
CR	10/07/2012	
APPROVED	DATE	
EL	10/07/2012	

CLIENT: HUMANWARE PLATO 6465 AVENUE DUROCHER, BUREAU 302 MONTRÉAL, QC, CANADA H2V 3Z1 TEL. 514-273-5107 FAX. 514-273-6196 STUDIO@LB2DESIGN.COM WWW.LB2DESIGN.COM		
PROJECT: BATTERY COMPARTMENT LABEL, MICRO SD AREA		
TITLE: BATTERY COMPARTMENT LABEL, MICRO SD AREA	SIZE: B	3D FILE NO.: BATTERY COMPARTMENT LABEL-I
SCALE: 1:1	DWG NO.: MECE-0092_RI	SHEET: 1 OF 1

8 7 6 5 4 3 2 1

