

ring  
Contact Sensor



## Home security beyond the front door

Ring Video Doorbells began a Ring of Security around your entire property.

Ring Protect is the security system that takes the Ring of Security a step further giving you another level of protection for your property.

Now, you can arm and disarm your system, prevent crime and protect your home - all from your phone, tablet or PC.

## Contents

1. Diagram
2. In-app Setup
3. Connecting the Device
4. Physical Installation
5. Troubleshooting

# 1. Say hello to your Ring Contact Sensor.

## Diagram

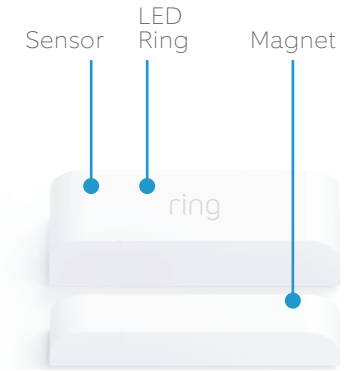

# 2. Set up your Ring Contact Sensor in the Ring app.

## Set up your Ring Contact Sensor near your Base Station

In the Ring app, choose **Set Up a Device**.

Choose **Sensors**, then **Ring Contact Sensor**, then tap **Add Device**.



# 3. Connect your Ring Contact Sensor to your base station.

## Scan the QR Code or enter the S2 PIN

The QR Code and PIN can be found on the back of your device, on the box, or on the card in this box.

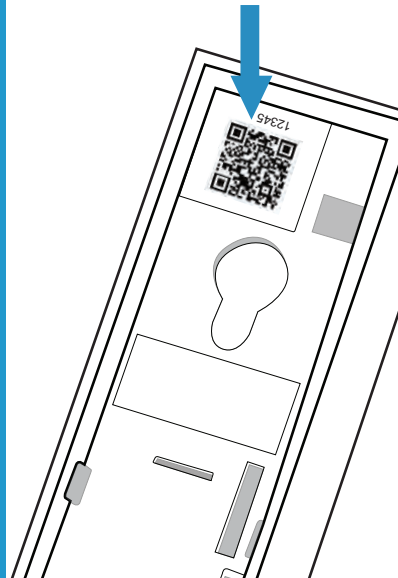

## Pull the tab on the sensor



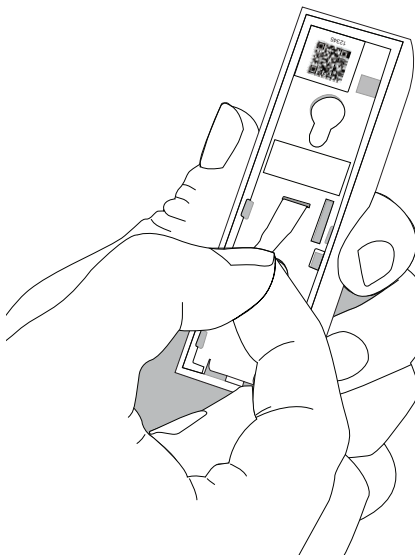

This connects the battery and turns on the device. Your base station will find it.



Track the connection progress of the sensor

Your sensor will try to connect to your base station. The sensor's LED ring will show the progress.

Here are some common LED patterns:

- Waiting to connect  Blue Blinking (30 sec)
- Connected  Blue Solid (5 sec)
- Couldn't add to base station  Blue Blink (5x, quick)
- Door or window open  Blue Blink (1x)
- Sensor tampered  Blue Blinks (3x)

Open and close the sensor to test it  
Make sure the app shows that the sensor is open when you pull it apart.

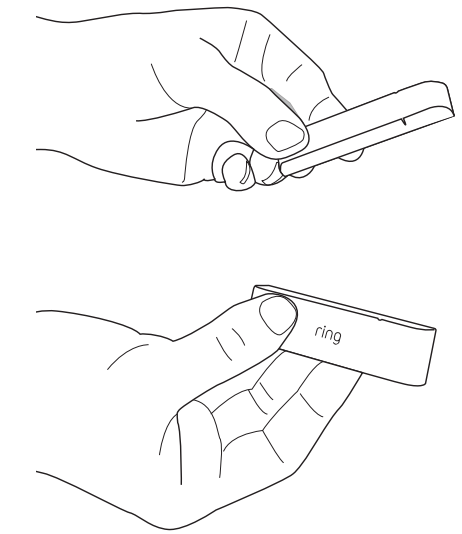

## 4. Install your Ring Contact Sensor on the wall.

Place your sensor (but don't install it yet)  
Hold the sensor where you want to install it. Place it near an edge of the door or window that will move.

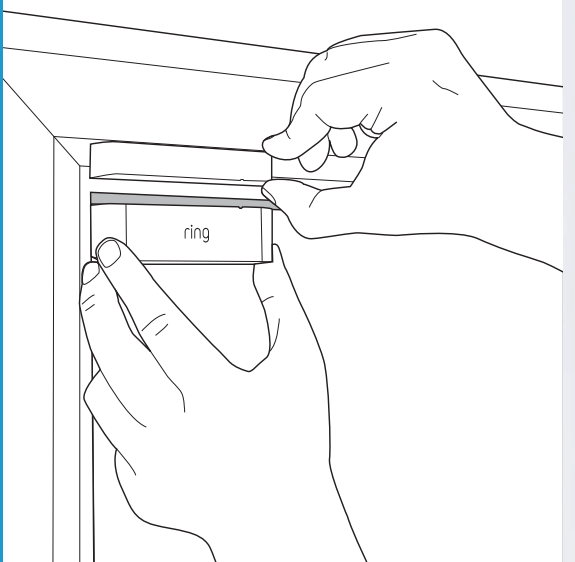

Align the magnet and the sensor  
Place the magnet on the trim near the sensor so that the lines on the sensor and magnet are parallel. The magnet and sensor can be a maximum of 1/2" apart.



Install your sensor on a door or window.  
Use the bracket and tape or screws included in your kit.

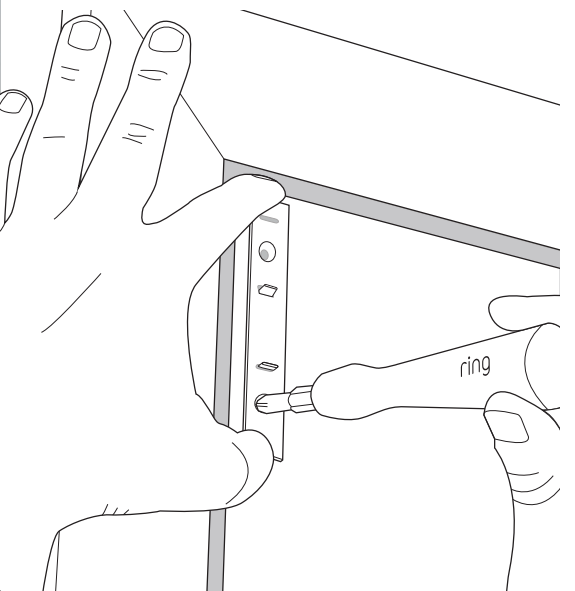

View sensor history in the Ring app  
You should have a few history events from installing your sensor. Check your app to make sure it's working.

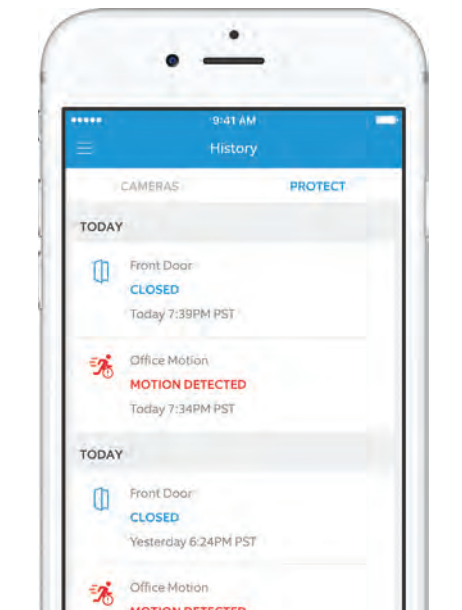

## 5. Some additional details about your sensor.

How to change the battery  
Your battery should last quite a long time, but when you need to replace it, press the clip and remove the sensor cover.

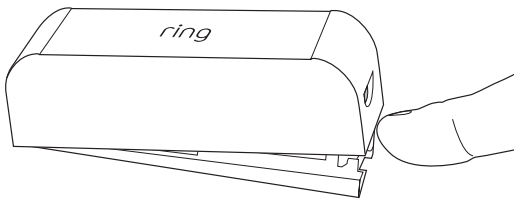



ring 1523 26th St.  
Santa Monica, CA 90404

This device complies with Part 15 of the FCC Rules. Operation is subject to the following two conditions: (1) This device may not cause harmful interference, and (2) this device must accept any interference received, including interference that may cause undesired operation.

This device complies with Industry Canada's licence-exempt RSSs. Operation is subject to the following two conditions: (1) This device may not cause interference; and (2) This device must accept any interference, including interference that may cause undesired operation of the device.

CAN ICES-3 (B)/NMB-3(B) – This Class B digital apparatus complies with Canadian ICES-003.

Cet appareil numérique de la classe B est conforme à la norme NMB-003 du Canada.

The FCC ID of the device in this package can be found on the back or bottom of the device.

#### CAUTION

To reduce the risk of electrical shock, DO NOT open the unit. There are no user serviceable parts inside the unit. Refer to customer support for any repairs.

#### CAUTION

Danger of explosion if battery is incorrectly replaced. Replace only with the same of equivalent type recommended by the manufacturer. Dispose of the used batteries according to the manufacturer's instructions.

**WARNING:** Changes or modifications to this unit not expressly approved by the party responsible for compliance could void the user's authority to operate the equipment.

**NOTE:** This equipment has been tested and found to comply with the limits for a Class B digital device, pursuant to Part 15 of the FCC Rules. These limits are designed to provide reasonable protection against harmful interference in a residential installation. This equipment generates, uses, and can radiate radio frequency energy and, if not installed and used in accordance with the instructions, may cause harmful interference to radio communications.

However, there is no guarantee that interference will not occur in a particular installation. If this equipment does cause harmful interference to radio or television reception, which can be determined by turning the equipment off and on, the user is encouraged to try to correct the interference by one or more of the following measures:

- Reorient or relocate the receiving antenna.
- Increase the separation between the equipment and receiver.
- Connect the equipment into an outlet on a circuit different from that to which the receiver is connected.
- Consult the dealer or an experienced radio/TV technician for help.



Le présent appareil est conforme aux CNR d'Industrie Canada applicables aux appareils radio exempts de licence. L'exploitation est autorisée aux deux conditions suivantes : (1) l'appareil ne doit pas produire de brouillage, et (2) l'utilisateur de l'appareil doit accepter tout brouillage radioélectrique subi, même si le brouillage est susceptible d'en compromettre le fonctionnement.

Protect the device from direct sunlight. Install the device at dry locations, and protect it against rain and humidity. The device may not get in contact with salt water or other conductive liquids. The device must be charged only within a building in a dry state.

This device may not be disassembled and used for any other purpose. This unit, and all the components are configured for the sole purpose of providing a security. They are not approved for individual cellular use, battery use or other mishandling.

A mobile app must be used to set up the device.

This device is not an Access point or Hotspot and should not be used as one.

