

Wireless GIGAPHONE **GIGA M**

USER GUIDE



**GIGAM**

## Wireless and Now with Stereo!

High Quality Sound with No Distortion – GIGAM

Rich in Volume, 40W(20W+20W) Great Output  
Accurate Original Sound, Crystal Clear Sound,  
Dual System with Wire/Wireless Microphone.  
The abundance of stereo sound that fills space with wireless  
convenience.



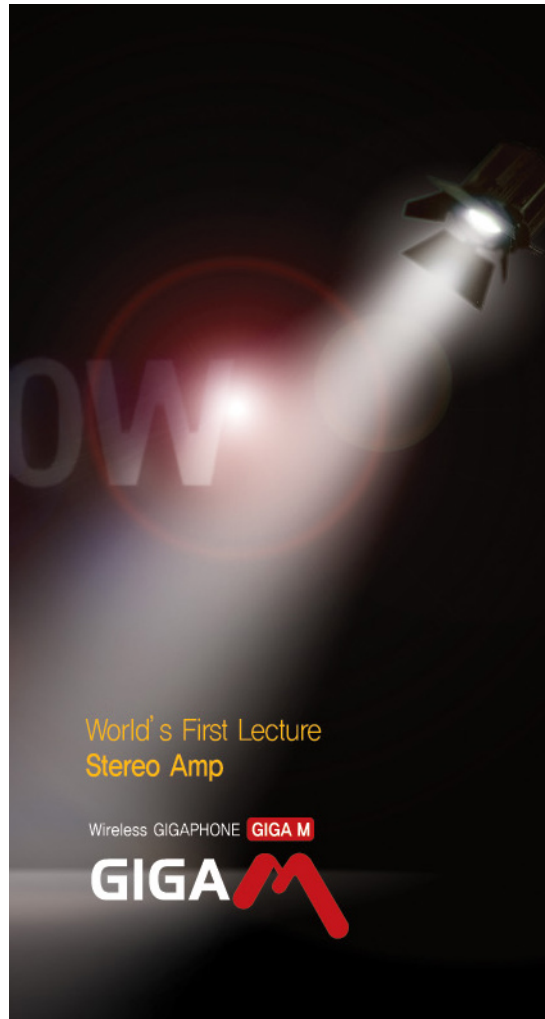

1999 / GIGAPHONE Launch  
2000~2008 / Continuous Technology Development  
and Customer Satisfaction  
2009 / WIRELESS GIGAPHONE "GIGA M"  
RELEASE

FCC notice to users and product statements  
THIS DEVICE COMPLIES WITH PART 15 OF THE FCC RULES.  
Operation is subject to the following two conditions; (1) this device may  
not cause harmful interference, and (2) this device must accept any  
interference received, including interference that may cause undesired  
operation. CAUTION: Changes or modifications not expressly approved  
by the party responsible for compliance could void the user's authority to  
operate the equipment.

## I N D E X

- 2 JUNSUNG TECH "GIGA M"
- 4~5 What is **GIGA M**?
- 6~7 Names and Features of the Product
- 8~9 Product Configuration and Specification
- 10~17 How to Use
- 18~19 Product Warranty

## What is **GIGA M** ?

GIGA M is the world's first wireless single body lecture amplifier. This GIGAPHONE is one of the smallest of its class that has great power output producing a crystal clear sound with no signal jams.

This is an excellent product created with patented technology. The company Junsung Tech is now making a new legend of wireless microphones after the great success of the GIGAPHONE series.



GIGA M Wireless Microphone(MG-77) is small and has various methods for usage. You can easily control the volume and mute function.



### External Device

MP3, Notebook, Desktop PC, PSP, PMP, Mobile phone can be connected to the GIGA-M MG-3300 (AUX). The clean and clear sound is hearable from the GIGA-M MG-30 stereo speaker and the main body while also using the Wireless Microphone MG-77 during lectures. (It is possible to simultaneously use the Wireless and Wired Microphone AUX)



## Names and Feature of the Product

### SPECIAL FEATURE

#### **GIGA M MG-3300**

- Rich stereo sound when connected external audio instrument to AUX.
- Powerful output among it's class. (20W+20W)
- Available to connect wireless Mic., wired Mic., and external devices simultaneously.
- The Wired and Wireless Mic can be used simultaneously after connecting the audio device in the AUX.
- Control the volume, when using external devices.
- Display status of wireless connection and residual battery through LCD screen.
- Use the MG-30 (speaker) with and without connection .
- Long lasting battery and short recharging time due to lithium-polymer battery.

#### **GIGA M MG-77**

- Delivering crystal clear sound by 2.4GHz digital method.
- No frequency hopping interference..
- Polishing design that emphasizing convenience.
- Easy to use Mic. with mute, volume control function.
- Convenient user-interface with mini-Mic. and Iset Mic.
- Easy to notice the status of battery charge and connectivity through LED screen

## PRODUCT CONFIGURATION



PACKAGE INCLUDES

## PACKAGE INCLUDES



MG-3300 (Main Body)



MG-30 (Stereo Speaker)



MG-77 (Wireless Microphone)



Mini-Microphone



Adapter



i-set Mic



i-set Body



MG-77Case (Necklace Style)



Bag



Shoulder Strap



MG-30 Stereo Connector



User Guide

※ Mini-microphone is connected to wireless microphone when packaging product.



## PRODUCT SPECIFICATION

### GIGA M MG-3300

Item	SPECIFICATION
Max Power Output	20W + 20W (stereo power)
Distortion	5% max(at 15W output)
SPL	94dB/W ± 2dB
Hum & Noise	50dB Min
AF Response	±2dB (at 140Hz ~ 15KHz)
Current Consumption	5A Max
Power Source	Li-Polymer 3.7V X 2
Size	112 X 136 X 45mm (W, H, D)
Weight	480gram

### GIGA M MG-77

Item	SPECIFICATION
Time of Use	12h (Talking time)
Charging Time	2.5 Hours
Power Source	Li-Polymer 3.7V
Size	28(W) X 73(H) X 22(D) mm
Weight	28gram

Item	SPECIFICATION
Used Frequency	2,406 ~ 2,478 GHz
Modulation Method	GFSK
Operation Temperature	-10°C ~ 50°C

Channel	0	1	2	3	4	5	6	7	8	9	10	11	12	13	14	15	16	17	18
Freq.(MHz)	2406	2407	2408	2410	2412	2414	2416	2418	2420	2422	2424	2426	2428	2430	2432	2434	2436	2438	2440
Channel	19	20	21	22	23	24	25	26	27	28	29	30	31	32	33	34	35	36	37
Freq.(MHz)	2442	2444	2446	2448	2450	2452	2454	2456	2458	2460	2462	2464	2466	2468	2470	2472	2474	2476	2478

## Manual (How to Use)

### 1. Main Body(MG-3300) On/Off

- ① Press power switch for 2 seconds to turn it on.
- ② LCD Battery indicator on top of the Main Body will show as soon it is turned on.
- ③ The connecting icon (📶) will blink on the LCD when connected to the Wireless Mic.
- ④ Press the power switch for 5 seconds to turn it off.

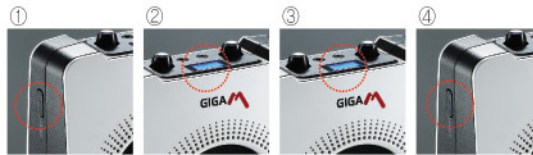

### 2. Wireless(MG-77) On/Off

- ① Move up the power switch on the left side of wireless Mic, to turn it on.
- ② When the power is on, red LED blinks and it goes to waiting mode for connection with the main body
- ③ Move down the power switch on the left side of wireless Mic, to turn it off.



### 3. Connecting the Main Body and the Wireless Mic.

- ① Turn on both the Main Body and Wireless Mic.
- ② When both connected, the LED on the Mic, blinks in red per 1 second and then connecting icon(📶) will display on the Main Body LCD screen.
- ③ Press the CH button and the LED on the Wireless Mic, will change green and become in status ready to use. (Voice transmission)



### 4. Using the Wireless Mic. Mute and Volume Control.

- ① Press  $\Delta$  V button to control the volume.  
Once the volume is set, the level stays the same despite turning it On/Off.
- ② Press the MU button (mute function button) just once to mute the volume.
- ③ When muted, the LED blinks red and green alternatively.
- ④ To use Mic, again, press the MU button one more time. (LED turns in green)



## Manual

### 5. Low Battery Sign

- ① Low battery sign can be checked by the LCD. Recharge when battery status gauge goes down to one bar.
- ② When the Mic, and the Main Body are connected, the LED blinks green when the battery is low. The low battery indication will not be shown when muted.



---

### 6. Built-in Battery

- ① The Main Body and the Wireless Mic, have built-in rechargeable lithium-polymer battery.
- ② Because the built-in battery is easily detachable, it is easy to replace when no longer in use.



## 7. Recharging battery in Main Body and Wireless Mic.

- ① Recharge the battery when the battery meter is below 1 bar.
- ② A charger adapter (DEP-0920A) included in the package consists 2 type of connection jacks which is able to recharge the main body and wireless Mic, at the same time.
- ③ As you can see below the page, when the connection jack is connected in the DC IN, the LCD screen which indicates the battery meter will blink 0~4 bars consecutively. There will be four solid bars once it is fully charged.
- ④ The red LED is on when the charger adapter is connected to the USB terminal for charging. The green LED is on after the battery is completely recharged.
- ⑤ After 3~4 hours of charging, the battery meter will show 4 bars with the LED switching from red to green. This is an indication that the battery has been fully recharged.
- ⑥ The battery runs more than 20 hours after a full complete recharge. (company's experimental result)
- ⑦ The charge time for the Wireless Mic,(MG-77) is about 2~3 hours. It runs more than 10 hours afterward.

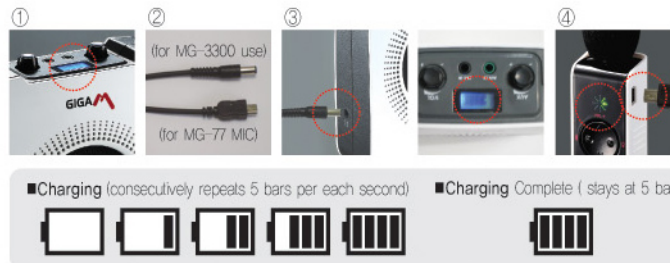

### 8. re-registering the Main Body and Wireless Mic.

- ① We recommend you to register or re-register the Wireless Mic. (MG-77) in case of loss or having any trouble.
- ② Registration process:
  - a) Open battery cover of main body, and press power switch for 2 seconds with pressing reset switch inside.
  - b) Blinking wireless connection icon (📶) of LCD screen in main body.
  - c) Turn on power switch (🔘) by pressing CH button (🔘).
  - d) The red LED will turn and start to blink after properly registering the Wireless Mic

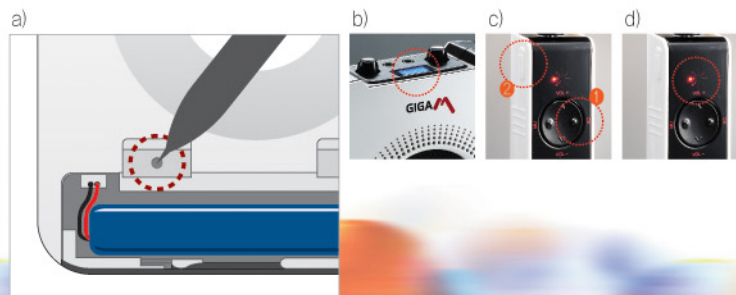

### 9. The proper method using the wireless Mic. And (Mini Mic.)

- ① Connect Mini Mic. to Mic. terminal with hooking-up wireless Mic. in necklace case.
- ② Wear the necklace on your neck. Adjust the strap with the stopper on the rear side of the necklace case.
- ③ Position the Mini Mic. just 10cm below the chin.
- ④ For a louder sound, we suggest using it as a Hand Mic.
- ⑤ It is convenient because the necklace makes the Mic. Hand-free and fixes the position.

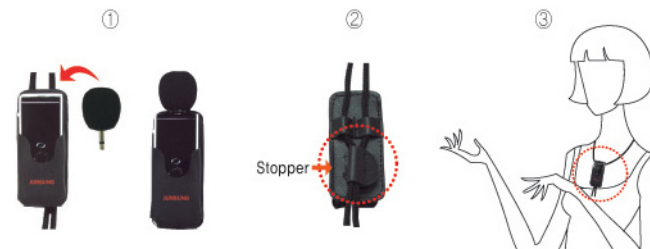

- ⑥ Connect the i-set Mic, to the main body(MG-3300) through the MIC IN on top, (used for both wired and wireless)
- ⑦ Use the i-set Mic, Hands-free
- ⑧ Connect the i-set Mic to the i-set body, Then wear the i-set body on your head and connect the i-set Mic terminal to the Wireless Mic terminal
- ⑨ Face the logo in the middle of the i-set Mic upward and place it on the i-set pin holder.

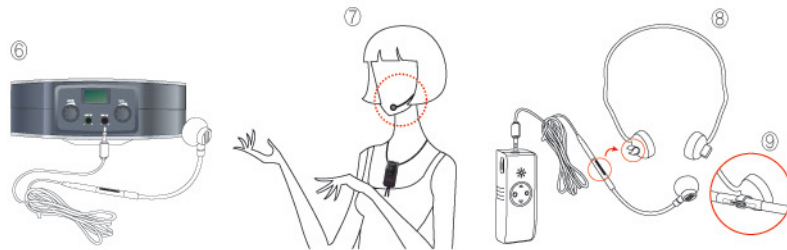



## 10. Connecting the Stereo Speaker (MG-30)

- ① Connect the stereo connecting cord to the SPK(Speaker) OUT and MG-3300 (Main body) on the side. Then the SPK(Speaker) IN on the side of MG-30.
- ② GIGA-M allows you to use the Mic both wired and wireless. This is an excellent wireless amp for lectures and can also be used for multipurpose such as listening to music, English conversations, Q&A.



Warning: The MG-3300 Speaker output is 20W, Anything below 20W is prohibited.

## Quality Guaranteed

We guarantee that the product has no manufacturing or material status defect up to one year for the Main Body, 6 months for (Mini-Microphone, Wired Microphone, and Consumables) after the products have been purchased. The users' responsibility and extent of the product warranty that are not stated here follows consumer protection law and fair trade law.

Corresponding Wireless equipment can not provide services related to safety as it has possibility to cross.

### Applying after Service

- ① You can apply for after service on our website, agency, or the store you have bought the product.
- ② To request for an after service, please use the company you selected and write your contact number and personal information.

### Consumer Responsibility

- ① **Our company issues product warranty on the website.**
- ② For the security of our customers personal information, we do not require the resident registration number when we issue a product warranty.
- ③ Product warranty is valid only when consumers submit the required information with their real name.
- ④ The customer is responsible for the delivery charge when the customer returns the product even if the product has no defect within 7 days after the product purchase.

**PRODUCT NAME****GIGA M**

- **Our company issues and registers the product warranty on our website. ([www.gigam.co.kr](http://www.gigam.co.kr))**
- You may not be able to receive full customer services from our company, if you do not register the product warranty online.

- ① This product has been through a strict quality control and inspection process.
- ② Warranty repair service covers breakdown under normal usage within the warranty period without additional charge.
- ③ Even if the product is within the warranty period, repair charge may be imposed for charged services listed in the warranty certificate.
- ④ The Product Warranty is only valid domestically.
- ⑤ When the product goes out of order, please contact our customer satisfaction center at the head office, agency, or the store you have purchased the product.

**Charged Services**

- ① When we cannot confirm the warranty period because the consumer didn't register for the warranty certificate.
- ② Defects occurred by any carelessness.
- ③ Defects occurred by any repair or remodel from customer.
- ④ Defects occurred by any natural disasters. (e.g. fire, sea water, water and etc.)
- ⑤ When warranty period of product is expired.
- ⑥ When any consumption goods were bought.



## CAUTION

Failure to follow the following instructions may result in physical damage.  
Please read carefully and use properly.

- Charging of the product must be done with the charger (DEP-0920A).
- For first time use after purchasing the product, fully charge the battery before use.
- Do not separate the battery from the main body.
- As the battery pack is a consumable, useful life may shorten inconsistently by the environment of use and elapsed time. If the battery needs to be replaced because of its remarkably shortened life, please contact our customer service center.
- Danger! The product may catch on fire, heat, up or explode in the following conditions :
  - If water or liquid gets into the product
  - If the product is used outdoors on a rainy or snowy day
  - If charged unnecessarily for an extended period of time
  - If the product receives severe shock and impact or approached by fire
  - If foreign material gets into the product or become exposed under high temperature
  - If the battery terminal is wet or contacted by metal product or metal fiber
- Do not charge and store in humid or a hot area.
- Store the product at a temperature range 0~40°C.

Name of the product: Specific low power wireless device for wireless data communication system      Manufactured by: Junsungtech Co.,Ltd.  
Model name: GIGAM MG-3300/MG-30/MG-77      Manufactured in: Korea  
Certification sign: JPA-MG3300, JPA-JSM77



**Junsungtech Co., Ltd**

Head office: Life Science Hall 635, Korea Univ., Anam-dong 5(o)-ga, Seongbuk-gu, Seoul, Korea  
Customer satisfaction center: Junsungtechville 448-2, Shinwol 2 dong, Yangcheon-gu, Seoul, Korea  
Telephone: 1544-8250, 02-2697-2094/5, 02-2601-8793  
Fax: 0505-270-8250, 02-2694-2093  
E-mail: gigaphone@naver.com      [www.gigam.co.kr](http://www.gigam.co.kr)