

 dashbon

flicks

Quick Start Guide

TURN ON THE MASTER SWITCH

You won't be able to operate Flicks without turning on the master switch located at the bottom of Flicks

CHARGE YOUR FLICKS

Fully charge your Flicks using the included power adapter before first use. It would take approximately 4 to 10 hours to fully charge your Flicks depending on the Flicks models you purchase.

- 140WH Flicks model fully charged in 4 to 6 hours
- 280WH Flicks model fully charged in 8 to 10 hours

WATCH MOVIES ON FLICKS

TURNING ON PROJECTOR

1. Press and hold the projector power button for 2 seconds to turn on the projector. The speakers will turn on automatically along with the projector so you don't need to do anything else.
2. Connect Flicks to your HDMI-compatible device using the included HDMI cable.

ADJUSTING VOLUME

Adjust the volume of your movie by pressing the + and - buttons located on the top panel of Flicks.

ADJUSTING FOCUS

Rotate the focus ring clockwise/counterclockwise to sharpen the image.

TURNING OFF PROJECTOR

Press and hold the projector power button for 2 seconds and follow the on-screen instruction to turn off the projector by pressing the projector power button again.

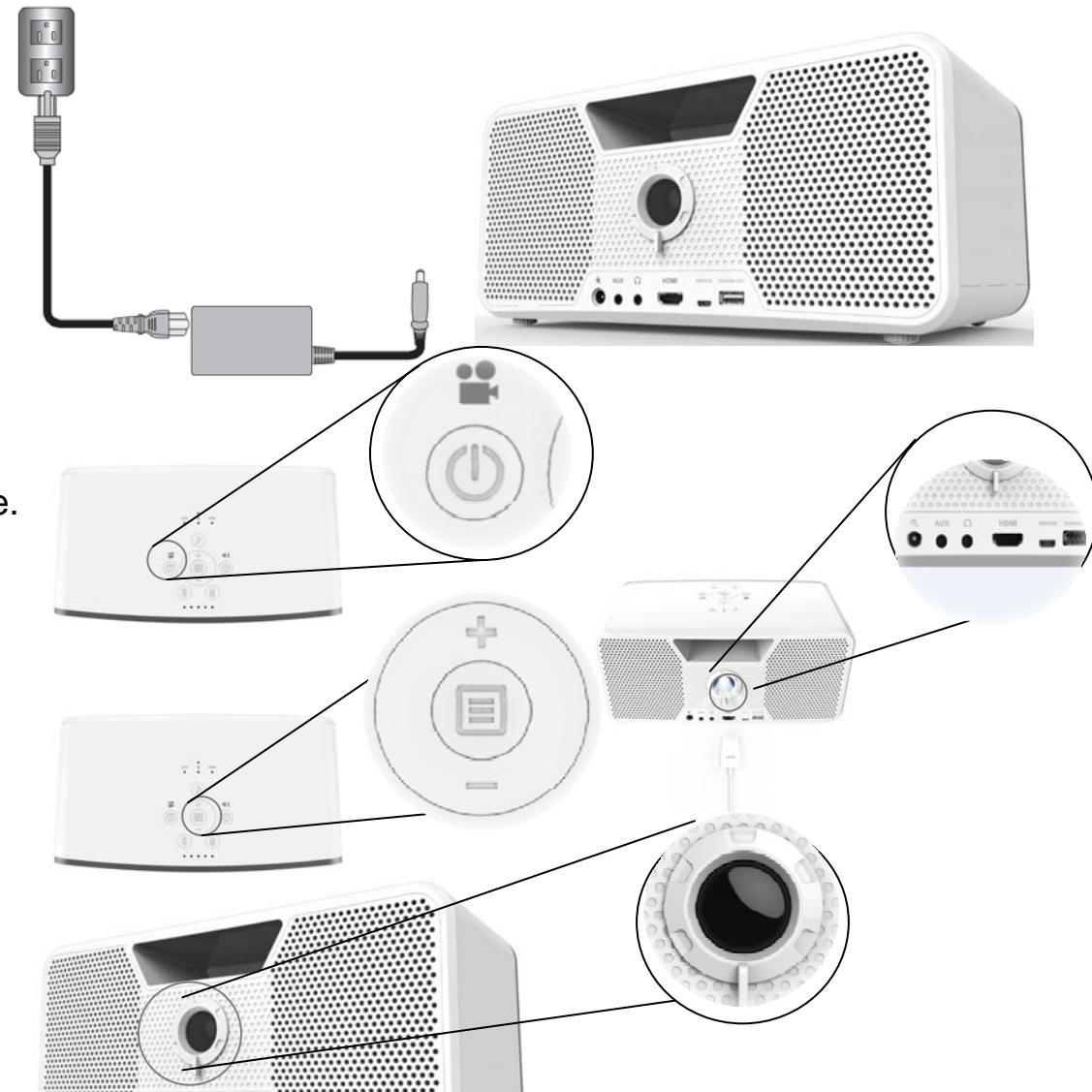

LISTEN TO BLUETOOTH MUSIC ON FLICKS

TURNING ON SPEAKER

1. Press and hold the speaker power button for 2 seconds to turn on the speakers.
2. Turn on Bluetooth on your Bluetooth-enabled device.
3. When prompted, select "Dashbon Flicks" to pair. It may take up to a minute to pair.

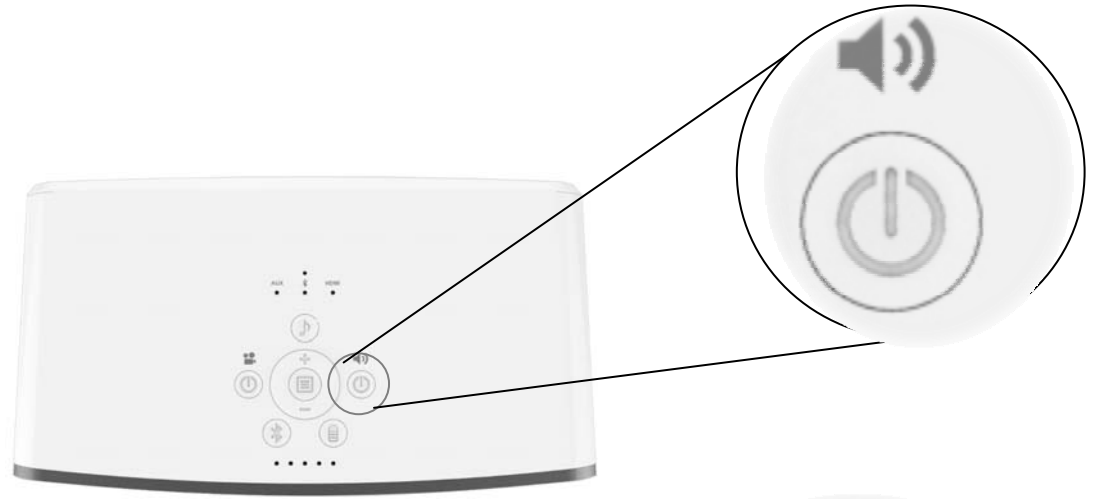

ADJUSTING VOLUME

Adjust the music volume by pressing the + and - buttons located on the top panel of Flicks or the volume buttons on your Bluetooth-enabled device.

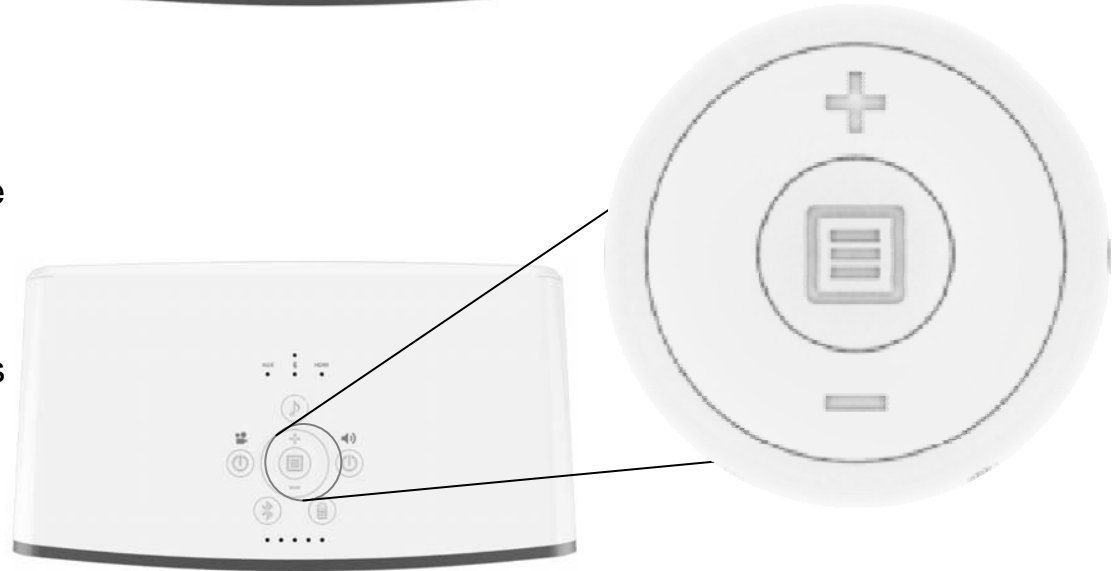

TURNING OFF SPEAKER

Press and hold the speaker power button for 2 seconds to turn off the speaker.



WARNING !



Do not look directly into the projector beam

SAFETY



The lightning flash with arrow-head symbol within an equilateral triangle is intended to alert the user to the presence of uninsulated “dangerous voltage” within the unit’s enclosure that may be of sufficient magnitude to constitute a risk of electric shock.



The exclamation point within an equilateral triangle is intended to alert the user to the presence of important operating and maintenance (servicing) instructions in the literature accompanying the unit.

WARNINGS

- To reduce the risk of fire or electrical shock, do not expose the product to rain or moisture.
- Do not expose this apparatus to dripping or splashing, and do not place objects filled with liquids, such as vases, on or near the apparatus. As with any electronic products, use care not to spill liquids into any part of the system. Liquids can cause a failure and/or a fire hazard.
- Do not place any naked flame sources, such as lighted candles, on or near the apparatus.
- Do not use any charger other than that specifically provided for use with the equipment.
- The battery needs to be charged before use. Always use the correct charger and refer to the manufacturer's instructions or equipment manual for proper charging instructions.
- After extended periods of storage, it may be necessary to charge and discharge the battery pack several times to obtain maximum performance.
- The battery pack gives its best performance when it is operated at normal room temperature (68°F +/- 23°F or 20°C +/- 5°C).
- Do not leave a battery on prolonged charge when not in use.
- The battery pack shall not be exposed to excessive heat such as sunshine, fire or the like.
- Do not subject battery pack to mechanical shock.
- In the event of fluid from the battery leaks from the equipment, do not allow the liquid to come in contact with the skin or eyes. If contact has been made, wash the affected area with copious amounts of water and seek medical advice.
- Do not use any battery pack which is not designed for use with the equipment.
- Keep battery pack clean and dry.
- For battery replacement, please contact Dashbon Customer Service.

IMPORTANT SAFETY INSTRUCTIONS

1. Read these instructions.
2. Keep these instructions.
3. Heed all warnings.
4. Follow all instructions.
5. Do not use this apparatus near water.
6. Clean only with a dry cloth.
7. Do not block any ventilation openings. Install in accordance with the manufacturer's instructions.
8. Do not install near any heat sources such as radiators, heat registers, stoves, or other apparatus (including amplifiers) that produce heat.
9. Only use attachments/accessories specified by the manufacturer.
10. Unplug this apparatus during lightning storms or when unused for long periods of time.
11. Refer all servicing to qualified personnel. Servicing is required when the apparatus has been damaged in any way, such as power-supply cord or plug is damaged, liquid has been spilled or objects have fallen into the apparatus, the apparatus has been exposed to rain or moisture, does not operate normally, or has been dropped.
12. Do not block any ventilation openings. To ensure reliable operation of the projector and to protect from overheating, it is recommended to install the projector in a location that does not block ventilation. As an example, do not place the projector on a crowded coffee table, sofa, bed, etc. Do not put the projector in an enclosure such as a book case or a cabinet that restricts air flow.
13. Do not use the projector near water or moisture. To reduce the risk of fire and/or electric shock, do not expose the projector to rain or moisture.
14. Do not install near heat sources such as radiators, heaters, stoves or any other apparatus such as amplifiers that emits heat.
15. Clean only with dry cloth.
16. Only use attachments/accessories specified by the manufacturer.
17. Do not use the unit if it has been physically damaged or abused.
18. Physical damage/abuse would be (but not limited to):
 - Unit has been dropped.
 - Power supply cord or plug has been damaged.
 - Liquid has been spilled on to the projector.
 - Projector has been exposed to rain or moisture.
 - Something has fallen in the projector or something is loose inside.

19. Do not attempt to service the unit yourself. Opening or removing covers may expose you to dangerous voltages or other hazards. The unit should only be repaired by appropriate service personnel, please contact Dashbon Customer Service.
20. Do not look directly into projector beam.

FCC STATEMENT

1. This device complies with Part 15 of the FCC Rules. Operation is subject to the following two conditions:

- (1) This device may not cause harmful interference, and
- (2) This device must accept any interference received, including interference that may cause undesired operation.

2. Changes or modifications not expressly approved by the party responsible for compliance could void the user's authority to operate the equipment.

This equipment has been tested and found to comply with the limits for a Class B digital device, pursuant to part 15 of the FCC Rules. These limits are designed to provide reasonable protection against harmful interference in a residential installation. This equipment generates, uses and can radiate radio frequency energy and, if not installed and used in accordance with the instructions, may cause harmful interference to radio communications. However, there is no guarantee that interference will not occur in a particular installation. If this equipment does cause harmful interference to radio or television reception, which can be determined by turning the equipment off and on, the user is encouraged to try to correct the interference by one or more of the following measures:

- Reorient or relocate the receiving antenna.
- Increase the separation between the equipment and receiver.
- Connect the equipment into an outlet on a circuit different from that to which the receiver is connected.
- Consult the dealer or an experienced radio/ TV technician for help.

FCC Radiation Exposure Statement:

This equipment complies with FCC radiation exposure limits set forth for an uncontrolled environment. In order to avoid the possibility of exceeding the FCC radio frequency exposure limits, Human proximity to the antenna shall not be less than 20cm (8 inches) during normal operation.

IC WARNING STATEMENT

This device complies with Industry Canada License-exempt RSS standard(s).

Operation is subject to the following two conditions:

- (1) This device may not cause harmful interference, and
- (2) This device must accept any interference, including interference that may cause undesired operation of the device. Changes or modifications not expressly approved by the party responsible for compliance could void the user's authority to operate the equipment. The battery or batteries shall not be exposed to excessive heat such as sunshine, fire or the like.

Radio Frequency (RF) Exposure Information

The radiated output power of the Wireless Device is below the Industry Canada (IC)

radio frequency exposure limits. The Wireless Device should be used in such a manner such that the potential for human contact during normal operation is minimized. This device has also been evaluated and shown compliant with the IC RF Exposure limits under mobile exposure conditions. (Antennas are greater than 20cm from a person's body).

Avertissement d'Industrie Canada

Cet appareil est conforme à la norme d'Industrie Canada sur les appareils radio exempts de licence. Son utilisation est soumise aux deux conditions suivantes :

- (1) cet appareil ne doit pas causer d'interférence nuisible, et
- (2) cet appareil doit accepter toute autre interférence reçue, y compris les interférences pouvant entraîner un fonctionnement non désiré. Toute modification ou tout changement qui n'a pas été expressément approuvé par la partie responsable de la conformité pourrait annuler le droit de l'utilisateur de faire fonctionner cet équipement. La pile (ou les piles) ne doit jamais être exposée à une source de chaleur excessive telle que le soleil, le feu ou autre source de chaleur élevée.

Avertissement d'Industrie Canada

Cet appareil est conforme à la norme d'Industrie Canada sur les appareils radio exempts de licence.

Son utilisation est soumise aux deux conditions suivantes :

- (1) cet appareil ne doit pas causer d'interférence nuisible, et
- (2) cet appareil doit accepter toute autre interférence reçue, y compris les interférences pouvant entraîner un fonctionnement non désiré.

Informations sur l'exposition aux radiofréquences (RF)

La puissance RF rayonnée par le dispositif sans fil est sous les limites d'exposition aux radiofréquences établies par Industrie Canada (IC). Le dispositif sans fil doit être utilisé de façon à ce que la possibilité de contact humain soit minimisée pendant son utilisation normale.

Ce dispositif a également été évalué et déclaré conforme aux limites d'exposition RF IC en conditions d'exposition mobiles (antennes à plus de 20 cm du corps d'une personne).

NCC WARNING STATEMENT

Article 12

Without permission, any company, firm or user shall not alter the frequency, increase the power, or change the characteristics and functions of the original design of the certified lower power frequency electric machinery.

Article 14

The application of low power frequency electric machineries shall not affect the navigation safety nor interfere a legal communication, if an interference is found, the service will be suspended until improvement is made and the interference no longer exists.

Names and Contents of Toxic or Hazardous Substances or Elements						
Part Name	Toxic or Hazardous Substances and Elements					
	Lead (Pb)	Mercury (Hg)	Cadmium (Cd)	Hexavalent (CR(VI))	Polybrominated Biphenyl (PBB)	Polybrominated Diphenyl Ether (PBDE)
PCBs	X	0	0	0	0	0
Metal parts	X	0	0	0	0	0
Plastic parts	0	0	0	0	0	0
Speakers	X	0	0	0	0	0
Cables	X	0	0	0	0	0
O: Indicates that this toxic or hazardous substance contained in all of the homogeneous materials for this part is below the limit requirement in SJ/T 11363-2006.						
X: Indicates that this toxic or hazardous substance contained in at least one of the homogeneous materials used for this part is above the limit requirement in SJ/T 11363-2006.						