

**OPTICAL  
DL/UL  
WDM**

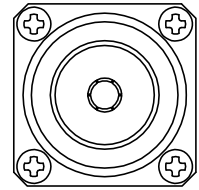

MADE IN ITALY



**RF PORT**

Model: **TRU8A19AWWV/AC-WS**

Frequency Range: **824 ÷ 894MHz  
1850 ÷ 1995MHz  
1710 ÷ 2155MHz**

Manufacturing Date: \_\_\_\_\_

Serial n° \_\_\_\_\_

When working on the equipment always make sure that the equipment is not connected to the main supply



**GROUND**

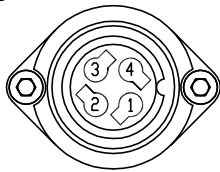
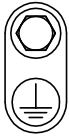

**AC MAINS (100-240V~; 50-60Hz; 12A)**

1 = Line (brown)      3 = Ground  
2 = Neutral (blue)    4 = Not conn.

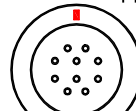

**FAN**

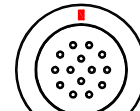

**ALARM**



**LED**

**TEKO TELECOM**  
**MODEL: TRU8A19AWWV/AC-WS**  
**FCC ID: XM2-VERYHIGHPOWER**

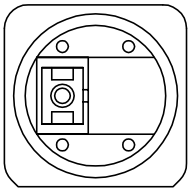
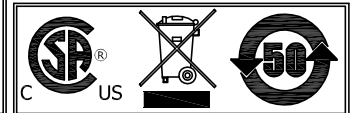

**OPTICAL  
DL/UL  
WDM**



MADE IN ITALY

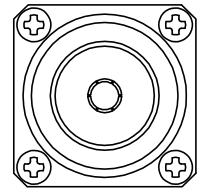

**RF PORT**

Model: **TRU8S19AWWV/AC-WS**

Frequency Range: **806 ÷ 869MHz  
1850 ÷ 1995MHz  
1710 ÷ 2155MHz**

Manufacturing Date: \_\_\_\_\_

Serial n° \_\_\_\_\_

When working on the equipment always make sure that the equipment is not connected to the main supply



**GROUND**

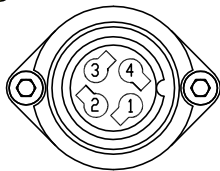
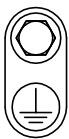

**AC MAINS (100-240V~; 50-60Hz; 12A)**

1 = Line (brown)      3 = Ground  
2 = Neutral (blue)    4 = Not conn.

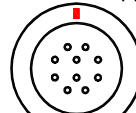

**FAN**

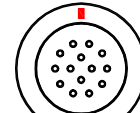

**ALARM**



**LED**

**TEKO TELECOM**  
**MODEL: TRU8S19AWWV/AC-WS**  
**FCC ID: XM2-VERYHIGHPOWER**

