

**PRODUCT LABELING**

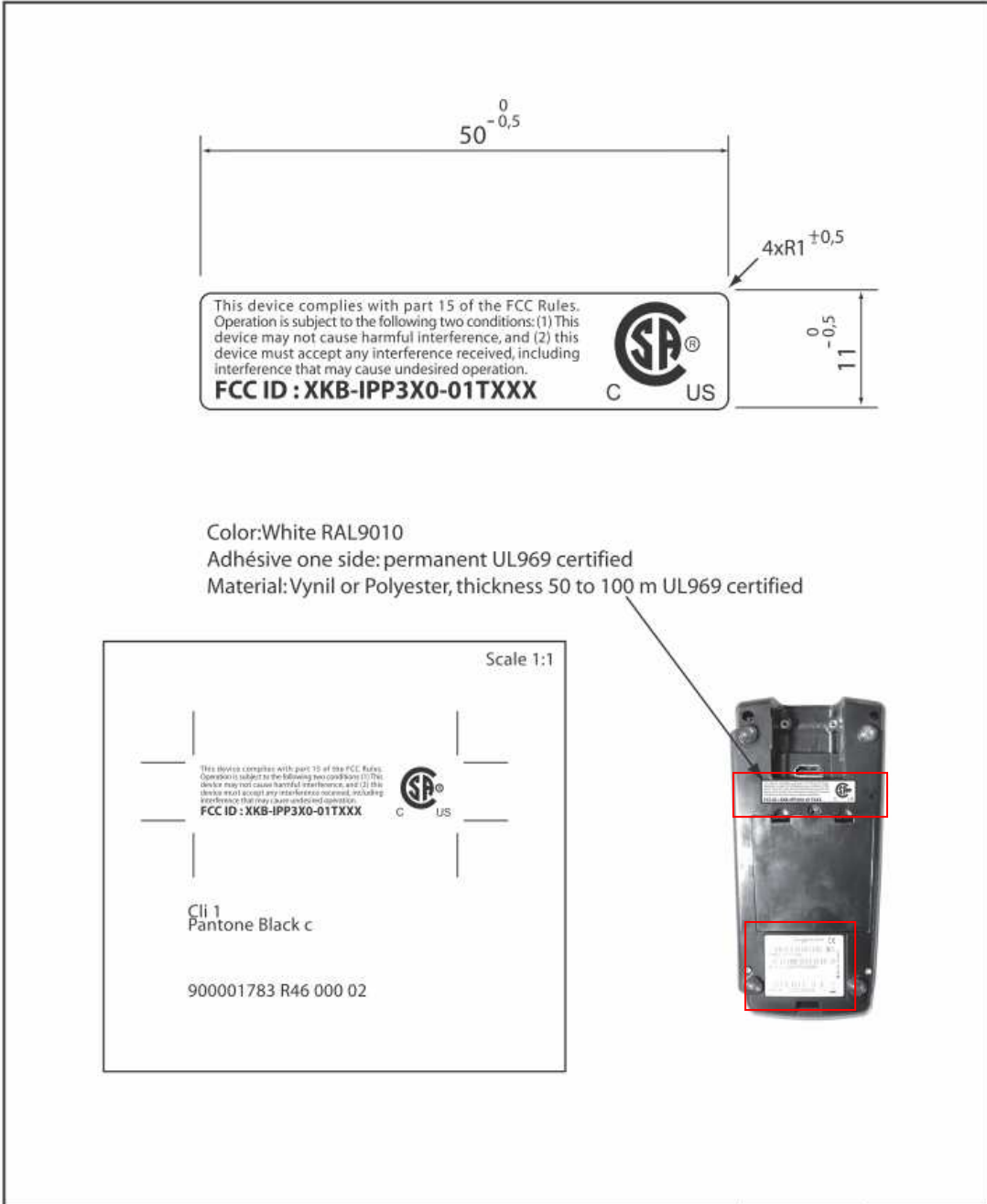

Adobe / ILLUSTRATOR						ECHELLE SCALE 2:1	
ETABLI DRAWN	NOM / NAME Olivier BLANC	DATE 16/06/2010	VERIFIE CHECKED	NOM / NAME S.BARNERON	DATE 16/06/2010		
LIBELLE DENOMINATION ETIQUETTE FCC CSAus IPP3xx(MAR) IPP3xx FCC STICKER MARKING (MAR)						FEUILLE / SHEET 1/1	
R.FAB / P.N. - 296108834 AB			FORMAT SIZE A4	900001782	R46	000	02
			F6151	NUMERO DU DOCUMENT DRAWING NUMBER		TYPE	PART VERS.

DOCUMENT . REPRODUCTION ET DIVULGATION INTERDITES ALL RIGHTS RESERVED REPRODUCTION AND DISCLOSURE PROHIBITED

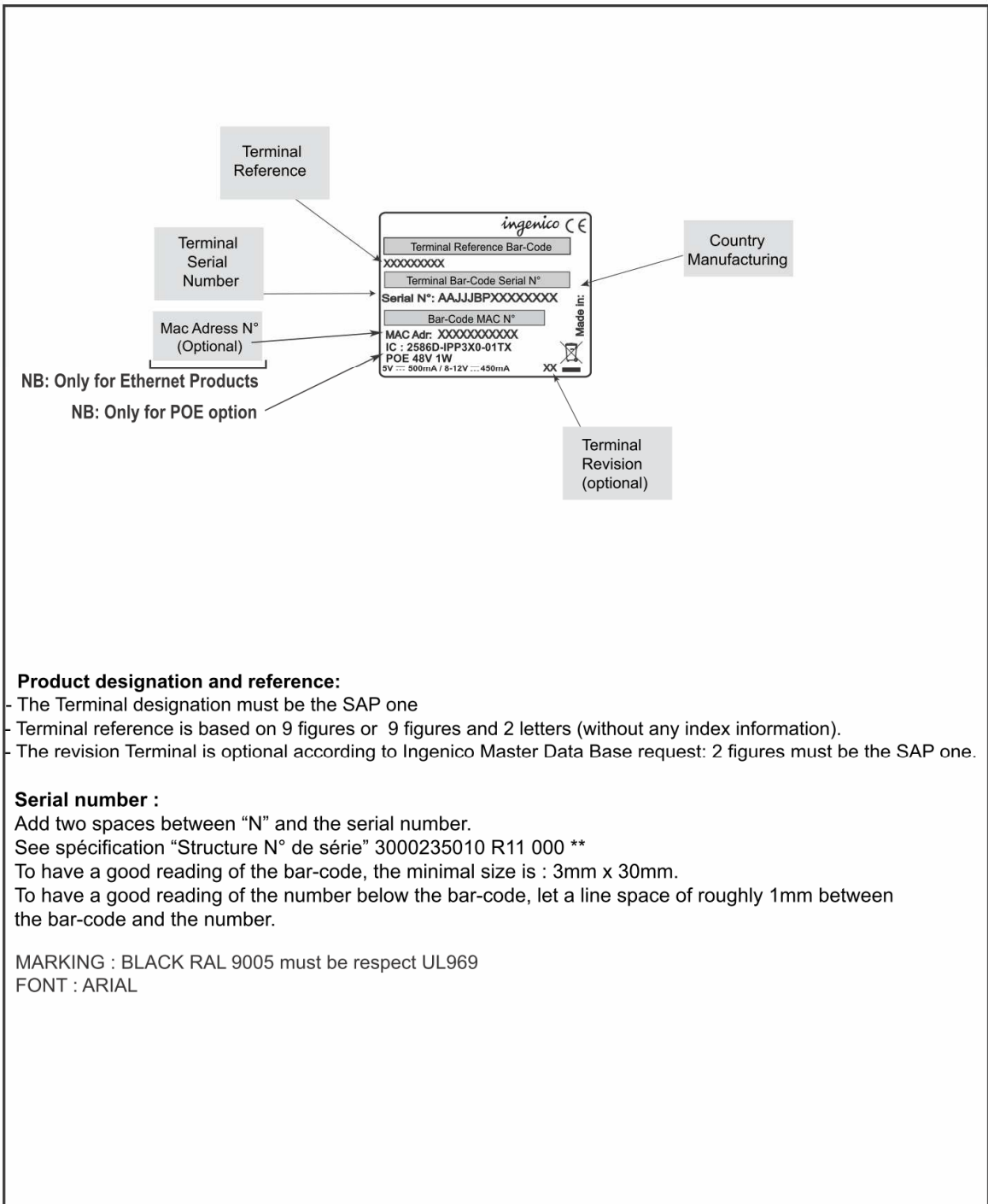

**Product designation and reference:**

- The Terminal designation must be the SAP one
- Terminal reference is based on 9 figures or 9 figures and 2 letters (without any index information).
- The revision Terminal is optional according to Ingenico Master Data Base request: 2 figures must be the SAP one.

**Serial number :**

Add two spaces between "N" and the serial number.  
 See spécification "Structure N° de série" 3000235010 R11 000 \*\*  
 To have a good reading of the bar-code, the minimal size is : 3mm x 30mm.  
 To have a good reading of the number below the bar-code, let a line space of roughly 1mm between the bar-code and the number.

MARKING : BLACK RAL 9005 must be respect UL969  
 FONT : ARIAL

Adobe / ILLUSTRATOR							ECHELLE SCALE		
ETABLI DRAWN	NOM / NAME Bernard MAURICE	DATE 09/06/2010	VERIFIE CHECKED	NOM / NAME Sylvain DE SA COSTA	DATE 09/06/2010				
LIBELLE DENOMINATION ETIQUETTE TERMINAL IPP3XX Terminal Label IPP3XX									
R.FAB / P.N. 296101856AC					FORMAT SIZE A4	900000573	R40	000	05
					NUMERO DU DOCUMENT DRAWING NUMBER		TYPE	PART	VERS.