

QUICK START GUIDE GUIDE DE DÉMARRAGE RAPIDE



IMPORTANT READ BEFORE USING À LIRE AVANT UTILISATION

Any questions? Des questions?
turtlebeach.com/support
Model: Stealth™ 700 Gen 2 for PlayStation®

IMPORTANT PLEASE MAKE SURE YOUR HEADSET IS UPDATED WITH THE LATEST FIRMWARE.

IMPORTANT VEUILLEZ VOUS ASSURER QUE VOTRE CASQUE DISPOSE DE LA DERNIÈRE VERSION DU MICROLOGICIEL.

Connect to the **Turtle Beach Audio Hub for Windows or Mac®** to update firmware. Customize your settings with the **Turtle Beach Audio Hub** mobile app for **Android** and **iOS**.

Connectez-vous au **Turtle Beach Audio Hub** pour **Windows** ou **Mac®** afin de mettre à jour le micrologiciel. Personnalisez vos options avec l'application mobile **Turtle Beach Audio Hub** pour **Android** et **iOS**.

turtlebeach.com/audiohub



MAPPABLE BUTTONS BOITONS ASSIGNABLES

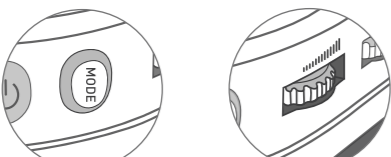

The **MODE Button** and **Mappable Wheel** can be assigned to a new function based on your gaming style. To change the button's assignment, follow these steps:

The **MODE Button** and **Mappable Wheel** can be assigned to a new function based on your gaming style. To change the button's assignment, follow these steps:



Scan this QR code for more information on how to customize your mappable buttons.

Scannez ce code QR pour en savoir plus sur la façon de personnaliser les boutons pour votre appareil.

- Download the Turtle Beach Audio Hub mobile app on your iOS or Android device.
Téléchargez l'application mobile Turtle Beach Audio Hub sur votre appareil iOS ou Android.
- Enable Bluetooth® on your selected device, and pair with your headset to access the app.
Activez le Bluetooth® sur l'appareil sélectionné et associez-le à votre casque pour accéder à l'application.
- Swipe to the second settings screen to assign new functions.
Faites glisser jusqu'à deuxième écran des options pour assigner de nouvelles fonctions.
- Once selected, your headset will save this configuration.
Une fois la configuration sélectionnée, votre casque la sauvegardera.

SETUP FOR PLAYSTATION® CONFIGURATION POUR PLAYSTATION®

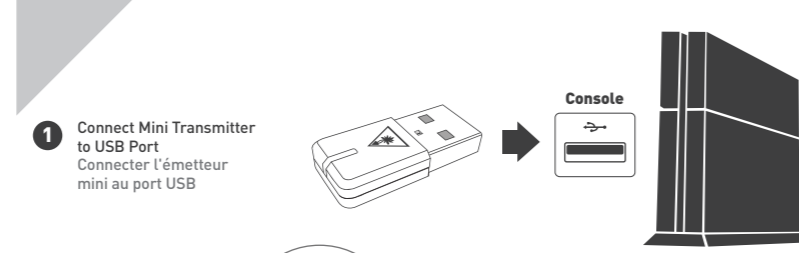

- Connect Mini Transmitter to USB Port
Connecter l'émetteur mini au port USB
- Power on Headset
Allumer le casque
- Go to Settings > Devices > Audio Devices
Aller à Paramètres > Périphériques > Périphériques Audio

- Select Stealth™ 700 Gen 2
Sélectionner Stealth™ 700 Gen 2
- Select Input & Output Device
Sélectionner l'entrée et le périphérique de sortie
- Select Volume Control (Headphones) Level to maximum
Sélectionner le niveau de volume (casque) au maximum
- Select Adjust Microphone Level and follow the on-screen instructions to calibrate your microphone
Sélectionner Régler le niveau de microphone et suivez les instructions à l'écran pour calibrer votre microphone

CONTENTS CONTENU DE LA BOÎTE

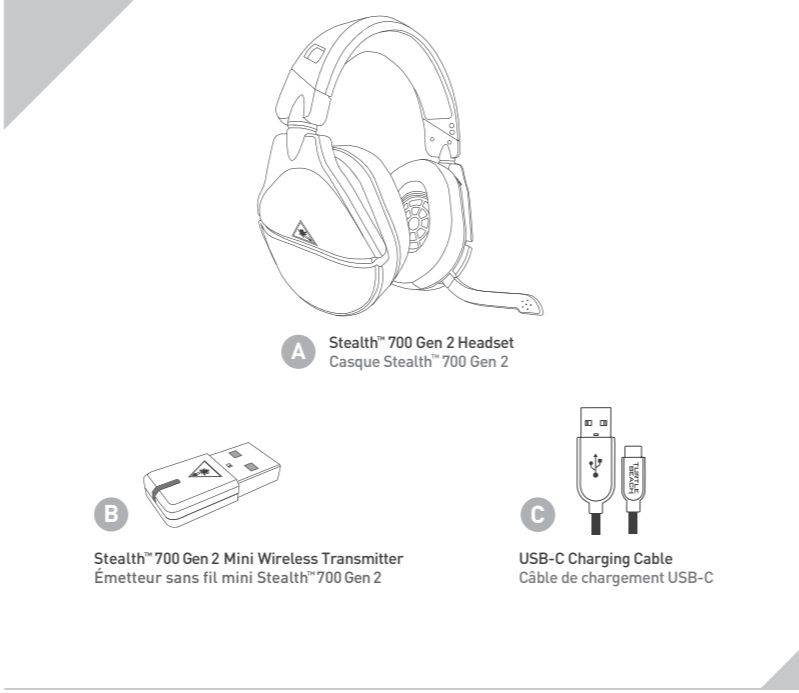

- Stealth™ 700 Gen 2 Headset
Casque Stealth™ 700 Gen 2
- Stealth™ 700 Gen 2 Mini Wireless Transmitter
Émetteur sans fil mini Stealth™ 700 Gen 2
- USB-C Charging Cable
Câble de chargement USB-C

- Go to Settings > Devices > Audio Devices
Aller à Paramètres > Périphériques > Périphériques Audio
- Select Stealth™ 700 Gen 2
Sélectionner Stealth™ 700 Gen 2
- Select Input & Output Device
Sélectionner l'entrée et le périphérique de sortie
- Select Volume Control (Headphones) Level to maximum
Sélectionner le niveau de volume (casque) au maximum
- Select Adjust Microphone Level and follow the on-screen instructions to calibrate your microphone
Sélectionner Régler le niveau de microphone et suivez les instructions à l'écran pour calibrer votre microphone

- Go to Settings > Devices > Audio Devices
Aller à Paramètres > Périphériques > Périphériques Audio
- Select Stealth™ 700 Gen 2
Sélectionner Stealth™ 700 Gen 2
- Select Input & Output Device
Sélectionner l'entrée et le périphérique de sortie
- Select Volume Control (Headphones) Level to maximum
Sélectionner le niveau de volume (casque) au maximum
- Select Adjust Microphone Level and follow the on-screen instructions to calibrate your microphone
Sélectionner Régler le niveau de microphone et suivez les instructions à l'écran pour calibrer votre microphone

- Go to Settings > Devices > Audio Devices
Aller à Paramètres > Périphériques > Périphériques Audio
- Select Stealth™ 700 Gen 2
Sélectionner Stealth™ 700 Gen 2
- Select Input & Output Device
Sélectionner l'entrée et le périphérique de sortie
- Select Volume Control (Headphones) Level to maximum
Sélectionner le niveau de volume (casque) au maximum
- Select Adjust Microphone Level and follow the on-screen instructions to calibrate your microphone
Sélectionner Régler le niveau de microphone et suivez les instructions à l'écran pour calibrer votre microphone

HEADSET CONTROLS COMMANDES SUR CASQUE

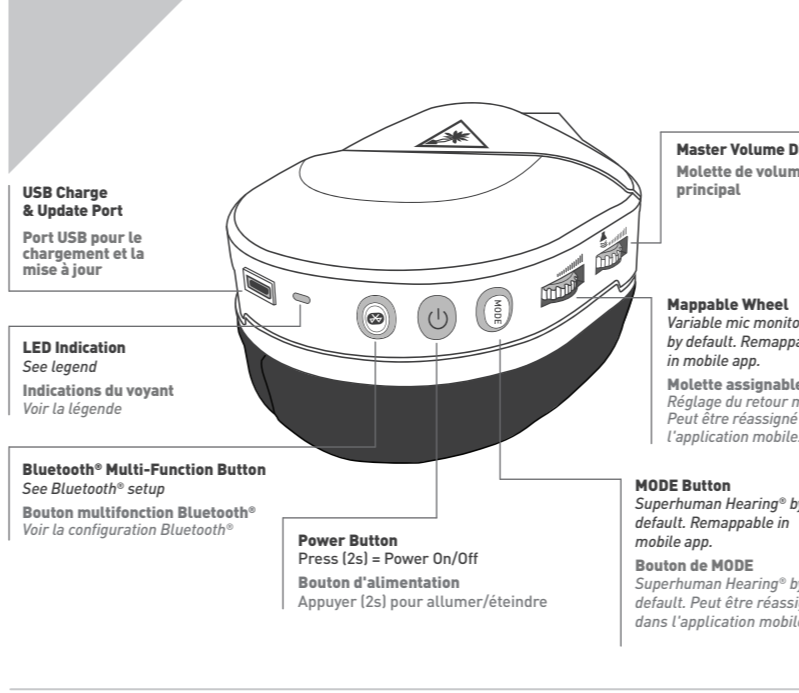

- Go to Settings > Devices > Audio Devices
Aller à Paramètres > Périphériques > Périphériques Audio
- Select Stealth™ 700 Gen 2
Sélectionner Stealth™ 700 Gen 2
- Select Input & Output Device
Sélectionner l'entrée et le périphérique de sortie
- Select Volume Control (Headphones) Level to maximum
Sélectionner le niveau de volume (casque) au maximum
- Select Adjust Microphone Level and follow the on-screen instructions to calibrate your microphone
Sélectionner Régler le niveau de microphone et suivez les instructions à l'écran pour calibrer votre microphone

- Go to Settings > Devices > Audio Devices
Aller à Paramètres > Périphériques > Périphériques Audio
- Select Stealth™ 700 Gen 2
Sélectionner Stealth™ 700 Gen 2
- Select Input & Output Device
Sélectionner l'entrée et le périphérique de sortie
- Select Volume Control (Headphones) Level to maximum
Sélectionner le niveau de volume (casque) au maximum
- Select Adjust Microphone Level and follow the on-screen instructions to calibrate your microphone
Sélectionner Régler le niveau de microphone et suivez les instructions à l'écran pour calibrer votre microphone

- Go to Settings > Devices > Audio Devices
Aller à Paramètres > Périphériques > Périphériques Audio
- Select Stealth™ 700 Gen 2
Sélectionner Stealth™ 700 Gen 2
- Select Input & Output Device
Sélectionner l'entrée et le périphérique de sortie
- Select Volume Control (Headphones) Level to maximum
Sélectionner le niveau de volume (casque) au maximum
- Select Adjust Microphone Level and follow the on-screen instructions to calibrate your microphone
Sélectionner Régler le niveau de microphone et suivez les instructions à l'écran pour calibrer votre microphone

- Go to Settings > Devices > Audio Devices
Aller à Paramètres > Périphériques > Périphériques Audio
- Select Stealth™ 700 Gen 2
Sélectionner Stealth™ 700 Gen 2
- Select Input & Output Device
Sélectionner l'entrée et le périphérique de sortie
- Select Volume Control (Headphones) Level to maximum
Sélectionner le niveau de volume (casque) au maximum
- Select Adjust Microphone Level and follow the on-screen instructions to calibrate your microphone
Sélectionner Régler le niveau de microphone et suivez les instructions à l'écran pour calibrer votre microphone

SUPERHUMAN HEARING®

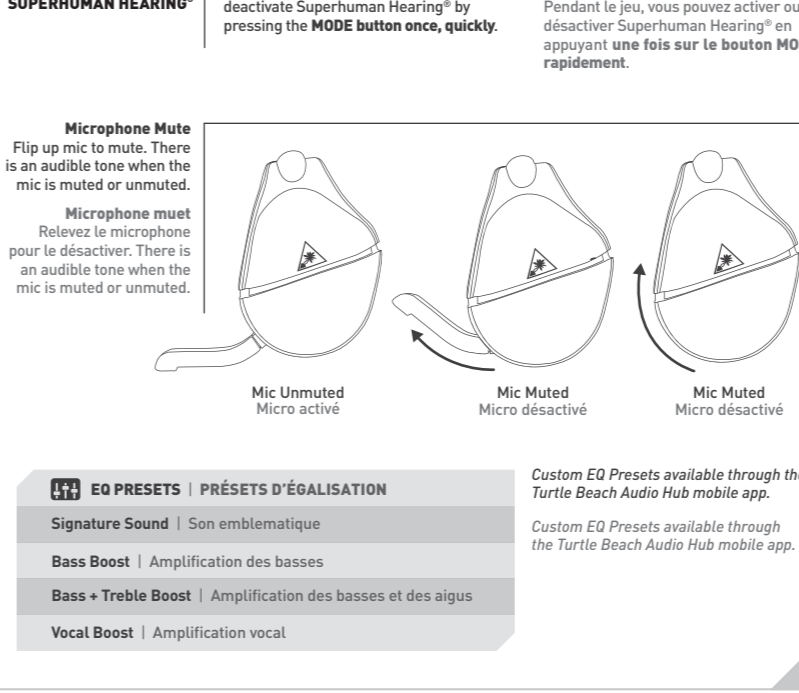

- Go to Settings > Devices > Audio Devices
Aller à Paramètres > Périphériques > Périphériques Audio
- Select Stealth™ 700 Gen 2
Sélectionner Stealth™ 700 Gen 2
- Select Input & Output Device
Sélectionner l'entrée et le périphérique de sortie
- Select Volume Control (Headphones) Level to maximum
Sélectionner le niveau de volume (casque) au maximum
- Select Adjust Microphone Level and follow the on-screen instructions to calibrate your microphone
Sélectionner Régler le niveau de microphone et suivez les instructions à l'écran pour calibrer votre microphone

- Go to Settings > Devices > Audio Devices
Aller à Paramètres > Périphériques > Périphériques Audio
- Select Stealth™ 700 Gen 2
Sélectionner Stealth™ 700 Gen 2
- Select Input & Output Device
Sélectionner l'entrée et le périphérique de sortie
- Select Volume Control (Headphones) Level to maximum
Sélectionner le niveau de volume (casque) au maximum
- Select Adjust Microphone Level and follow the on-screen instructions to calibrate your microphone
Sélectionner Régler le niveau de microphone et suivez les instructions à l'écran pour calibrer votre microphone

- Go to Settings > Devices > Audio Devices
Aller à Paramètres > Périphériques > Périphériques Audio
- Select Stealth™ 700 Gen 2
Sélectionner Stealth™ 700 Gen 2
- Select Input & Output Device
Sélectionner l'entrée et le périphérique de sortie
- Select Volume Control (Headphones) Level to maximum
Sélectionner le niveau de volume (casque) au maximum
- Select Adjust Microphone Level and follow the on-screen instructions to calibrate your microphone
Sélectionner Régler le niveau de microphone et suivez les instructions à l'écran pour calibrer votre microphone

- Go to Settings > Devices > Audio Devices
Aller à Paramètres > Périphériques > Périphériques Audio
- Select Stealth™ 700 Gen 2
Sélectionner Stealth™ 700 Gen 2
- Select Input & Output Device
Sélectionner l'entrée et le périphérique de sortie
- Select Volume Control (Headphones) Level to maximum
Sélectionner le niveau de volume (casque) au maximum
- Select Adjust Microphone Level and follow the on-screen instructions to calibrate your microphone
Sélectionner Régler le niveau de microphone et suivez les instructions à l'écran pour calibrer votre microphone

PAIRING DÉMARRAGE



BLUETOOTH® SETUP | CONFIGURATION BLUETOOTH®

- Hold down Bluetooth® Button until "Bluetooth® Pairing" prompt plays
Tenir enfoncé le bouton Bluetooth® jusqu'à ce que l'invite de jumelage Bluetooth® soit affichée
- Connect to your headphones in your phone or tablet Bluetooth® Settings
Se connecter à votre casque dans les paramètres Bluetooth® de votre téléphone ou de votre tablette
- Select Stealth™ 700 Gen 2
Sélectionner Stealth™ 700 Gen 2
- Select Input & Output Device
Sélectionner l'entrée et le périphérique de sortie
- Select Volume Control (Headphones) Level to maximum
Sélectionner le niveau de volume (casque) au maximum
- Select Adjust Microphone Level and follow the on-screen instructions to calibrate your microphone
Sélectionner Régler le niveau de microphone et suivez les instructions à l'écran pour calibrer votre microphone

FUNCTION FONCTIONS

FUNCTION FONCTIONS	ACTION ACTION
Play/Pause Lancer/Pause	Press Once Appuyer une fois
Skip Forward Passer	Press Twice Quickly Appuyer deux fois rapidement
Fast Forward Accélérer	Press Twice Quickly and Hold Appuyer deux fois rapidement et maintenir
Skip Back Retour en arrière	Press Three Times Quickly Appuyer trois fois rapidement
Rewind Rembobiner	Press Three Times Quickly and Hold Appuyer trois fois rapidement et maintenir
Answer Call Répondre à un appel	Press Once Appuyer une fois
End Call Mettre fin à un appel	Press Once Appuyer une fois
Reject Incoming Call Rejeter un appel	Press and Hold Appuyer et maintenir
Activate Voice Recognition (if available) Activer la reconnaissance vocale (si disponible)	Press and Hold Appuyer et maintenir

LED BEHAVIORS ÉTATS DES VOYANTS

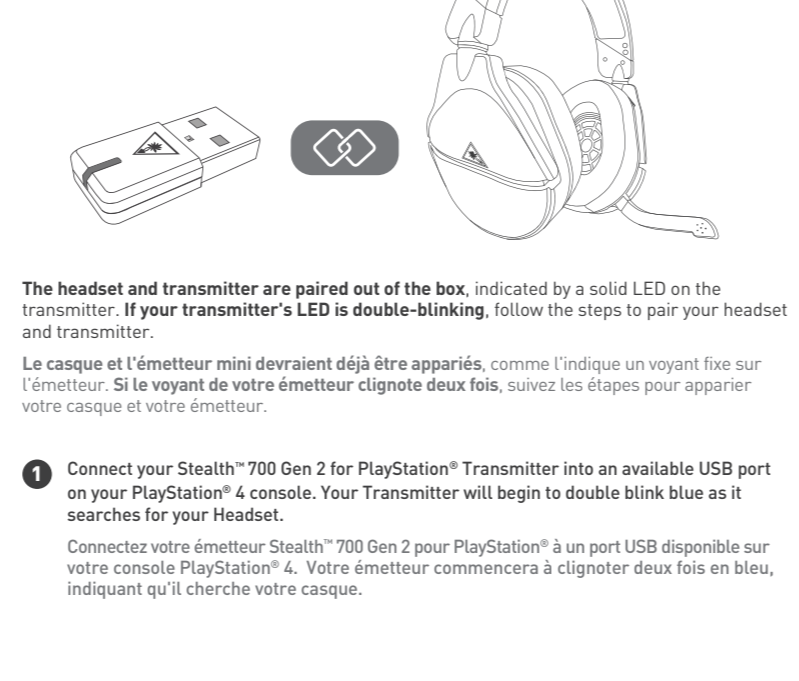

LED BEHAVIORS ÉTATS DES VOYANTS

TRANSMITTER LED VOYANT DE L'ÉMETTEUR	MEANING SIGNIFICATION
Solid Blue Bleu et Fixe	Headset and Mini Transmitter Paired Casque et Émetteur Mini Appariés
Double-Blink Blue Clignote Deux Fois en Bleu	Not Paired Non Apparié
Breathing Red Clignote en Rouge	Microphone Mute Microphone muet

Regulatory Compliance Statements for Stealth™ 700P Gen 2 RX & TX

Local Restrictions on Radio Usage
Caution: Due to the fact that the frequencies used by wireless devices may not yet be harmonized in all countries, these radio products are designed for use only in specific countries, and are not allowed to be operated in countries other than those of designation set out in a number of these products, you are responsible for ensuring that the products are used only in the countries for which they were intended and for verifying that they are configured with the correct selection of frequency and channel for the country of use. Any deviation from this permissible power and frequency settings for the country of use is an infringement of national law and may be punishable by law.

To determine whether you are allowed to use your wireless network device in a specific country, please check to see the radio type number that is printed on the identification label of your device is listed in the Regulatory Database document at the following URL: <http://www.turtlebeach.com/homologation> or contact Turtle Beach directly.

Federal Communications Commission (FCC) Compliance Notices
This section includes the following FCC statements for the Stealth™ 700P Gen 2 RX & TX.
• Class B Interference Statement
• RF Radiation Exposure & Hazard Warning

Class B Interference Statement
This equipment has been tested and found to comply with the limits for a Class B digital device, pursuant to Part 15 of the FCC Rules. The limits are designed to provide reasonable protection against harmful interference in a residential installation. This equipment generates, uses, and can radiate radio frequency energy and, if not installed and used in accordance with the instructions, may cause harmful interference to radio communications. However, there is no guarantee that interference will not occur in a particular installation. If this equipment does cause harmful interference to radio or television reception, which can be determined by turning the equipment off and on, the user is encouraged to try to correct the interference by one or more of the following measures:
• Reorient or relocate the receiving antenna.
• Increase the separation between the equipment and receiver.
• Connect the equipment into an outlet on a circuit different from that to which the receiver is connected.
• Consult the dealer or a qualified radio/TV technician for help.

FCC Caution
This device complies with Part 15 of the FCC Rules. Operation is subject to the following two conditions: (1) This device may not cause harmful interference, and (2) this device must accept any interference received, including interference that may cause undesired operation.

RF Radiation Exposure & Hazard Statements
This equipment complies with FCC RF exposure requirements. This device must be installed in a location such that the antenna of the device will be greater than 2 cm (8 in.) from all persons. Using higher gain antennas and types of antennas not covered under the FCC certification of this product is not allowed. Installers on the radio end and users of the product must adhere to the installation instructions provided in this manual. This transmitter must not be co-located or operated in conjunction with any other antenna or transmitter.

Non-Modification Statement
Use of the supplied external antenna. Unauthorized antennas, modifications, or attachments could damage the Stealth™ 700P Gen 2 RX & TX Module and voids FCC regulations. Any changes or modifications not approved by the party responsible for FCC compliance could void the user's authority to operate this equipment. Please contact Turtle Beach for a list of approved 2.4 GHz antennas.

This product is compliant with the Consumer Product Safety Improvement Act of 2008, Public Law 110-314 (CPSIA).

Canadian ICES Statements (IC)

ICES 0032, 2015, CSPP 32-2015
EN 301 210-1/2 and EN 301 210-2/3
This device complies with ICES-003 and RSS-247 of Industry Canada. Operation is subject to the following two conditions:
1. The device may not cause interference, and
2. The device must accept any interference, including interference that may cause undesired operations of the device.
Co-existence with cordless and mobile phones (DECT and GSM/CDMA)
See the instructions on the back of the device for more information.
1. Co-existence with cordless and mobile phones (DECT and GSM/CDMA)
2. Co-existence with cordless and mobile phones (DECT and GSM/CDMA)
3. Co-existence with cordless and mobile phones (DECT and GSM/CDMA)
4. Co-existence with cordless and mobile phones (DECT and GSM/CDMA)
5. Co-existence with cordless and mobile phones (DECT and GSM/CDMA)
6. Co-existence with cordless and mobile phones (DECT and GSM/CDMA)
7. Co-existence with cordless and mobile phones (DECT and GSM/CDMA)
8. Co-existence with cordless and mobile phones (DECT and GSM/CDMA)
9. Co-existence with cordless and mobile phones (DECT and GSM/CDMA)
10. Co-existence with cordless and mobile phones (DECT and GSM/CDMA)
11. Co-existence with cordless and mobile phones (DECT and GSM/CDMA)
12. Co-existence with cordless and mobile phones (DECT and GSM/CDMA)
13. Co-existence with cordless and mobile phones (DECT and GSM/CDMA)
14. Co-existence with cordless and mobile phones (DECT and GSM/CDMA)
15. Co-existence with cordless and mobile phones (DECT and GSM/CDMA)
16. Co-existence with cordless and mobile phones (DECT and GSM/CDMA)
17. Co-existence with cordless and mobile phones (DECT and GSM/CDMA)
18. Co-existence with cordless and mobile phones (DECT and GSM/CDMA)
19. Co-existence with cordless and mobile phones (DECT and GSM/CDMA)
20. Co-existence with cordless and mobile phones (DECT and GSM/CDMA)
21. Co-existence with cordless and mobile phones (DECT and GSM/CDMA)
22. Co-existence with cordless and mobile phones (DECT and GSM/CDMA)
23. Co-existence with cordless and mobile phones (DECT and GSM/CDMA)
24. Co-existence with cordless and mobile phones (DECT and GSM/CDMA)
25. Co-existence with cordless and mobile phones (DECT and GSM/CDMA)
26. Co-existence with cordless and mobile phones (DECT and GSM/CDMA)
27. Co-existence with cordless and mobile phones (DECT and GSM/CDMA)
28. Co-existence with cordless and mobile phones (DECT and GSM/CDMA)
29. Co-existence with cordless and mobile phones (DECT and GSM/CDMA)
30. Co-existence with cordless and mobile phones (DECT and GSM/CDMA)
31. Co-existence with cordless and mobile phones (DECT and GSM/CDMA)
32. Co-existence with cordless and mobile phones (DECT and GSM/CDMA)
33. Co-existence with cordless and mobile phones (DECT and GSM/CDMA)
34. Co-existence with cordless and mobile phones (DECT and GSM/CDMA)
35. Co-existence with cordless and mobile phones (DECT and GSM/CDMA)
36. Co-existence with cordless and mobile phones (DECT and GSM/CDMA)
37. Co-existence with cordless and mobile phones (DECT and GSM/CDMA)
38. Co-existence with cordless and mobile phones (DECT and GSM/CDMA)
39. Co-existence with cordless and mobile phones (DECT and GSM/CDMA)
40. Co-existence with cordless and mobile phones (DECT and GSM/CDMA)
41. Co-existence with cordless and mobile phones (DECT and GSM/CDMA)
42. Co-existence with cordless and mobile phones (DECT and GSM/CDMA)
43. Co-existence with cordless and mobile phones (DECT and GSM/CDMA)
44. Co-existence with cordless and mobile phones (DECT and GSM/CDMA)
45. Co-existence with cordless and mobile phones (DECT and GSM/CDMA)
46. Co-existence with cordless and mobile phones (DECT and GSM/CDMA)
47. Co-existence with cordless and mobile phones (DECT and GSM/CDMA)
48. Co-existence with cordless and mobile phones (DECT and GSM/CDMA)
49. Co-existence with cordless and mobile phones (DECT and GSM/CDMA)
50. Co-existence with cordless and mobile phones (DECT and GSM/CDMA)
51. Co-existence with cordless and mobile phones (DECT and GSM/CDMA)
52. Co-existence with cordless and mobile phones (DECT and GSM/CDMA)
53. Co-existence with cordless and mobile phones (DECT and GSM/CDMA)
54. Co-existence with cordless and mobile phones (DECT and GSM/CDMA)
55. Co-existence with cordless and mobile phones (DECT and GSM/CDMA)
56. Co-existence with cordless and mobile phones (DECT and GSM/CDMA)
57. Co-existence with cordless and mobile phones (DECT and GSM/CDMA)
58. Co-existence with cordless and mobile phones (DECT and GSM/CDMA)
59. Co-existence with cordless and mobile phones (DECT and GSM/CDMA)
60. Co-existence with cordless and mobile phones (DECT and GSM/CDMA)
61. Co-existence with cordless and mobile phones (DECT and GSM/CDMA)
62. Co-existence with cordless and mobile phones (DECT and GSM/CDMA)
63. Co-existence with cordless and mobile phones (DECT and GSM/CDMA)
64. Co-existence with cordless and mobile phones (DECT and GSM/CDMA)
65. Co-existence with cordless and mobile phones (DECT and GSM/CDMA)
66. Co-existence with cordless and mobile phones (DECT and GSM/CDMA)
67. Co-existence with cordless and mobile phones (DECT and GSM/CDMA)
68. Co-existence with cordless and mobile phones (DECT and GSM/CDMA)
69. Co-existence with cordless and mobile phones (DECT and GSM/CDMA)
70. Co-existence with cordless and mobile phones (DECT and GSM/CDMA)
71. Co-existence with cordless and mobile phones (DECT and GSM/CDMA)
72. Co-existence with cordless and mobile phones (DECT and GSM/CDMA)
73. Co-existence with cordless and mobile phones (DECT and GSM/CDMA)
74. Co-existence with cordless and mobile phones (DECT and GSM/CDMA)
75. Co-existence with cordless and mobile phones (DECT and GSM/CDMA)
76. Co-existence with cordless and mobile phones (DECT and GSM/CDMA)
77. Co-existence with cordless and mobile phones (DECT and GSM/CDMA)
78. Co-existence with cordless and mobile phones (DECT and GSM/CDMA)
79. Co-existence with cordless and mobile phones (DECT and GSM/CDMA)
80. Co-existence with cordless and mobile phones (DECT and GSM/CDMA)
81. Co-existence with cordless and mobile phones (DECT and GSM/CDMA)
82. Co-existence with cordless and mobile phones (DECT and GSM/CDMA)
83. Co-existence with cordless and mobile phones (DECT and GSM/CDMA)
84. Co-existence with cordless and mobile phones (DECT and GSM/CDMA)
85. Co-existence with cordless and mobile phones (DECT and GSM/CDMA)
86. Co-existence with cordless and mobile phones (DECT and GSM/CDMA)
87. Co-existence with cordless and mobile phones (DECT and GSM/CDMA)
88. Co-existence with cordless and mobile phones (DECT and GSM/CDMA)
89. Co-existence with cordless and mobile phones (DECT and GSM/CDMA)
90. Co-existence with cordless and mobile phones (DECT and GSM/CDMA)
91. Co-existence with cordless and mobile phones (DECT and GSM/CDMA)
92. Co-existence with cordless and mobile phones (DECT and GSM/CDMA)
93. Co-existence with cordless and mobile phones (DECT and GSM/CDMA)
94. Co-existence with cordless and mobile phones (DECT and GSM/CDMA)
95. Co-existence with cordless and mobile phones (DECT and GSM/CDMA)
96. Co-existence with cordless and mobile phones (DECT and GSM/CDMA)
97. Co-existence with cordless and mobile phones (DECT and GSM/CDMA)
98. Co-existence with cordless and mobile phones (DECT and GSM/CDMA)
99. Co-existence with cordless and mobile phones (DECT and GSM/CDMA)
100. Co-existence with cordless and mobile phones (DECT and GSM/CDMA)

EMC

EN 55032:2015, CSPP 32:2015
EN 301 210-1/2 and EN 301 210-2/3
EN 10104-2:2009, EN 15004-2:2008 + A1:2008 + A2:2010, EN 110100-4:2010
The products are licensed, as required, for additional country specific standards for the International Marketplace. Additional issued licenses available upon request.
Radio EN 300 328 V2.1 (2011-07)
SAR: EN 62202:2008
Environment: EN 55032:2015, CSPP 32:2015, EN 301 210-1/2 and EN 301 210-2/3, EN 10104-2:2009, EN 15004-2:2008 + A1:2008 + A2:2010, EN 110100-4:2010
WARNING: This is a Class B product. In a domestic environment, this product may cause radio interference, in which case, the user is advised to take appropriate measures.
ACHTUNG: Dieses ist ein Gerät der Funkstrahlungskategorie B. In Wohnbereichen können bei Betrieb dieses Gerätes Störfunktionen eintreten und die Einhaltung der Grenzwerte für elektromagnetische Störungen verletzlichen sein.
ATTENTION: Cet est un produit de Classe B. Dans un environnement domestique, ce produit risque de créer des interférences radioélectriques. L'utilisateur est invité à prendre les mesures appropriées.
RF Radiation Exposure & Hazard Statement
To ensure compliance with FCC RF exposure requirements, this device must be installed in a location such that the antenna of the device will be greater than 2 cm (8 in.) from all persons. Using higher gain antennas and types of antennas not covered under the FCC certification of this product is not allowed. Installers of the radio end and users of the product must adhere to the installation instructions provided in this manual. This transmitter must not be co-located or operated in conjunction with any other antenna or transmitter.
Expuestos sus radiaciones y Notificación de peligro
Para asegurar la conformidad con los requisitos FCC de exposición RF, este dispositivo debe instalarse en un lugar tal que la antena de este dispositivo esté a una distancia de al menos 2 cm (8 pulgadas) de todas las personas. Utilización de antenas de ganancia más elevada o de tipos de antenas no cubiertas por la certificación FCC de este producto no son autorizadas. Los instaladores de radio y los usuarios del producto deben adherirse a las instrucciones de instalación proporcionadas en este manual. Este transmisor no debe colocarse o operarse en conjunción con cualquier otra antena o transmisor.
European Union and European Fair Trade Association Regulatory Compliance
This equipment meets the European Union and European Fair Trade Association Regulatory Compliance requirements. This equipment is designed to comply with the limits for a Class B digital device, pursuant to Part 15 of the FCC Rules. The limits are designed to provide reasonable protection against harmful interference in a residential installation. This equipment generates, uses, and can radiate radio frequency energy and, if not installed and used in accordance with the instructions, may cause harmful interference to radio communications. However, there is no guarantee that interference will not occur in a particular installation. If this equipment does cause harmful interference to radio or television reception, which can be determined by turning the equipment off and on, the user is encouraged to try to correct the interference by one or more of the following measures:
• Reorient or relocate the receiving antenna.
• Increase the separation between the equipment and receiver.
• Connect the equipment into an outlet on a circuit different from that to which the receiver is connected.
• Consult the dealer or a qualified radio/TV technician for help.
European Union and European Fair Trade Association Regulatory Compliance
This equipment meets the European Union and European Fair Trade Association Regulatory Compliance requirements. This equipment is designed to comply with the limits for a Class B digital device, pursuant to Part 15 of the FCC Rules. The limits are designed to provide reasonable protection against harmful interference in a residential installation. This equipment generates, uses, and can radiate radio frequency energy and, if not installed and used in accordance with the instructions, may cause harmful interference to radio communications. However, there is no guarantee that interference will not occur in a particular installation. If this equipment does cause harmful interference to radio or television reception, which can be determined by turning the equipment off and on, the user is encouraged to try to correct the interference by one or more of the following measures:
• Reorient or relocate the receiving antenna.
• Increase the separation between the equipment and receiver.
• Connect the equipment into an outlet on a circuit different from that to which the receiver is connected.
• Consult the dealer or a qualified radio/TV technician for help.
Declaration of Conformity
We hereby declare that the product is in conformity with the EMC Directive (2014/53/EU) of the European Union (2014/53/EU).
This equipment meets the following performance standards:
Safety:
EN 60950-1:2006 + A11:2009 + A1:2009 + A12:2011 + A2:2013 (IEC Mark Conform),
IEC 62368-1:2009 (IEC 61131-1:2009 + A1:2009 + A2:2013 (IEC Safety Certified)),
IEC 62368-2:2015 (IEC 61131-2:2015),
IEC 62368-3:2015 (IEC 61131-3:2015)
Additional licenses issued for specific countries available on request.

To access the rating label: Pour accéder à l'étiquette:

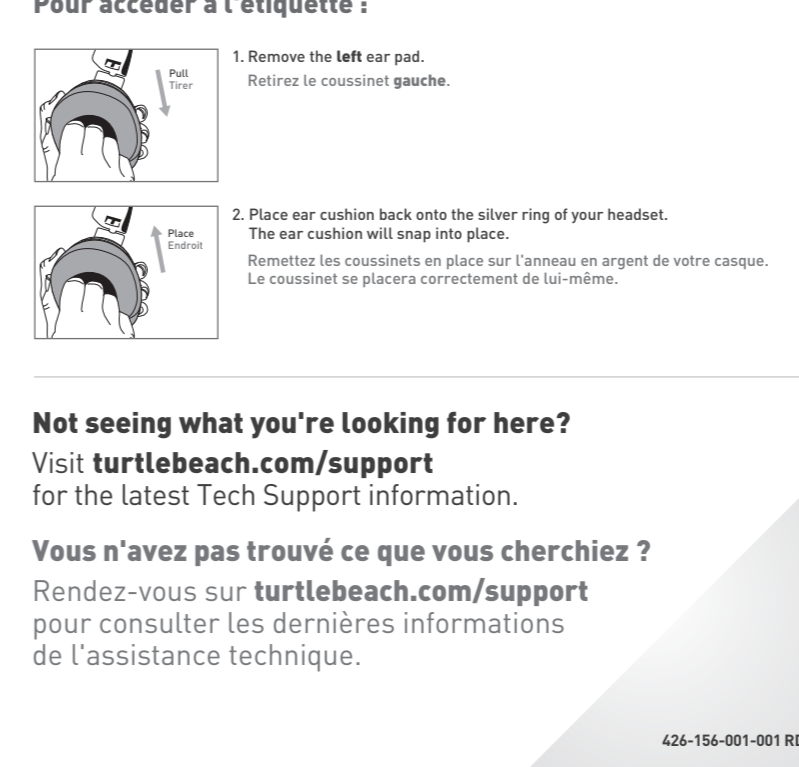

Not seeing what you're looking for here?
Visit turtlebeach.com/support for the latest Tech Support information.

Vous n'avez pas trouvé ce que vous cherchiez ?
Rendez-vous sur turtlebeach.com/support pour consulter les dernières informations de l'assistance technique.

PKG DESIGN DEPT

Designer: Taylor Swanson
Product: Stealth™ 700 Gen 2 - PS
Project: QSG
Date: JUN / 26 / 20
Arena #: 426-156-001-001 RC
Scale: 100%

COMMENTS

Please do not print this layer!!!
• 100% actual size
• Refer to video on how to fold

SPECIFICATIONS

Printing information
• BLK + WHT
• QSG Paper Weight (80g) Foldout
• Folding Line

CHANGES

Orig Arena #: 426-159-001-001
New Arena #: 426-156-001-001 R02
Date / Initiator: 05-06-20 / Taylor
1. Changes per ProofHQ comments
New Arena #: 426-156-001-001 RA
Date / Initiator: 05-15-20 / Taylor Swanson
1. Changes per PHQ comments—ready for PVT
Date / Initiator: 05-18-20 / Erin Steele
1. Edits per PHQ
Date / Initiator: 05-26-20 / Taylor Swanson
1. Translations placed
New Arena #: 426-156-001-001 RB
Date / Initiator: 06-24-20 / Erin Steele + Mickey Schoene
1. Access Rating Label instructions updated
2. Description added beside EQ Presets table
New Arena #: 426-156-001-001 RC
Date / Initiator: 06-24-20 / Mickey Schoene
1. TRANSMITTER LED BEHAVIORS CHART - Changed
"Battery Low" to "Microphone Mute" (held at press)
New Arena #: 426-156-001-001 RD
Date / Initiator: 08-31-20 / Erin Steele
1. Updates to copy