

# ANC-WT01 说明书（自动配对）

折后尺寸：60\*60mm（正反面印刷）

展开尺寸：360\*360（正反面印刷）

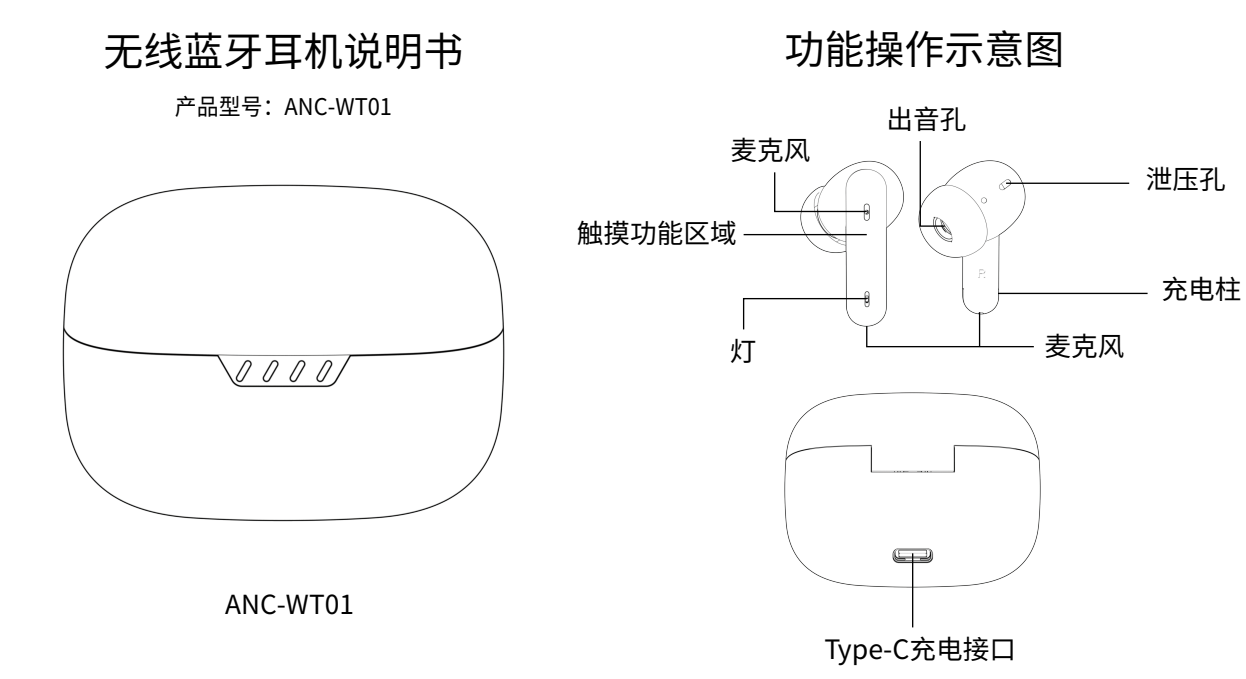

# ANC-WT01 Manual (Automatic Pairing)

Folded size: 60\*60mm (front and back printing)

Expanded size: 360\*360 (front and back printing)

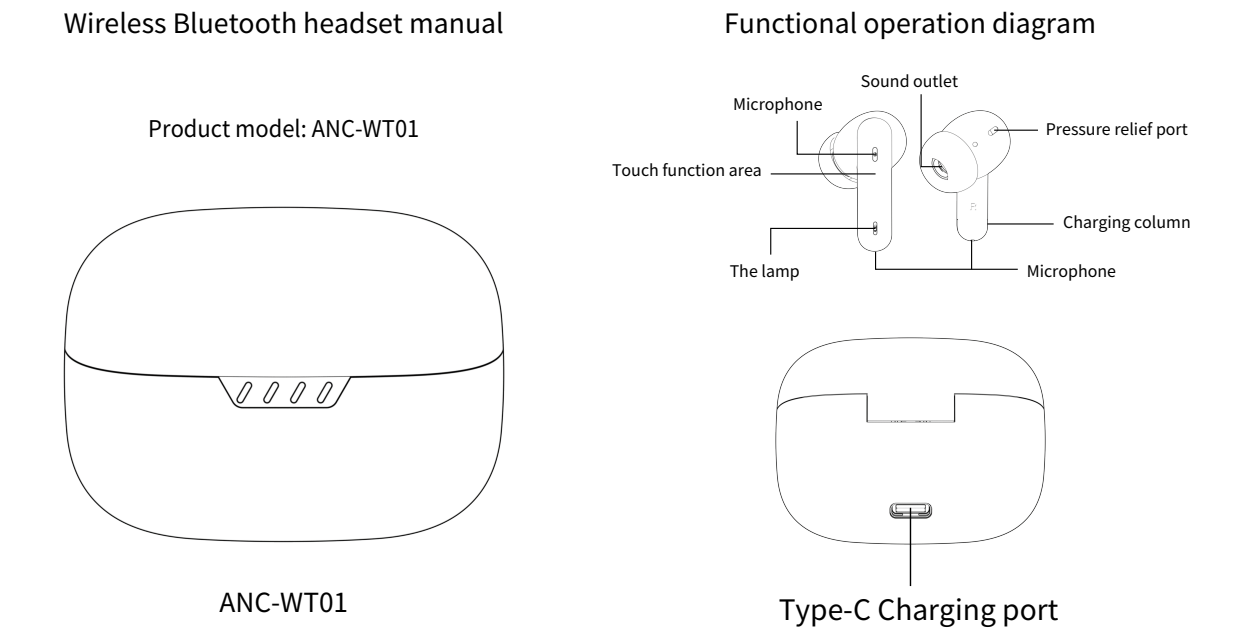

## 耳机功能操作说明

1. 开机:充电盒开盖2~3秒耳机自动开机左右配对
2. 关机： L/R 耳机放入充电盒，充电盒关盖，自动关机断连
3. 接听／挂断： L/R 来电单击功能键
4. 拒接来电 ： L/R 长按多功能键2S
5. 暂停／播放： L/R 单击功能键操作播放/暂停
6. 上一曲 ： L/双击功能键上一曲
7. 下一曲 ： R/双击功能键下一曲
8. 音量加 ： R 三击功能键音量加
9. 音量减 ： L 三击功能键音量减
10. 语音助手： L 四击进入语音助手
11. 游戏/音乐模式 ： R 四击功能键切换
12. 降噪模式 ： 开机： 长按3秒左/右耳机多功能键， 第一次是通透 循环  
开机： 长按3秒左/右耳机多功能键， 第二次是降噪 循环  
开机： 长按3秒左/右耳机多功能键， 第三次是关闭 循环
13. 连接手机： 蓝牙详情页搜索蓝牙名称连接 ANC-WT01
14. 断开连接： 耳机放入充电盒， 可自动断开连接
15. 显示电量： 耳机电量低于10%时提示（嘟嘟声）

## 耳机连接配对操作

耳机充电盒开盖自动开机，出现耳机红绿灯交替闪烁，开始进行设备搜索如下图所示

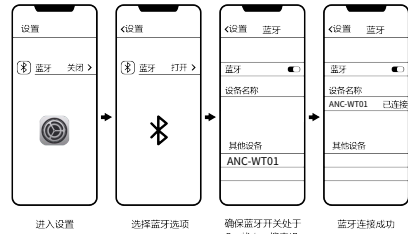

### 充电盒状态指示

1. 充电盒白灯快闪表示充电盒电量低，需要充电。
2. 给充电盒充电时白灯闪烁，每个灯代表25%电量，例：0~25% 电量第一个灯闪烁，25%以上第一个灯常亮，第二个灯闪烁。
3. 充电盒给耳机充电的时候，耳机亮红灯，充电盒白灯常亮。
4. 耳机低电的时候提示 (嘟嘟声) 表示低电提示。

## 产品参数

频响范围	20Hz-20KHz	
阻抗	32Ω±10%	
灵敏度	105±3db	
蓝牙接收距离	≥10米(标准环境下)	
蓝牙版本	BLUETOOTH V5.4	
支持协议	HSP/HFP/ADP/SBC/ ACC/ AVROP	
传输频率	2402MHz-2480MHz	
耳机充电时间	25分钟(耳机)， 约1.5小时(充电盒)	
播放时间	5小时(60%音量)	
通话时间	4小时(60%音量)	
续航时间	在蓝牙耳机与手机开启连接状态下通话时长:约3~4小时（双耳通话）;连接状态下通话时长:待机时间:约100小时。	
充电电压/电流	耳机额定输入:5V≐40mA×3	充电盒额定输入: 5V≐ 300mA
产品工作温度	-10-50℃	
产品存储温度	-20-65℃	

## 产品安全信息

在使用本产品前请阅读所有的指示和警告， 不规范使用将会给产品或人身安全带来损害。

1.产品内含电池， 请勿将本产品暴露在强日照或暖炉等过热环境中。请勿将本产品储存在高温， 强光及强磁场环境下。

2.产品不可放置在火源附近等恶劣环境中， 禁止敲击、 投掷、 践踏、 挤压或投入火中， 若出现鼓胀， 请勿使用。

3.产品使用环境温度:0~45℃。

4.请勿违反产品说明书不恰当使用， 造成产品损坏或危及人身财产安全， 后果自行承担。

5.非专业人员严禁分解本产品， 否则可能会导致起火， 甚至彻底损坏本产品。

6.请勿使用超出本产品输出电流负载(用电器)， 超出负载会自动停止工作。

7.请定期用干净的棉布对耳机充电触点进行清洁， 以避免因长期不清洁导致耳机出现无法充电或开机的情况。

8.请勿将本产品置于水中(或洗衣机中)， 若产品出现进水情况， 请等待其自然晾干后再使用

## Headset function operation instructions

1. Power on: Open the cover of the charging case for 2~3 seconds and the earphone will automatically power on and then pair
2. Power off: Put the L/R earphone into the charging box, close the cover of the charging box, and automatically shut down and disconnect
3. Answer/Hang up: L/R incoming call Click the function key
4. Reject incoming calls: L/R Long press the multi-function key for 2S
5. Pause/play: L/R Click the function key to play/pause
6. Previous: L/ Double-click the function key on the previous track
7. Next: R/ Double-click the function key to the next song
8. Volume plus: R three-click function key volume plus
9. Volume reduction: L three-stroke function key volume reduction
10. Voice assistant: L Four strokes to enter the voice assistant
11. Game/Music mode: R four click function key switch
12. Noise reduction mode: Power on: long press the left/right headset multi-function key for 3 seconds, the first time is transparent cycle  
Power on: Long press the left/right headset multi-function key for 3 seconds, the second time is the noise reduction cycle  
Power on: Long press the left/right headset multi-function key for 3 seconds, the third time is to close the loop
13. Connect mobile phone: Bluetooth details page search for Bluetooth name Connect ANC-WT01
14. Disconnect: The earphone can be automatically disconnected by placing it in the charging case
15. Display power: headset power less than 10% prompt (beep sound)

## Headset connection pairing operation

The earphone charging case opens and automatically turns on, the earphone traffic light flashes alternately, and the device search begins

As shown in the following figure

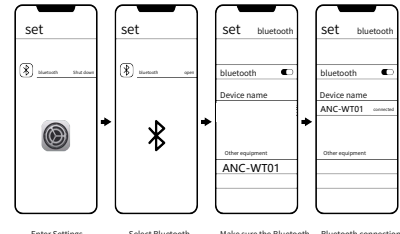

### Charging case status indicator

1. The white indicator of the charging box blinks at short intervals, indicating that the battery of the charging box is low and needs charging.

2. When charging the charging box, the white light blinks. Each light represents 25% of the power, for example, 0 ~ 25%

The first light blinks, the first light is steady on over 25%, and the second light blinks.

3. When the charging box is charging the earphone, the earphone is red and the white light of the charging box is steady on.

4. When the headset is in low battery state (beep), the headset is in low battery state.

## Product parameter

Frequency response range	20Hz-20KHz	
impedance	32Ω±10%	
sensitivity	105±3db	
Bluetooth receiving distance	≥10 m (standard environment)	
Bluetooth version	BLUETOOTH V5.4	
Support protocol	HSP/HFP/ADP/SBC/ ACC/ AVROP	
Transmission frequency	2402MHz-2480MHz	
Earphone charging time	25 minutes (headphones) about 1.5 hours (charging case)	
Play time	5 hours (60% volume)	
Talk time	4 hours (60% volume)	
Endurance time	Call duration when Bluetooth headset and mobile phone are connected; About 3~4 hours (binaural call); Call duration in connected state; Standby time: about 100 hours.	
Charging voltage /current	Headset rated input : 5V≐40mA x 3	Charging box rated input: 5V≐ 300mA
Product operating temperature	-10-50℃	
Product storage temperature	-20-65℃	

## Product safety information

Please read all instructions and warnings before using this product. Improper use will damage the product or personal safety.

1. The product contains batteries, do not expose the product to strong sunshine or overheating environment such as heaters. Do not store this product in high temperature, strong light and strong magnetic field environment.

2. Do not place the product in harsh environment such as near the fire source, do not knock, throw, trample, squeeze or put into the fire, if bulging, do not use.

3. Ambient temperature :0~45℃.

4. Do not violate the product instructions and use improperly, causing product damage or endangering personal and property safety, and bear the consequences.

5. Non-professional personnel are strictly prohibited from decomposing this product, otherwise it may lead to fire and even complete damage to this product.

6. Do not use the load that exceeds the output current of this product (electrical appliances), which will automatically stop working.

7. Please regularly clean the charging contact of the earphone with a clean cotton cloth to avoid the situation that the earphone cannot be charged or started due to long-term uncleaning.

8. Do not place the product in water (or washing machine). If the product is in water, please wait for it to dry naturally before use

**FCC Warning Statement:** Changes or modifications to this unit not expressly approved by the party responsible for compliance could void the user's authority to operate the equipment. This equipment has been tested and found to comply with the limits for a Class B digital device, pursuant to Part 15 of the FCC Rules. These limits are designed to provide reasonable protection against harmful interference in a residential installation. This equipment generates, uses and can radiate radio frequency energy and, if not installed and used in accordance with the instructions, may cause harmful interference to radio communications.

However, there is no guarantee that interference will not occur in a particular installation. If this equipment does cause harmful interference to radio or television reception, which can be determined by turning the equipment off and on, the user is encouraged to try to correct the interference by one or more of the following measures:

- Reorient or relocate the receiving antenna.
- Increase the separation between the equipment and receiver.
- Connect the equipment into an outlet on a circuit different from that to which the receiver is connected.
- Consult the dealer or an experienced radio/TV technician for help.

This device complies with Part 15 of the FCC Rules. Operation is subject to the following two conditions: (1) this device may not cause harmful interference, and (2) this device must accept any interference received, including interference that may cause undesired operation.

#### **FCC Radiation Exposure Statement**

The device has been evaluated to meet general RF exposure requirement. The device can be used in portable exposure condition without restriction.