

**N6** Quick Operation Manual  
Smart Mini POS Terminal

## Appearance Instructions

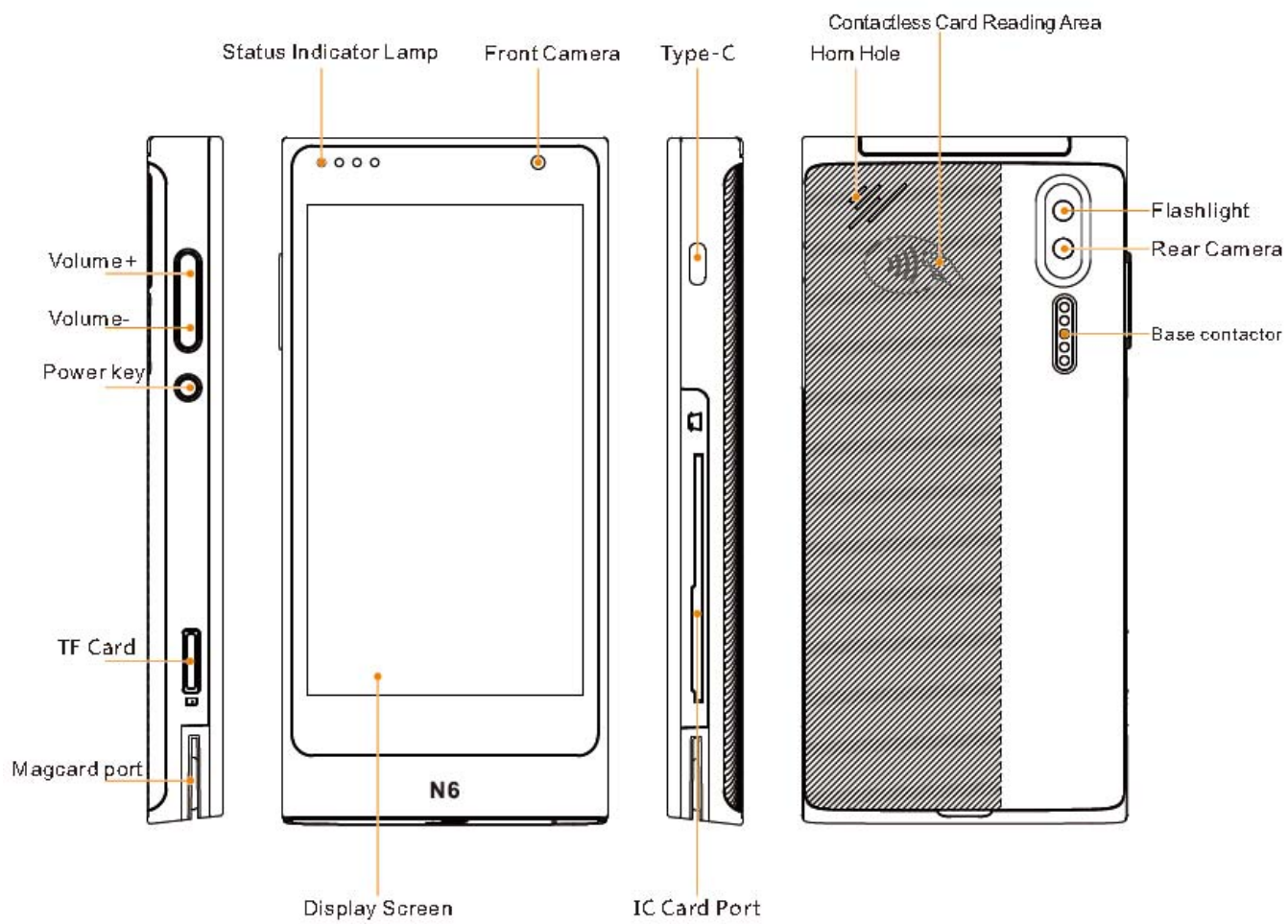

## Instructions

### Power on/off

Power on: press the "Power Key" on the left side of the POS Machine for 3 seconds, POS Machine will power on.

Power off: Under the status of powering on, press the "Power Key" then "Power Off" and "Restart" will be displayed on screen.

"Airplane Mode, Silent Mode" , Select "Power Off" and then the interface will display "Your smart terminal will power off, <Cancel> <Confirm>" . At the same time, press Enter to finish powering off.

### Magcard

Magcard Reading Area located at the bottom of the machine, while wiping the card, please downwards the magnetic stripe of magcard and then wipe the card from left or right in a smooth and steady speed, as shown in pic:

#### Attention

If the magnetic track is damaged or the way of wiping card is incorrect, it will cause transaction failure.

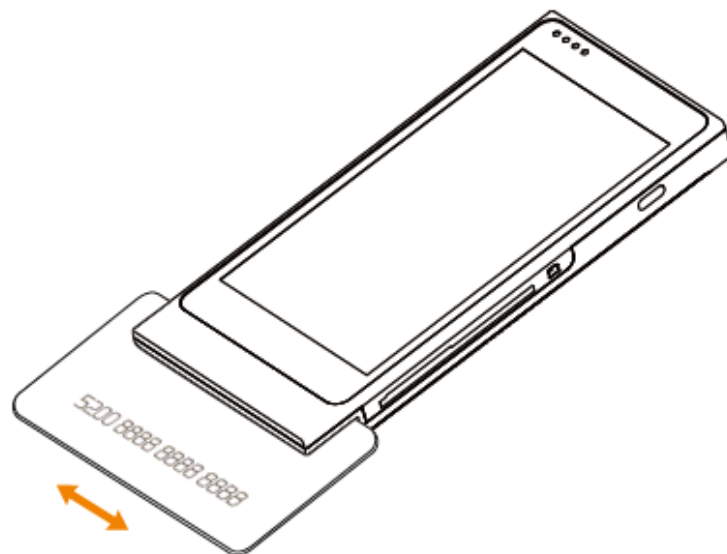

---

### **Contacting IC Card:**

IC Card locates at the right side of the machine. While inserting a card, IC Card Slot locates on the right side of the machine. While inserting card, take one side without chip of the IC Card by hand. The side with chip faces up, align the card slot and insert the IC Card till the bottom. In the procession of the transaction, IC card should be maintained inside the card slot as shown in pic:

Attention:if the contactor of the IC Card chip is damaged or oxidized, it will cause transaction failure.



### **Contactless IC Card :**

Contactless Card Reading Area locates at the back of the machine, while wiping a card, please take the IC Card near the midpoint of the contactless area and stay for about 1s. While hearing a sound "Diii" , it will prompt "Wipe Successfully" , and then remove the card as shown in pic.

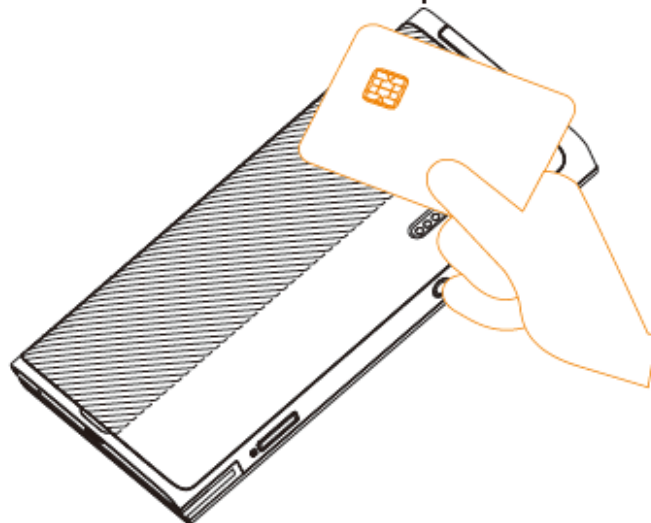

## Assemble/Disassemble Battery:



① Disassemble Battery Cover

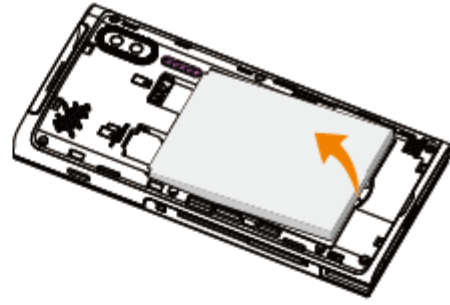

② Disassemble Battery

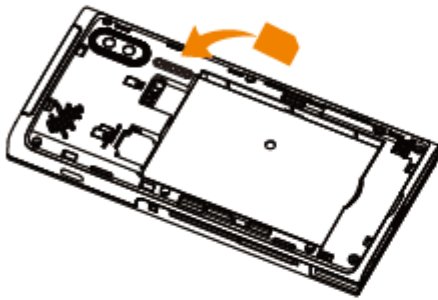

③ Insert a card



④ Assemble the back cover

① Open the battery cover

② Assemble Battery/ Disassemble Battery Holder

③ Insert SIM/PSAM Card

④ Assemble the back cover

## Assemble/Disassemble Fingerprint (Optional):

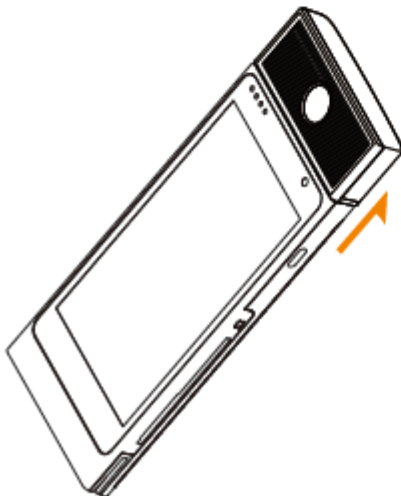

① Disassemble Fingerprint Module

## Charging:

Remove the battery cover, assemble the rechargeable lithium battery, and replace the battery cover. Connect the adapter or portable power source's USB interface by using USB main cable. Insert the USB small cable into the Type-C charging interface on the right side of machine. Plug the adapter into a power outlet. Power on the terminal. The terminal screen will display charging progress. After the terminal is fully charged, "  " will display. As it is shown below.

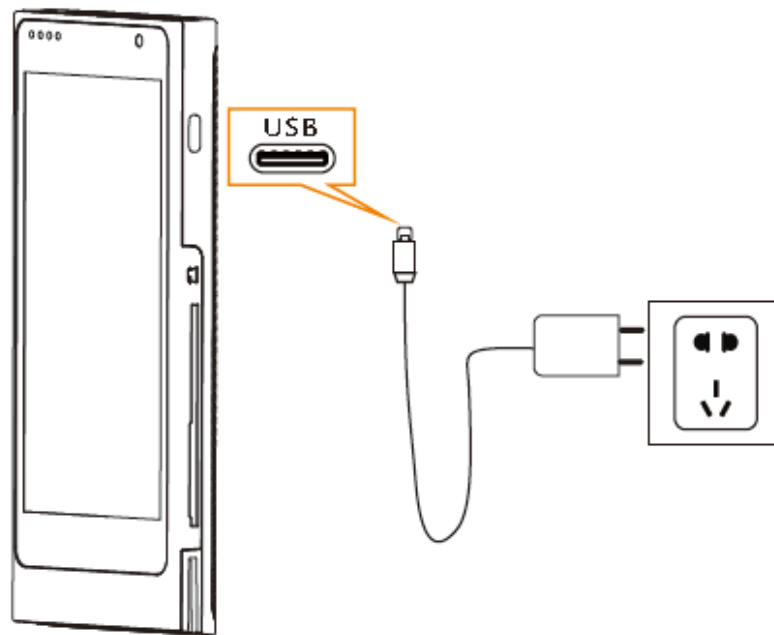

## Package List:

No.	Name	Quantity
1	Smart POS N6	1
2	Quick Operation Manual	1
3	Power Adapter	1
4	Disassemble Fingerprint Module (Optional)	1
5	Certification	1
6	Battery	1
7	Charging Base(Optional)	1

## List of Toxic and Hazardous Substances or Elements

Components	Hazardous and noxious substances or elements					
	Pb	Hg	Cd	Cr(VI)	PBB	PBDE
PCB Components	X	○	○	○	○	○

### Notes:

1) "○" means the content of this hazardous and noxious substance in all the homogeneous material of the component is below the requirement of SJ/T 11363-2006 standard.

2) "X" means that in the content of this hazardous and noxious substance, one of the homogeneous material is higher than the higher than the requirements of SJ/T 11363-2006 standard; but the components marked by "X" in the above form are all limited by the current industry technology developing level and cannot realize the substitution of the hazardous and noxious substances or elements.

### Environmental Protection Indication:

for the products which arrives or exceeds the durable life, should be recycling and reusing according to <The Management of Electronic and Information Product >, cannot discard carelessly

## Common Fault Analysis

If the following solutions do not solve an existing error, please contact Customer Service.

Category	Fault	Reason	Solution
ON/OFF Issue	Unable to power on terminal	1.Run out of battery; 2.Battery installation improperly; 3.AC power connect improperly; 4.Battery failure	1.Connect with AC power; 2.Confirm the battery is installed properly; 3.Confirm the AC power supply is plugged properly; 4.Replace battery.
PIN Pad Issue	No response	Terminal crash	Unplug power supply and battery, off and then restart the terminal
Communication Issue	Display reads:Communication Timeout	1.Weak wireless signal or no signal ; 2.SIM card Poor contact of SIM card connection 3.Terminal software issue;	1.Relocate the terminal to a window or open area; 2.Reinsert the SIM card; 3.Restart the terminal.
	Display reads: "Please Insert SIM Card" after SIM card is inserted	1.SIM card is damaged; 2.SIM card was inserted improperly;	1.Check if the SIM card is functioning,whether, the chip surface is oxidized or not, wipe the surface with a soft cloth;
Printer Issue	Blank printouts	Thermal printer paper is improperly placed;	Replace printer paper following "Install Paper Roll" guidelines above.
	Printing is too light/difficult to read	Poor quality printer papers used .	Replace with good quality printer papers.



<p><b>Card Read Error</b></p>	<p>Display reads: "Swipe Card Error, Please Swipe Again"</p>	<p>1. Reader is dirty; 2. Card is demagnetized; 3. Card swiped in opposite direction</p>	<p>1. Clean the card reader by inserting a moderately stiff piece of paper into the card slot and dragging the paper horizontally and vertically several times, removing any particles or dirt in the reader.</p> <p>2. Wipe any particles or dirt off of the magnetic strip on the card with a soft cloth; if the card is demagnetized, a replacement card may be needed from issuing bank;</p> <p>3. Please note the direction when swiping the card; the speed should be continuous.</p>
<p><b>Charging Error</b></p>	<p>Displays red battery icon after battery is installed and power adapter is connected</p>	<p>Li-battery was in storage for a long time , causing the battery to discharge below charging voltage; it can recover after reactivating.</p>	<p>If the battery icon displays red, please continue charging for 15 minutes; when the battery icon turns green, this indicates that the battery was successfully reactivated; it will perform normally after a complete recharge.</p>

## Attention of Installation and Operation



- Please follow the instruction strictly when install and connect the terminal.
- This terminal can only work with the specified power adapter, do not use other power supplies, otherwise it may cause abnormal operation or even damage the machine!
- Do not damage the USB cable and power adaptor. It can't be used any more if the power cable or power adaptor is damaged.
- Please check the service voltage set of the power supply socket before plugging the the power adapter into the ac socket. It is recommended to use the socket with fuse and good grounding.
- Please stay away from liquid. Do not splash any liquid substances or drop into conductive objects, or it will cause short circuit and damage the terminal.
- Please do not insert any foreign material into any ports, it will damage the terminal seriously.
- Please contact professional POS machine maintenance personnel if the equipment fails. Users and other non-qualified POS maintenances are not allowed to repair the equipment.
- Please use the standard printing paper in case of paper jam or printer damage.
- Please do not shake or knock the terminal violently..
- Please do not use or place flammability sprays or paints nearby etc., in case of fire.
- Forbid to disassemble or remake the terminal. Forbidden to use for illegal purposes, offenders will bear legal liability.

**FCC Statement**

This equipment has been tested and found to comply with the limits for a Class B digital device, pursuant to part 15 of the FCC Rules. These limits are designed to provide reasonable protection against harmful interference in a residential installation. This equipment generates, uses and can radiate radio frequency energy and, if not installed and used in accordance with the instructions, may cause harmful interference to radio communications. However, there is no guarantee that interference will not occur in a particular installation. If this equipment does cause harmful interference to radio or television reception, which can be determined by turning the equipment off and on, the user is encouraged to try to correct the interference by one or more of the following measures:

- Reorient or relocate the receiving antenna.
- Increase the separation between the equipment and receiver.
- Connect the equipment into an outlet on a circuit different from that to which the receiver is connected.
- Consult the dealer or an experienced radio/TV technician for help.

This device complies with part 15 of the FCC Rules. Operation is subject to the following two conditions: (1) This device may not cause harmful interference, and (2) this device must accept.

any interference received, including interference that may cause undesired operation. Caution Any changes or modifications not expressly approved by the party responsible for compliance could void the user's authority to operate the equipment.

SAR tests are conducted using standard operating positions accepted by the FCC with the device transmitting at its highest certified power level in all tested frequency bands, although the SAR is determined at the highest certified power level, the actual SAR level of the device while operating can be well below the maximum value.

Before a new model device is available for sale to the public, it must be tested and certified to the FCC that it does not exceed the exposure limit established by the FCC, Tests for each device are performed in positions and locations (e.g. at the ear and worn on the body) as required by the FCC.

For body worn operation, this model device has been tested and meets the FCC RF exposure guidelines when used with an accessory designated for this product or when used with an accessory that contains no metal and that positions the handset a minimum of 0 cm from the body.

For limb worn operation, this device has been tested and meets the FCC RF exposure guidelines when used with an accessory designated for this product or when used with an accessory that contains no metal.

Non-compliance with the above restrictions may result in violation of RF exposure guidelines.

## **Announcement**

Shenzhen Xinguodu Technology Co.,Ltd reserves the right to modify this manual without prior notice and continuously improve the accuracy, adequacy and completeness of the information contained in this manual. Shenzhen Xinguodu Technology Co.,Ltd does not bear legal liability for the adverse consequences caused by- using this product not in accordance with this manual or using accessories which are not supplied by Shenzhen Xinguodu Technology Co.,Ltd.

This manual is copyrighted by @ Shenzhen Xinguodu Technology Co.,Ltd.

**Shenzhen Xinguodu Technology Co., Ltd.**  
Company address:17B JinSong Mansion, Terra Industrial & Trade Park, Chegongmiao, Futian District, Shenzhen, China

Hotline: 400-609-6969  
Website:[www.xinguodu.com](http://www.xinguodu.com)