



Cloud Digital Photo Frame User's Manual



FCC ID:XBI19003200

MODEL: CD1900WV

For ongoing product improvement, this manual is subject to modification without prior notice.

User Notice

This product has met electronic emissions standards required. It can be used safely at home.

Contents

Before Operation

Product Introduction	2
Safety Precautions	3
Package Contents	5
Remote Control illustration	5

Basic Operation

Getting Started	7
Connect Power	7
Insert a memory card	8
Connect to the computer	8
Start-Up & Navigation	9
Dual Interface	9
Status Icon Briefing	10

Advanced Operation

WiFi Setup	11
Google Account	12
Google Play Store	12
Online Photos	13
Online Videos	14
Social Media	15
LAN Photos & Videos	15
Local Photos	16
Local Videos	16
Settings Menu Overview	17

Customer Management

FAQs	18
Support	18
Tips	18

Before Operation

Product Introduction

14" WiFi Digital Photo Frame, share your favorite photos and videos from the internet with friends, family and places of business, and bring endless photo and video storage with easy navigation to your home or business.

Features:

- Build up your own cloud albums, manage remote frames slide shows
- Enjoy 10GB free cloud storage space.
- View photos you stored in your cloud storage
- View photos scattered in computers in your home LAN
- View photos stored in your SD cards
- Store your most precious photos in internal memory and display them
- Share photos with your family and friends via internet
- Support display multimedia
- Dual interface, modern and traditional, for your selection
- High resolution screen to show details of the photos
- Motion sensor remote controller eases your internet surfing
- Wireless link to internet automatically

Specifications:

- Display resolution : 1366x768pixels (16:9)
 - Display size: 19 inch LED
 - Internal memory: 8GB
 - Multimedia support: Photo / Video / Audio
 - Built-in WiFi : 802.11 b/g/n
 - Memory Card: SD/SDHC
 - Speakers: 2 x 2W
 - G-sensor: Yes
 - USB type: 1xMini USB OTG, 1x USB host
 - Power Adaptor: Input: 110~240V; Output: 12V, 2A
- Remote: Motion Sensor RC

Before Operation

Safety Precautions

Please read the following guidelines carefully to ensure user safety.

Power Precautions

⚠ WARNING: indicates information that, if neglected, could result in serious injury and/or death to the user.

⚠ CAUTION: indicates information that, if neglected, could result injury to the user and/or material damage.

01. Use only the authorized power supply product. Failure to do so could result in product malfunction.

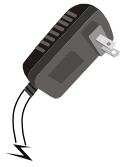

02. When connecting the power source, make sure that your hands are free of moisture. Failure to do so could result in electrical shock.



03. Make sure that the power supply is firmly plugged in and not loose. Failure to do so could result in electrical shock.

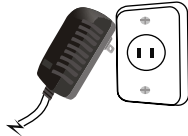

04. Do not let the power cord get overly entangled and do not place any heavy objects on the cord. Failure to do so could result in electrical shock.

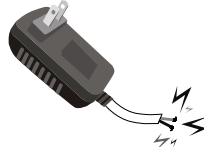

05. Do not connect the power supply to an electrical power strip with other various connections. Failure to do so could result in fire.

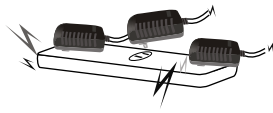

06. Disconnect the power supply during inclement weather conditions that include thunder and lightning. Failure to do so could result in fire.

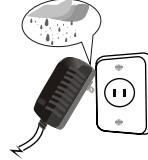

Before Operation

Safety Precautions

Please read the following guidelines carefully to ensure user safety and avoid malfunction.

Product Related Precautions

01. Dropping the product or subjecting it to a significant impact can cause critical damage.

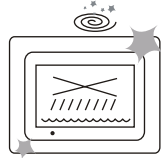

02. Spilling water or any other liquid on the product can cause critical damage.



03. Striking or scratching the LCD screen may cause critical damage.

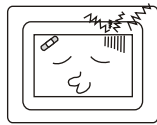

04. When cleaning the LCD screen, turn off the power and wipe it gently with a soft cloth.

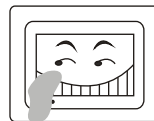

05. Do not subject the product to severe humidity and/or heat.

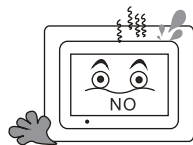

06. Make sure to power off the unit before disconnecting the power supply.

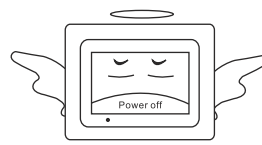

Before Operation

Package Contents

- 19" Cloud Digital Photo Frame
- Quick Start Guide
- Remote Control
- Power Adaptor
- Stand
- Limited Warranty

Remote Control



Tip: Click the  button to lock screen, and press again to unlock screen.

Note: Insert remote control receiver in the USB port before you use the remote control.

Before Operation

Motion Sensor Remote illustration

Open battery compartment, you will see a mini receiver, plug the mini receiver into the USB port, put in batteries, close compartment. Then click the  button on the remote control, now, you can use your motion sensor remote.



The Mini receiver



Take out the Mini receiver



Plug the mini receiver into the USB port



Put in 2 AAA batteries into the Remote Control

Basic Operation

Getting Started

Your frame can either sit on the top of a surface with the stand or hang on the wall with the optional support (not included)

Sitting on top of a surface



hang on a wall

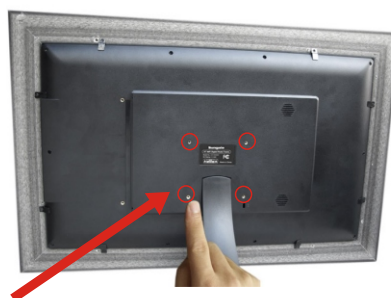

Wall mounting hole
(The wall mounting support is not included)

Connect Power

Plug the Power Adaptor into the frame and also into a Power Outlet.



Basic Operation

Insert a memory card

Insert card in the direction indicated by the arrow on the top of the card (the side of the memory card on which sticker is affixed face the frame).

SD/SDHC card is compatible with this unit.

Aligning the memory card upside down may cause user-error damage.

This may nullify the warranty.

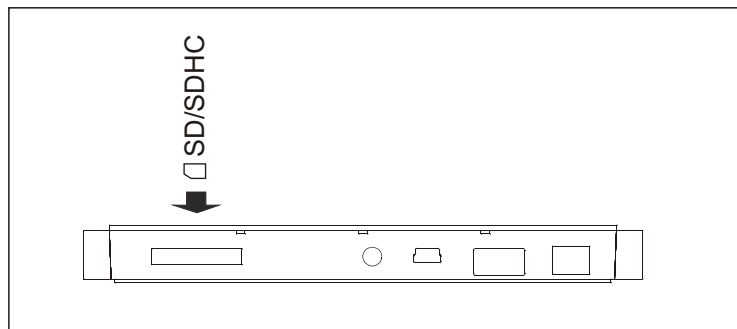

Connect the Cloud DPF to the computer

Use the USB cable, you can connect the Cloud DPF to the computer

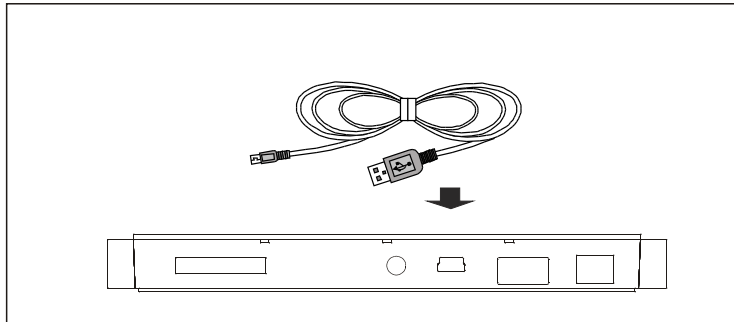

Removing the Memory Card

When removing a memory card from the frame, pull the card straight away from the unit. Avoid bending the card.

Basic Operation

Dual Interface

Block Interface



Traditional Interface

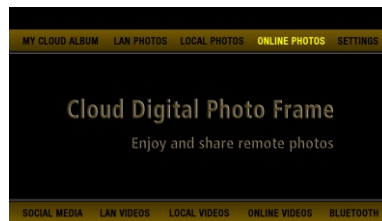

To switch between interface, Hold the “OK” key to slash cursor on home screen.

Basic Operation

Status Icon Briefing



- ① **MY Cloud Album:** to share or review the photos in cloud storage space.
- ② **Online Photos:** to review or download photos from website.
- ③ **Local Photos:** Display or review the photos stored in internal memory, SD card, U-Disk.
- ④ **Local Videos:** Play or view the videos stored in internal memory, SD card, U-Disk.
- ⑤ **Online Videos:** to review or download videos from website.
- ⑥ **Dropbox:** to connect with other DPF or mobile to share the pictures
- ⑦ **Social Media:** reach to facebook, twitter or google play's login page.
- ⑧ **LAN Photos:** to share or review the photos in local internet.
- ⑨ **LAN Videos:** to share or review the videos in local internet.
- ⑩ **Settings:** Configure the unit.
Have four icons in this route: Browser, all Apps, Files, Settings.

Advanced Operation

WiFi Setup

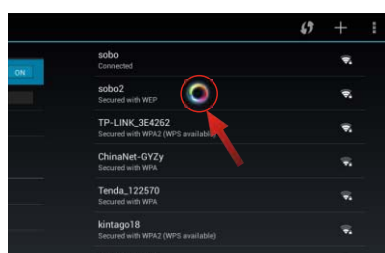

Step 1.

To setup the WiFi Connection on your photo frame, click “SETTINGS” from the home screen. (Cont. Next page)

Step 2.

Select the “SETTINGS” menu icon.

Step 3.

Slide the WiFi button to the “ON” position.

Step 4.

Select your network, put in your password, and then click “connect”.

Note: In order to use the online features of this frame, you must connect your frame to a WiFi internet connection.

Advanced Operation

Online Account Setup Part 1: Google Account

A Google Account will allow you to access the Google Play Store for APP downloads, and Google applications.

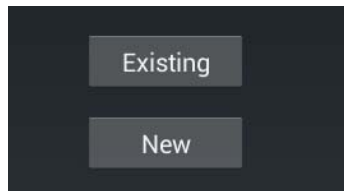
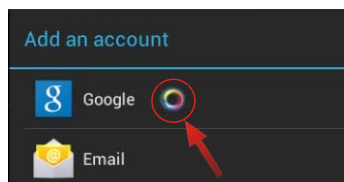
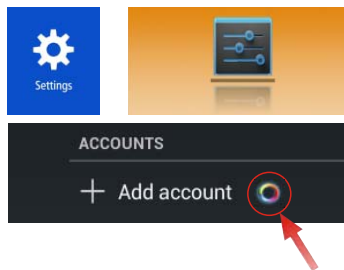

Step 1.

Go to the Settings menu, and scroll down to “+Add account”, and click it.

Step 2.

Click “Google” under the add an account menu.

Step 3.

Click “Existing” if you currently have a gmail email account and put in your email and password.

Click “New” to setup a gmail email account.

Google Play Store

Once you have setup your Google Account, you can access Google Play.

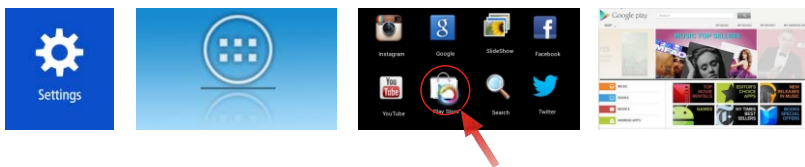

Advanced Operation

Online Account Setup Part 2: Online Photos

The Online Photos tab gives you access to a numerous amount of online Photo Hubs.



To access these Photo Hubs select Online Photos.



Select the "+" symbol in the lower right corner to enter the online storage back list.



Select any Hub to install and download to your frame.

Select "YES" to download



Select "YES" to install



After the installation is complete, your Hub will be available on the front screen. You can now select and use it.

Advanced Operation

Online Account Setup Part 3: Online Videos

The Online Videos tab gives you access to a numerous amount of online Video Hubs.



To access these Video Hubs select Online Videos.



Select the "+" symbol in the lower right corner to enter the online storage back list.



Select any Hub to install and download to your frame.

Select "YES" to download



Select "YES" to install

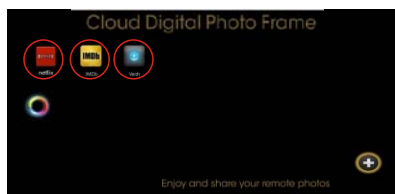

After the installation is complete, your Hub will be available on the front screen. You can now select and use it.

Advanced Operation

Online Account Setup Part 4: Social Media

Your frame has been pre-installed with 3 popular Social Media buttons right from the home screen. These include Facebook, Twitter and Google +.



LAN Photos & Videos

Your frame can access photos and videos that are available on a shared folder or shared device within your own LAN (Local Area Network)

Click the LAN Video or Photo icon and a search will automatically begin. Select the device you want to browse files of.



If no device is discovered, click the “refresh” icon in the lower corner to begin the search again.



Note: In some instances, you may have to turn off the firewall settings of a specific folder in order to have it show up. This can be done in your “Network Sharing Center”.

Advanced Operation

Local Features Part 1: Local Photos

Your frame comes with internet memory and also an SD card slot to store your photos on the frame itself.

Select the “Local Photos” icon.



Select an album

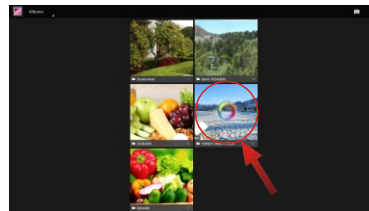

All the pictures will load in that album and if selecting a picture, you can start a slideshow by selecting the options, and then slideshow.

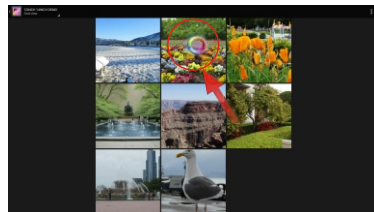

Local Features Part 2: Local Videos

Select the “Local Videos” icon.



Select the video you want to Play.

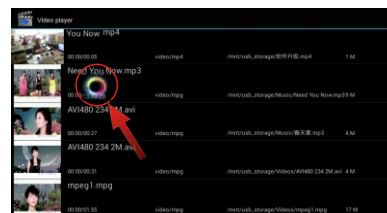

Advanced Operation

Settings Menu Overview

APP Block



Where your downloaded & installed Apps and Google Play are located.

Web Browser



Where you can browse, surf and search the internet.

File Directory



Where you can search for locally installed apps & files.

Settings Menu



Where all your device settings are located for your frame.

Customer Management

FAQs:

Q 1: Why can't I link to Wi-Fi?

A: Please check if you have turned on Wi-Fi. Go to → “Setting” → “Wireless & Networks” → Slide “off” to “on”.

Please check if you have input the right password of Wi-Fi router. For more Wi-Fi related questions, please go to www.sungale.com and find Support Wi-Fi related FAQ.

Q2: Why can't I download applications from the Market?

A: Please check if you have registered a Google account; pls check if the storage of DPF lack of space, in that case, you need to insert an SD card.

Q3: How to find more operations when running an application?

A: Click Menu icon on the top right corner.

Support

1. Visit the support site.

- For manual download, FAQs and more supports: www.sungale.com

2. Contact Sungale Support team

- Toll free number in the USA: 800-473-5156
- Service email: service@sungale.com

Tips

To go to YouTube.com to search “SungaleProducts”, you will see product demo videos, the videos give much easier way to know how to setup and how to use the products.

FCC statement

This device complies with Part 15 of the FCC Rules: Operation is subject to the following two conditions:

1. This device may not cause harmful interference and
2. This device must accept any interference that is received, including any interference that may cause undesired operation.

This device is acting as slave and operating in the 2.4 GHz (2412 ~2462 MHz) band.

Ad Hoc function is supported but not able to operate on non-US frequencies. Do not use the device with the environment which below minimum -10 °C or maximum over 50°C .

NOTE: This equipment has been tested and found to comply with the limits for a Class B digital device, pursuant to part 15 of the FCC Rules. These limits are designed to provide reasonable protection against harmful interference in a residential installation. This equipment generates uses and can radiate radio frequency energy and, if not installed and used in accordance with the instructions, may cause harmful interference to radio communications. However, there is no guarantee that interference will not occur in a particular installation. If this equipment does cause harmful interference to radio or television reception, which can be determined by turning the equipment off and on, the user is encouraged to try to correct the interference by one or more of the following measures:

- Reorient or relocate the receiving antenna.
- Increase the separation between the equipment and receiver.
- Connect the equipment into an outlet on a circuit different from that to which the receiver is connected.
- Consult the dealer or an experienced radio/TV technician for help

LIMITED WARRANTY

The limited warranty set forth below is given by the manufacturer with respect to Sungale brand DPF players and other consumer electronics products purchased and used in the United States of America. The manufacturer warrants this product against defects in material or workmanship as follows:

LABOR: For a period of ninety (90) days from the date of purchase if this Product is defective, the manufacturer will repair or replace the Product, at its option, at no charge. After this ninety (90) days period up to one year, a labor charge of US\$30.00 will be charged for each service.

PARTS: For a period of one year from the date of purchase, the manufacturer will supply, at no charge, new or rebuilt replacement parts in exchange for defective parts. After this one year period, the manufacturer will charge the new or replacement parts.

This warranty does not cover: (1) customer instruction, installation or set up; (2) cosmetic damage or damage due to accident, misuse, abuse, or negligence; (3) commercial use of the Product; (4) modification of any part of the Product; (5) damage due to improper operation, improper maintenance, or connection to an improper voltage supply; (6) damage due to an attempted repair of the Product by anyone other than a facility authorized by the manufacturer to service the Product; (7) consumables (such as fuses and batteries). This warranty is valid only in the United States.

The product must be accompanied by a copy of the original retail purchase receipt. If no proof of purchase is attached, the warranty will not be honored and repair cost will be charged.

This warranty is valid with attach written documentation detailing the complaint to the outside or inside of the carton.

This warranty is invalid if the factory applied serial number has been altered or removed from the Product.

The manufacturer reserves the right to modify any design of this product without prior notice.

To obtain warranty service, you must deliver the product freight prepaid, in either its original packaging or packaging affording an equal degree of protection, plus proof of purchase, to:

Service Center
13941 Central Ave,
Chino, CA 91710
Tel: **800-473-5156**

REPAIR OR REPLACEMENT AS PROVIDED UNDER THIS WARRANTY IS THE EXCLUSIVE REMEDY OF THE CONSUMER. THE SERVICE CENTER SHALL NOT BE LIABLE FOR ANY INCIDENTAL OR CONSEQUENTIAL DAMAGES FOR BREACH OF ANY EXPRESS OR IMPLIED WARRANTY ON THIS PRODUCT. EXCEPT TO THE EXTENT PROHIBITED BY APPLICABLE LAW, ANY IMPLIED WARRANTY OF MERCHANTABILITY OR FITNESS FOR A PARTICULAR PURPOSE ON THIS PRODUCT IS LIMITED IN DURATION TO THE DURATION OF THIS WARRANTY.

Some states do not allow the exclusion or limitation of incidental or consequential damages, or allow limitations on how long an implied warranty lasts, so the above limitations or exclusions may not apply to you. This warranty gives you specific legal rights, and you may have other rights which vary from state to state.