

⚡ WARNING ⚡
RISK OF ELECTRIC SHOCK

- TO REDUCE THE RISK OF ELECTRIC SHOCK, DO NOT REMOVE FRONT OR BACK COVER.
- READ THE MANUAL AND SAFETY PRECAUTIONS BEFORE PERFORMING INSTALLATION.
- MAKE SURE THE POWER CORD IS PLUGGED INTO THE SYSTEM BEFORE CONNECTING THE POWER CORD TO AN AC POWER OUTLET.
- DISCONNECT POWER FROM THE SYSTEM BY UNPLUGGING THE POWER CORD FROM AC OUTLET.
- THE AC POWER OUTLET SHOULD BE COMPATIBLE WITH THE 3-PIN POWER CORD CONNECTOR.

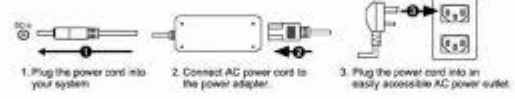

Label 1

Labe 2

Label 3

Model Name: AID 240SBW
Input Rating: 100-240Vac, 2.0-1.0A, 50-60Hz
 For use only with power adapter:
 Mfr.: EDAC POWER ELECTRONICS CO LTD
 Model: EM11013CWWWWW
 Input: 100-240Vac, 50-60 Hz, 2.0-1.0A
 Output: 19Vdc, 4.73A, Max. 90W
 Manufacturer : Avalue Technology Inc. TEL: +886-2-8226-2345
 7F. No.228, Lian Cheng Road, Zhonghe District, New Taipei City, 235, Taiwan

FC

CLASSIFIED
UL US
 E384674

MEDICAL - GENERAL MEDICAL EQUIPMENT AS TO ELECTRICAL SHOCK, FIRE AND MECHANICAL HAZARDS ONLY IN ACCORDANCE WITH ANSI/AAMI ES 60601-1 (2005) + AMD (2012) and CAN/CSA-C22.2 No. 6060-1 (2008) + (2014)

This device complies with Part 15 of the FCC rules. Operation is subject to the following conditions: (1) this device may not cause harmful interference and (2) this device must accept any interference received, including interference that may cause undesired operation

AID 240SBW Medical Computers
 FCC ID: XBG-AID240SBWMD IC: 21285-MD551
 Contains:
 FCC ID: TX2-RTL8821AE IC: 6317A-RTL8821AE
MADE IN TAIWAN
 Manufacture Date: 2016-05
 Rev.1.30 30ACH
 S/N: 0000AF00277 P/N: AID-240SBW01-D02R