



HC40BL

User manual

Contents

Preface	3
Valid for	4
Important information	5
Safety instructions.....	5
Safety issues.....	5
Only for EU markets	8
Only for Non EU markets	8
Misuse	8
Informations importantes	9
Consignes de sécurité	9
Seulement pour les marchés au sein de l'UE	10
Seulement pour les marchés hors UE	10
Utilisation abusive	10
Repairs	11
Manufacturer's declaration	11
Misc. on the HOMELINE® system	12
Warranty.....	12
Maintenance.....	12
ETL-marking	13
Getting started	14
Batteries and how to change for the HC40 FRAME™ Advanced.....	14
Batteries and how to change for the HC40 TWIST™ Advanced.....	15
Navigation	16
Screen elements	16
Setting time and day	17
Screen saver	18
Motion sensor	19
Favourite positions	21
Massage	23
My bed menu	25
About	26
Me	27
Alarms	28
Sleep timer	29
Shortcuts	30
Time & Day	31
Language	32
Child lock	33
Torch	34
Notifications	35
Disposal of LINAK's products	36
Main groups of disposal	36
Disposal of batteries	36
Labels	37
Drawings	38
Addresses	40

Preface

We are delighted that you have chosen a product from LINAK®.

LINAK systems are high-tech products based on many years of experience in the manufacture and development of actuators, electric control boxes, controls and chargers.

This User Manual does not address the end-user. It is intended as a source of information for the manufacturer of the equipment or system only, and it will tell you how to install, use and maintain your LINAK electronics. It is the responsibility of the manufacturer of the end-use product to provide a User Manual where relevant safety information from this manual is passed on to the end-user.

We are sure that your LINAK product/system will give you many years of problem-free operation.

Before our products leave the factory they undergo full function and quality testing. Should you nevertheless experience problems with your LINAK product/system, you are always welcome to contact your local dealer.

LINAK subsidiaries and some distributors situated all over the world have authorised service centres, which are always ready to help you.

LINAK provides a warranty on all its products. This warranty, however, is subject to correct use in accordance with the specifications, maintenance being done correctly and any repairs being carried out at a service centre, which is authorised to repair LINAK products.

Changes in installation and use of LINAK products/systems can affect their operation and durability. The products are not to be opened by unauthorised personnel.

The User Manual has been written based on our present technical knowledge. We are constantly working on updating the information and we therefore reserve the right to carry out technical modifications.

LINAK A/S

Valid for:

This User Manual is valid for the following products:

Controls: HC40 FRAME™ Advanced and HC40 TWIST™ Advanced

Important information

Important information on LINAK® products can be found under the following headings:



Warning!

Failure to comply with these instructions may result in accidents involving serious personal injury.



Failing to follow these instructions can result in the product being damaged or being destroyed.

Safety instruction



General

Safe use of the system is possible only when the operating instructions are read completely and the instructions contained are strictly observed.

Failure to comply with instructions marked with the "NOTE" symbol may result in serious damage to the system or one of its components.



It is important for everyone who is to connect, install, or use the systems to have the necessary information and access to this User Manual. Follow the instructions for mounting – risk of injury if these instructions are not followed.



The appliance is not intended for use by young children or infirm persons without supervision.



If there is visible damage on the product it must not be installed.



Assure free space for movement of application in both directions to avoid blockade.



The appliance is only to be used with the power supply unit provided with the appliance.

Safety issues



The builder of the equipment shall ensure that the use of the component complies with relevant standards – like the Machine Directive. Care must be taken to avoid squeezing of cables as it can cause movement of the system!

Updated manuals and declarations can always be found here:
www.linak.com/homeline

This device complies with part 15 of the FCC Rules. Operation is subject to the following two conditions:

- (1) This device may not cause harmful interference, and**
- (2) This device must accept any interference received, including interference that may cause undesired operation**

- **Statement – for all intentional and unintentional radiators:**

Changes or modifications not expressly approved by the party responsible for compliance could void the user's authority to operate the equipment.

- **Statement for digital devices for Class B:**

NOTE: This equipment has been tested and found to comply with the limits for a Class B digital device, pursuant to part 15 of the FCC Rules. These limits are designed to provide reasonable protection against harmful interference in a residential installation. This equipment generates, uses and can radiate radio frequency energy and, if not installed and used in accordance with the instructions it may cause harmful interference to radio communications. However, there is no guarantee that interference will not occur in a particular installation. If this equipment does cause harmful interference to radio or television reception, which can be determined by turning the equipment off and on, the user is encouraged to try to correct the interference by one or more of the following measures:

- Reorient or relocate the receiving antenna.
 - Increase the separation between the equipment and the receiver.
 - Connect the equipment into an outlet on a circuit different from that to which the receiver is connected.
 - Consult the dealer or an experienced radio/ TV technician for help.
-

This device contains licence-exempt transmitter(s)/receiver(s) that comply with Innovation, Science and Economic Development Canada's licence-exempt RSS(s).

Operation is subject to the following two conditions:

- (1) this device may not cause interference, and
- (2) this device must accept any interference, including interference that may cause undesired operation of the device.

L'émetteur/récepteur exempt de licence contenu dans le présent appareil est conforme aux CNR d'Innovation, Sciences et Développement économique Canada applicables aux appareils radio exempts de licence. L'exploitation est autorisée aux deux conditions suivantes :

- (1) l'appareil ne doit pas produire de brouillage, et
 - (2) l'appareil doit accepter tout brouillage radioélectrique subi, même si le brouillage est susceptible d'en compromettre le fonctionnement.
-

Labeling Requirements:

This Class B digital apparatus complies with Canadian ICES-003.

Cet appareil numérique de la classe B est conforme à la norme NMB-003 du Canada.

Only for EU markets



This appliance can be used by children aged from 8 years and above and persons with reduced physical, sensory or mental capabilities or lack of experience and knowledge if they have given supervision or instruction concerning use of the appliance in a safe way and understand the hazards involved.



Children shall not play with the appliance. Cleaning and user maintenance shall not be made by children without supervision.

Only for Non EU markets



Persons who do not have the necessary experience or knowledge of the product/products must not use the product/products. Besides, persons with reduced physical, sensory or mental abilities must not use the product/products, unless they are under surveillance or they have been thoroughly instructed in the use of the apparatus by a person who is responsible for the safety of these persons.



Moreover, children must be under surveillance to ensure that they do not play with the product.

Misuse



Do not overload the actuators – this can cause danger of personal injury and damage to the system.



Do not use the actuator system for lifting persons. Do not sit or stand on a table while operating – risk of personal injury.



Do not use the system in environments other than the intended indoor use

Informations importantes

Les informations importantes sur les produits LINAK® peuvent être trouvées dans les rubriques suivantes:



Attention!

Le non respect de ces instructions peut entraîner des accidents impliquant des blessures graves.



Ne pas suivre ces instructions peut entraîner l'endommagement ou destruction du produit.

Consignes de sécurité



Général

L'utilisation en toute sécurité du système n'est possible que si l'intégralité des instructions ont été lues et ont été strictement suivies.

Le non respect de se conformer aux instructions marquées du symbole "note" peut entraîner de graves dommages au système ou à un de ses composants.



Il est important pour tout individu qui connecte, installe, ou utilise le système d'avoir les informations nécessaires et l'accès à ce manuel d'utilisation.

Suivez les instructions pour le montage – risque de blessure si ces instructions ne sont pas suivies.



L'appareil n'est pas destiné à être utilisé par des enfants ou des personnes handicapées sans surveillance.



S'il y a des dommages visibles sur le produit, l'installation ne doit pas être effectuée.



Assurez un espace libre autour du matériel pour éviter tout blocage.



Le constructeur de l'équipement doit s'assurer que l'utilisation du composant conforme aux normes en vigueur, comme la Directive Machines. Les soins doivent être prises pour éviter de pincer les câbles car cela pourrait entraîner des mouvements du système!

Les mises à jours des manuels et autres informations peuvent-être trouvées sur www.linak.com/homeline

Seulement pour les marchés au sein de l'UE:



Cet appareil peut-être utilisé par des enfants âgés de 8 ans et plus, ainsi que les personnes dont les capacités physiques, sensorielles ou mentales sont réduites ou ayant un manque d'expérience et de connaissance si elles ont bénéficié d'une surveillance ou d'instructions concernant l'utilisation de l'appareil en toute sécurité et compris les risques encourus.



Les enfants ne doivent pas jouer avec l'appareil. Le nettoyage et l'entretien ne doivent pas être réalisés par des enfants sans surveillance.

Seulement pour les marchés hors UE:



Les personnes qui n'ont pas l'expérience ou les connaissances nécessaires sur le ou les produit(s) ne doivent pas le ou les utiliser. Par ailleurs, les personnes ayant des capacités physiques, sensorielles ou mentales réduites ne doivent pas utiliser le ou les produit(s), sauf si elles sont sous surveillance ou ont suivi une formation approfondie de l'utilisation de l'appareil par l'individu responsable de la sécurité de ces personnes.



De plus, les enfants doivent-être sous surveillance afin de s'assurer qu'ils ne jouent pas avec le produit.

Utilisation abusive:



Ne surchargez pas les actionneurs – cela peut engendrer un risque de blessures corporelles et endommager le système.



Ne pas utiliser les actionneurs pour soulever des personnes. Ne pas s'asseoir ou se tenir debout sur une table en fonctionnement – risque de blessures.



Ne pas utiliser le système dans des environnements autres que l'utilisation intérieure prévue.

Repairs

In order to avoid the risk of malfunction, all HOMELINE® repairs must only be carried out by authorised LINAK® workshops or repairers, as special tools must be used and special gaskets must be fitted. Lifting units under warranty must also be returned to authorised LINAK workshops.



Warning!

If any of the HOMELINE® products are opened, there will be a risk of subsequent malfunction.



Warning!

The HOMELINE® systems are not resistant to cutting oil.

DECLARATION OF INCORPORATION OF PARTLY COMPLETED MACHINERY

LINAK A/S
Smedevænget 8
DK - 6430 Nordborg

Name and address of the person authorized to compile the relevant technical documentation:
John Kling, Group Headquarters, Guderup, DK-6430 Nordborg, email jkl@linak.com

Herewith declares that LINAK Actuators and Actuator Systems comply with the following parts of the Machinery Directive 2006/42/EC, ANNEX I, *Essential health and safety requirements relating to the design and construction of machinery*:

1.5.1 Electricity supply: *Directive 2006/95/EC on the harmonization of the laws of Member States relating to electrical equipment designed for use within certain voltage limits.*

1.5.10 Radiation, 1.5.11 External radiation: *Directive 2004/108/EC on the approximation of the laws of the Member States relating to electromagnetic compatibility.*

The relevant technical documentation is compiled in accordance with part B of Annex VII and that this documentation or part hereof will be transmitted by post or electronically to a reasoned request by the national authorities.

This partly completed machinery must not be put into service until the final machinery into which it is to be incorporated has been declared in conformity with the provisions of this Directive, where appropriate.

Date: 2010-01-01

Signature:

John Kling
Certification and Regulatory Affairs

Misc. on the HOMELINE® system

Warranty

There is a 36 months' warranty on the HC40 products against manufacturing faults calculated from the production date of the individual products (see label). The LINAK warranty is only valid in so far as the equipment has been used and maintained correctly and has not been tampered with. Furthermore, the system must not be exposed to violent treatment. In the event of this, the warranty will be ineffective/invalid. For further details, please see standard terms of sale and delivery for LINAK A/S.

Maintenance

Clean dust and dirt on the outside of the system at appropriate intervals and inspect for damage and breaks. Inspect the connections, cables, and plugs and check for correct functioning as well as fixing points.



The cleaners and disinfectants must not be highly alkaline or acidic (pH value 6-8).

ETL-marking

Due to space limitations, the complete ETL-marking demands are not represented on the marking plates.

The full ETL Recognized Component markings are shown here.



C/N 120690

Conforms to UL962
Cert. to CSA Std. C22.2 No. 68-09

ETL Recognized Component mark for Canada and United States



C/N 9901916

Conforms to UL962
Cert. to CSA Std. C22.2 No. 68-09

ETL Recognized Component mark for Canada and United States



C/N 4008003

Conforms to UL962
Cert. to CSA Std. C22.2 No. 68-09

ETL Recognized Component mark for Canada and United States



C/N 4008005

Conforms to UL962
Cert. to CSA Std. C22.2 No. 68-09

ETL Recognized Component mark for Canada and United States



C/N 4008671

Conforms to UL962
Cert. to CSA Std. C22.2 No. 68-09

ETL Recognized Component mark for Canada and United States



C/N 4009507

Conforms to UL962
Cert. to CSA Std. No. 68-09

ETL Recognized Component mark for Canada and United States

Getting started

Batteries and how to change for the HC40 FRAME™ Advanced

The hand control needs 2 x AAA batteries.

1. Press the button located inside the oval arch at the bottom of the hand control. Take off the battery lid.



2. Put in the new batteries as indicated in the housing.



We recommend to use alkaline batteries. Using another type of batteries can lead to unintended restart of the hand control.

3. Reattach the battery lid by placing the lower end of the lid and then press below the 'down' button.

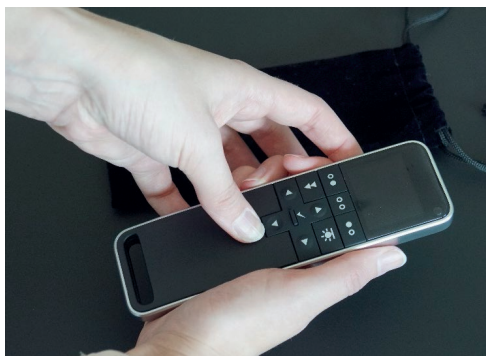
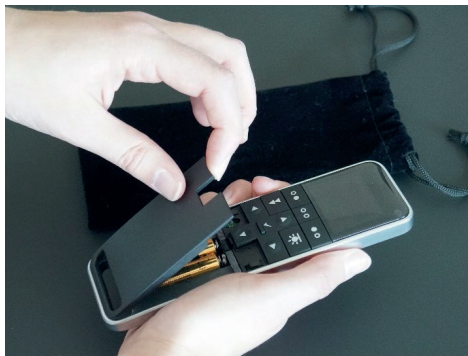

After insertion of the batteries in the HC40, a start-up logo appears for 5 seconds.

Batteries and how to change for the HC40 TWIST™ Advanced

The hand control needs 2 x AAA batteries.

1. Open the battery lid on the front of the HC40, by pressing and sliding it in the opposite direction of the keypad.



2. Put in the new batteries as indicated in the housing.



We recommend to use alkaline batteries. Using another type of batteries can lead to unintended restart of the hand control.

3. Reattach the battery lid by placing it back on the hand control and then slide it on in the direction towards the keypad.

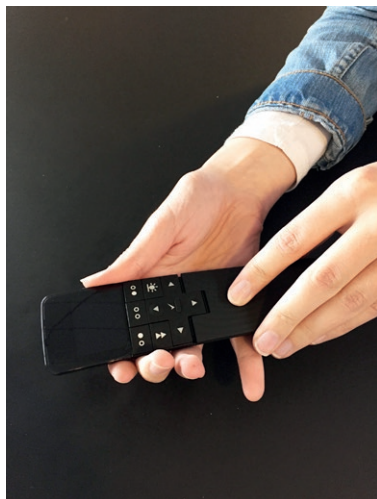

Navigation

The HC40 has 10 buttons. The picture below explains the functionality of the buttons:

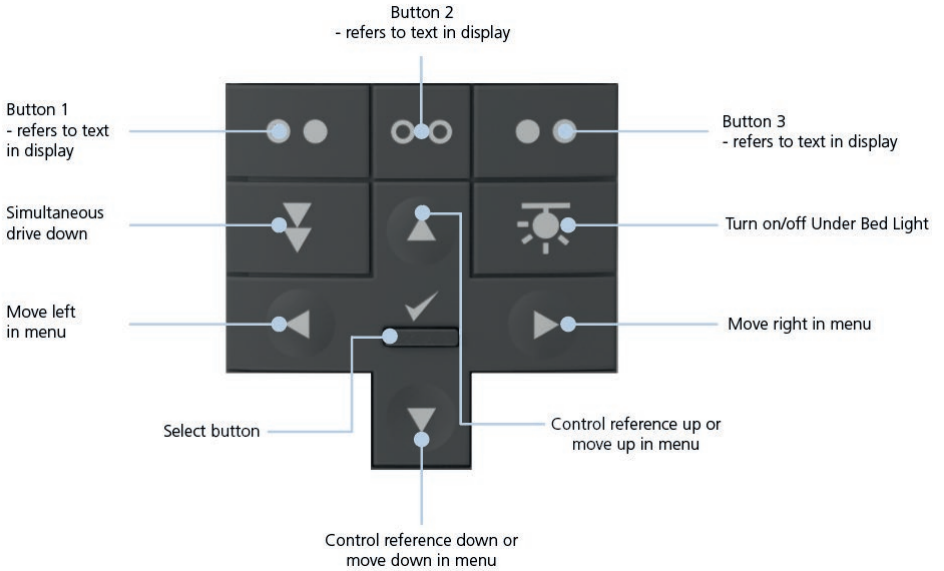

Screen elements



Menu colours:

- White References
- Blue Favourite positions
- Green Massage control
- Orange My bed menu

Setting time and day

1. Press button 1 to switch between 24H and AM/PM.



2. Adjust the time by using the 'up' and 'down' buttons on the keypad. Once the hours and minutes are adjusted, "SAVE" appears in the display. Press the 'select' button or button 3 "SAVE" to save the time.



3. Use the 'left' and 'right' buttons to adjust the day of the week. Press the 'select' button or button 3 "SAVE" to save the day.



The hand control is now ready for exploring the menu and the features.

Screen saver

After 10 seconds of inactivity the HC40 dims the light in the display. After another 10 seconds in dimmed light, the display turns off.

The next time the hand control is picked up, the screensaver (time and day) or a notification shows.



Motion sensor

After setting the time and day in the HC40, the motion sensor is enabled. The screen now reacts on any movement of the hand control. E.g. the screen turns on, when the user picks up the hand control.

As the motion sensor may cause the batteries to empty during bumpy transportation before the hand control reaches its destination, we recommend the bed producer not to complete the time and day registration in the HC40 if the hand control is delivered to the end user with batteries in.

Demo mode and how to pair

As long as the remote is not paired to any actuator system, the menu structure will be accessible to loop around in for demonstration purposes. We call this demo mode.

After 5 minutes active surfing around the menu structure in demo mode, a 'help-to-pair' guide appears.

1. Set the bed in pairing mode by applying power to the system.
2. Press button 1 and 3 at the same time.
3. With successful pairing a blue circle with a check mark shows. The HC40 and actuator system are now paired up.



Figure 1:

Pairing command

Pairing successful

The Demo mode is ended as soon as the actuator system and the HC40 are paired and connected. Up and down arrows are now visible on the screen surrounding the reference name, showing that the system can now run.



Figure 2:

HC40 not paired

HC40 paired

For customers pairing the HC40 to the actuator system on the production line when producing the bed, it is possible to pair the system already after the start-up logo is gone. No need to enter time and day before making the pairing procedure.

How to run references

The menu structure can contain up to four references: back, leg, neck and foot. Loop between the references using the 'left' and 'right' buttons. To run the references simply go to the screen with the reference and press the 'up' or 'down' arrow and the system runs in the requested direction.



Figure 3: Looping between references and up/down drive of them

Favourite positions

Save favourite positions

The HC40 allows for storing up to four favourite positions.

1. Drive the bed to the desired position.
2. Loop to the "SAVE FAVOURITE" screen using the 'left' and 'right' buttons.
3. When the screen is reached, press button 3 "SAVE".
4. Highlight one of the four favourite positions using the 'up' and 'down' buttons and press the 'select' button to save the position as the selected "FAVOURITE".
5. The saved "FAVOURITE" will now show in the main menu loop.



Figure 4: Step 3

Step 4

Step 5

As soon as all positions are saved, the "SAVE" option becomes hidden. It will be shown again as soon as one of the four saved positions is deleted.

From the screen with the favourite position, there are three options:

A. Drive to the favourite position

1. Press and hold button 3 "GO TO" or the 'select' button.



2. The system now drives towards the position while the name flashes in the display

B. Rename the favourite position (Not possible in Korean language)

1. Press button 2 "RENAME".
2. Use the 'left' and 'right' buttons to loop between the characters.
3. Press the 'select' button to choose a character and it shows in the blue bar.
4. Use button 1 "DELETE" to delete a character or button 2 "SPACE" to make a space between the characters.
5. When the desired name is typed in, press button 3 "SAVE" to save the new name.



C. Deleting a favourite position

1. Press button 1 "DELETE".
2. Confirm the deletion by pressing button 3 "YES".
3. The position is now deleted and removed from the general menu loop.

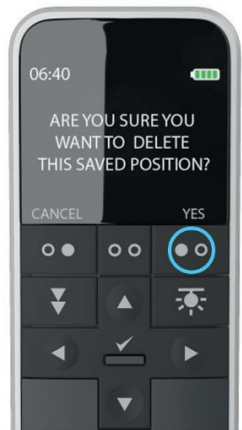

Message

Controlling message

The HC40 FRAME™ Advanced can control up to two message references. The two standard options are called "MESSAGE BACK" and "MESSAGE LEG".



Loop in the menu to find the message screens. From the message screen it is possible to:

- Set a timer
- Change message mode
- Turn on/off the message
- Adjust intensity

Setting a timer

1. Press button 1 "TIMER" to set a timer for the duration of the message session.
2. Use 'up' and 'down' buttons to adjust the minutes.
3. Press button 3 "SAVE" to save the duration and start the message.



Note: If the timer in the HC40 is set to a higher number than what is configured in the actuator system as timer, the message will stop according to the configuration in the actuator system.

Changing message mode

1. Press button 2 "MODE" to change message mode.
2. A green circle appears, and the message mode is now changed.
3. Repeat to toggle between more available modes.

Note: The number of message modes depends on the configuration in the actuator system.



Turning on/off the message

1. Use button 3 to turn on/off the message motor.

This action must be repeated for both screens "MESSAGE BACK" and "MESSAGE LEG" if both message options are to be turned on/off.



Adjusting intensity

1. Use the 'up' button to increase the message intensity.
2. Use the 'down' button to decrease the message intensity.



My bed menu

The "MY BED" menu is accessed by looping the menu with the 'left' or 'right' button, or via button 3 "MENU" on the main screen.

Once "MY BED" appears, press the 'select' button to access the "MY BED" menu.



The items in the "MY BED" menu depend on the number of features configured. The maximum list consists of the following items:

- ME
- ALARMS
- SLEEP TIMER (optional)
- SHORTCUTS
- TIME&DAY
- LANGUAGE
- CHILD LOCK
- TORCH
- ABOUT

About

The "ABOUT" section contains information about the product: the item number, the software number and version, and whether the control has been reconfigured. The item and software numbers also appear on the product label underneath the battery lid.

The about section contains the CE symbol and WEEE garbage can for approval reasons.



From the about section, it is possible to reset the hand control to default factory settings:

1. Press button 2 "RESET".
2. A warning pops up - confirm the request by pressing button 3 "YES".
3. The hand control is now reset meaning that every setting changed after receiving the hand control has been restored to the default factory settings. The settings affected by the reset are: favourite positions, my name, shortcuts, time and time format, day, alarms, child lock, language and any timers.



Figure 5:

Step 1: Reset

Step 2: Confirm

Step 3: Back to factory settings

Me

In the "ME" section it is possible to enter a name. By entering a name, the notifications get personalised, meaning "HAVE A NICE DAY" is now followed by the entered name.

1. Highlight the "ME" bar in the "MY BED" menu and press the 'select' button.
2. Press button 3 "EDIT" to enter a name.
 - 2.1. Use the 'left' and 'right' buttons to loop between the characters.
 - 2.2. Press the 'select' button to select a character.
 - 2.3. Press button 1 "DELETE" to delete a character or button 2 "SPACE" to make a space between the characters.
3. When the desired name is typed in, press button 3 "SAVE" to save the name.



Alarms

The alarm menu is accessible for systems including massage. When the alarm goes off, the massage motors start, providing a soundless wake-up.

Highlight the "ALARMS" bar in the "MY BED" menu and press the 'select' button to access the alarm menu, which contains three alarms.

1. Press the 'select' button to enable the alarm. The icon changes to green.
2. Press button 2 "EDIT" to change the alarm.
3. To disable an alarm, simply highlight the alarm and press the 'select' button. The icon changes to white/grey.



When the alarm goes off, the massage motors start in the latest used mode and the HC40 screen shows a bell.

- a. Press button 1 "SNOOZE" to snooze the alarm for 9 minutes.
- b. Press button 3 "STOP" to stop the alarm.

When the alarm is stopped, it is disabled, and the user has to go to the alarm menu to enable the alarm again for the next wake-up.



Sleep timer

The sleep timer functionality is a timer for the bed to return to flat position or a predefined favourite position, e.g. a sleeping position with the head a little raised. A typical use scenario could be a user wanting to fall asleep watching TV. He has the back of the bed raised and he sets the timer to 30 minutes on the HC40. When the timer elapses, the bed drives to flat position and he can sleep in a comfortable position.



The sleep timer functionality requires impulse drive enabled.

Highlight the "SLEEP TIMER" bar in the "MY BED" menu and press the 'select' button to access the sleep timer.

1. Use the 'up' and 'down' buttons to adjust the time.
2. Press button 3 "START" to start the timer.

A 'moon' icon is now shown next to the time to indicate that the sleep timer is on.



Cancelling/stopping the sleep timer

1. Access the "SLEEP TIMER".
2. Press button 3 "CANCEL" to stop the timer.



Shortcuts

It is possible to set shortcuts on the HC40. The shortcuts are meant for the user to put in his/her most used features, so they are only one click away from the main screen. This way the hand control can be personalised to the needs of the individual user.

The shortcut buttons are the top row of buttons referring to the text in the display.

Setting the shortcuts

Highlight the "SHORTCUTS" bar in the "MY BED" menu and press the 'select' button to access.

1. Highlight the bar with the wanted shortcut and press the 'select' button or button 2 "EDIT".
2. Highlight one of the options:
 - NONE (to remove a programmed shortcut)
 - ALARMS
 - FAVOURITE (saved favourite positions)
 - SLEEP TIMER (configurable)
 - TORCH
 - MY BED
 - CHILD LOCK
 - ABOUT
3. Press the 'select' button to choose the highlighted option.

A notification confirms the shortcut is saved.



The shortcut is now visible on the main screen and accessible in one click.

Time & Day

It is possible to adjust the time set during set-up of the hand control in the "TIME&DAY" menu in the "MY BED" menu.

1. Highlight the "TIME&DAY" bar in the "MY BED" menu and press the 'select' button to access.
2. Set the time:
 - 2.1. Highlight the "TIME" bar and press the 'select' button or button 2 "EDIT".
 - 2.2. Use the 'up' and 'down' buttons to adjust the time. Press button 1 to switch between 24H and AM/PM.
 - 2.3. Press the 'select' button or button 3 "SAVE" to save the time.



3. Set the day:
 - 3.1. Highlight the "DAY" bar and press the 'select' button or button 2 "EDIT".
 - 3.2. Use the 'left' and 'right' buttons to scroll to the actual day of the week.
 - 3.3. Press the 'select' button or button 3 "SAVE" to save the day.



Language

The HC40 comes in seven different languages: English (British), French, Spanish, German, Swedish, Danish and Korean.

1. Highlight the "LANGUAGE" bar in the "MY BED" menu and press the 'select' button to access the menu.
2. Use the 'up' and 'down' buttons to scroll through the languages.
3. Highlight the desired language and press the 'select' button.

A notification tells the user that the language is being set.



Child lock

It is possible to set a child lock on the HC40, meaning a specific button combination must be pressed to unlock the hand control before it is possible to run the bed.

Enabling the child lock

1. Highlight the "CHILD LOCK" bar in the "MY BED" menu
2. Press the 'select' button and a notification shows.
3. Press the 'select' button or button 3 "OK" to activate child lock.
4. The icon changes to green to indicate that child lock is enabled.



Unlocking the hand control

Child lock enabled is illustrated by a 'lock' icon at the top of the screen saver.

1. To unlock, press and hold at the same time the 'left' and 'right' buttons for 3 seconds until the main screen shows.

A guide explaining this procedure pops up at any press on a button from the locked screen saver.



Torch

On the backside of the hand control is a torch.

Turning the torch on/off

1. Highlight the "TORCH" bar in the "MY BED" menu.
2. Press the 'select' button to enable the torch.
3. The first five times a tip on how to turn on/off the torch by shaking the hand control shows. Press the 'select' button or button 3 "OK". The icon changes to green and torch is now on.



The torch can also be turned on directly from any screen. Simply shake the hand control sideways twice. To turn it off, simply shake the hand control twice again.



Notifications

The HC40 sends notifications to the user to give a personal experience. When a name is typed in, the notification will adapt to that.

The standard notification "HAVE A NICE DAY [name]" appears when the hand control is picked up in the time slot from 05.00 to 11.00 every third Saturday.

The standard notification "GOOD MORNING [name]" appears when the hand control is picked up in the time slot from 05.00 to 09.00 every second Wednesday.

The HC40 also shows other notifications to the user e.g. about how to pair if the HC40 is not connected to the bed, or if the battery has reached a low level.



Figure 6: Examples of notifications

Disposal of LINAK's products

As LINAK's customers often ask us how our products can be disposed of or scrapped we have prepared this guidance that enables a classification to different waste fractions for recycling or combustion.

Guidance

We recommend that our products be disassembled as much as possible and divided into different waste groups for recycling or combustion.

For example, waste can be sorted into metals, plastics, cable scrap, combustible material and recoverable resources.

Some of these main groups can be further divided into subgroups; e.g. metal can be divided into steel/aluminium/copper and plastic can be divided into ABS/PA/PE/PP.

As an example, the table below breaks down the different components in LINAK products to various recycling groups:

Product	Components	Recycling group
Column/ Actuator :	Spindle and motor Plastic housing Cable PC boards	Metal scrap Plastic recycling or combustion Cable scrap or combustion Electronics scrap
Control Box :	PC boards Plastic housing Cable Transformer	Electronics scrap Plastic recycling or combustion Cable scrap or combustion Metal scrap
Handset/Control :	Plastic housing Cable PC boards	Plastic recycling or combustion Cable scrap or combustion Electronics scrap

By now, almost all our casted plastic parts are supplied with an interior code for plastic types and fibre contents, if any.

Main groups of disposal

Product main groups	Metal scrap	Cable scrap	Electronics scrap	Plastic recycling or combustion	Comments
HC40 FRAME™ Advanced	X		X	X	
HC40 TWIST™ Advanced	X		X	X	

Disposal of batteries

"Details regarding safe disposal of used and leaking batteries:

Batteries should be disposed in accordance with appropriate federal, state and local regulations. LINAK recommends that used or leaking batteries are disposed through local recycling system. Please do not throw used or leaking batteries in normal household waste or in nature. This will cause damage to the environment.

How to deal with leaking batteries

Leaking batteries should be disposed as described above.

If leaking batteries are discovered in the product, the batteries must be removed at once to minimise damage to the product. If leaking batteries are left in the product, it become defective.

It is recommended to use plastic gloves when handling leaking batteries. The contents of a leaking batteries can cause chemical burns and respiratory irritation.

If exposed to the contents of a leaking battery, please wash with soap and water. If irritation persists, please seek medical attention. In case of eye contact, please flush eyes thoroughly with water for 15 minutes and seek medical attention."

Labels

Label for HC40 FRAME™ Advanced



Label for HC40 TWIST™ Advanced

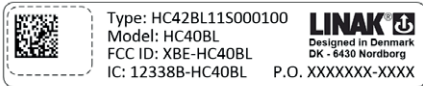

LINAK APPLICATION POLICY

The purpose of the application policy is to define areas of responsibilities in relation to applying a LINAK product defined as hardware, software, technical advice, etc. related to an existing or new customer application.

LINAK products as defined above are applicable for a wide range of applications within the Medical, Furniture, Desk and Industry areas. Yet, LINAK cannot know all the conditions under which LINAK products will be installed, used, and operated, as each individual application is unique.

The suitability and functionality of the LINAK product and its performance under varying conditions (application, vibration, load, humidity, temperature, frequency, etc.) can only be verified by testing, and shall ultimately be the responsibility of the LINAK customer using any LINAK product.

LINAK shall be responsible solely that the LINAK products comply with the specifications set out by LINAK and it shall be the responsibility of the LINAK customer to ensure that the specific LINAK product can be used for the application in question.

DRAWING APPENDIX

HC40 FRAME™ Advanced

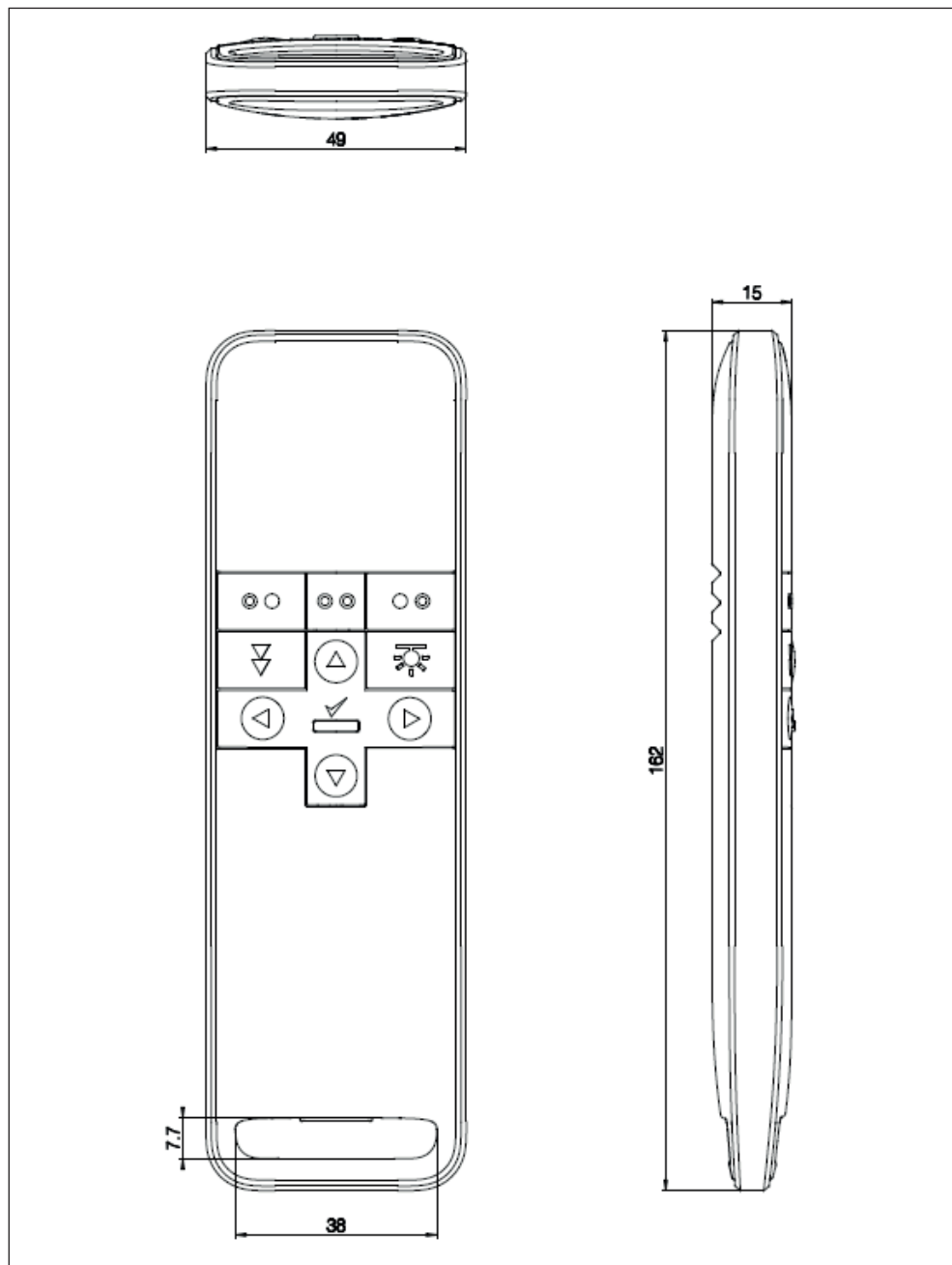

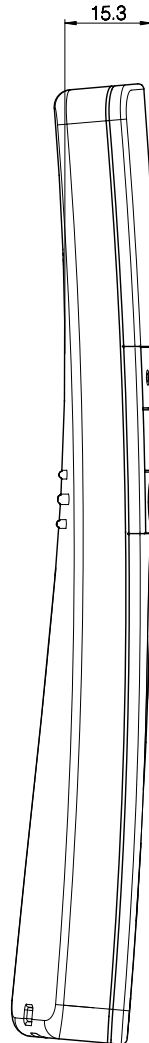
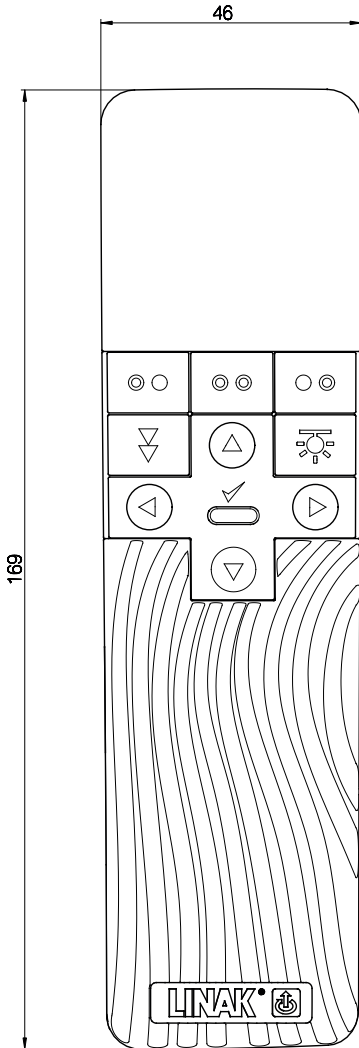
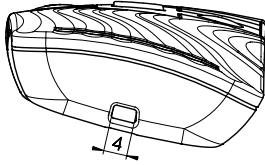

FACTORIES

China

LINAK (Shenzhen) Actuator Systems, Ltd.
Phone: +86 755 8610 6656
Phone: +86 755 8610 6990
E-mail: sales@linak.cn
www.linak.cn

Denmark - Headquarters

LINAK A/S - Group Headquarters

Phone: +45 73 15 15 15
Fax: +45 74 45 80 48
Fax (Sales): +45 73 15 16 13
E-mail: info@linak.com
www.linak.com

USA

LINAK U.S. Inc.

North and South American Headquarters
Phone: +1 502 253 5595
Fax: +1 502 253 5596
E-mail: info@linak-us.com
www.linak-us.com

SUBSIDIARIES

Australia

LINAK Australia Pty. Ltd.
Phone: +61 3 8796 9777
Fax: +61 3 8796 9778
E-mail: sales@linak.com.au
www.linak.com.au

Austria

LINAK Repräsentanz - Österreich (Wien)
Phone: +43 (1) 890 7446
Fax: +43 (1) 890 744615
E-mail: info@linak.de
www.linak.at

Belgium

LINAK Actuator-Systems NV/SA
(Belgium & Luxembourg)
Phone: +32 (0)9 230 80 19
Fax: +32 (0)9 230 88 80
E-mail: beinfo@linak.be
www.linak.be - www.fr.linak.be

Brazil

LINAK DO BRASIL COMÉRCIO DE
ATUADORES LTDA.
Phone: +55 (11) 2832 - 7070
Fax: +55 (11) 2832 - 7060
E-mail: info@linak.com.br
www.linak.com.br

Canada

LINAK Canada Inc.
Phone: +1 502 253 5595
Fax: +1 416-255-7720
E-mail: info@linak.ca
www.linak-us.com

Czech Republic

LINAK C&S S.R.O.
Phone: +420581741814
Fax: +420581702452
E-mail: info@linak.cz
www.linak.cz

Terms of use

The user is responsible for determining the suitability of LINAK products for specific application. LINAK takes great care in providing accurate and up-to-date information on its products.

However, due to continuous development in order to improve its products, LINAK products are subject to frequent modifications and changes without prior notice. Therefore, LINAK cannot guarantee the correct and actual status of said information on its products.

While LINAK uses its best efforts to fulfil orders, LINAK cannot, for the same reasons as mentioned above, guarantee the availability of any particular product. Therefore, LINAK reserves the right to discontinue the sale of any product displayed on its website or listed in its catalogues or other written material drawn up by LINAK.

All sales are subject to the Standard Terms of Sale and Delivery for LINAK. For a copy hereof, please contact LINAK.

Denmark - International

LINAK International
Phone: +45 73 15 15 15
E-mail: info@linak.com
www.linak.com

Denmark - Sales

LINAK DANMARK A/S
Phone: +45 86 80 36 11
Fax: +45 86 82 90 51
E-mail: linak@linak-silkeborg.dk
www.linak.dk

Finland

LINAK OY
Phone: +358 10 841 8700
E-mail: linak@linak.fi
www.linak.fi

France

LINAK FRANCE E.U.R.L
Phone: +33 (0) 2 41 36 34 34
Fax: +33 (0) 2 41 36 35 00
E-mail: linak@linak.fr
www.linak.fr

Germany

LINAK GmbH
Phone: +49 6043 9655 0
Fax: +49 6043 9655 60
E-mail: info@linak.de
www.linak.de

India

LINAK A/S India Liaison Office
Phone: +91 120 4531797
Fax: +91 120 4786428
E-mail: info@linak.in
www.linak.in

Ireland

LINAK UK Limited (Ireland)
Phone: +44 (0)121 544 2211
Fax: +44 (0)121 544 2552
+44 (0)796 855 1606 (UK Mobile)
+35 387 634 6554 (Republic Of
Ireland Mobile)

E-mail: sales@linak.co.uk
www.linak.ie

Italy

LINAK ITALIA S.r.l.
Phone: +39 02 48 46 33 66
Fax: +39 02 48 46 82 52
E-mail: info@linak.it
www.linak.it

Japan

LINAK K.K.
Phone: 81-45-533-0802
Fax: 81-45-533-0803
E-mail: linak@linak.jp
www.linak.jp

Malaysia

LINAK Actuators Sdn. Bhd.
Phone: +60 4 210 6500
Fax: +60 4 226 8901
E-mail: info@linak-asia.com
www.linak.my - www.linak.co.id
www.linak.pk - www.linak.ph

Netherlands

LINAK Actuator-Systems B.V.
Phone: +31 76 5 42 44 40 /
+31 76 2 00 11 10
E-mail: info@linak.nl
www.linak.nl

New Zealand

LINAK New Zealand Ltd
Phone: +64 9580 2071
Fax: +64 9580 2072
E-mail: nzsales@linak.com.au
www.linak.com.au

Norway

LINAK Norge AS
Phone: +47 32 82 90 90
E-mail: info@linak.no
www.linak.no

Poland

LINAK Polska
LINAK Danmark A/S (Spółka Akcyjna)
Phone: +48 22 295 09 70 /
+48 22 295 09 71
E-mail: info@linak.pl
www.linak.pl

Republic of Korea

LINAK Korea Ltd.
Phone: +82 2 6231 1515
Fax: +82 2 6231 1516
E-mail: info@linak.kr
www.linak.kr

Russia

LINAK LLC
Phone: +7 495 780 31 61
Fax: +7 495 687 14 26
E-mail: info@linak.ru
www.linak.ru

Spain

LINAK Actuadores, S.L.U
Phone: +34 93 588 27 77
Fax: +34 93 588 27 85
E-mail: esma@linak.es
www.linak.es

Sweden

LINAK Scandinavia AB
Phone: +46 8 732 20 00
Fax: +46 8 732 20 50
E-mail: info@linak.se
www.linak.se

Switzerland

LINAK AG
Phone: +41 43 388 31 88
Fax: +41 43 388 31 87
E-mail: info@linak.ch
www.linak.ch - www.fr.linak.ch
www.it.linak.ch

Taiwan

LINAK (Shenzhen) Actuator systems Ltd.
Taiwan Representative office
Phone: +886 2 27290068
Fax: +886 2 27290096
E-mail: sales@linak.com.tw
www.linak.tw

Turkey

LINAK İth. İhr. San. ve Tic. A.Ş.
Phone: +90 312 4726338
Fax: +90 312 4726635
E-mail: info@linak.com.tr
www.linak.com.tr

United Kingdom

LINAK UK Limited
Phone: +44 (0)121 544 2211
Fax: +44 (0)121 544 2552
E-mail: sales@linak.co.uk
www.linak.co.uk

DISTRIBUTORS

Argentina

NOVOTEC ARGENTINA SRL
Phone: 011-4303-8989 / 8900
Fax: 011-4032-0184
E-mail: info@novotecargentina.com
www.novotecargentina.com

Colombia

MEM Ltda
Phone: +[57] (1) 334-7666
Fax: +[57] (1) 282-1684
E-mail: servicioalcliente@memltda.com.co
www.mem.net.co

India

Mechatronics Control Equipments India Pvt Ltd
Phone: +91-44-28558484, 85
E-mail: bala@mechatronicscontrol.com
www.mechatronicscontrol.com

Indonesia

PT. HIMALAYA EVEREST JAYA
Phone: +6 221 544 8956, +6 221 544 8965
Fax: +6 221 619 1925
Fax (Sales): +6 221 619 4658
E-mail: hejplastic-div@centrin.net.id
www.hej.co.id

Israel

NetivTech LTD
Phone: +972 55-2266-535
Fax: +972 2-9900-560
Email: info@NetivTech.com
www.netivtech.com

Russia

OOD FAM
Phone: +7 812 3319333
Fax: +7 812 3271454
E-mail: purchase@fam-drive.ru
www.fam-drive.ru

Singapore

Servo Dynamics Pte Ltd
Phone: +65 6844 0288
Fax: +65 6844 0070
E-mail: servodynamics@servo.com.sg

South Africa

Industrial Specialised Applications CC
Phone: +27 011 466 0346
E-mail: garth@isagroup.co.za
www.isaza.co.za

United Arab Emirates

Mechatronics
Phone: +971 4 267 4311
Fax: +971 4 267 4312
E-mail: mechtron@emirates.net.ae



WE IMPROVE YOUR LIFE