



Diaper Sensor



Diaper Sensor

1. Includes



Diaper Sensor

2. Installing Abellstar App



Search 'abellstar' in Google Play Store

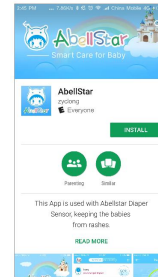

Search 'abellstar' in Apple App Store

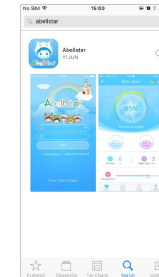

Diaper Sensor

3. Registration

You can register with [Email Address](#) and [Phone Number](#).

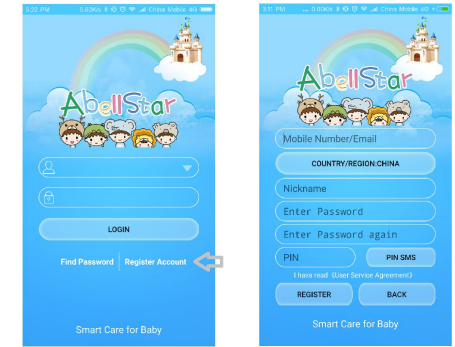

Note: Country/region code is needed if you register with Phone number



Diaper Sensor

4. Installing Batteries

Open the Diaper Sensor with a screwdriver :

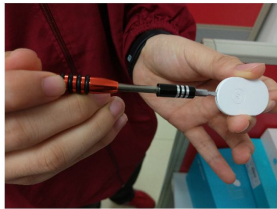

Install one piece of C2025 battery :



Diaper Sensor

5. Add a new device

Step 1. Power on the Diaper Sensor

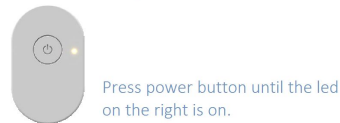

Step 2. Scan Diaper Sensors nearby

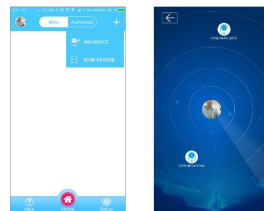

Step 3. Select your sensor according to the mac address



Diaper Sensor

6. My Device and Authorized

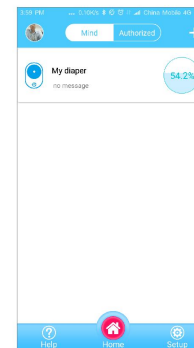

Mind: You are the manager of the device. You have the right to authorize it to other people. Authorized: You are authorized to use the device by the device's manager.



Diaper Sensor

7. To get an authorized Diaper Sensor

Step 1. Ask the Diaper Sensor's manager (owner) for help to share the Device QR code

Long press the sensor, go to the Authorization page.

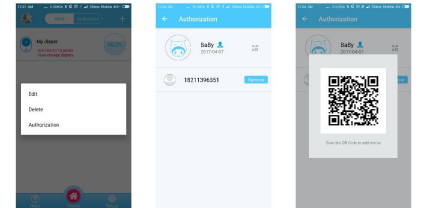

Step 2. Scan the QR code in your app

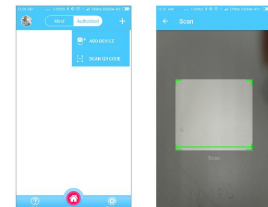

8. Diaper Sensing Mode

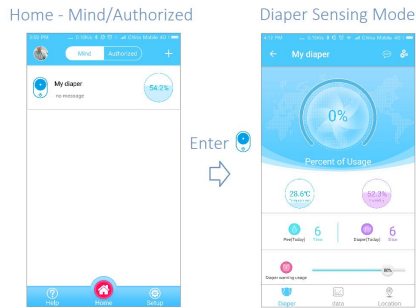

- 0%** illustrates how full the diaper is
- 28.6°C** Current temperature of the diaper's outer surface
- 52.3%** Current humidity of the diaper's outer surface
- 6** Pee today
- 6** Diaper used today
- Diaper Change Reminder threshold: When Percent of Usage beyond this value, app will receive a warning.

9. History Data of the Diaper Sensor

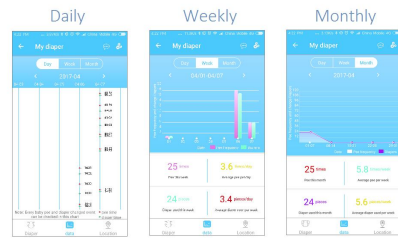
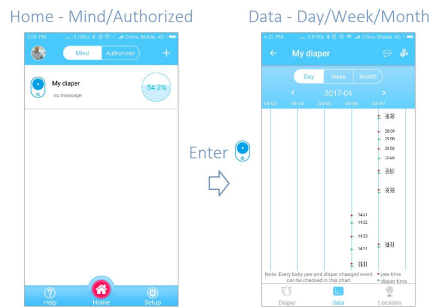

10. Location Mode

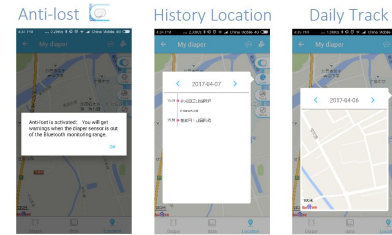
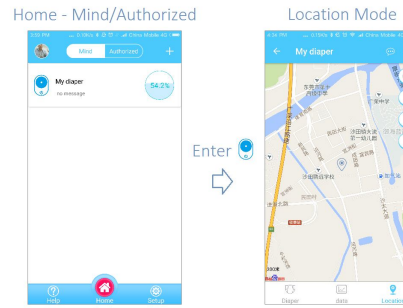

11. Message Box of the Diaper Sensor

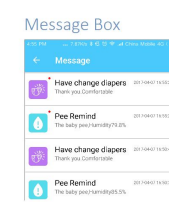
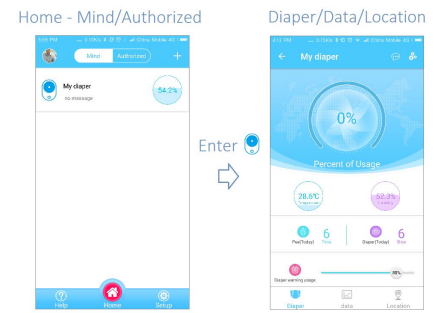

12. Mounting onto the diaper

Put the Diaper Sensor into the Diaper Band

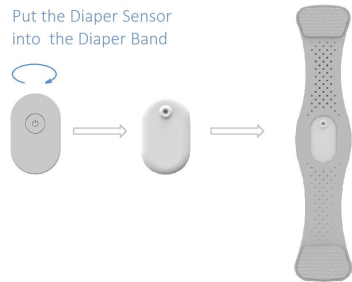

Put the Sensor on the bottom of the diaper, sticking the Velcro onto the outer surface.



FCC STATEMENT

- This device complies with Part 15 of the FCC Rules. Operation is subject to the following two conditions:
 - This device may not cause harmful interference, and
 - This device must accept any interference received, including interference that may cause undesired operation.
- Changes or modifications not expressly approved by the party responsible for compliance could void the user's authority to operate the equipment.

NOTE: This equipment has been tested and found to comply with the limits for a Class B digital device, pursuant to Part 15 of the FCC Rules. These limits are designed to provide reasonable protection against harmful interference in a residential installation.

This equipment generates uses and can radiate radio frequency energy and, if not installed and used in accordance with the instructions, may cause harmful interference to radio communications. However, there is no guarantee that interference will not occur in a particular installation. If this equipment does cause harmful interference to radio or television reception, which can be determined by turning the equipment off and on, the user is encouraged to try to correct the interference by one or more of the following measures:
Reorient or relocate the receiving antenna.
Increase the separation between the equipment and receiver.
Connect the equipment into an outlet on a circuit different from that to which the receiver is connected.
Consult the dealer or an experienced radio/TV technician for help.

RG warning statement:
The device has been evaluated to meet general RF exposure requirement. The device can be used in portable exposure condition without restriction.

Abellstar™
3 Chengtian Road, Mintian, Shatian Town,
Dongguan, Guangdong Province, China

"Abellstar" is trademark of
Dongguan Southstar Electronics Ltd.



Back view



Perspective view