

AFTERGLOW® WIRELESS HEADSET

SET UP: PLAYSTATION® 3

CONNECTED WITH COMPONENT/COMPOSITE CABLE*

*Cable comes with the PS3® console.

1. Plug the Afterglow® USB transmitter into one of the USB ports of the PS3® console .
2. Unplug the RCA cable (Red/White only) that runs from your console to the TV.
3. Plug the RCA cable (Red/White) that is attached to the Afterglow® USB transmitter into the TV.
4. Re-plug the RCA cable from the console into the pass-through ports of the Afterglow RCA cable that is now plugged into the TV.
5. Leave the PlayStation® 3 component/composite video plugs connected to the TV.

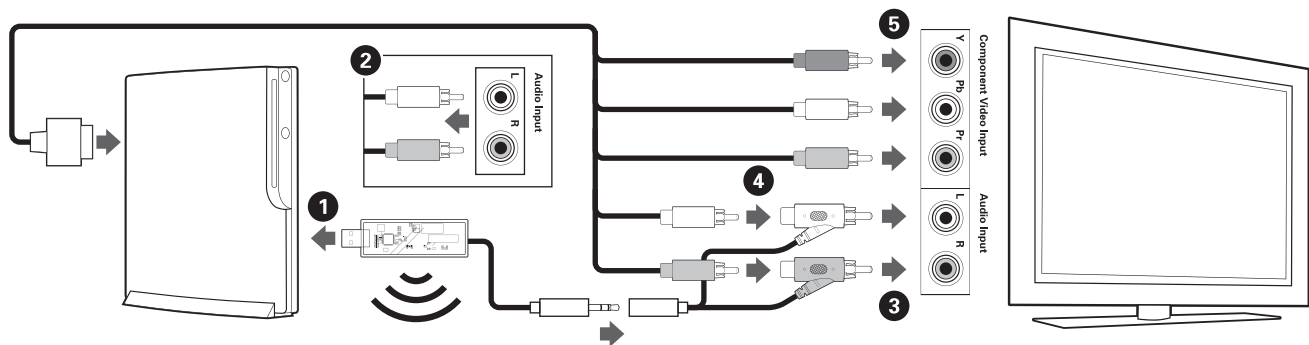

6. Turn the console and headset power ON.

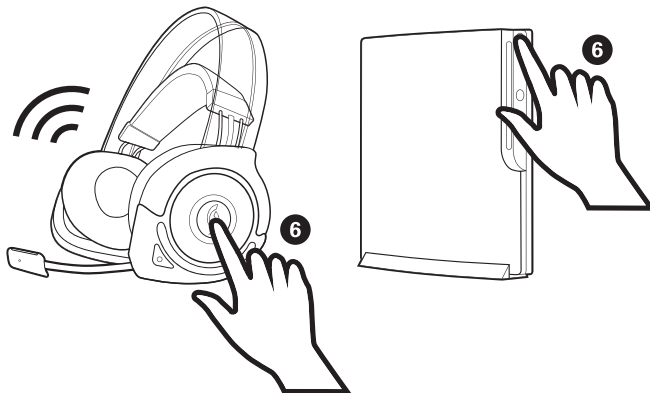

SET UP: PLAYSTATION® 3

CONNECTED WITH HDMI*

*HDMI cable not included.

1. Plug the Afterglow® USB transmitter into one of the USB ports of the PS3® console .
2. Unplug the RCA cable (Red/White only) that runs from your console to the TV.
3. Plug the RCA cable (Red/White) that is attached to the Afterglow USB transmitter into the TV.
4. Re-plug the RCA cable from the console into the pass-through of the Afterglow® RCA cable that is now plugged into the TV.

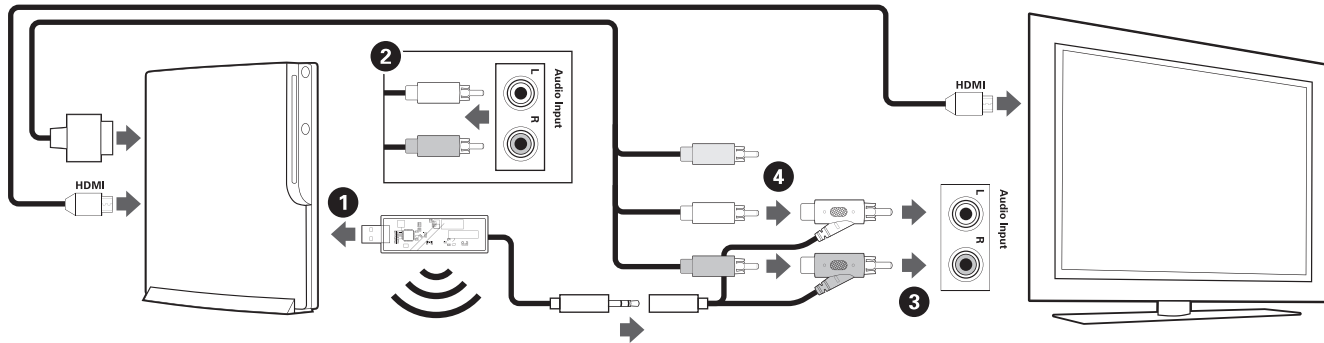

5. Turn the console and headset power ON.

Then in your Playstation XMB menu:

1. Go to Settings
2. Select "Sound Settings"
3. Select "Audio Output Settings"
4. Select the audio out as "Audio Input Connector"
5. Press X – Enter

Note: If you want the game audio to come from the headset and the TV simultaneously:

1. Go to Settings
2. Select "Sound Settings"
3. Audio Multi-Out: Turn it ON

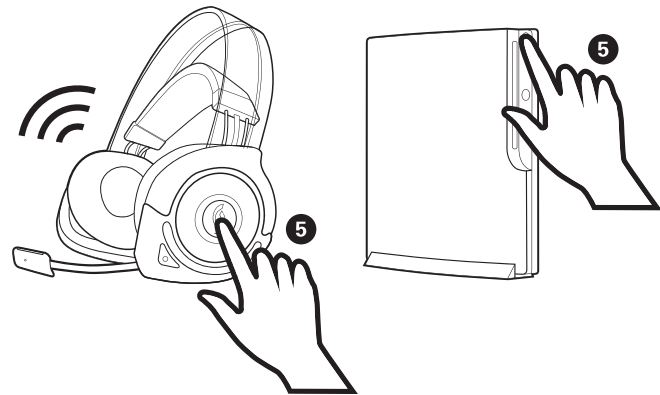

If you have lost your PS3 composite cable, contact PDP customer service at 1-800-331-3844 or go to <http://www.afterglowgaming.com/PS3AVcable>
The cable and shipping (priority 2-day) is free.