

Auto-Ki Smart Hub

Wireless Smart Hub Installation Instructions

For use only with the following garage door operators:

ATS-2AM & GDO-12AM

Conçu pour être utilisé uniquement avec les ouvre portes de garage suivants : ATS-2AM et GDO-12AM

AUTO-KI SMART HUB KIT - ORDER NO. 87480		
ITEM	DESCRIPTION	QTY
1	WIRELESS HUB200 WT B&D	1
2	POWER SUPPLY AU 240V	1
3	WALL BRACKET HUB100	1
4	PLASTIC WALL PLUG 6.9 X 25	2
5	SELF TAPPING SCREW 6 X 25	2

AUTO-KI SMART MODULE FOR HIRO NTR-1V1AM - ORDER NO. 14817		
ITEM	DESCRIPTION	QTY
6	NETWORK TRANSCEIVER NTR-1V1 AY	1

AUTO-KI SMART MODULE FOR TEMPO NTR-2V1AM - ORDER NO. 87463		
ITEM	DESCRIPTION	QTY
7	NETWORK TRANSCEIVER NTR-2V1 AY	1
8	TIMING HARNESS 400MM VR12 AY	1

CLASS B DEVICE

CAN ICES-3 (B)/NMB-3 (B)

This equipment has been tested and found to comply with the limits for a Class B digital device, pursuant to Part 15 of the FCC Rules. These limits are designed to provide reasonable protection against harmful interference in a residential installation. This equipment generates, uses and can radiate radio frequency energy and, if not installed and used in accordance with the instructions, may cause harmful interference to radio communications. However, there is no guarantee that interference will not occur in a particular installation. If this equipment does cause harmful interference to radio or television reception, which can be determined by turning the equipment off and on, the user is encouraged to try to correct the interference by one or more of the following measures:

- Reorient or relocate the receiving antenna
- Increase the separation between the equipment and receiver
- Connect the equipment into an outlet on a circuit different from that to which the receiver is connected.
- Consult the dealer or experienced radio/TV technician for help.

To comply with FCC/IC RF exposure limits for general population / uncontrolled exposure, the antenna(s) used for this transmitter must be installed to provide a separation distance of at least 7.87in (20cm) from all persons and must not be co-located or operating in conjunction with any other antenna or transmitter.



WARNING!

Changes or modifications not expressly approved by the party responsible for compliance could void the user's authority to operate the equipment.

This network device allows for unattended operation of the door when not in line-of-sight of the door opener.

The door may operate unexpectedly, therefore do not allow anything to stay in or near the path of the door. When the door is not operating automatically, watch the door when it is moving and keep people away until the door is completely opened or closed. **Contact with the moving door can cause serious personal injury or damage to property.**

Your opener must be fitted with **SAFETY BEAMS**. Safety Beams detect any obstructions in the door's path and override automatic operation if one presents. These must be installed as in accordance with UL 325 and CSA C222.2 No 247.

This is in addition to regular professional servicing, and monthly obstruction tests as detailed in your opener's Owners Manual.

The compliance to FCC radiation exposure limits for an uncontrolled environment, and a minimum of 20cm separation between antenna and body.

This device complies with part 15 of the FCC Rules. Operation is subject to the following two conditions: (1) This device may not cause harmful interference, and (2) this device must accept any interference received, including interference that may cause undesired operation.



AVERTISSEMENT!

Tout changement ou toute modification non expressément approuvée par la partie responsable de la conformité est susceptible d'annuler le droit de l'utilisateur d'utiliser l'équipement.

La télécommande radio permet d'actionner la porte lorsque l'utilisateur est hors de la ligne de vue de la porte et de l'appareil.

En conséquence, la porte risque de s'ouvrir ou se fermer inopinément et vous devez éviter de laisser des objets sur sa course ou à proximité. Lorsque la porte ne fonctionne pas automatiquement, surveillez-la lorsqu'elle bouge et éloignez toute personne jusqu'à ce qu'elle soit complètement ouverte ou fermée. **Le contact avec la porte en mouvement peut provoquer des blessures graves ou des dommages matériels.**

Votre ouvre-porte doit être équipé de **FAISCEAUX DE SÉCURITÉ**. Les faisceaux de sécurité détectent tout obstacle sur le trajet de la porte et annulent alors le fonctionnement automatique. Ceux-ci doivent être installés conformément aux normes UL 325 et CSA C222.2 N° 247. Ceci s'ajoute à l'entretien professionnel régulier et aux tests d'obstruction mensuels détaillés dans le mode d'emploi de votre ouvre-porte.

Conformité aux limites d'exposition aux rayonnements FCC pour un environnement non contrôlé, et distance minimale de 20 cm entre l'antenne et le corps.

Ce dispositif est conforme à la partie 15 des règles de la Federal Communications Commission (FCC). Son fonctionnement est assujéti aux deux conditions suivantes: (1) Ce dispositif ne doit pas provoquer de brouillage préjudiciable, et (2) il doit accepter tout brouillage reçu, y compris le brouillage pouvant entraîner un mauvais fonctionnement.

Important Safety Instructions



WARNING!

- **DO NOT** attempt to disassemble, repair or modify the product. This will invalidate the warranty.
- Do not allow children to play with the Base Station or your smart phone if the ATA phone app has been installed.



AVERTISSEMENT!

- NE tentez PAS de démonter, réparer ou modifier le produit. La garantie ne serait plus valide.
- Empêchez les enfants de jouer avec la station de base ou votre smartphone si l'application de téléphone ATA a été installée.



ELECTROCUTION!

- Keep the device away from water and other liquids. In the event that water or other liquids enter the device, power off the product immediately and clean the device.
- To reduce the risk of fire or electric shock, do not expose this device to rain or moisture. The device should not be exposed to dripping or splashing.
- **DO NOT** remove the cover as there are no user-serviceable parts inside.



ELECTROCUTION!

- Éloignez l'équipement de l'eau et d'autres liquides. Si de l'eau ou un autre liquide pénètre dans l'équipement, débranchez aussitôt le produit et nettoyez-le.
- Pour limiter les risques d'incendie ou de choc électrique, protégez cet équipement de la pluie ou de l'humidité. L'équipement ne doit jamais être exposé à des fuites ou des éclaboussures.
- NE retirez PAS le couvercle car il n'y a pas de pièces réparables par l'utilisateur à l'intérieur.



CAUTION!

- Ensure ladder is the correct type for job and is on flat ground. We recommend the user has 3 points of contact while on ladder.



PRUDENCE

- Utilisez un escabeau adéquat et stable. Lorsque l'utilisateur se tient sur un escabeau, il est conseillé de veiller à ce que les points de contact soient au nombre de trois.

This device contains licence-exempt transmitter(s)/receiver(s) that comply with Innovation, Science and Economic Development Canada's licence-exempt RSS(s). Operation is subject to the following two conditions:

- 1. This device may not cause interference.***
- 2. This device must accept any interference, including interference that may cause undesired operation of the device.***

L'émetteur/récepteur exempt de licence contenu dans le présent appareil est conforme aux CNR d'Innovation, Sciences et Développement économique Canada applicables aux appareils radio exempts de licence.

L'exploitation est autorisée aux deux conditions suivantes :

- 1. L'appareil ne doit pas produire de brouillage;***
- 2. L'appareil doit accepter tout brouillage radioélectrique subi, même si le brouillage est susceptible d'en compromettre le fonctionnement.***

Installation

Before going out to site, check the following with the customer:

- The customer has a Smart Phone: Android (running 4.4 and above) or iPhone (running iOS8 and above)
- An internet connection for remote operation is available.
- A 2.4ghz WiFi network is set up.
- We recommend the customer has a WPA2 encryption on the WiFi network as other network types are not as secure.

Mounting the Hub

- Determine whether you are going to wall mount the hub.
 - If hub is to be placed on bench, simply connect to power supply, turn on and proceed to installing the Transceiver.
 - If hub is to be wall mounted follow steps below.
- To wall mount - Use wall bracket (3) as template to mark where to drill holes. Pre-drill holes.
 - For plaster walls - insert (2) two Plastic wall plugs (4) into holes, place wall bracket over holes and affix with (2) two self tapping screws (5).
 - For brick walls - place wall bracket (3) over holes and affix with (2) two self tapping screws (5).
- Slide the hub (1) over the bracket.
- Connect the power supply and turn on.

This device must be connected to power at all times. DO NOT disconnect power after setup.

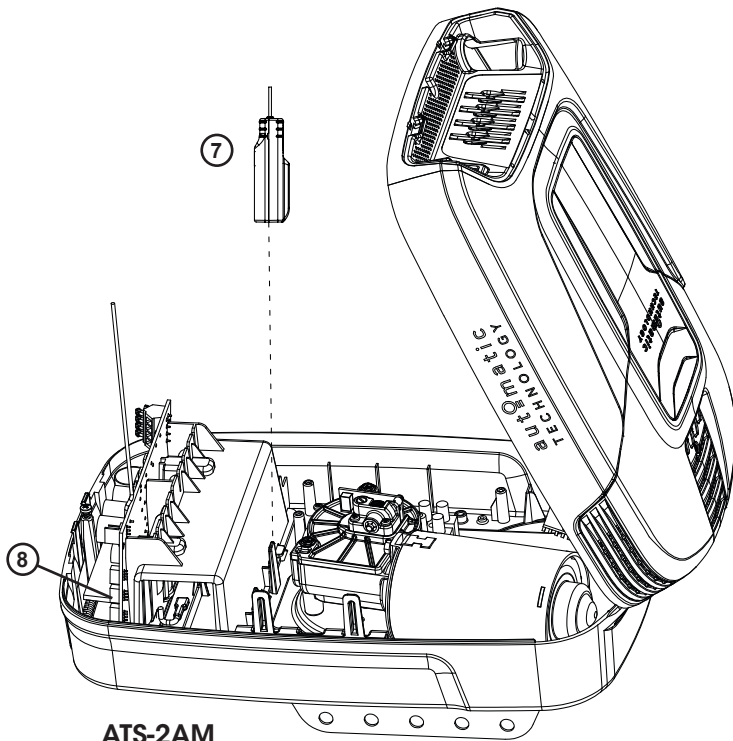
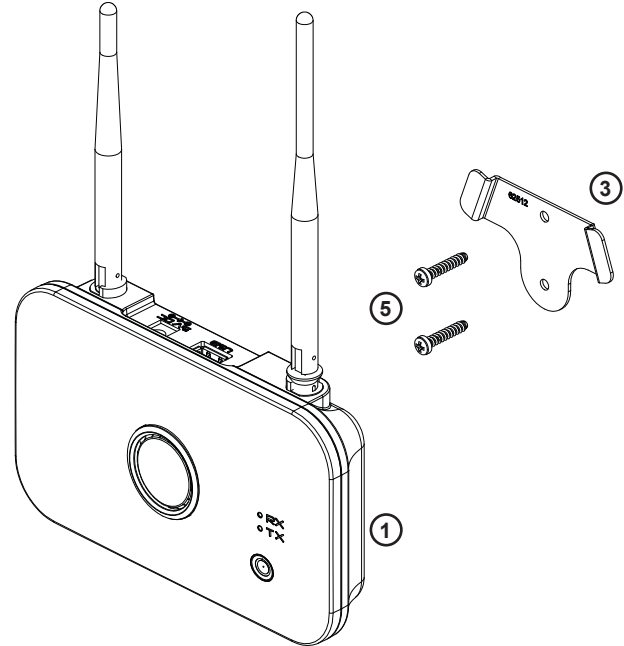

Mounting the Transceiver to the Operator

Follow the below steps for the particular operator installed.

Hiro GDO-12AM:

- The Auto-Ki Smart module (6) is preinstalled in the unit.
- Locate the registration card that came with the unit or contact technical support on 800 934 9892.
- Download the ATA App and follow the instructions in the App to setup new smart hub.

Tempo ATS-2AM:

- Disconnect the power supply to the operator and open the main cover.
- Connect the harness (8) to ACC on the control board, before attaching to the Auto-Ki Smart module (7) as shown.
- Close cover.
- Download the ATA App and follow the instructions in the App to setup new smart hub.
- Use a programmed remote and run the door through a few cycles which will update the unit with the details of the transceiver module.

Warranty

WARRANTY PERIOD	
ACCESSORIES	1 Year

This Warranty is to be read in conjunction with the owner's copy of the operator installation instruction

