

● PACKAGE CONTENTS

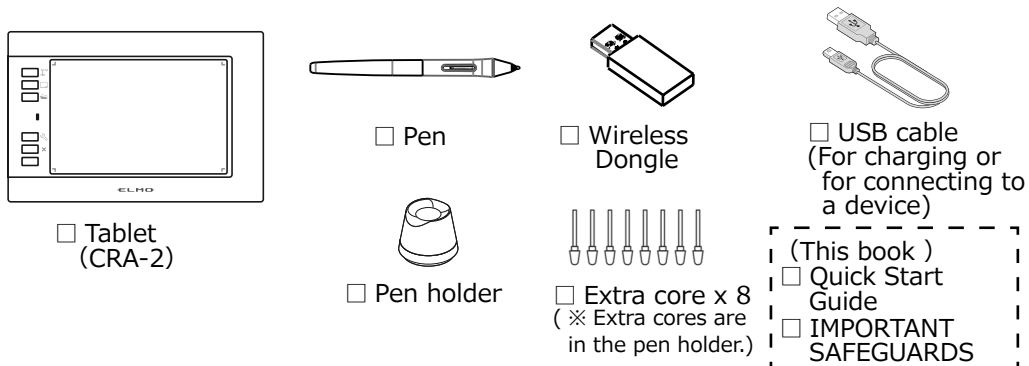

● PREPARATION

● Charging

Connect the tablet to a computer with the supplied USB cable.

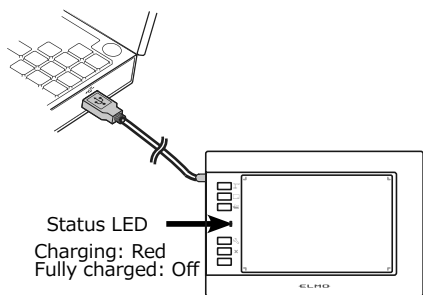

● Connecting to a device

Use the supplied wireless dongle to connect the tablet to a device wirelessly.

Connecting to a computer

You can control your computer like a mouse. By using with the EIT, you can add annotations to the screen image.

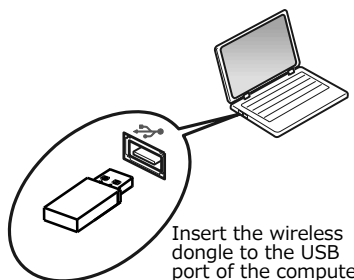

● Checking the connection ports and switches

Side view (left)

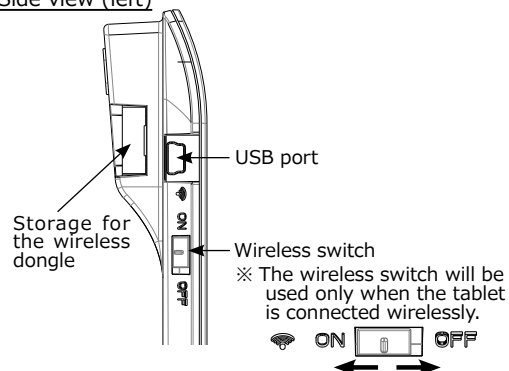

Connecting to the document camera

You can add annotations to the document camera image or control the document camera.

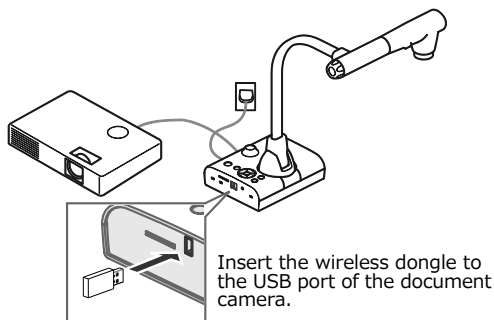

※ You can also use the tablet by connecting it to a device using the supplied USB cable.

● USING THE PRODUCT

1. Turn on the power.

The Status LED will turn green and go off after the power is on.

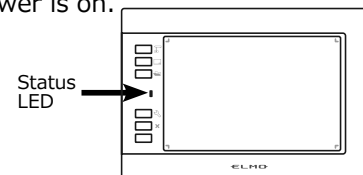

● When connecting wirelessly

⇒ The tablet will power on when the wireless switch is set to on.

ON (Enabled)

By connecting the wireless dongle to a computer or document camera, you can use the CRA-2 wirelessly.

OFF (Disabled)

The power enters standby mode.

※ You can use the tablet no matter the wireless switch is on or off when connecting with the USB cable.

● When connecting with the USB cable

⇒ The tablet will power on when it is connected to a running computer or document camera.

2. Operate the tablet

Working area

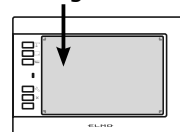

The tablet will start to recognize the pen if the working range is touched by the pen tip button.

The tablet will enter sleep mode after about 45 minutes of inactivity.
※ Only when connected wirelessly

● Replacing the pen tip

When the pen tip becomes round, replace it with the supplied "extra core". Use the supplied pen holder when replacing the pen tip.

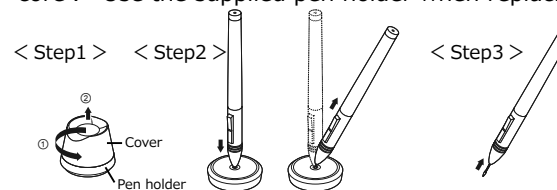

※ Caution

- When replacing the pen tip, be sure to replace it with the supplied "extra core".
- Make sure that children do not put small parts into their mouths.

● Pen operations



Right click (when using with the document camera : eraser)

When using with the document camera : eraser

Left click

※ Available functions may differ depending on the document camera used.

● Shortcut keys

※ You need to install the EIT on your computer to use the tablet with your computer. Available functions may differ depending on the document camera used.

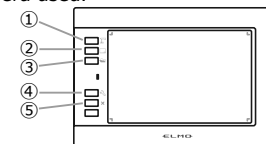

	Name	Description
①	Document camera mode	To display the document camera image.
②	Whiteboard mode	To display the whiteboard screen.
③	Playback mode	To display images stored.
④	Operation/ Settings mode	• When connecting to a computer: to control a computer as a mouse • When connecting to the document camera: to configure pen settings
⑤	Close/ Hide	• When connecting to a computer: to close the EIT • When connecting to the document camera: to display or hide menus

● Storage for the pen and wireless dongle

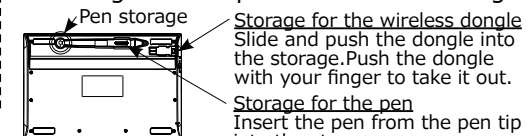

Slide and push the dongle into the storage. Push the dongle with your finger to take it out.

Insert the pen from the pen tip into the storage. Pull the pen with your finger to take it out.

● DETAILED USAGE OF THE PRODUCT

For detailed information about the Instruction Manual, refer to the following website:

<https://www.elmoussa.com/>

<https://www.elmoeurope.com/index.php/en/>



IMPORTANT SAFEGUARDS

- Read Instructions : All the safety and operating instructions should be read before the appliance is operated.
- Retain Instructions : The safety and operating instructions should be retained for future reference.
- Head Warnings : All warnings on the product and in the operating instructions should be adhered to.
- Follow Instructions : All operating and use instructions should be followed.
- Cleaning : Unplug this product from the wall outlet before cleaning. Do not use liquid cleaners or aerosol cleaners. Use a damp cloth for cleaning.
- Attachments : Do not use attachments not recommended by the product manufacturer as they may cause hazards.
- Water and Moisture : Do not use this product near water - for example, near a bath tub, wash bowl, kitchen sink, or laundry tub, in a basement, or near a swimming pool, and the like.
- Placement : Do not place this product on an unstable cart, stand, tripod, bracket, or table. The product may fall, causing serious injury to a child or adult, and serious damage to the product. Use only with a cart, stand, tripod, bracket, or table recommended by the manufacturer or sold with the product. Any mounting of the product should follow the manufacturer's instructions, and should use a mounting accessory recommended by the manufacturer.
- Ventilation : Slots and openings in the cabinet are provided for ventilation and to ensure reliable operation of the product and to protect from overheating, and these openings must not be blocked or covered. The openings should never be blocked by placing the product on a sofa, rug, or other similar surface. This product should not be placed in a built-in installation such as a bookcase or rack unless proper ventilation is provided or the manufacturer's instructions have been adhered to.
- Power Sources : This product should be operated only from the type of power source indicated on the marking label. If you are not sure of the type of power supply to your home consult your appliance dealer or local power company. For products intended to operate from battery power, or other sources, refer to the operating instructions.
- Grounding or Polarization : This product may be equipped with either a polarized 2-wire AC line plug (a plug having one blade wider than the other) or a 3-wire grounding type plug, a plug having a third (grounding) pin. If the 2-Wire polarized plug will not fit in the outlet, try reversing the plug. If the plug still fails to fit, contact your electrician to replace your obsolete outlet. Do not defeat the safety purpose of the polarized plug. The 3-wire grounding type plug will fit into a grounding type power outlet.
- This is a safety feature. If you are unable to insert the plug into the outlet, contact your electrician to replace your obsolete outlet. Do not defeat the safety purpose of the grounding type plug.
- Power-Cord Protection : Power-supply cords should be routed so that they are not likely to be walked on or pinched by items placed upon or against them, paying particular attention to cords at plugs, convenience receptacles, and the point where they exit from the product.
- Lightning : For added protection for this product during a lightning storm, or when it is left unattended and unused for long periods of time, unplug it from the wall outlet and disconnect the antenna or cable system. This will prevent damage to the product due to lightning and power-line surges.
- Overloading : Do not overload wall outlets, extension cords, or integral convenience receptacles as this can result in a risk of fire or electric shock.
- A product and cart combination should be moved with care. Quick stops, excessive force, and uneven surfaces may cause the product and cart combination to overturn.
- Object and Liquid Entry : Never push objects of any kind into this product through openings as they may touch dangerous voltage points or short-out parts that could result in a fire or electric shock. Never spill liquid of any kind on the product.
- Servicing : Do not attempt to service this product yourself as opening or removing covers may expose you to dangerous voltage or other hazards. Refer all servicing to qualified service personnel.
- Damage Requiring Service : Unplug this product from the wall outlet and refer servicing to qualified service personnel under the following conditions:
 - When the power-supply cord or plug is damaged.
 - If liquid has been spilled, or objects have fallen into the product.
 - If the product has been exposed to rain or water.
 - If the product does not operate normally by following the operating instructions. Adjust only those controls that are covered by the operating instructions as an improper adjustment of other controls may result in damage and will often require extensive work by a qualified technician to restore the product to its normal operation.
 - If the product has been dropped or damaged in any way.
 - When the product exhibits a distinct change in performance - this indicates a need for service.
- Replacement Parts : When replacement parts are required, be sure the service technician has used replacement parts specified by the manufacturer or have the same characteristics as the original part. Unauthorized substitutions may result in fire, electric shock or other hazards.
- Safety Check : Upon completion of any service or repairs to this product, ask the service technician to perform safety checks to determine that the product is in proper operating condition.
- Heat : The product should be situated away from heat sources such as radiators, heat registers, stoves, or other products (including amplifiers) that produce heat.

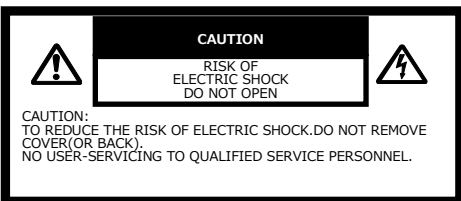

SA 1965

The lightning flash with arrowhead symbol, within an equilateral triangle, is intended to alert the user to the presence of uninsulated "dangerous voltage" within the product's enclosure that may be of sufficient magnitude to constitute a risk of electric shock to persons.



SA 1966

The exclamation point within an equilateral triangle is intended to alert the user to the presence of important operating and maintenance (servicing) instructions in the literature accompanying the product.



This symbol [crossed-out wheeled bin WEEE Annex IV] indicates separate collection of waste electrical and electronic equipment in the EU countries. Please do not throw the equipment into the domestic refuse. Please use the return and collection systems available in your country for the disposal of this product.

WARNING
TO REDUCE THE RISK OF FIRE OR ELECTRIC SHOCK, DO NOT EXPOSE THIS PRODUCT TO RAIN OR MOISTURE.
The connection of a non-shielded equipment interface cable to this equipment will invalidate the FCC Certification or Declaration of this device and may cause interference levels which exceed the limits established by the FCC for this equipment. It is the responsibility of the user to obtain and use a shielded equipment interface cable with this device. If this equipment has more than one interface connector, do not leave cables connected to unused interfaces. Changes or modifications not expressly approved by the manufacturer could void the user's authority to operate the equipment.

FOR UNITED STATES USERS: INFORMATION

This device complies with part 15 of the FCC Rules. Operation is subject to the following two conditions: (1) This device may not cause harmful interference, and (2) this device must accept any interference received, including interference that may cause undesired operation.

Any Changes or modifications not expressly approved by the party responsible for compliance could void the user's authority to operate the equipment.

Note: This equipment has been tested and found to comply with the limits for a Class B digital device, pursuant to part 15 of the FCC Rules. These limits are designed to provide reasonable protection against harmful interference in a residential installation. This equipment generates uses and can radiate radio frequency energy and, if not installed and used in accordance with the instructions, may cause harmful interference to radio communications. However, there is no guarantee that interference will not occur in a particular installation. If this equipment does cause harmful interference to radio or television reception, which can be determined by turning the equipment off and on, the user is encouraged to try to correct the interference by one or more of the following measures:

- Reorient or relocate the receiving antenna.
- Increase the separation between the equipment and receiver.
- Connect the equipment into an outlet on a circuit different from that to which the receiver is connected.
- Consult the dealer or an experienced radio/TV technician for help.

The device has been evaluated to meet general RF exposure requirement. The device can be used in portable exposure condition without restriction.

USER-INSTALLER CAUTION:

Your authority to operate this FCC verified equipment could be voided if you make changes or modifications not expressly approved by the party responsible for compliance to Part 15 of the FCC rules.

Declaration of Conformity
ELMO Co., Ltd. hereby declares that this CRA-2 Smartphone is in compliance with the essential requirements and other relevant provisions of Directive 2014/53/EU. In accordance with Article 10(2) and Article 10(10), This product is allowed to be used in all EU member states.

This device complies with Industry Canada's licence-exempt RSSs. Operation is subject to the following two conditions:

- (1) This device may not cause interference; and
- (2) This device must accept any interference, including interference that may cause undesired operation of the device. Cet appareil est conforme aux CNR exemptes de licence d'Industrie Canada. Son fonctionnement est soumis aux deux conditions suivantes :
 - (1) Ce dispositif ne peut causer d'interférences ; et
 - (2) Ce dispositif doit accepter toute interférence, y compris les interférences qui peuvent causer un mauvais fonctionnement de l'appareil.

Le dispositif a été conçu pour répondre à la demande générale de radioexposition.

BEFORE YOU USE

■ Disposal of battery

This product uses Lithium Ion rechargeable and recyclable battery.

When disposing of the battery, contact the dealer from whom you purchased the product. Do not try to remove the battery by yourself.

■ The built-in lithium-ion battery has its own life span. Along with the temperature, frequency of use, time of use and the time passed, battery capacity decreases gradually.

If operation time becomes substantially short at normal temperature (between 10°C and 30°C), the battery life seems to have come near its end. Replace it with a new battery. Contact your dealer or ELMO Customer Service for battery replacement (fee applies).

■ About electric waves used by the Tablet

The Tablet uses electric waves in the 2.4 GHz band. When using the Tablet, a radio station license is not necessary. However, please note the following precautions.

Do not use near the following:

- Microwave ovens/industrial, scientific or medical equipment, such as pacemakers
- In-factory radio stations for mobile unit identification systems (radio stations that require a license) used in production lines of factories
- Specified low power radio stations (radio stations that do not require a license)
- IEEE802.11g/b wireless LAN units

When the Tablet is used near any of the equipment mentioned above, electric wave interference may occur, making the Tablet difficult to use.

■ About wireless equipment used in the 2.4 GHz band

This frequency bandwidth is the same as for industrial, scientific, and medical equipment such as microwave ovens, mobile unit identification systems (radio stations that require a license) used in factory production lines, and specified low-power radio stations (radio stations that do not require a license).

• Before using this product, check that there are no radio stations for mobile unit identification systems or specified low-power radio stations nearby.

• If this product emits electric waves which interfere with in-factory radio stations for mobile unit identification systems, cease use immediately and stop generating the electric waves. For information on countermeasures, etc. (for example, erecting partitions), contact one of our sales departments whose details are provided at the end of this manual.

• If this product emits electric waves which interfere with specified low-power radio stations used for mobile unit identification systems, or causes similar problems, contact one of our sales departments whose details are provided at the end of this manual.

<https://www.elmoussa.com/>

<https://www.elmoeurope.com/index.php/en/>