

ITEM	DESCRIPTION	PART NO./MATERIAL	NOTES	QTY
1	KEYFOB , PCB	63249-339-50		1
2	KEYFOB CASE,	POLYCASE FB40-3		1
3	BATTERY,CR2032	CR2032		1
4	PRODUCT LABEL,KEYFOB	63249-355-09		1

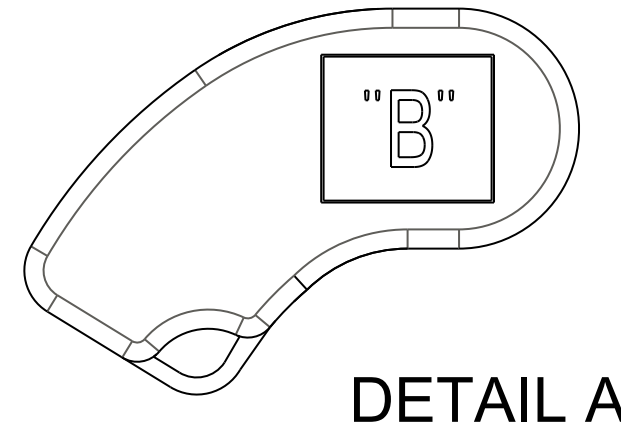
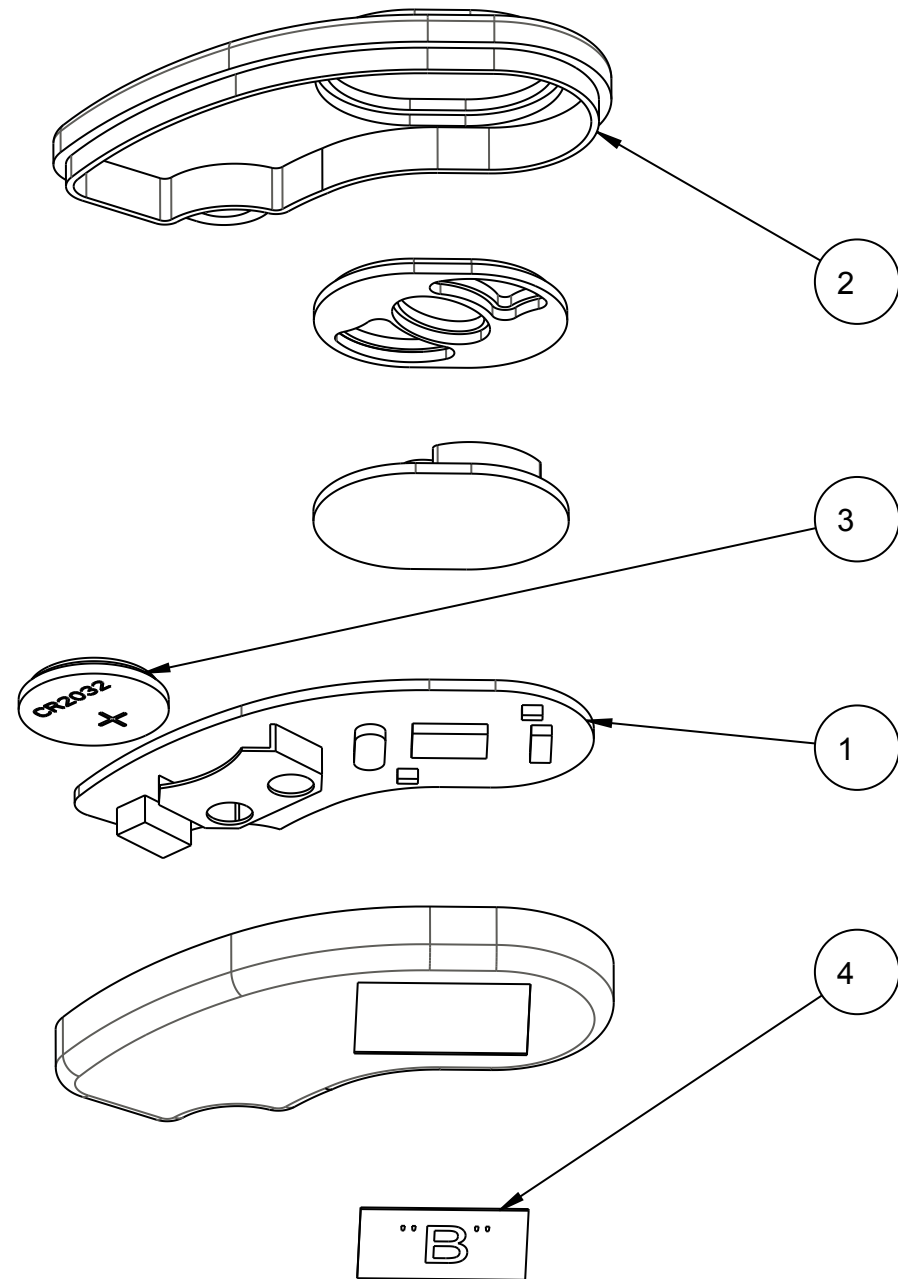

- NOTES:
1. ASSEMBLE ITEMS IN ACCORDANCE WITH THE VARIOUS VIEWS IN THIS DRAWING
 2. INSTALL BATTERY PRIOR TO INSERTING PCB INTO ENCLOSURE.
 3. POSITION PRODUCT LABEL, ON BOTTOM OF UNIT AS INDICATED IN DETAIL A THE LETTER "B" INDICATES ORIENTATION OF GRAPHICS.
 4. THE MANUFACTURING ENTITY IS TO ENSURE THEIR PROCESS DOES NOT IMPORT HAZARDOUS SUBSTANCES (e.g. MERCURY, LEAD) TO THE ASSEMBLY AS RESTRICTED BY DIRECTIVES LISTED IN SOP3282 (e.g. RoHS).

REV.	ECN NO.	DATE	BY	UNLESS OTHERWISE SPECIFIED: ALL TOLERANCES	APPROVALS	DATE	TITLE	Schneider Electric		
				LINEAR: .XX = ± .01 [.25mm] .XXX = ± .005 [.13mm]	DRAWN J DYER	02/26/10	KEYFOB REMOTE SUB ASSY	LAVERGNE, TENNESSEE, U.S.A.		
				ANGLE: UNDIMENSIONED 90°: ± 2° DIMENSIONED ANGLE: ± 1°	CHECKED			FILENAME	63249-335-106	
				3RD ANGLE PROJECTION	ENGINEERING		PART NO.	SHEET	SCALE	REVISION
A1	PH10055	03/15/10	CR	BREAK ALL SHARP EDGES DO NOT SCALE DRAWING	MANUFACTURING		63249-335-106	1 OF 1	NOTED	A1