

## **Precautions:**

This device complies with Part 15 of the FCC Rules. Operation is subject to the following two conditions: (1) This device may not cause harmful interference, and (2) this device must accept any interference received, including interference that may cause undesired operation.

NOTE: This equipment has been tested and found to comply with the limits for a Class B digital device, pursuant to Part 15 of the FCC Rules. These limits are designed to provide reasonable protection against harmful interference in a residential installation. This equipment generates uses and can radiate radio frequency energy and, if not installed and used in accordance with the instructions, may cause harmful interference to radio communications. However, there is no guarantee that interference will not occur in a particular installation. If this equipment does cause harmful interference to radio or television reception, which can be determined by turning the equipment off and on, the user is encouraged to try to correct the interference by one of the following measures:

- Reorient or relocate the receiving antenna.
- Increase the separation between the equipment and receiver.
- Connect the equipment into an outlet on a circuit different from that to which the receiver is connected.
- Consult the dealer or an experienced radio/TV technician for help.

WARNING: Any changes or modifications not expressly approved by the party responsible for compliance could void the user's authority to operate this equipment.

The device must not be co-located or operating in conjunction with any other antenna or transmitter.

FCC RF Radiation Exposure Statement Caution: To maintain compliance with the FCC's RF exposure guidelines, place the product at least 20cm from nearby persons.

## **Using Quad View**

- With the QuadView layout, you can operate audio player

and access apps, while displaying the telephone and air conditioning screens.

- You can enlarge the area you want to operate by touching the area.
- You can switch from the full screen view to the four screen view by touching the cross point.
- You can rearrange the areas of the Quad View.
- Move the area you want to rearrange using the four screen view.

### **Set the priority mode**

Press down the intersection of the equal four screens, shift to different priority mode

Per the priority mode, the press operation may be different on equal four screens.

## **Function limit during driving**

Notes:

For your safety, when parking brake is released and drive speed is over 8km/h, some of the functions may be prohibited. The notification of the prohibition is shown and related buttons will be shown as grey.

Functions of drive limitation is as follows:

- Prohibit the display of image and the play of USB video, the current video is automatically shifted from video mode to audio mode.
- Prohibit the dialing of phone number.
- Prohibit the viewing of short message.
- Prohibit equal four screens dragging of 2 sections shifting operation.
- Prohibit the setting of partial functions, such as Vehicle Settings, Bluetooth Settings, Device Connection etc.

## Function Button

### Central control panel button

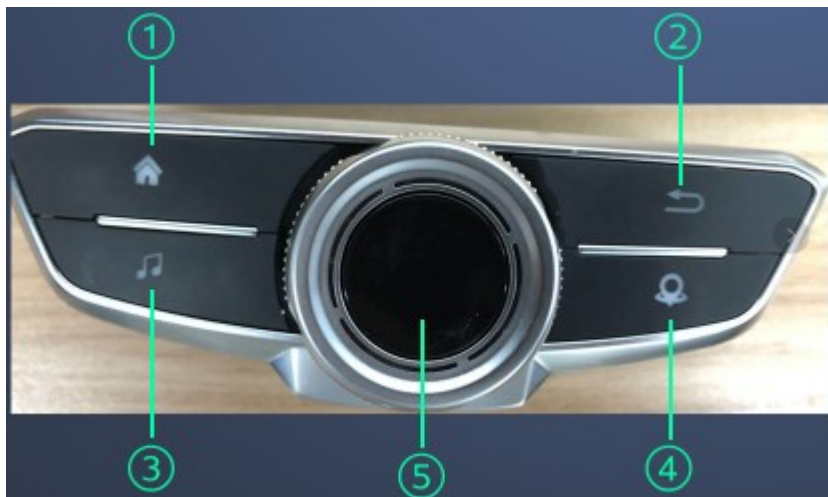

① Home Button

Under any screen, long press Home button to enter into Main

Menu, long press again Home button to back into the screen before Main Menu.

Short press, shift to 75% view or full view in clockwise sequence.

## ② Back Button

- If the current view was full view or 75% view, then it went back to the previous menu.

- If the current view was Main Menu, then it went back to previous view of Main Menu;

- If the current view was Apple CarPlay view, it went back to previous menu, until it reached to Apple CarPlay main view, at this time, press again Back button, then it goes back to previous view of Apple CarPlay.

- If the current view was Android Auto, press Back button to return to previous view of Android Auto.

## ③ Media Button

Press Media button, shift source following the below sequence, for unconnected equipment, it skips over:

- When Android Auto/Apple CarPlay is not connected, the shifting sequence will be:

Radio→USB/iPod→BT Audio ;

- When Android Auto connected, the shifting sequence will be Radio→Android Auto Music;
- When Apple CarPlay Auto is connected, the shifting sequence will be Radio→USB→Apple CarPlay Music;
- When Apple CarPlay is connected (through USB), the shifting sequence will be Radio → USB → Apple CarPlay Music;

#### ④ Audio Button

Press down Audio button to enter into Audio Settings interface.

#### ⑤ Rotary Button

The compatible operations: Short press, long press, left move, right move, up move, down move, clockwise rotary, anticlockwise rotary.

-up and down, left and right move: effective when it is full screen or 75% view.

- Beyond of Apple CarPlay/Android Auto full view and 360° look around view, move the cursor at the current view.
- Valid when Apple CarPlay/Android Auto is full view and 360° look around view
- When current view is full view or 75% view, cursor is shown

or enter into the program when cursor stays at;

- When Apple CarPlay/Android Auto full screen, press button is invalid.
- When it is 360° look around view, shift 360° look around view into as its 2D/3D model ;
- Under standby, run the operation of turning on.
  - Long press: under turning on state, long press for 3s for standby; under turning off state, long press for 6s to reboot.
  - Rotary: Rotate clockwise to turn the volume up; rotate anticlockwise to turn the volume down. When it is under 360° look around view, shift angle of view of 360° look around.

## **Steering Wheel Buttons**

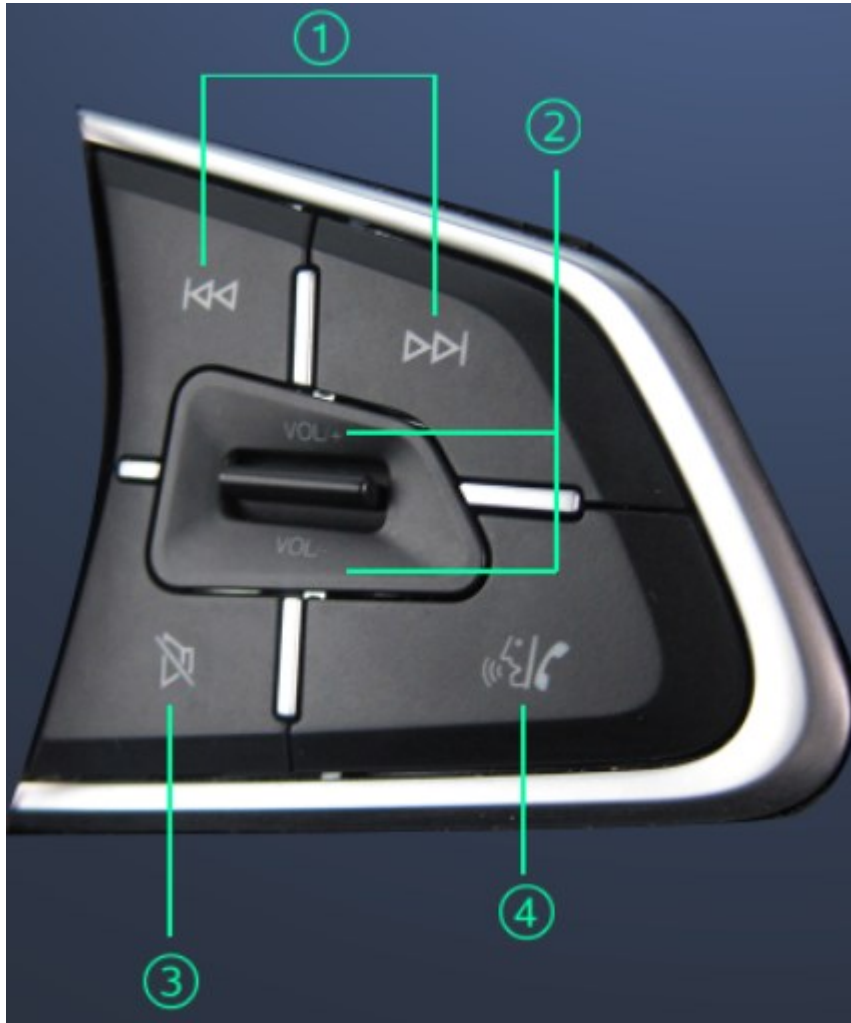

- 1 Up, Down Button: under the mode of USB ( Music, Video, Picture)、iPod、 Bluetooth Audio and Apple CarPlay Music, shift to play of previous/next file; Long press, fast track/fast reverse (except USB Picture). Under Radio mode, short press, present channel up/down; long press, seek up/down.
- 2 Volume Button: Volume adjustment
- 3 Mute button: Mute on or off.
- 4 VR/Phone Button :



- Short Press, enter into Bluetooth Phone Menu view, Apple CarPlay Phone or Android Phone view; under receiving phone call, short press to answer the call; under dialing or calling, short press to hang up.
- Long press, when Apple CarPlay/Android Auto is connected, active Siri/VR; if Apple CarPlay is not connected, run the Wireless Apple CarPlay connection, display Apple CarPlay equipment registration view.

## **Main Menu**

Long press Home button on central control panel to enter into view of Main Menu, four views will be displayed. Initial setup area 1 will be A/C related function; area 2 will be functions related to Audio interconnection, area 3 will be tool related functions, and area 4 will be functions on Phone. Press button on each area to enter into other views, Main Menu released.

By dragging and shifting two areas of Quadview, the display of 4 areas view will be realized.

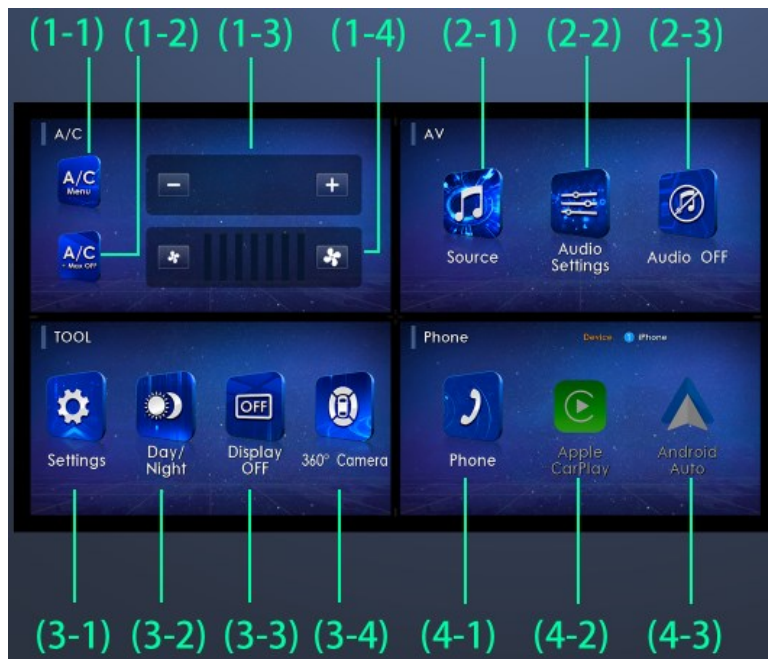

1-1 [A/C Menu]: Enter into A/C setup view

1-2 [A/C Max]: Fast refrigeration

1-3 Temperature regulation: Regulate the air temperature

1-4 Wind speed regulation: Regulate the wind speed of A/C.

2-1 [Source ]: Press to enter into media source view, shifting to play of media source or Audio OFF.

2-2 [Audio Settings] : Press and enter into Audio Setting View.

2-3 [Audio OFF]: Press Audio OFF, stop the play of Media.

3-1 [Settings]: Enter into Settings view

3-2 [Day/Night]: Shifting between day/night display mode.

When turn on the headlight during the day, it is hard to see clear what is on the screen, it can be shifted to day mode in order to see more clear of the screen.

3-3 [Display OFF]: Turn off screen display; press again display, press any button on central control panel or press the Mute button or VR/Phone button on steering wheel to turn on the display screen.

3-4 [360° Camera]: it is 360° look around image system.

(suitable for Titanium Plus model car)

4-1 [Phone]: When Apple CarPlay is not connected, shift to Bluetooth phone menu view; when Apple CarPlay is connected, shift to Apple CarPlay phone view.

4-2 [Apple CarPlay]: Press and enter into main view of Apple CarPlay.

4-3 [Android Auto]: Press and enter into main view of Android Auto.

## **Audio Settings**

Under Main Menu, press [Audio Settings] button to enter into Audio Settings view, the setup of Balance/Fader, Bass, Mid and Treble can be done here, as well as Speed Sensitivity Volume on or off, loudness on or off.

Dragging the slide block of Balance/Fader, balance of left and right, front and rear speaker can be adjusted.



1 Reinforce the Gain Value of Volume automatically based on the vehicle speed.

2 Replenish the high pitch and bass base on the Volume levels.

3 Press [Reset] button to resume to factory settings of Audio Settings.

## TOOL View

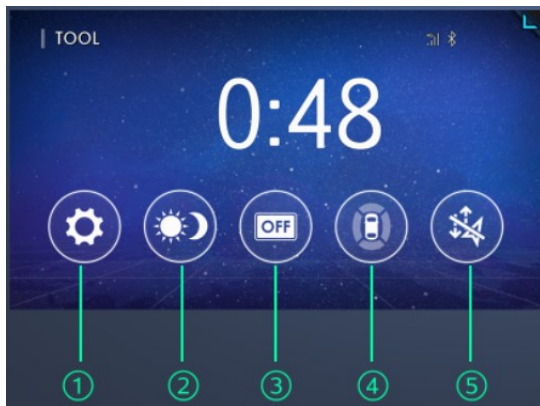

Clock, mute sign are shown on TOOL view; When connecting with Bluetooth, Bluetooth sign and signal strength of hand phone is shown.

- ① Press to shift the screen between day and night model.
- ② Press to enter into view setup.

- ③ Press to turn off the monitor.
- ④ Press to enter into 360° look around video system.  
(Suitable for Titanium Plus model of car).
- ⑤ Showing the current connection status of Modem,  
press to enter into view of Modem. (Only for Brazil)

## Settings

Under Main Menu, press [Settings] to enter into the configuration of view, total 2 pages.

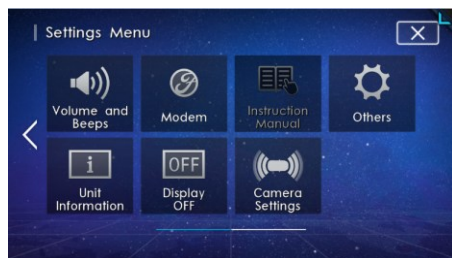

- 1 [Vehicle Settings] : car information is shown, for configuration of car safety, car body and atmosphere light.
- 2 [Bluetooth Settings] : To turn the Bluetooth on/off; to register, choose or delete the connection devices;

devices name can be changed.

- 3 [Apple CarPlay Settings] : wireless connection, choose or delete connection Apple CarPlay devices.
- 4 [Android Auto Settings] : Configure Use Android Auto as on state or off state. When it is on, automatically use Android Auto when connecting Android Auto mobile phone.
- 5 [Select Language] : the system language can be set as Brazil Portugal language, Mexican Spanish language or English.
- 6 [Clock Settings] : clock, clock system, GPS Auto network timer, time zone and daylight hours (Only for Brazil) can be set here.  
  
The vehicle will show clock automatically based on GPS, manually setting is prohibited.
- 7 Press to shift the monitor between daytime or nighttime mode.
- 8 [Adjust Brightness] : Regulate the brightness of monitor backlight.
- 9 [Volume and Beeps] : To adjust the volume of audio, phone ring and phone call, turn the keypad tone on and

off.

10 [Modem] : Showing the vehicle data or location is under sharing or not, when the vehicle is under location sharing, Modem reset is allowed. (Only for Brazil).

11 [Instruction Manual] : Viewing the manual book of the vehicle.

12 [Others] : Press to enter into setup of others, following functions are allowed:

-Resume to factory configuration: to setup the device to default setting

-Unit setting: the unit of Millage, temperature, pressure and average fuel consumption can be set.

13 [Unit Information] : check the version information, product information and system upgrade.

14 [Display OFF] : Press to turn off the monitor.

15 [Camera Settings] : According to configuration of the vehicle, 360° Panoramic descent reentry, (suitable for Titanium Plus model of car) or keep the Video Rearview system (suitable for Trend or Trend + model of car) on or off.

## **Bluetooth Functions**

## Bluetooth Settings

Press [Bluetooth Settings] under Settings view and enter into Bluetooth Settings. The Bluetooth can be turned on and off, Bluetooth connection and change name of Bluetooth.

Notes:

When the device is under Android Auto or Apple CarPlay, [Bluetooth] and [Device Connection] button are invalid.

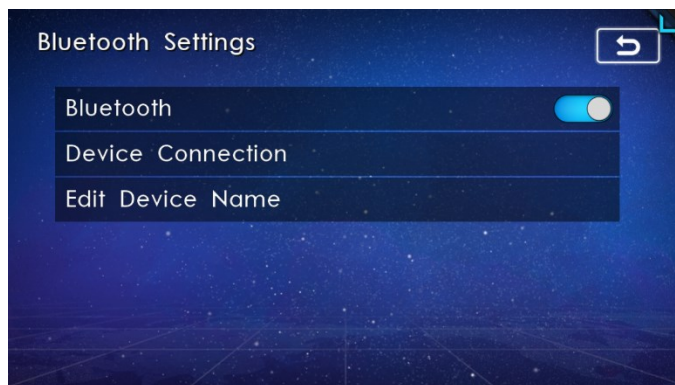

## Device Connection

Under the view of Bluetooth Settings, press [Device Connection] to enter into the view of Device Connection, new Bluetooth device can be matched, connected or deleted.

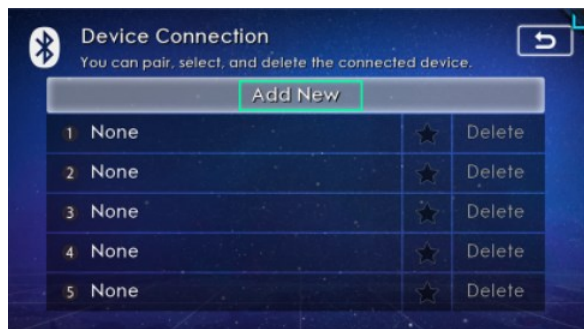



1. Press “Add New”, Pair Device view is shown, from your Bluetooth set up menu, look for “Ford Territory” to pair.

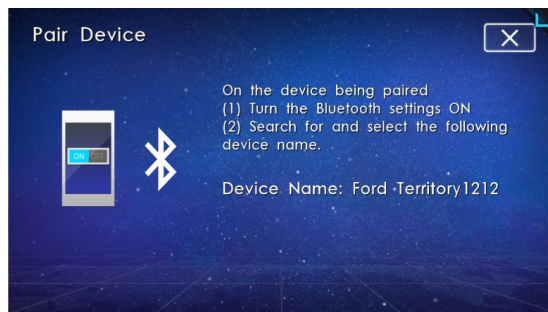

2. After successfully matched, press “End” button to return to connecting view, the matched devices will be shown on the lists. The Bluetooth device which is connected will be marked with “✓”.

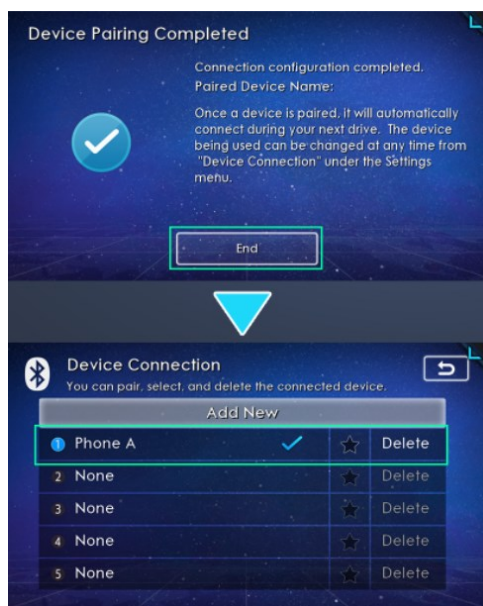

3. Press “☆” button besides the device, customers can add the favorites here. When the device is on, it automatically connects the added devices; When none of device is added, it automatically connects with the device last time

paired.

## Phone Menu

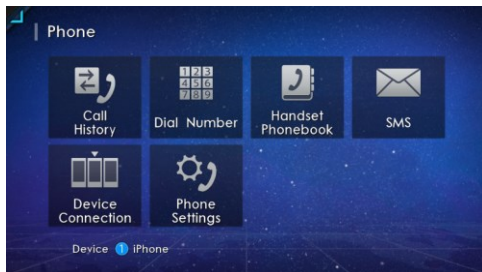

On Main Menu, press [Phone] to enter into telephone menu view, when mobile phone is connected, you can check the dialing history, dialing, phone number book, short message, equipment connections and configuration of telephone. At the end of the view, current connecting mobile phone is shown.

- 1 [Call History] : After entering into Call History view, phone number can be chosen for dialing.
- 2 [Dial Number] : Entering into Dial Number, you can directly enter the phone number to dial.
- 3 [Handset Phonebook] : If the phone book is already synchronized, phone number can be checked and can be dialed. If not, manually set to synchronize.
- 4 [SMS]: If the short message is synchronized, you can get the short message. Press to enter into the short message

list, short message can be checked.

- 5 [Device Connection] : Press to enter into Device Connection view.
- 6 [Phone Settings] : (Ring volume and call volume), set the incoming call number show on/off and call history synchronization on/off. When call history synchronization is on, call history will be synchronized automatically when the mobile phone and the device is paired.

Remark:

- Device synchronization permission should be set for the synchronization when pairing the Call history, call book and short message. Once synchronization is done, the relative key can be pressed for view. Short messages in some of the mobile phone could not be synchronized.

### **Under calling**

When under calling, the following view is shown, current telephone number, call duration, called party name (if saved in phone book) and phone number are shown on the view. Call volume can be set by press wheel volume key or rotary knob.

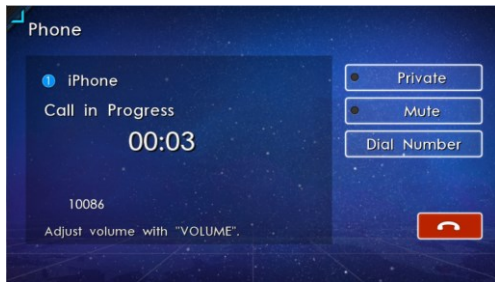

- 1 [Private] : Press to shift to private conversation mode, the voice of the other calling party is not transmitted by speaker.
- 2 [Mute] : Turn the speaker mute, shut off the transmission of voice.
- 3 [Dial Number] : On some occasion, phone number should be entered here.
- 4 Hang off button: end the current call.

## Media Play

### Shift of Media Source

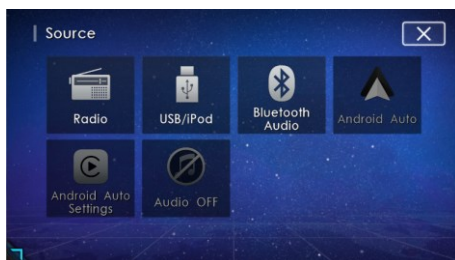

The Media Sources supports by the device includes: Radio, USB/iPod, Bluetooth Audio, Android Auto (music) , Apple CarPlay (music). Two ways of media sources shift.

- Enter into the shift of Media Source view

After entered into Media Source view, you can shift the media source, also you can press Audio OFF key to turn off the play of media.

■Shift by press the down key

Press the key [Media] on Center control panel.

## Listening to Radio

The tuner in this head unit contains RBDS (Radio Broadcast Data System) in FM band.



- ① Radio information view: Based on the previous radios you have listened, the preset radio number, radio frequency, stereo indicator, PS name, PTY name and Radio Text are shown.
- ② [FM], [AM] : Band show and shift
- ③ [SCAN]: Searching radio, play for 20 seconds when found

the radio frequency.

- ④ Option key : Press to enter into the view of Option, Auto Store function is active. It will automatically search for the top 12 or 18 most strong signal radios and preset in the radio list.
- ⑤ [ ◀ ], [ ▶ ]: Press to manually tune up/down.
- ⑥ Up, Down key : Press to automatically seek up/down
- ⑦ Preset Channel List : short press every preset radio key, listen to the selected preset radio. Long press to preset radio key, the current frequency radio will be preset. In FM band, 10 radios can be preset; for AM band, 12 radios can be preset.
- ⑧ Audio Settings key: Press to enter into Audio Settings view.
- ⑨ Sourcekey: Press to enter into Media Source shift view.

## **Other Media Playback**

### **Compatible media**

#### **■compatible media medium**

This device supports the following media medium:

- (1)USB: the interface is USB1.1/2.0, the zoned format is FAT16,FAT32, exFAT, NTFS. Including root directory, total 32 layers is allowed, and the maximum is 512 folders, in each

folder, maximum 255 files is allowed, the maximum total files is 8000, 2GM maximum audio file is allowed.

(2)iPod: iPod, iPhone etc.

(3)Bluetooth Audio: Bluetooth 4.2 ; HFP 1.7 ; A2DP 1.3 ;  
AVRCP 1.6 ; PBAP 1.2.

### ■The compatible media type

Mass storage files in the USB can be played, including audio, video, pictures etc.

- Pictures: JPG/BMP/PNG.

- Audio: MP3/WMA/AAC/WAV/FLAC/AACLC/HE-  
AC/WMA10Std.

- Compressed Video:

MKV/AVI/MOV/M4V/MPEG( MPG/MPE)/MP4/MPEG2/MPEG4  
/H.264/WMV/FLV.

## Audio Playback

According to the shift way of Media Source, the media play view will be shown(USB、iPod、BT Audio、Apply Apple CarPlay、Android Auto ) . For Apply Apple CarPlay and Android Auto, 75% view will be shown.

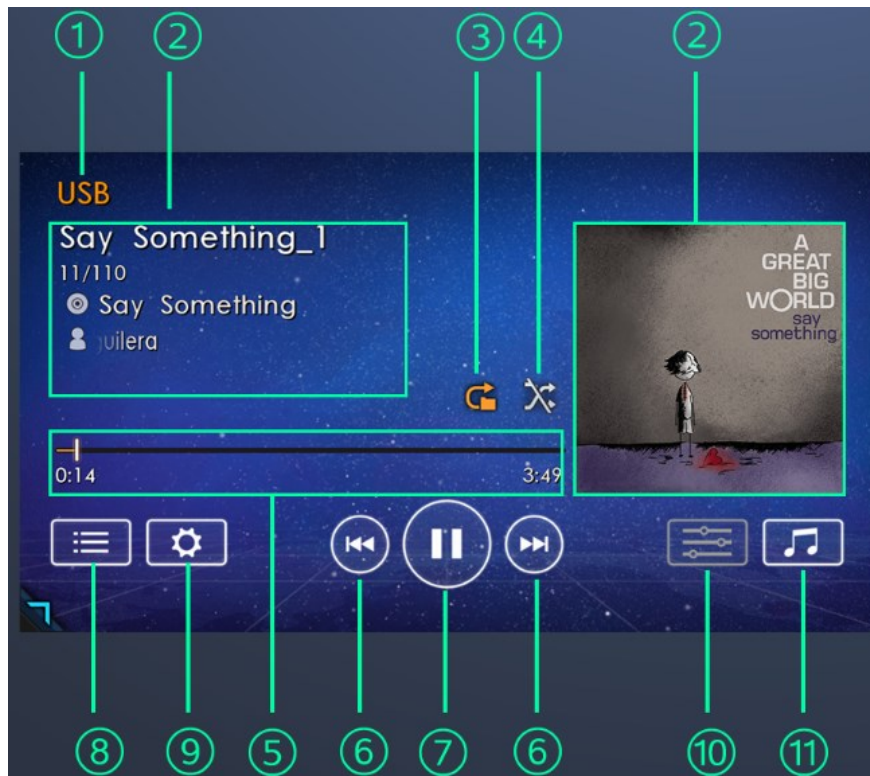

- ① Current play media type.
- ② Song information area: Based on the song data, the name of the song, SN of the tracks/total numbers of tracks (USB/iPod mode), theme name, singer and album cover of theme will be shown. Under Bluetooth Audio mode, current connected Bluetooth name is shown.
- ③ **Repeat** button- Press to play single file repeatedly or shift between folders
- ④ Random button- press to shift between random on /off.
- ⑤ Progress bar- Under USB mode, progress bar can be dragged, directly and quickly shift the current playing tracks



- ⑥ Up, Down button- press to jump to previous track/next track; long press to forward/backward.
- ⑦ Play/Pause button- press to pause or play
- ⑧ **List button: under** USB/iPod mode, press to open all current play media category list ( for the first time use, enter into all the tracks song name.), from the list, you can select according to category, play any tracks or category.

Under the list, press Search sign on the upper left, you can type text to do the file searching.

- ⑨ **Option button-when there are videos or pictures stored in the USB, entering into Option view, you can press** “Switch to Video” or “Switch to Picture “to shift to play video or picture; Under Bluetooth Audio mode, press to enter into Device Connection view.
- ⑩ **Audio Settings Button- Jumps to Audio Settings View.**
- ⑪ **Source button- Jump to Source to select views and shift to Media Source.**

## **Video Playback (USB)**

Press screen or operation function button, touchpad will be active. Within 5 seconds, if no operation is given or press the screen, the touchpad will automatically hide.

Notes: When the car is under driving, the video can not be played, only the

sound of the video can be heard.



- ① Video information- shows the name of the video under playing and video number/total files.
- ② **Progress bar** – drag the progress bar to quickly shift to current video play.
- ③ **Play/Pause button- press play or pause.**
- ④ Up, Down button- press to jump to previous video /next video; long press to forward/backward by 4 times speed. Continuously press the key, after 3 seconds, run the high speed (16 times) to forward/backward
- ⑤ List button: enter into list category, there are files list (where video files folders and folders inside videos are saved) and video list (all video lists file.)
- ⑥ Option button- When there are both video or pictures are stored in the USB, enter into Option view, “Switch to Audio” or “Switch to Picture” can be pressed to shift to

video or picture playing. In this view, there are also pictures shift of video, the time of play can be set as on/off.

- ⑦ **Audio Settings button-** jump to sound setting view.
- ⑧ **Source button-** jump to media source to select view for shifting to media source.
- ⑨ **Repeat Button-** Press to repeatedly play single song or play songs in folders one by one.
- ⑩ **Random button-** press to shift between random on/ off.

## Picture Browse (USB)

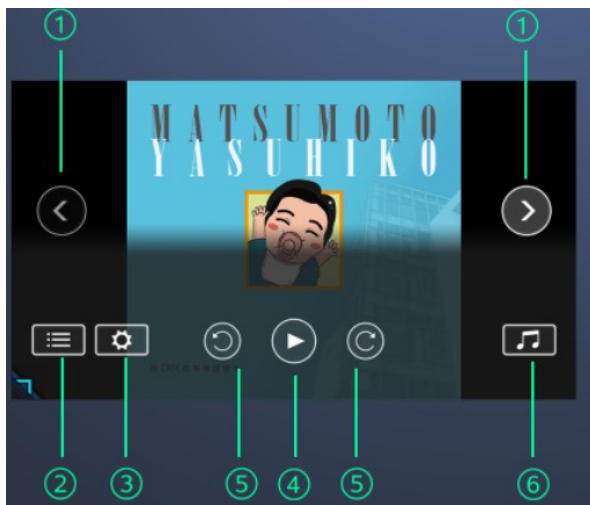

Press screen or operation function button, the below function button will be shown. Within 5 seconds, if no any operation or pressing on the screen, this function will be hidden.

- ① [**<**], [**>**] – press to show the previous or next picture.
- ② **List button-** press to show the thumbnail in USB, select any

picture to play.

- ③ Option button- When there are both audio and video files are stored in USB, enter into Option view, press “Switch to Audio” or “Switch to Video” to shift to audio or video play.
- ④ [▶] – press this button to enter into picture slide play. Each picture will show for 3 seconds, then automatically shift to next picture. Press this button, “||” is show; press again to exit slide play.
- ⑤ Rotary button- Every time press this button, the picture will be rotated clockwise or anti-clockwise by 90 degree.
- ⑥ Source button- jump to media source and select view to shift to media source.

## **Smartphone Interconnection**

Connect iPhone which compatible with Apple CarPlay function or Android smartphone which supports Android Auto with the device, some applications on the smartphone can be used on this device.

Notes:

Any costs arising out of Apple CarPlay or Android Auto will be charged to mobile phone connected.

### **Using Android Auto**

Using Android Auto, some functions of Android smartphone can be used, such as map navigation, dialing and connecting phone call,

send or receive short message, music play or voice function.

Compatible models: Android smartphone

Compatible OS: Android OS over 5.0

Compatible **Bluetooth** protocol: HFP (Hands-Free Profile)

## ■ Preparation

- Set Android Auto under Android Auto Settings as on.

-Using the Google Play in your Android smartphone to download and install Auto application.

-Connect Android smartphone to the device USB by the equipped data line.

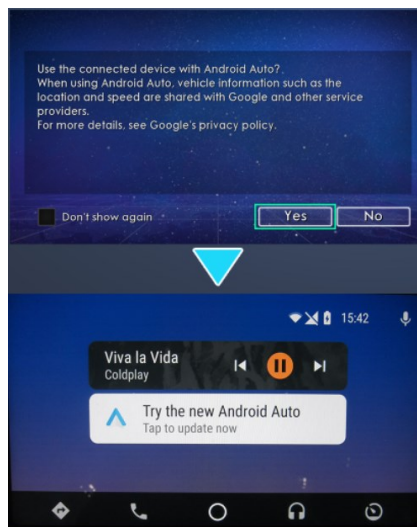

## Using Apple CarPlay

Using Apple CarPlay, you can use all functions of iPhone such as map navigation, dialing and answering phone call, send or receive message, audio play or voice function.

Applicable model: over iPhone 5

Applicable OS: over iOS 10.0.2

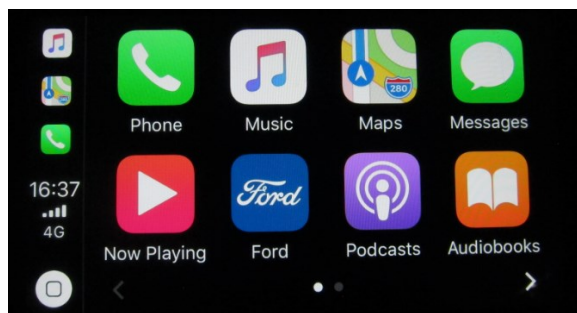

## ■ Connection

Connection by line or by wireless

- Wire connection: connect your iPhone with the device USB interface by equipped dataline.

-Wireless connection: Wireless connection or data transmission can be realized through bluetooth.

The maximum of 5 Apple CarPlay and one fix line connection of Apple CarPlay are realized.

### Wireless Connection

- 1、 Press [Settings]→[Apple CarPlay Settings], enter into Registration process; or if the device is not connected with mobile phone, long press TEL/VR button on steering wheel to enter into registration process.

New equipment can be paired, delete or connect paired equipment, press ☆ button behind wireless connection equipment, this equipment will be the first priority equipment connected.

- 2、 Press [Add Wireless Device], when the prompt view is shown, press [Yes], entering into equipment registration view.

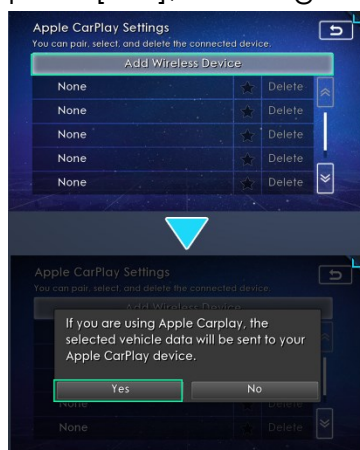

- 3、 Open the bluetooth on your iPhone, search "Ford Territory " and press connect.
- 4、 Please confirm PIN and pair on your iPhone.

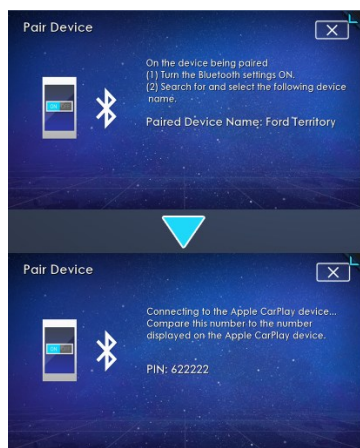

- 5、 Pair successfully.
- 6、 Passkey pass.

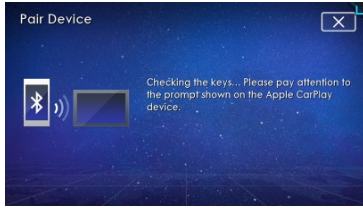

- 7、 When active CaPlay is shown, press agree on your iPhone to run Apple CarPlay.

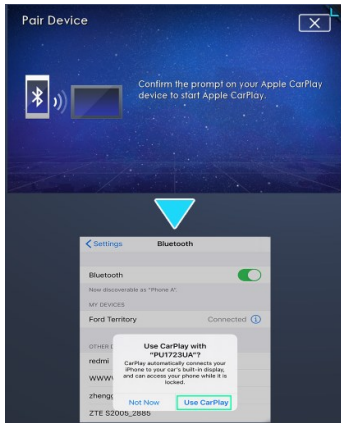

- 8、 When connection is successful, it automatically jumps to CarPaly view.

■ Run the Apple CarPlay

Connect iPhone with the device, or under already connected state, press Apple CaPlay button on Menu.

■ Exit the Apple CarPlay

Disconnect the iPhone with the device, then Apple CarPlay is exited.

## Vehicle Settings

Under Settings view, press [Vehicle Settings] to enter into Vehicle Settings screen, Vehicle Information, Vehicle Safety Settings、 Body Settings and Ambient Lighting Settings are all here.

Notes:

The configuration items are different based on different

model of cars.

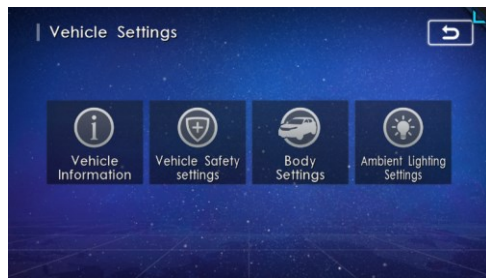

## **Vehicle Information**

Press [Vehicle Information] button under Vehicle Settings shown, you can check vehicle information here such as total mileage of car, fuel percentage left, range, average fuel consumption, tire pressure and temperature, driving time, average speed, maintenance mileage, driving mode etc.

## **Vehicle Safety Settings**

Press "Vehicle Safety Settings" button under Vehicle Settings shown, you can enter into vehicle safety view. Here you can set safety reminder during driving.

- 1、 FCW/PCW Collision Warning : Front collide pre warning, FCW function, through radar system, vehicle driving direction can be monitored, judging the distance between two vehicles, direction and speed, when there is collide possibility, a warning is sent to drivers, this function is already on during driving.
- 2、 FCW/PCW Sensitivity Settings : three tap positions are



set namely high, medium and low, customer can set based on their desire on sensitivity.

- 3、 AEB (Autonomous Emergency Braking) : When radar detects a collide possibility, it prompts and assist driving to give enough brake. If no brake is done by driver, it automatically starts the emergency braking, in this way, collide or collide speed is avoided or reduced. It is in on state during driving.
- 4、 BSD (Blind Spot Detection) Prompt : When it is on, when rear radar on the back of vehicle detects vehicle or objects, warning light on rear mirror will light to warn the drive for safety.
- 5、 BSD (Blind Spot Detection) Prompt Sound: sound prompts can be selected here.

## **Body Settings**

Press “Body Settings “under Vehicle Settings View to enter into body configuration view.

- 1、 Follow Home : The headlight will be turned off in delayed mode, in this way, the driver or passenger can go home with the light on to identify the road. It has four options, 30 Seconds、 1 Minutes、 2 Minutes、 3 Minutes.

2、 Courtesy Lamp: Once the complete vehicle is unlocked, the timer for indoor ceiling lamp, background light, small light, atmosphere light can be set, three options are possible, namely 0 Seconds, 15 Seconds, 30 Seconds.

3、 Room Lamp: When it is set to be Off, the indoor lamp will not be turned off immediately, after a while, it turned off automatically, energy saving is done. This setting can be set as a delayed mode, such as 5 Minutes, 10 Minutes, 15 Minutes.

4、 Rear Defroster : this setting is for defrost the rear mirror, there are the options such 5 Minutes, 10 Minutes.

5、 Power Fold : when the car is locked by remote key, the power fold function is run or it can be chosen to fold manually.

6、 Speed Lock : Once all doors are closed properly during driving and the speed is over 20km/h, all the doors will be locked automatically so as to guarantee the driving safety; once the car is stopped and engine is shut off, the doors are unlocked automatically. User can choose this function is turned on or off.

7、 Auto Window : it is long distance or remote control on

windows to be opened by one push on the key.

8、 Smart Lock : it is unlock when nearing or unlock when leaving car. When the key is nearing car or to a certain distance, the car will be unlock automatically; When key is away from car for a certain distant, the car will be locked automatically.

9、 Wireless Charge: it can turn on or off the function of wireless charging.

### **Ambient Lighting Settings**

Under Vehicle Settings view, press “Ambient Lighting Settings” to enter into atmosphere lamp setup. The car atmosphere lamp is a lighting lamp for decoration purpose; it can be set on or off. The light color can be set also.

## **A/C Control Screen**

Under Main Menu view, press A/C Menu to enter into A/C function interface.

Notes:

The buttons will be different based on different model of cars.

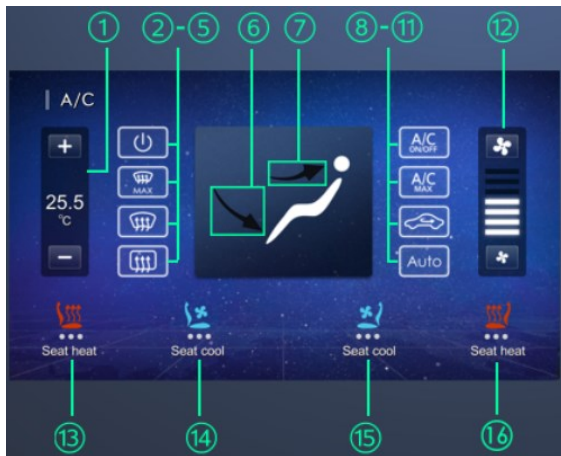

- ① Temperature regulation
- ② A/C switch
- ③ front defrost switch
- ④ rear defrost switch
- ⑤ A/C foot blowing switch
- ⑥ A/C face blowing switch
- ⑦ A/C ON/OFF switch
- ⑧ A/C MAX switch: quick A/C
- ⑨ indoor/outdoor circulation switch
- ⑩ Wind volume regulation switch
- ⑪ Auto button: Automatically A/C switch
- ⑫ Driver seat Heat Control
- ⑬ Driver Seat Cool Control
- ⑭ Passenger Seat Cool Control
- ⑮ Passenger Seat Heat Control

# RVC function (For Trend or Trend + model of cars)

RVC (Rear View Camera) is a back car assistant function which shifts to rear camera when backing the car.

Once the electric door is functioning and car shift to rear shift steadily, rear camera view and radar detected information is shown on screen.

Four areas individually are: left edge angle, left middle, right middle, right edge angle will be detected by radar. According to detect distance set, front/rear and middle detectors are shown by green, yellow, red curved line. And all edge detectors will be shown as yellow and red curved line, only the current obstacles information is detected by doctors

Radar abnormal: If one of the detectors is abnormal or send wrong signals, "rear radar abnormal" will be shown.



- ① shown of image
- ② back car assisting line
- ③ radar show

## 360° look around image (applicable for Titanium Plus model of car )

■ Turned on 360° look around image

Under the following situation, 360° look around image will be turned on.

When car gear is on R shift, 360° look around image will be turned on.

When car is not on R shift and the speed is less than 20km/h, under Main Menu or TOOL view, press [360° Camera]key to run 360° look around image.

- When "360° panorama speed down full" of Camera setting is on

and car speed is  $\geq 20\text{km/h}$ , 360° look around image is turn off, when the car speed is  $\leq 15\text{km/h}$ , 360° look around image to turn on.

■ Turned off of 360° look around image

Under the following circumstances, the 360° look around image can be turned off.

Power is shifted to non ON mode.

After entering into 360° look around image view and under non R gear, car speed is  $\geq 20\text{km/h}$

Press 360° look around image exit button and the gear is not under R shift.

The gear is from non P shift to P shift.

■ Shift between 2D and 3D mode

When under non R shift, press 360° look around image to enter into 360° look around view, 2D/3D mode and view can be shifted.

When shifting to R and entering into 360° look around image, only 2D rear view is possible, it can not be shifted to view or view angle, no exit button for 360° look around view.

■ Radar shown

Radar detection shown is overlapped on monitors, front and rear radar detection areas are: left edge angle, left middle, right middle, right edge angle. According to detect distance set, front/rear and middle detectors are shown by green, yellow, red curved line. And all edge detectors will be shown as yellow and red curved line, only the current obstacles information is detected by doctors

Radar abnormal: When rear radar is abnormal, it prompts with "rear radar abnormal; when front radar is abnormal, it prompts with "front radar abnormal: Signal abnormal or loss, it prompts with "outside system is abnormal".

## **Dashboard linkage function**

On dashboard, following image are shown: language setup, unit setup, multimedia audio play information (including Radio, Bluetooth Audio, USB, iPod, Apple CarPlay, Android Auto), Audio off, phone call connects, phone call interruption.