



A7800 Wireless Keyboard/Mouse Set Quick Guide



Thanks for your purchasing this ATake 7800 combo set! This keyboard and mouse will finally free you of the constraints of your desktop by providing a wireless connection between your keyboard/mouse and your PC. In order to enjoy the full performance of your keyboard and mouse we recommend you to read this manual carefully before the installation.



Model: AKM-5101N

2.4G Wireless Keyboard + Optical Mouse Quick Guide:

Batteries Installation(Mouse)

1. Open the battery compartment of the mouse.
2. Put 2 AAA batteries into the compartment and make sure the polarities are right, then close it carefully (Fig. 1) .
3. Close the compartment.

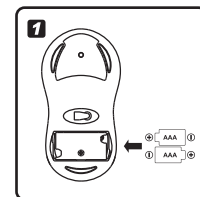

Batteries Installation(Keyboard)

1. Open the battery compartment of the keyboard.
2. Put 1 AA battery into the compartment and make sure the polarities are right, then close it carefully (Fig. 2) .
3. Close the compartment.

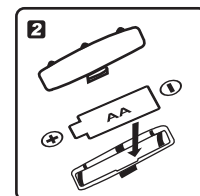

Wireless Receiver Connection

Both the keyboard mouse use 2.4GHz digital technology to wirelessly communication. They transmit radio frequency signals that are picked up by the receiver and sent to the computer. The USB receiver is connected via one of USB port of your computer.

CAUTION: Turn the computer off before the connection, and remember that working on a metallic surface will reduce the RF performance.

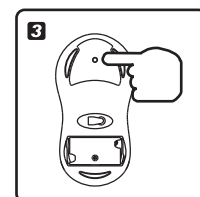

Turn ON/OFF the switch of the Optical Mouse Manually: (Fig 3.)

1. Turn ON: Press the power button once when not using the mouse for a long time.
2. Turn OFF: Press the button for 4 seconds to turn on the mouse.





A7800 Wireless Keyboard/Mouse Set Quick Guide



Turn On/Off the Power of the Optical Mouse Automatically:

Auto-sleeping mode and power-saving function will be activated if the mouse is not working within a long time. Press any key or scroll wheel to activate.

LOW POWER INDICATION

When the power is low, the intelligent power indication light on the keyboard turns to RED and starts blinking.

NOTE ON HANDLING BATTERIES

- Keep batteries out of children's reach.
- Do not mix old and new batteries or use different types of battery.
- Replace old or weak batteries promptly.
- Dispose of and recycle your old batteries in accordance with local regulations.

TROUBLE SHOOTING

If the keyboard and/or mouse doesn't work after installation:

- Make sure you've correctly connected the receiver to the computer; i.e., properly plugged in to one of the computer's USB ports.
- Make sure the batteries are installed correctly.
- Make sure the distance between the keyboard/mouse and the receiver is no more than 10 meters.

If the mouse cursor doesn't move properly, or if the keyboard doesn't allow you to type on the screen:

- Make sure the receiver isn't too far away.
- Make sure there are no large metal devices in the proximity — such as microwaves, electric stoves, televisions and hair dryers — which may be interfering the receiver's radio reception.
- Check the status of the batteries.

FCC Statement

1. This device complies with part 15 of the FCC rules.
Operation is subject to the following two conditions:
(1) This device may not cause harmful interference, and.
(2) This device must accept any interference that may cause undesired operation.
2. Changes or modifications not expressly approved by the party responsible for compliance could void the user's authority to operate the equipment.

DISCLAIMER

We made every effort to ensure that the information and procedure in this guide is accurate and complete, no liability can be accepted for any errors or omissions and reserves the right to make any changes without further notices to any products herein.



<http://www.atake.com/>
Customer Service
 +886 222214999
 service@atake.com

