



# ROADCAM AI PLUS

**4K AI Dashcam & Rear Cam Set**



BT533642

## **User Manual**

**Important, retain for future reference:  
Read carefully**



For more detailed instructions, please scan the QR code above or visit [www.letsyada.com](http://www.letsyada.com) to access the complete user manual.

# QUICK INSTALLATION GUIDE

Before you begin... Gather these items.

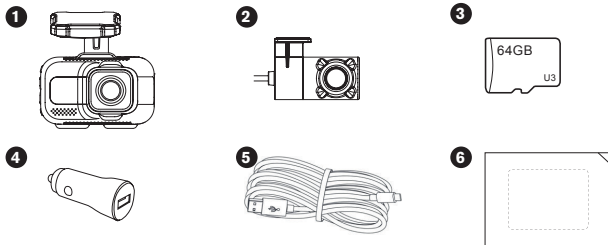

## 1. Mount the AI Dashcam

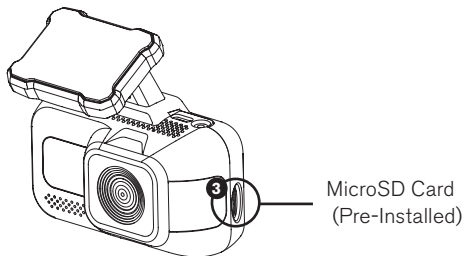

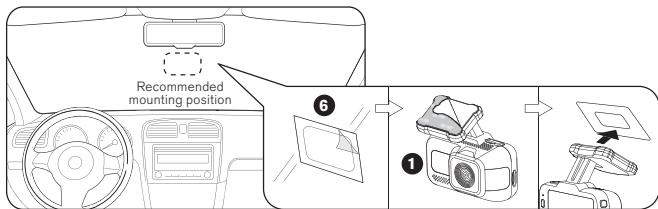

To optimize the accuracy of AI calibration, we recommend placing the Dashcam at the center of your windshield, right behind your rear view mirror.

## 2. Connect to Power

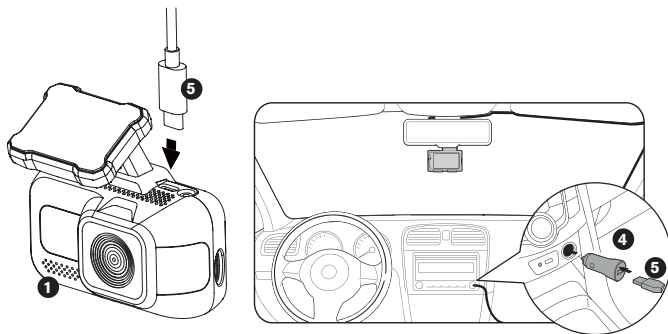

### 3. Connect the Rear Camera

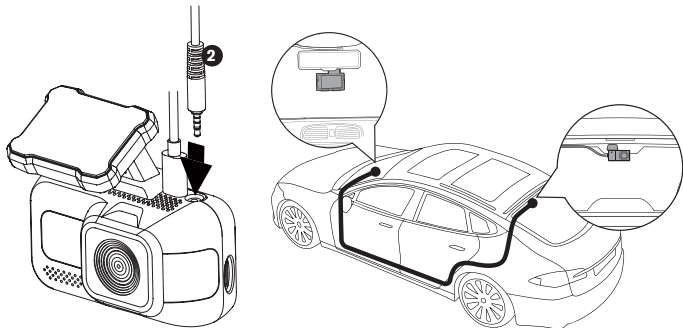

## INTRODUCTION

Please read all of the installation instructions carefully before installing the product. Improper installation will void manufacturer's warranty. The installation instructions do not apply to all types of vehicles, and are written as guidelines to assist in installing the product.

Consult an experienced technician if you are not comfortable installing the product. You can also contact YADA at **1.866.294.9244** to speak to one of our installation specialists if you have any specific questions regarding the Roadcam AI Plus.

**BEFORE using the Roadcam AI Plus, please read the safety information provided in this user manual. ALWAYS use the product as outlined in this user manual.**

Please make sure to read and understand all local laws and regulations regarding cameras and their use in a vehicle. Laws vary by state.

# PRODUCT SPECIFICATIONS

## 4K AI Dashcam

<b>Display:</b>	3 inch display
<b>Lens:</b>	125 degrees diagonal
<b>Video Resolution:</b>	4K (3840x2160), 2K (2560x1440) or FHD (1920x1080)
<b>Frequency:</b>	2.4GHz
<b>Circular Video:</b>	Seamless loop recording
<b>Memory Card:</b>	MicroSD (maximum support 512GB)
<b>Microphone:</b>	Supported
<b>Built-in Audio:</b>	Supported
<b>Operating Temperature:</b>	14°F~ 140°F (-10°C~60°C)
<b>Operating Voltage:</b>	Cigarette Lighter Adapter - DC 12/24V / DC 5.2V (USB-C)
<b>Battery:</b>	Built-in Supercapacitor
<b>Maximum Signal Range:</b>	9.84 Feet/3 Meters (without interference or obstruction)

## Rear Camera

<b>Lens:</b>	122 degrees diagonal
<b>Video Resolution:</b>	FHD (1920x1080)
<b>Operating Temperature:</b>	14°F~ 140°F (-10°C~60°C)
<b>Operating Voltage:</b>	DC 5V

# PACKAGE CONTENTS

1. 1 x 4K AI Dashcam
2. 1 x Rear Camera
3. 1 x 64GB MicroSD Card
4. 1 x 12V/24V Power Adapter
5. 1 x 11.5ft/3.5m USB-A to USB-C Power Cable
6. 1 x 3M VHB™ Double-sided Tape (Spare)
7. 1 x Electrostatic Sticker
8. 1 x Instruction Manual

**1**



**2**



**3**



**4**



**5**

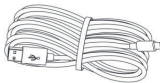

**6**



**7**



**8**

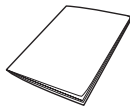

# PRODUCT OVERVIEW

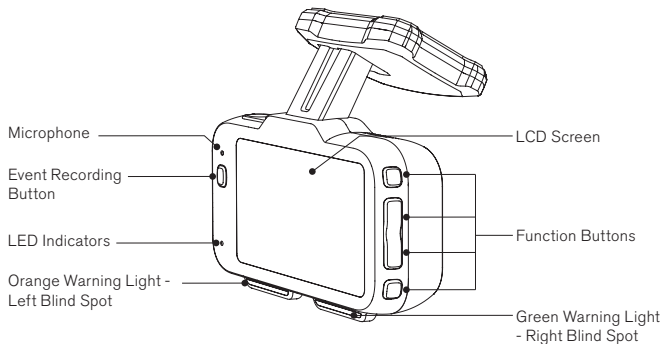
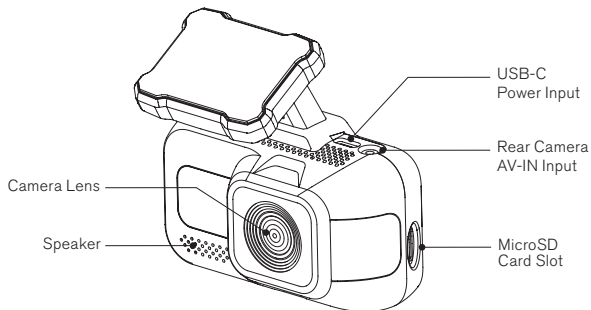



## CAMERA CONTROLS

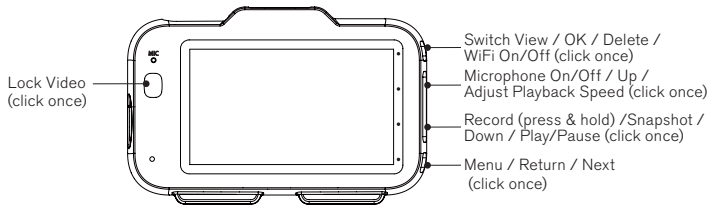

For more information about AI Dashcam operation, please refer to the e-manual on [www.letsyada.com](http://www.letsyada.com).

## CAMERA DIMENSIONS

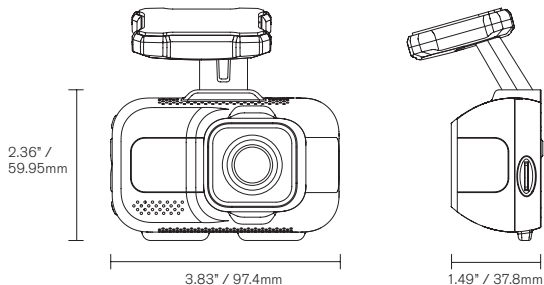

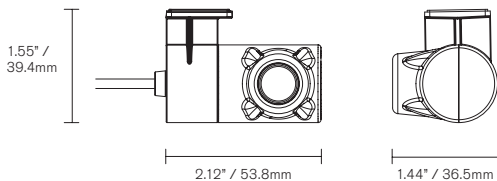

## INSTALLATION

1.

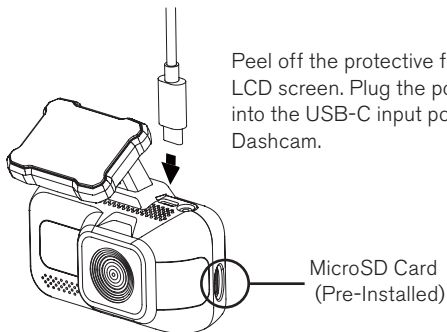

2. Attach the AI Dashcam onto the windshield:
- Apply the electrostatic sticker onto the cleaned windshield and peel off the protective film.
  - Peel off the 3M VHB™ tape backer from the Dashcam Mount and attach the Dashcam onto the center of the sticker.

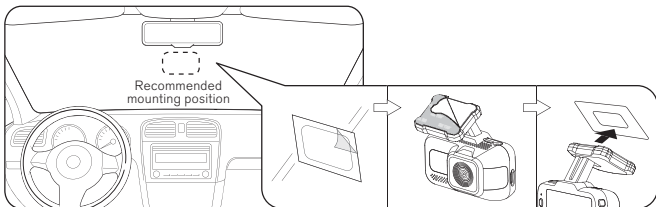

**NOTE:** To optimize the accuracy of AI calibration, we recommend placing the Dashcam at the center of your windshield, right behind your rear view mirror.

3.

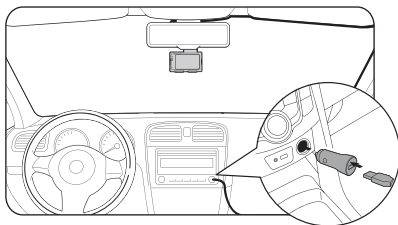

Plug the cable into the power adapter then into your 12/24V outlet (cigarette lighter).

Route and hide the power cable in the headliner and pillars in your vehicle. We recommend going through the passenger side so the cable doesn't get into the driver's way.

4. Plug the Rear Camera into the AV-IN port on the Dashcam.

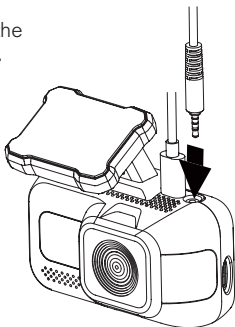

5. Mount the Rear Camera on the rear window inside your vehicle. Adjust the camera to your desired angle. Route and hide the power cable in your vehicle.

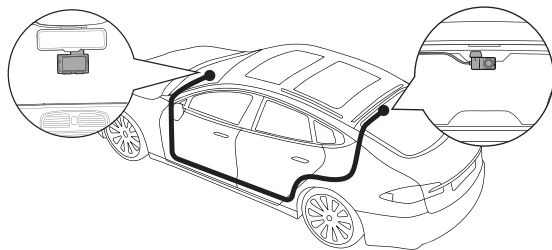

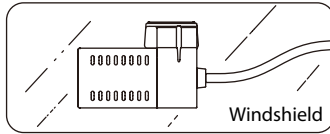

**CAUTION:** Please position the cable to the right while installing the Rear Camera to ensure proper orientation of captured images.

## DOWNLOADING THE APP



The Roadcam AI Plus auto sync function enables you to control and play back recorded media files using your smartphone with the YADA Drive APP. Scan the QR code on the right or search "YADA Drive" in the APP Store or Google Play. Download and install the APP.



Compatible with iPhone, iPad, Mac and iPod touch with iOS 11 or higher.



Compatible with devices with Android™ 7.0 or higher.

## Help / FAQs

- 1) Problem: The AI Dashcam is unable to take pictures and record videos.  
Solution: Please try formatting the MicroSD card.
- 2) Problem: The AI Dashcam shows that the memory card is full.  
Solution: Please 1) Switch the G-sensor to “Mid” or “Low”, 2) Take the MicroSD card out and clear the “Event” folder manually on your computer.
- 3) Problem: Message showing “The file is crashed” or “SD card error”  
Solution: Please format the MicroSD card. You’ll find the “Format” feature under System Setting.
- 4) Problem: The image looks foggy.  
Solution: Please try cleaning the camera lens.
- 5) Question: Can I buy my own MicroSD memory card?  
Answer: Yes, but please make sure you purchase one that is U3 rated with the max capacity of 512GB.

**NOTE:** The AI Dashcam is designed to be powered on while the vehicle is running. The built-in capacitor is only designed for storing documents when the vehicle’s engine is off. The capacity of the built-in capacitor is limited. Please connect the AI Dashcam to the vehicle’s on-board power supply for daily use.

# SAFETY INFORMATION

## IMPORTANT SAFETY INSTRUCTIONS

1. **SAVE THESE INSTRUCTIONS** – This manual contains important safety and operating instructions of the 12V/24V cigarette lighter adapter for Model BT533642.
2. Before using the product, read all instructions and cautionary markings.
3. Do not expose cigarette lighter adapter to rain, moisture, or snow.
4. Use of an attachment not recommended or sold by the product manufacturer may result in a risk of fire, electric shock, or injury to persons.
5. To reduce risk of damage to cigarette lighter connector and cord, pull by cigarette lighter connector rather than cord when disconnecting cigarette lighter adapter.
6. Make sure cord is carefully secured so that it will not be stepped on, tripped over, or otherwise subjected to damage or stress.
7. Do not operate cigarette lighter adapter with damaged cord or cigarette lighter connector – replace it immediately.
8. Do not operate cigarette lighter adapter if it has received a sharp blow, been dropped, or otherwise damaged in any way; take it to a qualified serviceperson.
9. Do not disassemble cigarette lighter adapter; take it to a qualified serviceperson when service or repair is required. Incorrect reassembly may result in a risk of electric shock or fire.
10. To reduce risk of electric shock, unplug cigarette lighter adapter before attempting any maintenance or cleaning. Turning off controls will not reduce this risk.

**WARNING:** A failure to read and follow these warnings and instructions may result in a serious accident, including damaged property or a serious injury, including loss of life.

- The AI Dashcam and Rear Cam are designed as an aid to the driver in detecting large stationary objects to help avoid damaging the vehicle. However, you, the driver, must use it safely and properly. Use of the AI Dashcam and Rear Cam is not a substitute for safe, proper and legal driving.
- Never depend on the AI Dashcam and Rear Cam entirely when driving and backing up. The image on the screen is different from actual conditions. Objects viewed in the AI Dashcam display screen differ from actual distance because a wide-angle lens is used.
- If you use Rear Camera, never back up while looking only at the screen. You should always check behind and around the vehicle when backing up just as you would if the vehicle did not have the Rear Camera. Always make sure your intended path is clear. If you back up while looking only at the monitor, you may hit a vehicle, pedestrian, bicyclist, child, pet or other object resulting in injury or death. Always back up slowly.
- The area displayed by the AI Dashcam and Rear Cam is limited. The AI Dashcam does not display objects that are out of the AI Dashcam's field of view. The area displayed on the screen may vary according to vehicle orientation or road conditions. The Rear Camera does not display objects that are close to or below the bumper, underneath the vehicle, or objects out of the camera's field of view. The area displayed on the screen may vary according to vehicle orientation or road conditions.
- Be sure to check the camera's position and mounting angle before each use.
- Do not strike the AI Dashcam and Rear Cam. They are precision instruments. Otherwise, they may malfunction or cause damage resulting in a fire or an electric shock.



- This product will only provide images of items that are within the field of view of the AI Dashcam and Rear Cam. Thus, it is imperative that the AI Dashcam and Rear Cam should be kept clean and unobstructed.
- Adhere to all applicable traffic laws and motor vehicle regulations applicable to the device.
- Consult local laws and regulations for any restrictions on installation or use.
- Never allow children to play with the device. Small parts may be a choking hazard.
- There is a plastic cover over the AI Dashcam and Rear Cam. Do not scratch the cover when cleaning dirt or snow from it.
- If the temperature changes rapidly, the system may not operate normally.
- If you replace the tires, the area displayed on the monitor may change and you may need to adjust the camera.
- When strong light directly enters a camera, objects may not be displayed clearly.
- The screen may flicker under fluorescent light.
- The colors of objects on the AI Dashcam may differ from those of the actual objects.
- Do not use alcohol or thinner to clean the camera. This will cause discoloration. To clean the camera, wipe with a clean cloth dampened with mild cleaner diluted with water and then wipe with a dry cloth.

## **Safety Around and Behind Other Vehicles**

Using AI Dashcam and Rear Cam is not enough to completely overcome a vehicle's blind spot. Many preventable injuries and deaths occur in driveways or parking lots when drivers do not see children, pets, or others near their vehicles. Here are a few safety tips that will help you to avoid an accident:

- Walk completely around your vehicle before getting in. Check for kids,

toys, and pets before entering the vehicle and starting the engine.

- Know where children are. Have children stand in a place where they are in full view.
- Be aware of young children. Young children are small and hard to see.
- Parents, caregivers and all adults need to be vigilant in supervising children, especially when children are in the yard, driveway or parking lot playing near parked cars.
- Roll down your window so you will be able to hear what is happening outside your vehicle.
- Owners of SUVs, trucks, and vans need to take extra care to avoid hitting or running over a child.
- Teach children to move away from a vehicle whenever it is started.

## **MAINTENANCE & WARRANTY**

### **Cleaning**

- If dirt, rain or snow attaches to the camera, the display screen may not clearly display objects. If water droplets, snow or mud adhere to the camera lens, rinse with water and wipe with a dry cloth.
- Do not use alcohol, benzene or thinner to clean the camera. This will cause discoloration. To clean the camera, wipe with a clean cloth dampened with mild cleaner diluted with water and then wipe with a dry cloth.

### **Warranty**

#### **YADA LIMITED WARRANTY**

YADA warrants, to the original purchaser, that its products are free from defects in material and workmanship for 1 year from the date of original purchase. Where permitted by law, YADA's liability shall be limited to that set

forth in this limited express warranty. This limited express warranty shall be the exclusive remedy of the purchaser and YADA makes no other warranty of any kind aside from the limited express warranty stated above.

**NOTE:** Warranty only applies for North American customers of purchases made in North America.

### **CONDITIONS OF WARRANTY**

If during the 1 year warranty period your new product is found to be defective, YADA will repair such defect, or replace the product, without charge for parts or labor subject to the following conditions:

1. All repairs must be performed by YADA.
2. All warranty claims must be accompanied by a copy of the sales receipt or bill of sale.
3. The equipment must not have been altered or damaged through negligence, accident, improper operation, or failure to follow the product instructions for installation, use, or care.
4. The replacement of parts is excluded from the warranty when replacement is necessary due to normal wear and tear.
5. Repair or replacement parts supplied by YADA under this warranty are protected only for the unexpired portion of the original warranty.
6. This is a "repair or replace" warranty only, and does not cover the costs incurred for the installation, removal or reinstallation of the product, or damage to any mobile phone device or vehicle.

## **OWNER'S RESPONSIBILITIES:**

YADA will make every effort to provide warranty service within a reasonable period of time. SHOULD YOU HAVE ANY QUESTIONS ABOUT SERVICE RECEIVED OR IF YOU WOULD LIKE ASSISTANCE IN OBTAINING SERVICE, PLEASE CALL TOLL FREE 1.866.294.9244 DURING REGULAR BUSINESS HOURS MONDAY THROUGH FRIDAY 8:00 AM TO 5:00PM.

**NOTE:** Toll Free # is for North America Customers ONLY. See Customer service section for customer contact numbers for other regions/offices.

For customer service and technical support, please call us at 1.866.294.9244. If at that time it is determined that a replacement unit is needed, the support representative will issue a Return Authorization and instruct on how to get a new unit. YADA makes no other warranty of any kind aside from the limited express warranty stated herein.

DISCLAIMER OF WARRANTIES, INCLUDING WARRANTY OF MERCHANTABILITY AND WARRANTY OF FITNESS FOR PARTICULAR PURPOSE: EXCEPT AS SPECIFICALLY SET FORTH HEREIN, NO WARRANTY OR REPRESENTATION, EXPRESS OR IMPLIED, IS MADE AS TO THE ROADCAM AI PLUS. EXCEPT AS EXPRESSLY SET FORTH HEREIN, YADA AND/OR ITS AFFILIATES EXPRESSLY DISCLAIMS, WITHOUT LIMITATION, ANY STATUTORY WARRANTIES AND ALL IMPLIED WARRANTIES, INCLUDING ANY IMPLIED WARRANTY OF MERCHANTABILITY OR FITNESS FOR A PARTICULAR PURPOSE.

YADA and/or its affiliates do not guarantee or promise that the user of Roadcam AI Plus will not be in an accident or otherwise not collide with an object and/or person. Our Roadcam AI Plus is not intended in any way to be

a substitute for careful and cautious driving or for the consistent adherence to all applicable traffic laws and motor vehicle safety regulations.

The Roadcam AI Plus is not intended to be a substitute for rearview mirrors or for any other motor vehicle equipment mandated by law. Even when properly installed, our Roadcam AI Plus has a limited field of vision and does not provide a comprehensive view of the rear area of the vehicle.

YADA and/or its affiliates are not responsible for a user's intended or actual use of the Roadcam AI Plus. In no event shall YADA and/ or its affiliates have any liability for any losses (whether direct or indirect, in contract, tort or otherwise) incurred in connection with the Roadcam AI Plus, including but not limited to damaged property, personal injury and/or loss of life. Neither shall YADA and/or its affiliates have any liability for any decision, action or inaction taken by any person in reliance on the Roadcam AI Plus, or for any delays, inaccuracies and/or errors in connection with the Roadcam AI Plus and its functioning.

YADA and/or its affiliates shall have no responsibility or liability for damage and/or injury resulting from accidents occurring with vehicles having the installed, and YADA and/or its affiliates, the manufacturer, distributor and seller shall not be liable for any injury, loss or damage, incidental or consequential, arising out of the use or intended use of the product.

# GENERAL INFORMATION

## Customer Service/Contact

IF YOU ARE EXPERIENCING ANY ISSUES WITH THE PRODUCT DURING OPERATION, DO NOT RETURN THE PRODUCT TO THE STORE. CONTACT YADA DIRECTLY FOR INSTRUCTIONS ON HOW TO RETURN/EXCHANGE THE PRODUCT.

FCC Compliance Statement:

This device complies with Part 15 of the FCC rules. Operation is subject to the following two conditions: (1) This device may not cause harmful interference, and (2) this device must accept any interference received, including interference that may cause undesired operation.

**WARNING:** Changes or modifications to this unit not expressly approved by the party responsible for compliance could void the user's authority to operate the equipment. The manufacturer is not responsible for any radio or TV interference caused by unauthorized modifications or change to this equipment. Such modifications or change could void the user's authority to operate the equipment.

**NOTE:** This equipment has been tested and found to comply with the limits for a Class B digital device, pursuant to part 15 of the FCC Rules. These limits are designed to provide reasonable protection against harmful interference in a residential installation. This equipment generates, uses and can radiate radio frequency energy and, if not installed and used in accordance with the instructions, may cause harmful interference to radio communications. However, there is no guarantee that interference will not occur in a particular installation. If this equipment does cause harmful  
22 interference to radio or television reception, which can be determined by

turning the equipment off and on, the user is encouraged to try to correct the interference by one or more of the following measures:

- Reorient or relocate the receiving antenna.
- Increase the separation between the equipment and the receiver.
- Connect the equipment into an outlet on a circuit different from that to which the receiver is connected.
- Consult the dealer or an experienced radio/TV technician for help.

This equipment complies with FCC RF radiation exposure limits set forth for an uncontrolled environment. In order to avoid the possibility of exceeding the FCC radio frequency exposure limits, human proximity to the antenna shall not be less than 20cm during normal operation.

**⚠ WARNING:** This product can expose you to chemicals including Di(2-ethylhexyl)phthalate (DEHP) and Diisononyl Phthalate (DINP), which are known to the State of California to cause cancer and birth defects or other reproductive harm.  
For more information go to [www.P65Warnings.ca.gov](http://www.P65Warnings.ca.gov).

3M VHB™ is a trademark of 3M Company.

Android is a trademark of Google Inc.

iPhone, iPad, Mac and iPod touch are trademarks of Apple Inc.

Roadcam AI Plus

4K AI Dashcam & Rear Cam Set

BT533642

Responsible Party:

YADA

2975 Red Hill Ave., Ste. 100,

Costa Mesa, CA 92626

Tel: 1.866.294.9244

## NOTES



# NOTES

## NOTES



**Product code / Code de produit / Código del producto : BT533642**

Register this product within 30 days of purchase to receive one **(1) additional year** of warranty coverage (beyond the standard 1-year warranty), along with special product offers and announcements.

Enregistrez ce produit dans les 30 jours suivant l'achat pour recevoir une couverture **supplémentaire de 1 AN** (au-delà de la garantie standard d'un an), ainsi que des offres et des annonces spéciales.

Registre este producto dentro de los 30 días siguientes a la compra para recibir un **(1) año adicional** de cobertura de garantía (más allá de la garantía estándar de un año), junto con ofertas de productos y anuncios especiales.

[www.letsyada.com/register](http://www.letsyada.com/register)



@letsyada



Please contact our customer service before returning this product to the store. Our friendly representatives are happy to help with any questions or concerns you have.

Veuillez communiquer avec notre service à la clientèle avant de retourner le produit au magasin. Nos représentants se feront un plaisir de vous assister pour toute question ou préoccupation.

Póngase en contacto con nuestro servicio a clientes antes de regresar este producto a la tienda. A nuestros amables representantes les dará mucho gusto ayudarle con cualquier pregunta o inquietud que tenga.

**Mon-Fri, 8am-5pm PST / Lundi au vendredi, 8h à 17h HNP /  
Lun-vie, 8 a. m. a 5 p. m. Hora del Pacífico  
customercare@horizon-brands.com / 1.866.294.9244**



CONNECT  
WITH US



@letsyada

2975 Red Hill Ave., Ste. 100, Costa Mesa, CA 92626  
1.866.294.9244 | [customercare@horizon-brands.com](mailto:customercare@horizon-brands.com)

© 2023 ADC Solutions Auto, LLC.

[www.letsyada.com](http://www.letsyada.com)

ML-533642\_V1

Product Label Information can be accessed at **Regulatory Info** page as follows.

Starting from Main Menu:

Step 1. Open Settings Menu

Step 2. Go to System Setting

Step 3. Go to Regulatory Info

