

1080P Solar Powered App View Backup Camera

WP ITM. BT57799
Care & Use Instructions

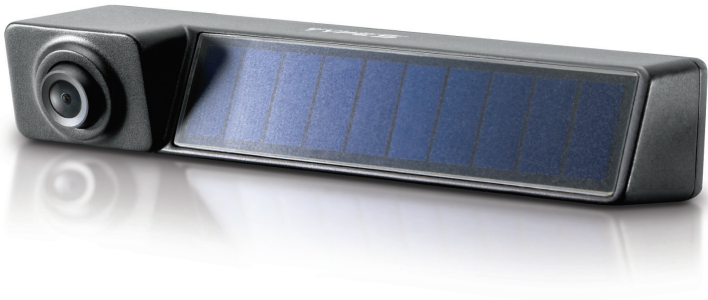

**Important, retain for future reference:
Read carefully**

TABLE OF CONTENTS

1. Introduction	1
2. Package Contents	2
3. Product Specifications	3
4. Product Overview	3
5. Camera Status & LED Indicators.....	4
6. Before You Install.....	4
7. APP Installation.....	5
8. Pairing the camera.....	6
9. Installation Guide	8
10. Settings and Operation	12
11. Safety Information	14
12. Maintenance & Warranty	17
13. General Information	20

1. INTRODUCTION

Please read all of the installation instructions carefully before installing the product. Improper installation will void manufacturer's warranty. The installation instructions do not apply to all types of vehicles, and are written as guidelines to assist in installing the system.

Consult an experienced technician if you are not comfortable installing the product. You can also contact TYPE S at **866.294.9244** to speak to one of our installation specialists if you have any specific questions regarding the Wireless Backup Camera.

BEFORE using the Wireless Backup Camera - Solar Powered 1080P App View, please read the safety information provided in this user manual. ALWAYS use the product as outlined in this user manual.

Please make sure to read and understand all local laws and regulations regarding cameras and their use in a vehicle. Laws vary by state.

2. PACKAGE CONTENTS

- 1 x App View Camera
- 1 x MicroUSB Charging / Data Cable
- 1 x Screw Mount Kit
 - 1x US Mounting Plate
 - 2 x Two Way Mounting Tab (Optional)
 - 2 x Mounting Screw & Nut (Optional)
 - 2 x License Plate Machine Screw (Optional)
 - 2 x License Plate Self-Tapping Screw (Optional)
 - 8 x Mounting Screw
- 1 x Adhesive Mount Kit
 - 1x International Mounting Plate
- 1 x Quick Install Guide
- 1 x User Manual

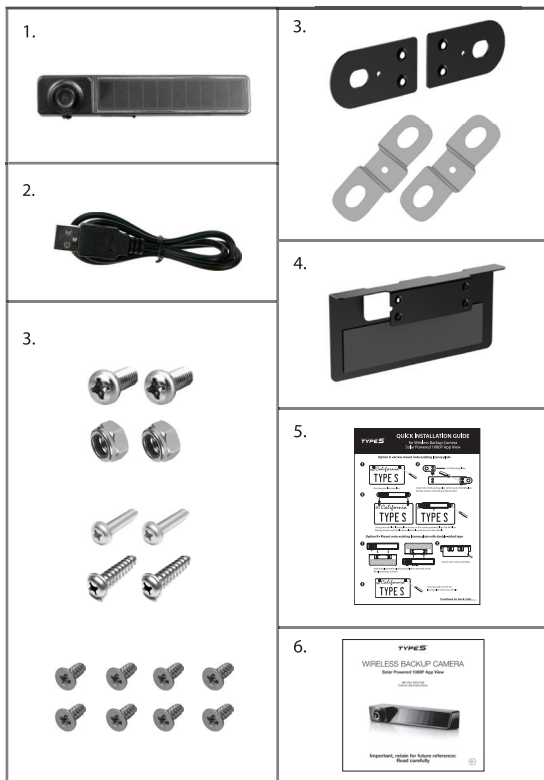

3. PRODUCT SPECIFICATIONS

Frequency:	2.4 GHz
Operating Voltage:	DC 5V
Operating Temperature:	14°F~122°F (-10°C~50°C)
Camera Water Resistance:	IP67 Rating
Battery Capacity:	2500mAh (Minimum Capacity 2400mAh)
Maximum Signal Range:	33 Feet / 10 Meters (without interference or obstruction)

4. PRODUCT OVERVIEW

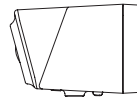
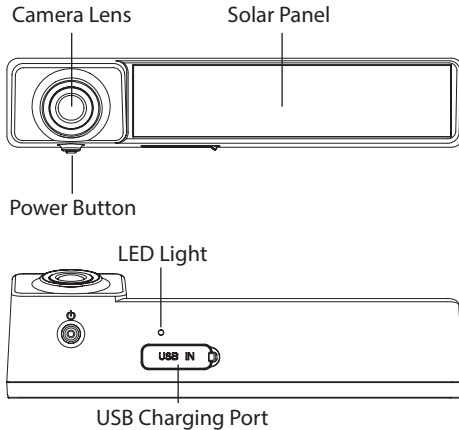

5. CAMERA STATUS & LED INDICATORS

Power / Mode Status	LED Indicators
Power On Press and hold the power button until you see the blue LED light flashes and then release.	Blue LED light flashes twice.
Power Off Press and hold the power button for more than 2 seconds and then release.	Red LED light flashes once.
Reset password While the Backup Camera is on, press and hold the power button for more than 5 seconds and then release.	Blue LED light flashes 5 times.
Low Voltage Protection	Red LED flashes continuously.

6. BEFORE YOU INSTALL

Please charge, pair, and test the Wireless Backup Camera with the TYPE S Drive App before you install on your vehicle.

NOTE: The camera should come with at least 90% battery charge. We recommend to charge for 5-6 hours prior to use to ensure maximum performance.

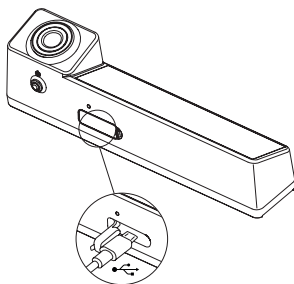

CHARGING THE WIRELESS BACKUP CAMERA

Fold back camera power port plug and insert included charging cable. Most AC USB wall adapters will work with the USB charging cable.

7. APP INSTALLATION

Install TYPE S DRIVE APP on your smart phone. Scan below QR code or search for the TYPE S DRIVE APP in the APP Store or Google Play.



Compatible with iPhone 4s & higher, iPad3, iPad Mini, iPad Air & higher, and iPod touch 5th Generation & higher. Requires iOS 9.0 or higher.



Compatible with phones with Android™ 5.0 or higher.

Once installed, open the APP and begin enjoying your TYPE S Drive APP.

8. PAIRING THE CAMERA

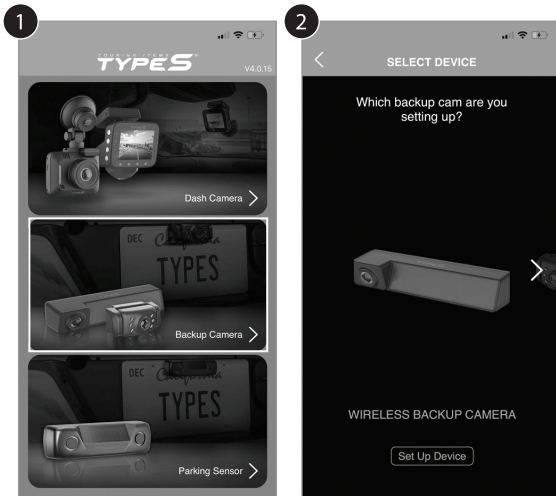

1. Open the TYPE S Drive APP and select the Backup Camera category.

NOTE: Please turn on Bluetooth of your smart device before pairing.

2. Select Wireless Backup Camera from the list of backup cameras. The App will switch to the live view screen. An image from the camera will not be seen until the pairing process is complete (Step #8).

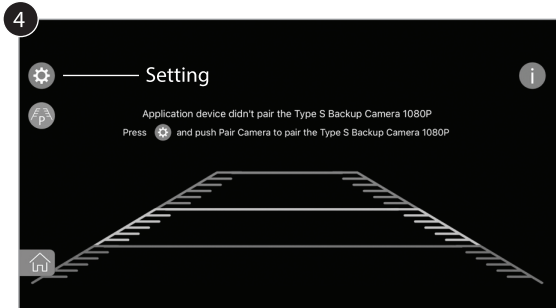
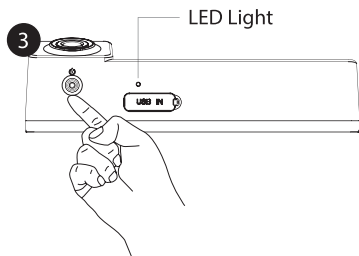

3. Press and hold the Power Button on the Wireless Backup Camera until the blue LED light flashes 2 times.
4. On the Wireless Backup Camera live view screen tap the **Setting** icon.

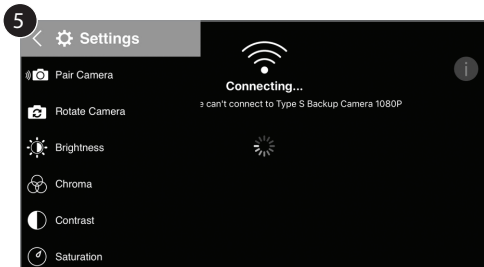

5. Tap **Pair Camera**.
6. Tap the **Connect** icon to pair with the camera.
7. Follow the on-screen instructions and assign a new password for the camera.
8. Tap **Join** when the APP prompts you to join the Backup Camera's WiFi network.
9. You should see the live view.

NOTE: No matter you close or push the APP to the background, the APP will switch back to live view automatically everytime you open the APP again.

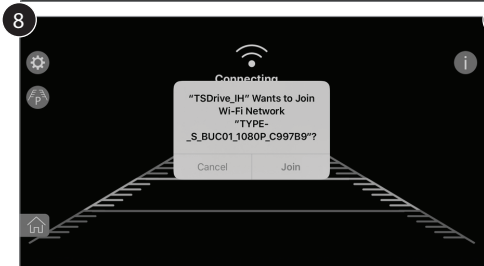
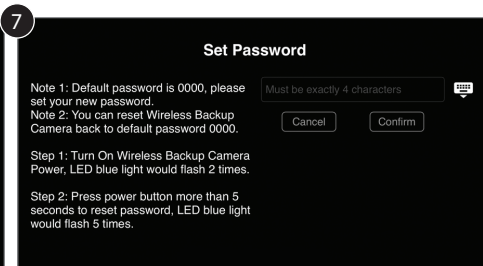
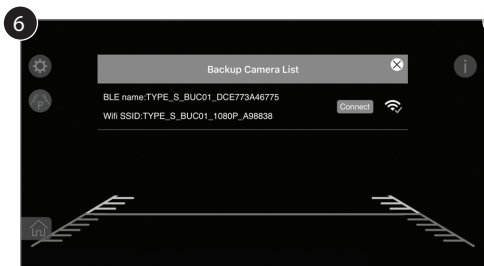

9. INSTALLATION GUIDE

OPTION A - SCREW MOUNT ONTO EXISTING LICENSE PLATE



1. Unscrew your license plate.

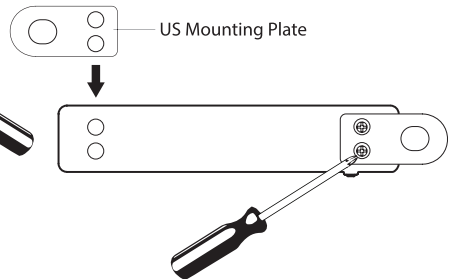

2. Attach the US Mounting plate to the back of the Wireless Backup Camera with the provided screws.

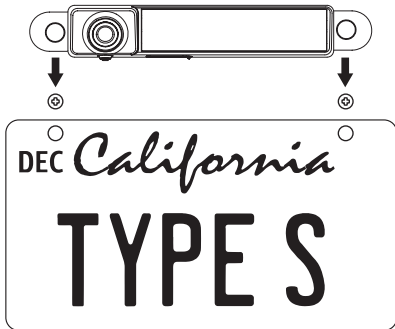

3. Using your vehicle's license plate screws, or the screws provided, align the Wireless Backup Camera with the license plate holes and secure to the vehicle.

OPTION B - MOUNT ONTO EXISTING LICENSE PLATE WITH DOUBLE-SIDED TAPE

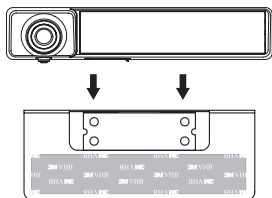

OR

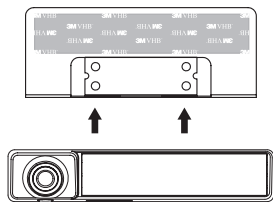

1. Attach the International Mounting Plate to the back of the Wireless Backup Camera.

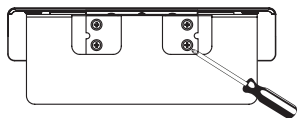

2. Secure with screws provided.



3. Unscrew and remove the license plate from your vehicle.

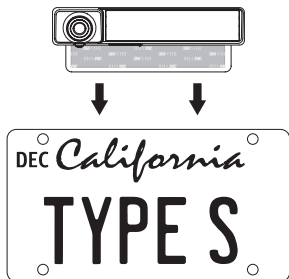

OR

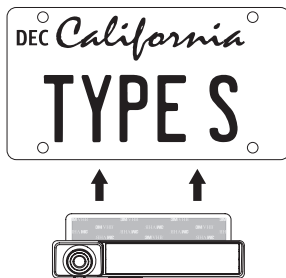

4. Peel off the cover of the double-sided tape from the International Mounting Plate, and attach the license plate to the Wireless Backup Camera.

RECOMMENDATION
Thoroughly clean & dry the mounting surface area of the license plate before attaching.



5. Secure the license plate with the attached Wireless Backup Camera to the vehicle.

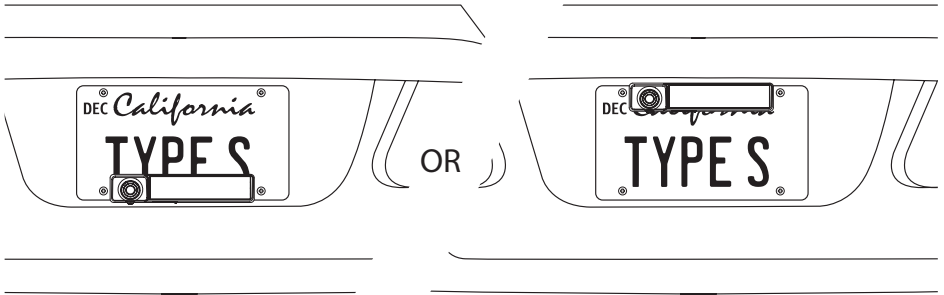

OPTION C - LOWERING INSTALLATION – FOR VEHICLES WITH TRUNK OR HATCH DOOR RELEASE

(This allows more clearance for finger tips to release door latch)

1. Unscrew and remove the license plate from your vehicle.

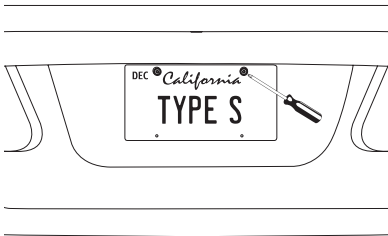

3. Secure the Two Way Mounting Tabs to the vehicle using the vehicle's license plate screws.

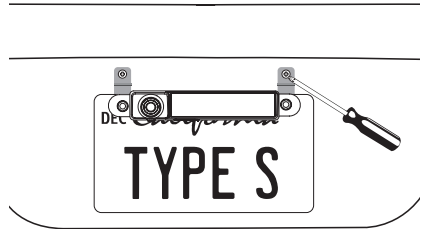

2. Place the Two Way Mounting Tabs behind the license plate. Insert the Mounting nuts through the Wireless Backup Camera mount holes and tighten with a wrench. Reference the Assembly Reference Example.

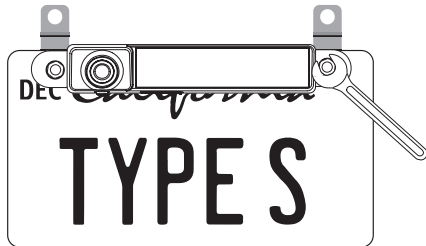

Assembly Reference:

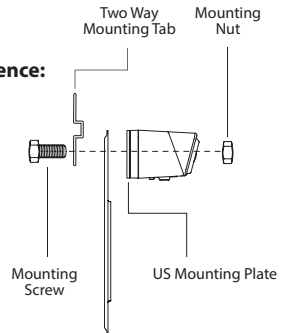

10. SETTINGS AND OPERATION

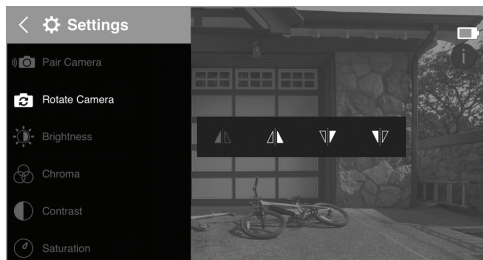

ROTATE CAMERA

Tap on the setting to reverse the camera view.

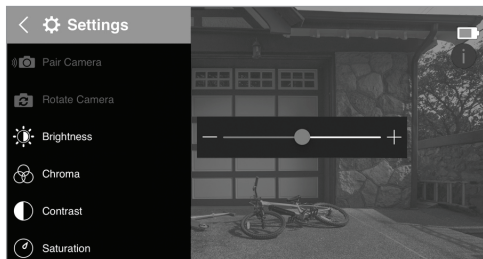

BRIGHTNESS

Swipe to adjust screen brightness.

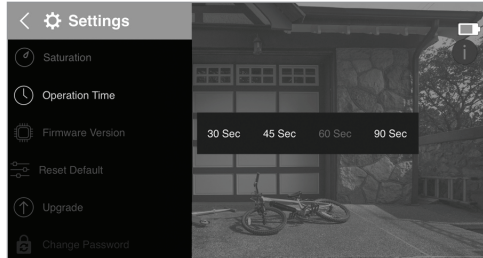

CHROMA

Swipe to adjust screen chroma.

CONTRAST

Swipe to adjust screen contrast.

SATURATION

Swipe to adjust screen saturation.

OPERATION TIME

Tap to choose a different operation time. The Wireless Backup Camera's parking view operation time will start to count down when you wake up the Wireless Backup Camera. When the timer runs out, the parking view will automatically switch to stand-by mode.

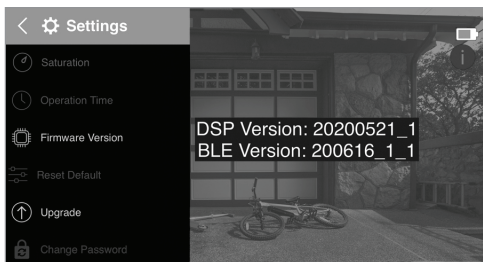

FIRMWARE VERSION

Tap to check the Backup Camera's firmware version.

UPGRADE

Tap to upgrade the Backup Camera's firmware to the latest version through the APP:

NOTE: - Keep your smart device connected to WiFi in order to download the firmware.
- Make sure the APP is paired and connected to the camera prior to the upgrade.

1. Tap **Start update** to begin.
2. After the upgrade is done, the APP will switch back to the live view.

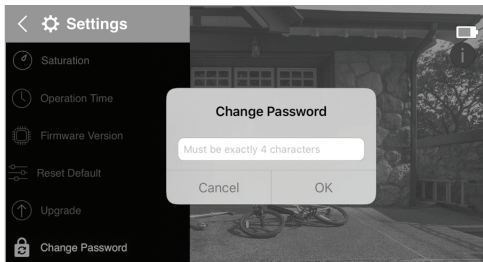
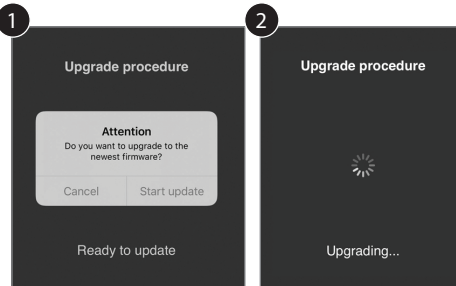
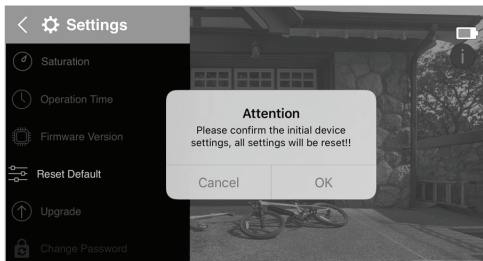

RESET DEFAULT

Tap to clear all the camera settings.

CHANGE PASSWORD

Tap to change the Backup Camera's pairing password.

11. SAFETY INFORMATION

IMPORTANT SAFETY INSTRUCTIONS

1. SAVE THESE INSTRUCTIONS– This manual contains important safety and operating instructions of Model BT57799.
2. Before using the product, read all instructions and cautionary markings.
3. Use of an attachment not recommended or sold by the product manufacturer may result in a risk of fire, electric shock, or injury to persons.
4. Do not disassemble the Wireless Backup Camera; take it to a qualified serviceperson when service or repair is required. Incorrect reassembly may result in a risk of electric shock or fire.

WARNING: A failure to read and follow these warnings and instructions may result in a serious accident, including damaged property or a serious injury, including loss of life.

- The Wireless Backup Camera is designed as an aid to the driver in detecting large stationary objects to help avoid damaging the vehicle. However, you, the driver, must use it safely and properly. Use of the Wireless Backup Camera is not a substitute for safe, proper and legal driving.
- Never back up while looking only at the screen. You should always check behind and around the vehicle when backing up just as you would if the vehicle did not have the Wireless Backup Camera. Always make sure your intended path is clear. If you back up while looking only at the APP screen, you may hit a vehicle, pedestrian, bicyclist, child, pet or other object resulting in injury or death. Always back up slowly.
- Never depend on the Wireless Backup Camera entirely when backing up. The image on the screen is different from actual conditions. Objects viewed in the APP screen differ from actual distance because a wide-angle lens is used. Objects in the APP screen will appear visually opposite than when viewed in the rear view and outside mirrors. Use the inside mirror or glance over your shoulder to properly judge distances to other objects.
- The area displayed by the Wireless Backup Camera is limited. The Wireless Backup Camera does not display objects that are close to or below the bumper, underneath the vehicle, or objects out of the Camera's field of view. The area displayed on the screen may vary according to vehicle orientation or road conditions.
- Be sure to check the Camera's position and mounting angle before each use.
- Make sure the trunk, hatch, or backdoor is completely and securely closed when backing up.
- If the back of the vehicle is hit, the position and mounting angle of the Wireless Backup Camera

may change.

- When washing the vehicle with high pressure water, be sure not to spray it around the Wireless Backup Camera. Otherwise, water may enter the Camera unit causing water condensation on the lens, a malfunction, fire or an electric shock.
- Do not strike the Wireless Backup Camera. It is a precision instrument. Otherwise, it may malfunction or cause damage resulting in a fire or an electric shock.
- This product will only provide images of items that are within the field of view of the Wireless Backup Camera. Thus, it is imperative that the Wireless Backup Camera should be kept clean and unobstructed, and should be mounted so that its field of view includes the entire area behind your vehicle.
- Adhere to all applicable traffic laws and motor vehicle regulations applicable to the device.
- Consult local laws and regulations for any restrictions on installation or use.
- Never allow children to play with the device. Small parts may be a choking hazard.
- There is a plastic cover over the Wireless Backup Camera. Do not scratch the cover when cleaning dirt or snow from the cover.
- The Wireless Backup Camera has a water resistant construction. Do not detach, disassemble or modify it. This may cause incorrect operation. Wireless Backup Camera is waterproof.
- Do not submerge Wireless Backup Camera in water, which can cause internal damage to the Camera.
- If the temperature changes rapidly, such as when hot water is poured on the vehicle in cold weather, the system may not operate normally. The Digital Camera can withstand the effects of rain, snow, and inclement weather.
- When strong light directly enters a camera, objects may not be displayed clearly.
- The screen may flicker under fluorescent light.
- The colors of objects on the APP screen may differ somewhat from those of the actual object.
- If dirt, rain or snow attaches to the Camera, the APP screen may not clearly display objects. If water droplets, snow or mud adhere to the Camera lens, rinse with water and wipe with a dry cloth.
- Do not use alcohol, benzene or thinner to clean the Camera. This will cause discoloration. To clean the Camera, wipe with a clean cloth dampened with mild cleaner diluted with water and then wipe with a dry cloth.

- Will work up to 33 feet.
- ALWAYS engage Parking/Emergency/Hand Brakes of the vehicle when testing the system.

SAFETY AROUND AND BEHIND OTHER VEHICLES

Using a Wireless Backup Camera is not enough to completely overcome a vehicle's blind spot. Many preventable injuries and deaths occur in driveways or parking lots when drivers do not see children, pets, or others near their vehicles. Here are a few safety tips that will help you to avoid a back-over accident:

- Walk completely around your vehicle before getting in. Check for kids, toys, and pets before entering the vehicle and starting the engine.
- Know where children are. Have children stand in a place where they are in full view.
- Be aware of young children. Young children are small and hard to see.
- Parents, caregivers and all adults need to be vigilant in supervising children, especially when children are in the yard, driveway or parking lot playing near parked cars.
- Roll down your window so you will be able to hear what is happening outside your vehicle.
- Owners of SUVs, trucks, and vans need to take extra care to avoid hitting or running over a child.
- Teach children to move away from a vehicle whenever it is started.

12. MAINTENANCE & WARRANTY

CLEANING

- If dirt, rain or snow attaches to the Camera, the APP screen may not clearly display objects. If water droplets, snow or mud adhere to the Camera lens, rinse with water and wipe with a dry cloth.
- Do not use alcohol, benzene or thinner to clean the Camera. This will cause discoloration. To clean the Camera, wipe with a clean cloth dampened with mild cleaner diluted with water and then wipe with a dry cloth.

WARRANTY

- **TYPE S LIMITED WARRANTY**

TYPE S warrants, to the original purchaser, that its products are free from defects in material and workmanship for 1 year from the date of original purchase. Where permitted by law, TYPE S liability shall be limited to that set forth in this limited express warranty. This limited express warranty shall be the exclusive remedy of the purchaser and TYPE S makes no other warranty of any kind aside from the limited express warranty stated above.

NOTE: Warranty only applies for North American customers of purchases made in North America.

CONDITIONS OF WARRANTY

If during the 1 year warranty period your new product is found to be defective, TYPE S will repair such defect, or replace the product, without charge for parts or labor subject to the following conditions:

1. All repairs must be performed by TYPE S.
2. All warranty claims must be accompanied by a copy of the sales receipt or bill of sale.
3. The equipment must not have been altered or damaged through negligence, accident, improper operation, or failure to follow the product instructions for installation, use, or care.
4. The replacement of parts is excluded from the warranty when replacement is necessary due to normal wear and tear.

5. Repair or replacement parts supplied by TYPE S under this warranty are protected only for the unexpired portion of the original warranty.
6. This is a “repair or replace” warranty only, and does not cover the costs incurred for the installation, removal or reinstallation of the product, or damage to any mobile phone device or vehicle.

OWNER'S RESPONSIBILITIES:

TYPE S will make every effort to provide warranty service within a reasonable period of time. SHOULD YOU HAVE ANY QUESTIONS ABOUT SERVICE RECEIVED OR IF YOU WOULD LIKE ASSISTANCE IN OBTAINING SERVICE, PLEASE CALL TOLL FREE 1.866.294.9244 DURING REGULAR BUSINESS HOURS MONDAY THROUGH FRIDAY 8:00 AM TO 5:00 PM.

NOTE: Toll Free # is for North America Customers ONLY. See Customer service section for customer contact numbers for other regions/offices.

For customer service and technical support, please call us at 1.866.294.9244. If at that time it is determined that a replacement unit is needed, the support representative will issue a Return Authorization and instruct on how to get a new unit. TYPE S makes no other warranty of any kind aside from the limited express warranty stated herein.

DISCLAIMER OF WARRANTIES, INCLUDING WARRANTY OF MERCHANTABILITY AND WARRANTY OF FITNESS FOR PARTICULAR PURPOSE: EXCEPT AS SPECIFICALLY SET FORTH HEREIN, NO WARRANTY OR REPRESENTATION, EXPRESS OR IMPLIED, IS MADE AS TO THE WIRELESS BACKUP CAMERA. EXCEPT AS EXPRESSLY SET FORTH HEREIN, TYPE S AND/OR ITS AFFILIATES EXPRESSLY DISCLAIMS, WITHOUT LIMITATION, ANY STATUTORY WARRANTIES AND ALL IMPLIED WARRANTIES, INCLUDING ANY IMPLIED WARRANTY OF MERCHANTABILITY OR FITNESS FOR A PARTICULAR PURPOSE.

TYPE S and/or its affiliates do not guarantee or promise that the user of Wireless Backup Camera will not be in an accident or otherwise not collide with an object and/or person. Our Wireless Backup Camera is not intended in any way to be a substitute for careful and cautious driving or for

the consistent adherence to all applicable traffic laws and motor vehicle safety regulations.

The Wireless Backup Camera is not intended to be a substitute for rearview mirrors or for any other motor vehicle equipment mandated by law. Even when properly installed, our Wireless Backup Camera has a limited field of vision and does not provide a comprehensive view of the rear area of the vehicle. You should always look around outside your vehicle and use your mirrors to confirm rearward clearance and that your vehicle can back up safely.

TYPE S and/or its affiliates are not responsible for a user's intended or actual use of the Wireless Backup Camera. In no event shall TYPE S and/or its affiliates have any liability for any losses (whether direct or indirect, in contract, tort or otherwise) incurred in connection with the Wireless Backup Camera, including but not limited to damaged property, personal injury and/or loss of life. Neither shall TYPE S and/or its affiliates have any liability for any decision, action or inaction taken by any person in reliance on the Wireless Backup Camera, or for any delays, inaccuracies and /or errors in connection with the Wireless Backup Camera and its functioning.

TYPE S and/or its affiliates shall have no responsibility or liability for damage and/or injury resulting from accidents occurring with vehicles having the installed, and TYPE S and/or its affiliates, the manufacturer, distributor and seller shall not be liable for any injury, loss or damage, incidental or consequential, arising out of the use or intended use of the product.

13. GENERAL INFORMATION

CUSTOMER SERVICE/CONTACT

IF YOU ARE EXPERIENCING ANY ISSUES WITH THE PRODUCT DURING OPERATION, DO NOT RETURN THE PRODUCT TO THE STORE. CONTACT TYPE S DIRECTLY FOR INSTRUCTIONS ON HOW TO RETURN/ EXCHANGE THE PRODUCT.

FCC Compliance Statement:

This device complies with Part 15 of the FCC rules. Operation is subject to the following two conditions: (1) This device may not cause harmful interference, and (2) this device must accept any interference received, including interference that may cause undesired operation.

Warning: Changes or modifications to this unit not expressly approved by the party responsible for compliance could void the user's authority to operate the equipment. The manufacturer is not responsible for any radio or TV interference caused by unauthorized modifications or change to this equipment. Such modifications or change could void the user's authority to operate the equipment.

NOTE: This equipment has been tested and found to comply with the limits for Class B digital device, pursuant to part 15 of the FCC Rules. These limits are designed to provide reasonable protection against harmful interference in a residential installation. This equipment generates, uses and can radiate radio frequency energy and, if not installed and used in accordance with the instructions, may cause harmful interference to radio or television reception, which can be determined by turning the equipment off and on, the user is encouraged to try to correct the interference by one or more of the following measures:

- Reorient or relocate the receiving antenna.
- Increase the separation between the equipment and the receiver.
- Connect the equipment into an outlet on a circuit different from that to which the receiver is connected.
- Consult the dealer or an experienced radio/TV technician for help.

The device has been evaluated to meet general RF exposure requirement.

To maintain compliance with FCC's RF exposure guidelines, this equipment should be installed and operated with a minimum distance of 20cm between the radiator and your body.

IC Compliance Statement:

This device complies with Industry Canada licence-exempt RSS standard(s). Operation is subject to the following two conditions: (1) this device may not cause interference, and (2) this device must accept any interference, including interference that may cause undesired operation of the device. The device has been evaluated to meet general RF exposure requirement. To maintain compliance with RSS-102 — Radio Frequency (RF) Exposure guidelines, this equipment should be installed and operated with a minimum distance of 20cm between the radiator and your body.

Le présent appareil est conforme aux CNR d'Industrie Canada applicables aux appareils radio exempts de licence. L'exploitation est autorisée aux deux conditions suivantes : (1) l'appareil ne doit pas produire de brouillage, et (2) l'utilisateur de l'appareil doit accepter tout brouillage radioélectrique subi, même si le brouillage est susceptible d'en compromettre le fonctionnement. Le dispositif a été évalué à répondre général rf exposition exigence.pour maintenir la conformité avec les directives d'exposition du RSS-102-Radio Fréquence (RF). ce matériel doit être installé et exploité à une distance minimale de 20 cm entre le radiateur et votre corps.

Contains Transmitter Module FCC ID: WUI-BT57799

Contains Transmitter Module IC: 7297A-BT57799

1080P Solar Powered App View

Backup Camera

BT57799

Responsible Party:

TYPE S

2975 Red Hill Ave., Ste. 100,

Costa Mesa, CA 92626

Tel: 866-294-9244

WINPLUS®

2975 Red Hill Ave., Ste. 100, Costa Mesa, CA 92626

1.866.294.9244 | info@typesauto.com

©2020 TYPE S. All rights reserved.

www.typesauto.com