

# SunVote C4000T User Manual



## Connection type

- Connect via USB port, plug and play under Windows. Support less than 10M USB 2.0 external cables.

## Management

### Base station ID

#### ❖ Set ID

- Use Tool Kit to get base station ID.
- Use Tool Kit to set base station ID. In a same system with multiple base stations, each base station should have unique ID. In different systems with different base stations, the same ID would not interfere each other.
- Base station ID will be saved until next modification once set.

#### ❖ Set channel

- Use Tool kit to get and set base station channel from 1-32.
- When base station channel is changed, all the matched keypads will automatically change to its new channel, no need to change in keypads one by one.

## Working mode

### ❖ Auto mode

**How to use:** Keypads connect with an auto mode base station directly after turn on.

**When to use:** Mostly for rentals. Rental companies could distribute different sets to different places quickly without too many configurations. Usually only one conference in one place; as in auto mode, different systems will have interference to each other.

### ❖ Match mode

**How to use:** Match the keypads to a certain base station before use.

**When to use:** Multiple conferences in one place need to avoid interference from each other and keypads can only communicate with the matched certain base station, cannot communicate with other base station in other conferences.

### How to switch match modes?

Open Tool Kit and connect the base station, select the mode you want. Once set, base station will save the mode until next modification.

## Multiple Base Station

### When to use:

- If attendees are more than the capacity of one base, use multiply base stations to increase the capacity of the system (usually using USB mode).
- If room size is larger than the operation distance of the voting system, use multiply base stations to extend the operation distance (usually using NET mode)

### How to use:

#### ● Base station configurations

Connect base station in USB mode. **For example**, to balance the keypads number with each base, here 1000pcs keypads and 3pcs bases, we can match 350pcs keypads (ID ranging from 1 to 350) with base station A, match other 350pcs keypads (ID ranging from 351 to 700) with base station B, match the last keypads (ID ranging from 701 to 1000) with base station C.

### Notice the bellowing points while doing it.

1. Base station ID: ranging from 1 to 32, each base station ID should be different.
2. Base station channel: ranging from 1 to 32, each base station channel should be different.

#### ● Connect multiple base stations:

Connect the bases via USB cables and plug the cables into the same USB HUB.

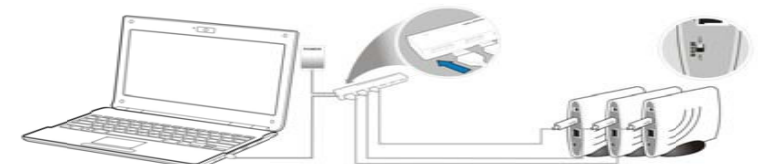

**Enable multi base stations in the application software:** set base station ID and connect. The connection state shows “successful” if connected successfully.

## Copyright Notice

All information related to the products and technology in this document belongs to the copyright of CHANGSHA SUNVOTE LIMITED. Anyone who browses, reproduces, prints and distributes this document without due authorization might constitute an infringement of copyright.

The technical parameters in this document may vary due to the actual use, environment, service life and production batches. If you have any doubt, please do not hesitate to consult CHANGSHA SUNVOTE LIMITED staff.

CHANGSHA SUNVOTE LIMITED reserves the final right of interpretation of this document.

## FCC Warning

Any Changes or modifications not expressly approved by the party responsible for compliance could void the user’s authority to operate the equipment.

This device complies with part 15 of the FCC Rules. Operation is subject to the following two conditions: (1)

This device may not cause harmful interference, and (2) this device must accept any interference received, including interference that may cause undesired operation.

Note: This equipment has been tested and found to comply with the limits for a Class B digital device, pursuant to part 15 of the FCC Rules. These limits are designed to provide reasonable protection against harmful interference in a residential installation. This equipment generates, uses and can radiate radio frequency energy and, if not installed and used in accordance with the instructions, may cause harmful interference to radio communications. However, there is no guarantee that interference will not occur in a particular installation. If this equipment does cause harmful interference to radio or television reception, which can be determined by turning the equipment off and on, the user is encouraged to try to correct the interference by one or more of the following measures:

- Reorient or relocate the receiving antenna.
- Increase the separation between the equipment and receiver.
- Connect the equipment into an outlet on a circuit different from that to which the receiver is connected.
- Consult the dealer or an experienced radio/TV technician for help.