

SK-BH-M12 使用手册

产品简介

■ **SK-BH-M12** 蓝牙无线立体声耳机的设计结合了时尚流行元素及崭新的无线技术；其迷你尺寸，精巧设计完全符合时尚生活的需求。

■ **SK-BH-M12** 蓝牙无线立体声耳机所支持的A2DP可以让您实现无线立体声音乐享受。

■ **SK-BH-M12** 蓝牙无线立体声耳机更可以让您在音乐与通话功能中相互切换。当您正在听音乐时，您可以用**SK-BH-M12**蓝牙无线立体声耳机接听蓝牙手机的来电或拨出电话。当您挂断电话后，几秒钟内音乐又开始自动接收播放。

■ 除了蓝牙无线立体声功能及蓝牙耳机免提功能，您更可以在支持蓝牙技术的电脑上使用**SK-BH-M12**蓝牙无线立体声耳机，通过网络通讯与他人交谈，例如：Skype、MSN Messenger或Yahoo!Messenger。

SK-BH-M12 蓝牙无线立体声耳机结构图



蓝牙配对是蓝牙产品使用上的一个专业术语；通过简单的操作将具备蓝牙功能的设备组成无线连接，例如，手机与蓝牙耳机使用时就要操作手机的蓝牙功能进行搜索蓝牙设备，然后选项取后通过识别密码进行无线匹配，连接。

SK-BH-M12 蓝牙无线立体声耳机的配对步骤如下：

1. 保证耳机处于关闭状态（见打开/关闭耳机）。
2. 按住多功能按钮约7秒,直到指示灯打开并红蓝交替闪烁。
3. 按照手机使用说明书的操作方法，将蓝牙耳机设为搜索蓝牙耳机。通常,设置步骤涉及进入手机上的“设定”、“连接”或“蓝牙”菜单，然后选择发现蓝牙设备的选项。
4. 手机会找到**SK-BH-M12**蓝牙耳机，并询问您是否准备与之对接。按下“是”或“确定”键，可对接。
5. 输入万能密钥或PIN码，“0000”然后按下“是”或“确定”键。
(重要提示：对接成功，指示灯发出蓝光闪烁3次，之后每隔7秒闪烁一次。如果未成功，指示灯仍旧交替闪烁，需要重新对接。)

通过语音拨打电话

如果语音识别功能开启并且使用免提操作设定连接耳机，则可以通过语音拨打电话。

1. 按下多功能按钮一次，您会听到语音启动提示音。
2. 说出希望呼叫的人名。
(重要提示：耳机是否支持语音拨打电话功能，这取决于手机。)

播放音乐

当手机不在通话时轻按一下多功能键可以播放/暂停音乐
(重要提示：有些立体声手机因为兼容性的问题，如要使立体声正常工作须做下面操作：首先你的手机是支持立体声，其次你须要确保你是由手机向立体声手机发出的连接。也就是说有时当您关掉手机再开机后，打开耳机后会自动连接到手机，这时只要在手机端先断开连接。再重新由手机发出连接到耳机就能正常使用立体声功能了。)

基本操作

1. 开机：关机情况下按住多功能键约3秒后蓝灯常亮3秒后手松开
2. 关机：在开机状态下按住多功能键约7秒后红灯常亮3秒手松开
3. 进入配对模式：关机情况下一直按住多功能键约7秒直至红蓝LED指示灯交替闪烁
4. 接听来电：当电话打入时轻按多功能键一下可接听电话
5. 挂断电话：当耳机与手机进入通话模式，轻按多功能键一下即可挂断电话
6. 拒听电话：当电话打入时，长按多功能键约3秒，喇叭听到哪声，松开此键，此电话被拒绝接听
7. 语音拨号：耳机与手机在连接模式，长按多功能键约3秒（后手松开）一次此键，喇叭听到哪声，即可语音拨号。是否支持此功能取决于手机。
8. 重拨号码：耳机和手机在连接模式，双击多功能键，喇叭听到哪声，松开按键即可重拨最后一个拨出的号码。
9. 播放/暂停音乐：当在待机状态时，轻按多功能键一次为播放/暂停音乐
10. 音量+：在通话模式或播放音乐时，短按一次“音量+”键，声音增加一级，当声音到最大时按一次键喇叭会发出一次嘟嘟声
11. 播放上一首：播放音乐时长按“音量+”键3秒播放上一首歌曲
12. 音量-：在通话模式或播放音乐时，轻按一次“音量-”键，声音减小一级，当声音到最小时按一次键喇叭会发出一次嘟嘟声
13. 播放下一首：播放音乐时长按“音量-”键3秒播放下一首歌曲
14. 打开/关闭静音：在通话状态，同时长按3秒“音量+”键“音量-”键，喇叭听到哪声，打开/关闭MIC的声音

重要使用提示：

蓝牙配对

电池充电及低压报警

正常连接充电后，充电时为红灯长亮，充电完成后指示灯将熄灭，充电一般需要2-3小时。当红灯每隔7秒钟闪烁一次且每30秒钟发出一报警音提示说明这时电池已经快用完，需尽快充电。如果继续使用5~10分钟会自动关机。

注意事项

如果无法将耳机连接到手机，请执行以下操作：

1. 确保耳机电量充足，已开机，已与手机配对并建立连接。
2. 确保手机的蓝牙功能启动。
3. 查看耳机与手机之间的距离是否超过10米，以及二者间是否存在障碍物或其他电子设备。
4. 蓝牙音乐装置或使用蓝牙连接器/蓝牙耳机传输器的音乐装置必须要支持蓝牙A2DP。
5. 蓝牙音乐装置或使用蓝牙连接器/蓝牙耳机传输器的音乐装置必须要支持蓝牙AVRCP。
6. 有些手机并不会开放让耳机拥有主动转换音乐与通话功能之间的蓝牙连接，如此将导致耳机的转换音乐电话来电的功能失效。

电池信息

本耳机由充电电池供电。新电池只有在经过两、三次完全充电和放电的周期后才能达到最佳性能。电池可以充电、放电几百次，但最终会失效。当你不充电时，请断开其与耳机的连接，请勿将完全充电的电池长时间连接在充电器上，因为过度充电会缩短电池寿命；如果已完全充电的电池闲置不用，电池本身在一段时间会放电。如果把耳机放在过热或过冷的地方，如在夏天或冬天将其放在封闭汽车里，会减少电池的容量和寿命。应尽量将电池温度保持在10°C和50°C之间。耳机电池过冷或过热可能会使其暂时无法工作，即使电池电量充足。当温度远低于冰点时，电池的性能尤其受到限制。请勿将电池投入火中，以免电池爆炸。受损的电池也可能爆炸。

SK-BH-M12 USER MANUAL

Product overview

■ Designed for an active lifestyle, **SK-BH-M12** Bluetooth Stereo Headset combines the stylish design and reliable wireless technology in the ideal mini size units. It's completely accord with the requirement of fashion life.

■ With the Bluetooth wireless technology, **SK-BH-M12** gives you the convenience wireless way to enjoy the steaming stereo music transmitted from the Bluetooth A2DP

■ Switching between music and phone calling, **SK-BH-M12** allows you answer or make calls with the Bluetooth enabled mobile phone while you are listening to music. After you ended the call, the music will follow to be streamed in few seconds.

■ Besides the wireless stereo and mobile hands-free applications, you also can apply the **SK-BH-M12** to the Bluetooth - enabled PC with the internet messenger such as Skype, MSN Messenger or Yahoo! Messenger.

SK-BH-M12 Bluetooth Stereo Headset Structure

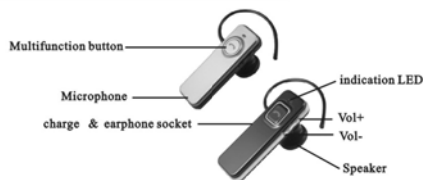

Important operation notice

Bluetooth pairing

Bluetooth pairing is professional word for Bluetooth products use: it makes the Bluetooth devices to wireless connect via simple operation. For example, you have to use the Bluetooth function built-in mobilephone, then take the device, pair and connect by password.

SK-BH-M12 Bluetooth Stereo Headset Pairing:

1. Make sure the headset under off state (see Switch on/off)
2. Press and hold multifunction key for 7S until red and blue LED flash alternatively.
3. Follow the operating instruction of your Bluetooth mobile phone to start the pairing process, typically, this is done by going to a "Connect" or "Setup" menu and then selecting the option to search the Bluetooth devices.
4. The mobile will find **SK-BH-M12** and ask whether you are willing to connect your mobile with the headset. Press "Yes" or "Confirm" to confirm this action.
5. Enter password or PIN 0000, and press "Yes" or "Confirm".
(Notice: If the connection is successful, the blue LED of the headset will flash 3 times. Then blue LED will flash one time every 7 seconds. If the pairing is unsuccessful, THE red and blue LED still flash alternatively. You please turn off the headset and pairing again.)

Voice dialing (dialing a number by saying a name)

The voice dialing is available, if the voice recognition turn on, and headset connected have been set up.

1. Press multifunction key of the headset one time, you will hear a beep prompt.
2. Say the name of the person you wish to call loudly
(Notice: That's key to make sure your mobile phone support voice dialing function)

Primarily Operation

1. Switch on: In the off state, press and hold multifunction key for 3
2. Switch off: In the on state, press and hold multifunction key for 7 seconds until red LED light 3 seconds
3. pairing mode: In the off state, press and hold the multifunction key 7 seconds until red and blue LED flash alternatively.
4. Answer a call: Press the multifunction key one time while the call coming to answer from the headset.
5. End a call: Press the multifunction key one time while the talking state to end a call from the headset.
6. Reject a call: Press and hold multifunction key about 3S until there is a prompt sound from the headset to reject the incoming call.
7. Voice dialing: Under the headset and mobile connecting state, press and hold multifunction key 3S until you hear a beep prompt to operate the voice dialing. To use this function, your mobile must support this option.
8. Redial number: Under the headset and mobile connecting state, press multifunction key two times until hear beep prompt to redial the last dialed number.
9. Play / Pause music: In the standby state, press multifunction key one time to play or pause music.
10. Vol+ : Under talking or music state, press "Vol+" one time, the volume up a degree. Press the button and hear beep prompt that's the max volume.
11. Play previous song: Press and hold the "Vol+" for 3S to play the previous song.
12. Vol- : Under talking or music state, press "Vol-" one time, the volume down a degree. Press the button and hear beep prompt that's the min volume.
13. Play next song: Press and hold the "Vol-" for 3S to play the next song.
14. On / off mute: Press "Vol+" & "Vol-" for 3S until hear beep prompt to turn on / off MIC.

Notice:

If disconnection occurs, please check the following factors:

1. Ensure that the headset has enough power, is turned on and has been successfully paired to the mobile.
2. The Bluetooth function of the mobile is enabled.
3. Check whether the range between the headset and mobile is over 10 meters, or there is wall or other disturbance or other electrical devices between headset and mobile.
4. Bluetooth music devices or the music devices with Bluetooth connector/Bluetooth stereo dongle must support A2DP.
5. Some mobile can't support the switching between music and calling for Bluetooth connection, is caused the function lost that switch between music and phone call by headset.

Battery information:

Your device is powered by a rechargeable battery. The full performance of a new battery is achieved only after two or three complete charge and discharge cycles. The battery can be charged and discharged hundreds of times, but it will eventually wear out. Please cut the connection between charger and headset when not charging. Do not leave a fully charged battery connected to a charger, since overcharging may shorten battery lifetime. If left unused, a fully charged battery will lose power with time past. Leaving the device in hot or cold places, such as in closed car in summer or winter conditions, will reduce the capacity and lifetime of the battery. Always try to keep the battery between -10 and 50. A device with a hot or cold battery may not work temporarily, even when the battery is fully charged. Battery performance is particularly limited in temperatures well below freezing. Do not dispose of batteries in a fire as they may explode. Battery may also explode if damaged.

FCC Statement

This equipment has been tested and found to comply with the limits for a Class B digital device, pursuant to part 15 of the FCC rules. These limits are designed to provide reasonable protection against harmful interference in a residential installation. This equipment generates, uses and can radiate radio frequency energy and, if not installed and used in accordance with the instructions, may cause harmful interference to radio communications. However, there is no guarantee that interference will not occur in a particular installation. If this equipment does cause harmful interference to radio or television reception, which can be determined by turning the equipment off and on, the user is encouraged to try to correct the interference by one or more of the following measures:

- Reorient or relocate the receiving antenna.
- Increase the separation between the equipment and receiver.
- Connect the equipment into an outlet on a circuit different from that to which the receiver is connected.
- Consult the dealer or an experienced radio/TV technician for help.

To assure continued compliance, any changes or modifications not expressly approved by the party responsible for compliance could void the user's authority to operate this equipment. (Example- use only shielded interface cables when connecting to computer or peripheral devices).

This equipment complies with Part 15 of FCC RF Rules. Operation is subject to the following two conditions:

- 1) This device may not cause interference and
- 2) This device must accept any interference, including interference that may cause undesired operation of the device.

FCC Radiation Exposure Statement

This equipment complies with FCC radiation exposure limits set forth for an uncontrolled environment

1. This Transmitter must not be co-located or operating in conjunction with any other antenna or transmitter.
2. This equipment complies with FCC RF radiation exposure limits set forth for an uncontrolled environment.

Caution!

The manufacturer is not responsible for any radio or TV interference caused by unauthorized modifications to this equipment. Such modifications could void the user authority to operate the equipment.