

QUICK START CARD

Installation

1. Install the universal bracket to camera and connect the power jack of adapter (DC 12V 500mA) to camera.

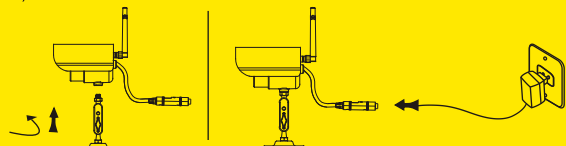

2. Connect the receiver to your TV with AV cable (yellow for video and red for audio).

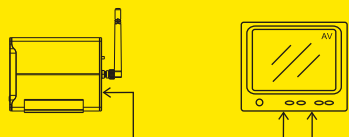

3. Connect the adapter (DC 8V 300mA) to the receiver. Slide the power switch to **ON** position. The power indicator lights up.

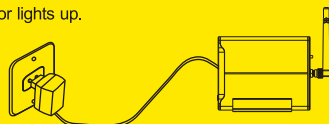

4. Power on the monitor/TV and select **AV** mode.

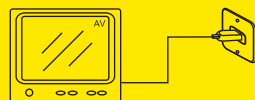

5. Check the camera's frequency. Press the channel button continuously to set the receiver's channel same as that of the camera. The monitor/TV receives pictures.

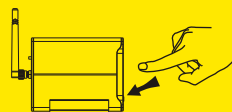

6. Adjust the brightness, contrast and color of the monitor/TV and the antenna's direction of the receiver for the perfect effect.



7. Setup the wireless receiver with included remote control:
 - (a) Remove the insulated plastic sheet from the remote control.
 - (b) Press loop key (the key with three circled arrows) on the remote control, then press "1" and "2" key, press loop key again. The receiver will be on the "loop" mode, and shows the cameras at three seconds' intervals.

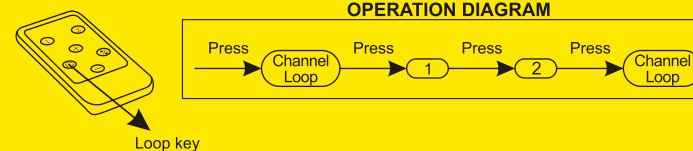

8. Press the lock key (the key with a lock symbol) to lock the channels.

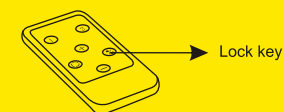

9. To reset the wireless receiver, just turn off the power switch and turn it on again. And go through above Step 7 to Step 8 again.

Function:

- Keep an eye on baby or elderly
- Domestic surveillance
- Small business surveillance
- Keep an eye on animals and birds without disturbing them
- Listen to function with visual, night vision, strong waterproof, wireless signal, and flexibility in the use of transmission
- 100 meter in the sceneries, night may photograph 15 meter in the sceneries.

Note:

Check your local and state laws regarding the usage of this product; any unlawful usage will be the sole responsibility of the users. Manufacturer and the distributors will assume no responsibility or liability over any unlawful usage and conduct by the users.

SPECIFICATIONS

Items		Value
Transmission Frequency		ISM 905MH . 924MHz
Transmission Distance		300ft (Without Block)
Operating Temperature		-10°C~+50°C /+14°F~+122°F
Storage Temperature		-20°C~+60°C /-4°F~+140°F
Storage Humidity		85%RH
Camera	Imaging Sensor	1/4-inch CMOS
	CMOS Total Pixels	(NTSC)
	Antenna Type	50 ohm
	Horizontal Resolution	420 TV Lines
	Minimum Illumination	<2(IR OFF)/O(IR ONP) Lux
	Night Vision Range	15m
	Transmission Power	10mW (CE)/2mW (FCC)
	Power Supply	DC 12V 500mA
	Consumption Current	120mA(IR OFF) 250mA(IR ON)
	Gain Antenna	>2Dbi
Receiver	Demodulation Type	FM
	Antenna	50 ohm smA
	Receiving Sensitivity	≤ -85dBm
	Video Output Level	1Vp-p@75ohm, S/N>38dB
	Audio Output Level	1Vp-p@600ohm
	Power Supply	DC 8V 300mA
	Consumption Current	250mA
	Gain Antenna	>2Dbi