

Trademarks

Autel®, MaxiSys®, MaxiDAS®, MaxiScan®, MaxiTPMS®, MaxiRecorder®, and MaxiCheck® are trademarks of Autel Intelligent Technology Corp., Ltd., registered in China, the United States and other countries. All other marks are trademarks or registered trademarks of their respective holders.

Copyright Information

No part of this manual may be reproduced, stored in a retrieval system or transmitted, in any form or by any means, electronic, mechanical, photocopying, recording, or otherwise without the prior written permission of Autel.

Disclaimer of Warranties and Limitation of Liabilities

All information, specifications and illustrations in this manual are based on the latest information available at the time of printing.

Autel reserves the right to make changes at any time without notice. While information of this manual has been carefully checked for accuracy, no guarantee is given for the completeness and correctness of the contents, including but not limited to the product specifications, functions, and illustrations.

Autel will not be liable for any direct, special, incidental, indirect damages or any economic consequential damages (including the loss of profits).

IMPORTANT

Before operating or maintaining this unit, please read this manual carefully, paying extra attention to the safety warnings and precautions.

For Services and Support



<http://pro.autel.com>

www.autel.com



1-855-288-3587/1-855-AUTELUS (North America)

0086-755-22672493/86532091 (China)



support@autel.com

For details, please refer to the *Technical Support* section in this manual.

Safety Information

For your own safety and the safety of others, and to prevent damage to the device and vehicles upon which it is used, it is important that the safety instructions presented throughout this manual be read and understood by all persons operating or coming into contact with the device.

There are various procedures, techniques, tools, and parts for servicing vehicles, as well as in the skill of the person doing the work. Because of the vast number of test applications and variations in the products that can be tested with this equipment, we cannot possibly anticipate or provide advice or safety messages to cover every circumstance. It is the automotive technician's responsibility to be knowledgeable of the system being tested. It is crucial to use proper service methods and test procedures. It is essential to perform tests in an appropriate and acceptable manner that does not endanger your safety, the safety of others in the work area, the device being used, or the vehicle being tested.

Before using the device, always refer to and follow the safety messages and applicable test procedures provided by the manufacturer of the vehicle or equipment being tested. Use the device only as described in this manual. Read, understand, and follow all safety messages and instructions in this manual.

Safety Messages

Safety messages are provided to help prevent personal injury and equipment damage. All safety messages are introduced by a signal word indicating the hazard level.

DANGER

Indicates an imminently hazardous situation which, if not avoided, will result in death or serious injury to the operator or to bystanders.

WARNING

Indicates a potentially hazardous situation which, if not avoided, could result in death or serious injury to the operator or to bystanders.

Safety Instructions

The safety messages herein cover situations Autel is aware of. Autel cannot know, evaluate or advise you as to all of the possible hazards. You must be certain that any condition or service procedure encountered does not jeopardize your personal safety.

 **DANGER**

When an engine is operating, keep the service area **WELL VENTILATED** or attach a building exhaust removal system to the engine exhaust system. Engines produce carbon monoxide, an odorless, poisonous gas that causes slower reaction time and can lead to serious personal injury or loss of life.

 **SAFETY WARNINGS**

- Always perform automotive testing in a safe environment.
- Wear safety eye protection that meets ANSI standards.
- Keep clothing, hair, hands, tools, test equipment, etc. away from all moving or hot engine parts.
- Operate the vehicle in a well ventilated work area, for exhaust gases are poisonous.
- Put the transmission in PARK (for automatic transmission) or NEUTRAL (for manual transmission) and make sure the parking brake is engaged.
- Put blocks in front of the drive wheels and never leave the vehicle unattended while testing.
- Be extra cautious when working around the ignition coil, distributor cap, ignition wires and spark plugs. These components create hazardous voltages when the engine is running.
- Keep a fire extinguisher suitable for gasoline, chemical, and electrical fires nearby.
- Do not connect or disconnect any test equipment while the ignition is on or the engine is running.
- Keep the test equipment dry, clean, free from oil, water or grease. Use a mild detergent on a clean cloth to clean the outside of the equipment as necessary.
- Do not drive the vehicle and operate the test equipment at the same time. Any distraction may cause an accident.
- Refer to the service manual for the vehicle being serviced and adhere to all diagnostic procedures and precautions. Failure to do so may result in personal injury or damage to the test equipment.
- To avoid damaging the test equipment or generating false data, make sure the vehicle battery is fully charged and the connection to the vehicle DLC is clean and secure.
- Do not place the test equipment on the distributor of the vehicle. Strong electro-magnetic interference can damage the equipment.

Laser Radiation

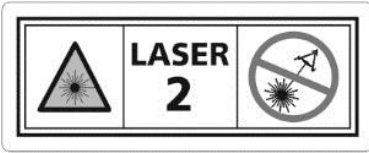

Never point the laser beam at people, particularly at their face or eyes.

The term laser equipment refers to devices, systems or test set-ups generating, transmitting or employing laser radiation.

The class of the laser device indicates the level of potential danger associated with its accessible laser radiation. In the case of class 2 laser equipment, the accessible laser radiation is in the visible spectral range (400 nm to 700 nm).

The eyelids provide sufficient protection for inadvertent brief eye contact with such laser radiation. Class 2 laser devices may therefore be used without further precautionary measures if the user is definitely not required to either look into the laser intentionally for extended periods of time (>0.25 s) or repeatedly look into the laser or at directly reflected laser radiation.

WARNING

Taking medication or alcohol consumption will slow down the reflex action of the eyelids. This results in a particular risk. Wearing laser safety glasses of protection level R1 is recommended for anyone who is under the influence of medication.

Persons who are not trained to work with laser equipment and on the hazards of laser radiation, may not enter workplaces where work takes place with laser beams nor a laser emitting device.

Infrared Radiation



Infrared inside. Avoid eye exposure.

Hot surface. Avoid contact directly.

Protect From Water and Sunlight



For indoor use only. Please protect from water and sunlight.

Safety measures:

- The operator is to place the warning “Warning of Laser beam” at eye level and in a visible manner at the measuring station.
- Do not look directly into laser source.
- The operator must comply with the intended use.

Use protective boots!

When performing work with risk of injury to the feet, notice must be given of the necessary wearing of protective shoes. Foot injuries can, for example, be caused by falling over or falling tools or work items, trapping the foot, occurrence of nails or metal shavings in the soles, etc.

Safety measures:

- The operator is to place the mandatory sign “Use Safety Shoes” at eye level and in a clearly visible manner at the measuring station.
- Operators should always wear the recommended protective shoes.

CONTENTS

	SAFETY INFORMATION	II
	SAFETY MESSAGES	II
	SAFETY INSTRUCTIONS.....	II
	LASER RADIATION.....	IV
	INFRARED RADIATION.....	IV
	PROTECT FROM WATER AND SUNLIGHT	V
1	USING THIS MANUAL	1
	CONVENTIONS.....	1
2	GENERAL INTRODUCTION	3
	FUNCTIONAL DESCRIPTION	3
	OTHER ACCESSORIES.....	6
3	GETTING STARTED	7
	ASSEMBLY INSTRUCTION	7
	ADAS SETTINGS.....	12
	CONNECTION CONFIGURATION.....	15
4	MAINTENANCE AND SERVICE	17
	MAINTENANCE INSTRUCTIONS	17
	SERVICE PROCEDURES	17
5	COMPLIANCE INFORMATION	20
6	WARRANTY	22
	LIMITED ONE YEAR WARRANTY.....	22

1 Using This Manual

This manual contains device usage instructions.

Some illustrations shown in this manual may contain modules and optional equipment that are not included in your system.

Conventions

The following conventions are used.

Bold Text

Bold text is used to highlight selectable items such as buttons and menu options.

Example:

- Tap **OK**.

Notes and Important Messages

Notes

A **NOTE** provides helpful information such as additional explanations, tips, and comments.

Example:

NOTE

New batteries reach full capacity after approximately 3 to 5 charging and discharging cycles.

Important

IMPORTANT indicates a situation which, if not avoided, may result in damage to the tablet or vehicle.

Example:

IMPORTANT

Keep the cable away from heat, oil, sharp edges and moving parts. Replace damaged cables immediately.

Hyperlink

Hyperlinks, or links, that take you to other related articles, procedures, and illustrations are available in electronic documents. Blue italic text indicates a selectable hyperlink and blue underlined text indicates a website link or an email address link.

Illustrations

Illustrations used in this manual are samples, the actual testing screen may vary for each vehicle being tested. Observe the menu titles and on-screen instructions to make correct option selection.

2 General Introduction

Autel's MaxiSys ADAS is designed to calibrate Advanced Driver-Assistance Systems quickly and easily. Lane departure warning, adaptive cruise control, rear collision warning, and other camera and radar-based safety systems are becoming a common feature on vehicles of every class. The radar and camera used by these systems necessitate the utmost precision when calibrating following many common repairs, such as camera/radar replacement or chassis adjustment.

Autel's MaxiSys Intelligent ADAS IA800 Camera & Adapter kit displays vehicle-specific step-by-step instructions and detailed illustrations to enable the technician to perform efficient and accurate calibrations on these increasingly popular vehicle systems.

MaxiSys ADAS's ADAS module covers eleven manufactures: Volkswagen, Mercedes-Bens, BMW, Lexus, Nissan, Infiniti, Honda, Toyota, Hyundai, KIA, Ford, and Volvo. More vehicles will be included in future updates.

Functional Description

Camera Kit

Facing the front of the ADAS main frame, the left camera unit is on the left side, the right camera unit is on the right side.

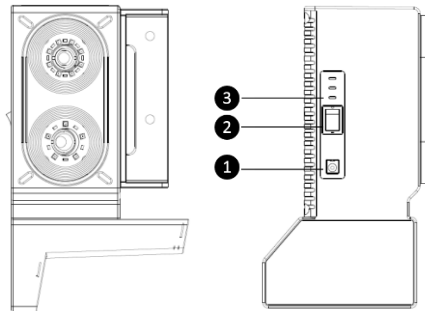

Figure 2-1 Left Camera Unit AUTEL-CSC0500/06

1. Power Port
2. Switch
3. Power Indicator

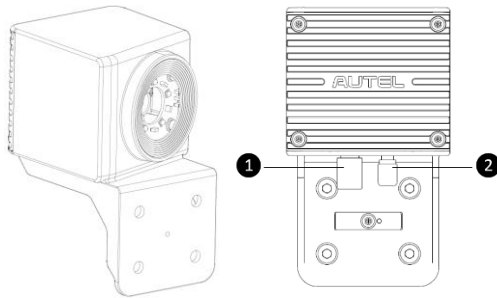

Figure 2-2 Center Camera AUTEL-CSC0500/06

1. USB Port
2. Power Port

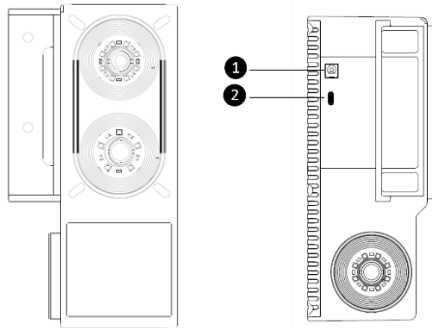

Figure 2-3 Right Camera Unit AUTEL-CSC0500/06

1. Power Port
2. USB Port

24V Power Adapter

24V power adapter is used for power the camera & adapter kit (CSC0500/06).

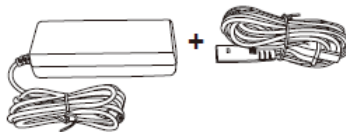







Figure 2-4 24V Power Adapter

Technical Specifications

Table 2-1 Specifications

Item	Description
Recommended Use	Indoor
Operating System	LINUX
Processor	Quad-core processor (1.5 GHz)
Memory	2GB RAM DDR4 & 32GB ROM
Connectivity	<ul style="list-style-type: none">● Wi-Fi● USB 2.0, Type C
Power Consumption	5A @24 V
Operating Temp.	-10 to 50°C
Storage Temp.	-20 to 70°C
Dimensions (W x H x D)	127.9mm*220.7mm*123mm (Left Camera Unit) 75mm*128.1mm*92.5mm (Center Camera) 113mm*216.2mm*92.5mm (Right Camera Unit)
Net Weight	1375g (Left Camera Unit) 420g (Center Camera) 1140g (Right Camera Unit)

Other Accessories

<p>Hex L-wrench (4mm) 1pc</p> 	<p>Sealing Strip 1pc</p> 	<p>Bolt (M6x14) 8pcs</p> 
<p>T Hammer Nut (M6) 4pcs</p> 	<p>Sliding Nut (M6) 4pcs</p> 	

3 Getting Started

Assembly Instruction

Assemble the Left Camera Unit

1. Remove the 2 bolts (Pos.1) with the hex L-wrench (4mm) from one end of the crossbar.
2. Remove the end cover (Pos.2).

Similarly, remove the 2 bolts and end cover at the opposite end of the crossbar.

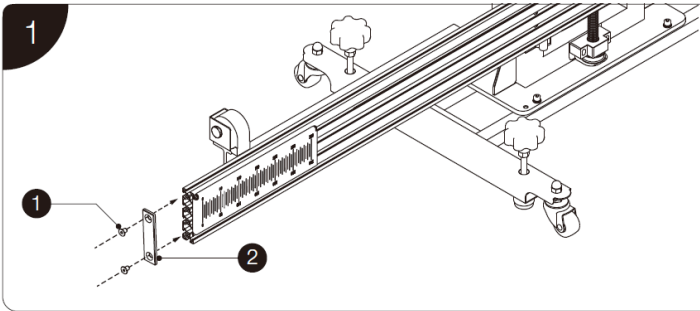

Figure 3-1 Remove Bolts and Cover

1. Insert two sliding nuts (M6) into the first and third slide slots of the crossbar.

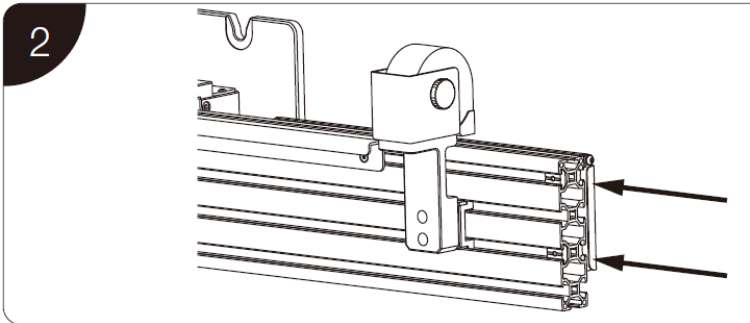

Figure 3-2 Insert Nuts

1. On the left side of the crossbar, insert the long power supply cable into the first inner hole of the crossbar. Ensure that the cable is fully passed through the entire crossbar, and that the connector of the power supply cable (Pos.1) is exposed at the opposite end of the crossbar.
2. Insert the long signal cable attached to the left camera unit into the third inner hole from the same end of the crossbar. Ensure that the cable is fully passed through the entire crossbar, and that the connector of the long signal cable (Pos.2) is exposed at the opposite (right) end of the crossbar.

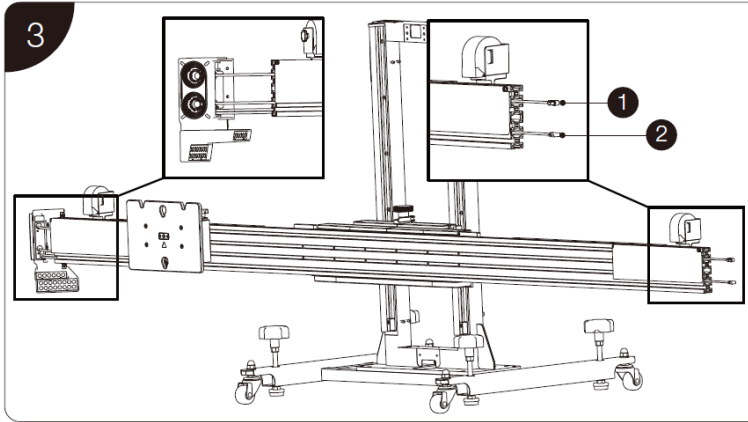

Figure 3-3 Cables Fully Passed Through Crossbar

1. Insert the side segment of the camera unit into the left end of the crossbar, and place the two short cables into the fourth slide slot.
2. Align the bolt holes on the side segment with the screw holes on the sliding nuts (M6), insert two bolts (M6x14) into the screw holes, and then tighten bolts with the hex L-wrench until the camera unit is secured.

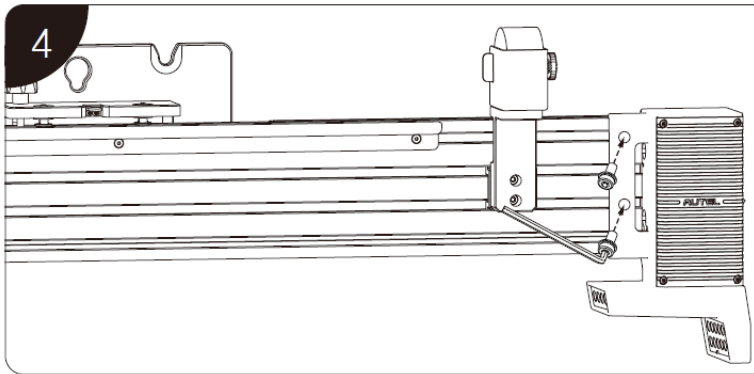

Figure 3-4 Secure the Left Camera Unit

Assemble the Right Camera Unit

1. Insert two sliding nuts (M6) into the first and third slide slots of the crossbar.
2. From the front to the back of the camera unit, pass the long power supply cable and the long signal cable exposed at the opposite end of the crossbar through the narrow slot of the side segment.

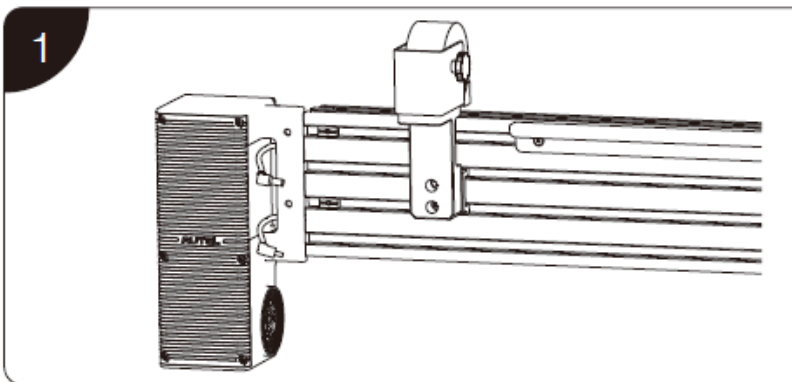

Figure 3-5 Insert Nuts

1. Insert the side segment of the camera unit into the end of the crossbar.
2. Align the bolt holes on the side segment with the screw holes on the sliding nuts

(M6), insert two bolts (M6x14) into the screw holes, and then tighten bolts with the hex L-wrench until the camera unit is secured.

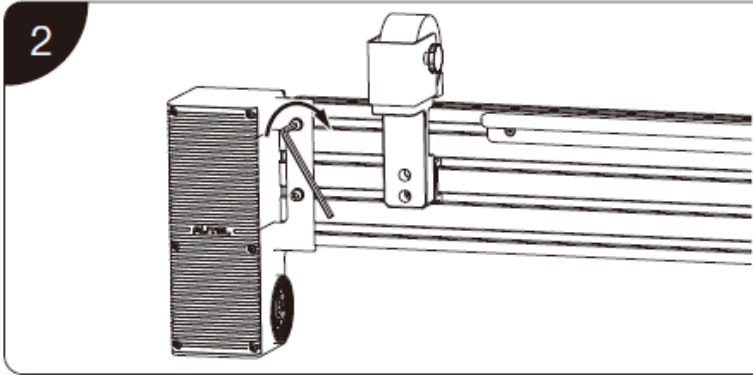

Figure 3-6 Secure the Right Camera Unit

1. Remove the caps on the connectors of the long power supply cable and the long signal cable.
2. Plug the long power supply cable connector into the power input port on the top of the camera unit, and plug the long signal cable connector into the USB C port. Insert the extra parts of two cables into the narrow slot beside the side segment.

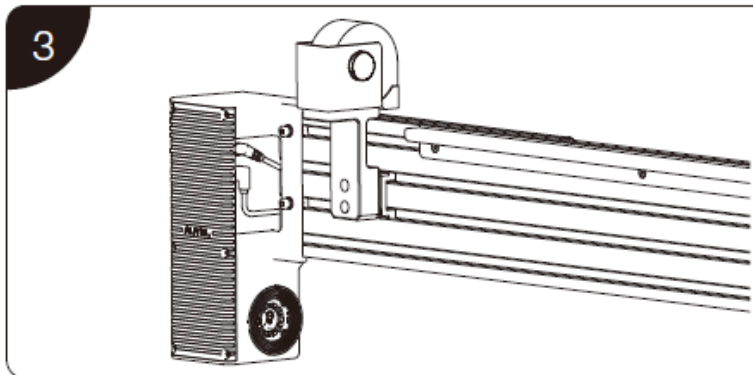

Figure 3-7 Connect the Cables

Assemble the Center Camera

1. Adjust the four T hammer nuts (M6) attached on the center camera to the horizontal direction, and insert all the T hammer nuts (M6) into the first and second slide slots of the crossbar next to the pattern board slot.

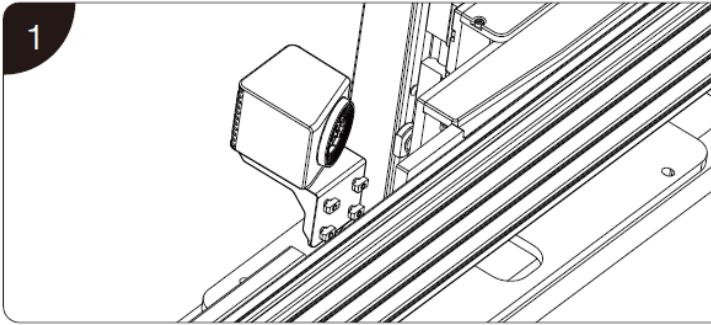

Figure 3-8 Adjust the Nuts

1. Tighten the bolts with the hex L-wrench until the camera is secured.

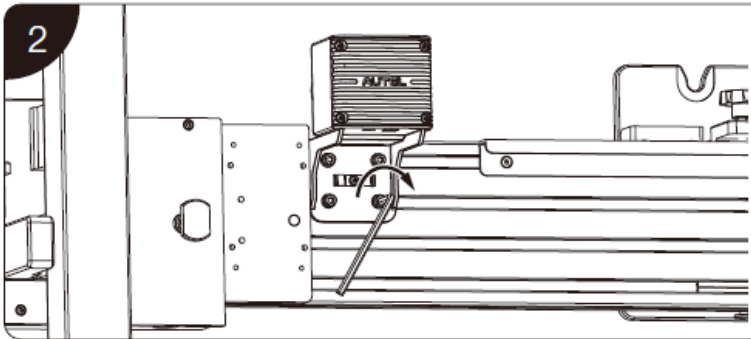

Figure 3-9 Tighten the Bolts

1. Plug the connector of the short power supply cable into the power input port at the bottom, and plug the connector of the short signal cable into the USB C port.
2. Insert the two cables (short power supply cable and short signal cable) into the fourth slide slot of the crossbar. Press the sealing strip into the slide slot and ensure it is flush with the crossbar.

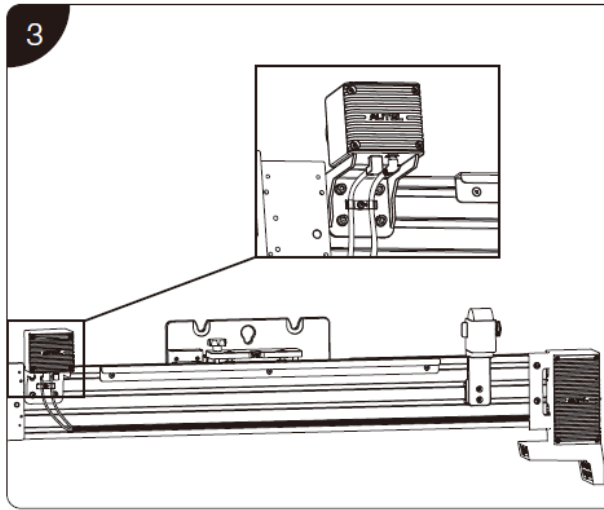

Figure 3-10 Connect the Cables

ADAS Settings

! IMPORTANT

Before operating or maintaining this unit, please read these instructions carefully. Use this unit correctly and with care. Failure to do so may cause damage and/or personal injury and will void the limited product warranty.

1. After the camera units are assembled successfully, plug the included power cord into the power port (Pos. 1) of the left camera unit. Turn on the switch (Pos. 2) and the Power indicator light will display red (Pos. 3).

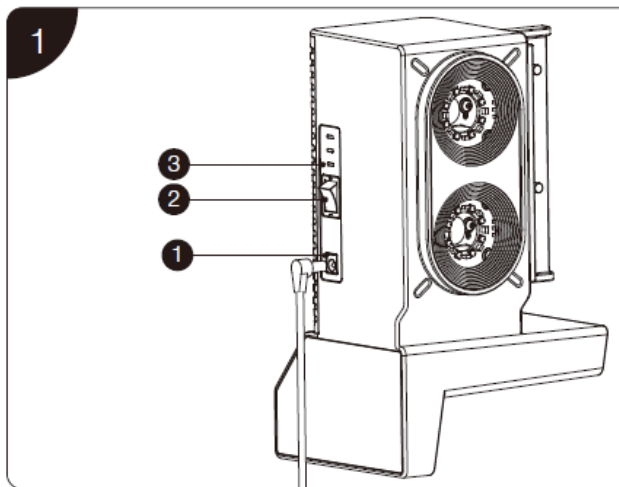

Figure 3-11 Power the Camera Unit

2. Turn on the MaxiSys tablet. Tap the **Settings** application on the MaxiSys Job Menu. The tablet connects with the camera and adapter kit via Wi-Fi.

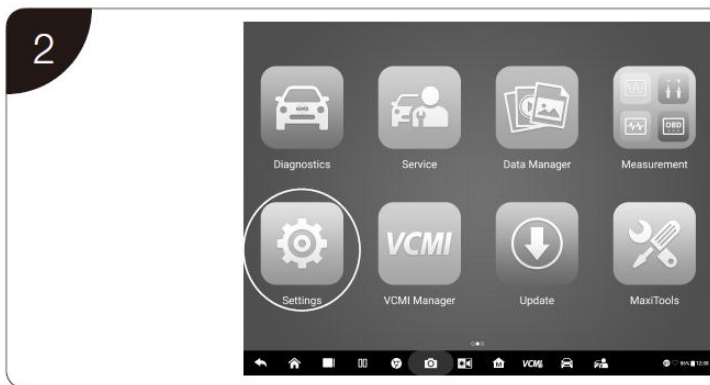

Figure 3-12 Tap Settings Application

3. Tap the **ADAS settings** option on the left column. Tap the **Connection** setting to display the ADAS Wi-Fi connection screen.

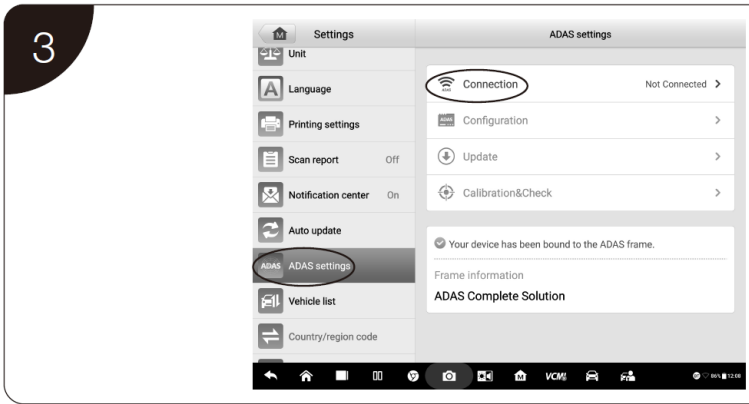

Figure 3-13 Tap ADAS Settings > Connection

4. Swipe the Wi-Fi toggle to turn **ON** ADAS Wi-Fi. The tablet will search for available units. The camera and the adapter kit will display with an ADAS suffix and a serial number. Tap the appropriate unit to connect. When connection is established, the connection status will display as **Connected**.

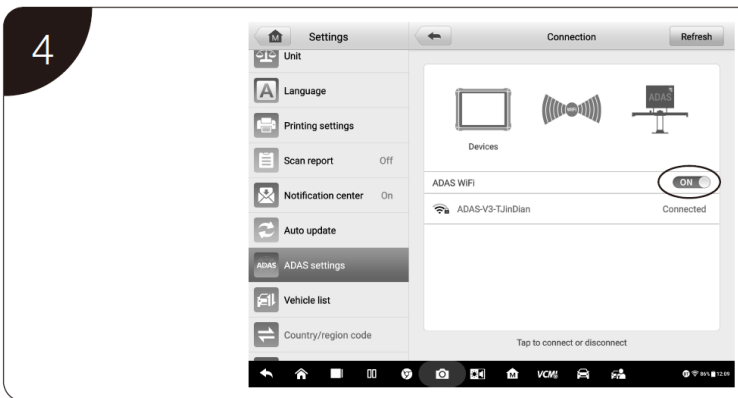

Figure 3-14 ADAS Connection

After the ADAS Wi-Fi is connected successfully, the camera and adapter kit is ready to start vehicle calibration.

Connection Configuration

Connect the MaxiSys tablet to your Wi-Fi (Internet accessible) network.

1. Tap **Settings > ADAS settings > Configuration** to enter the Wi-Fi configuration screen.

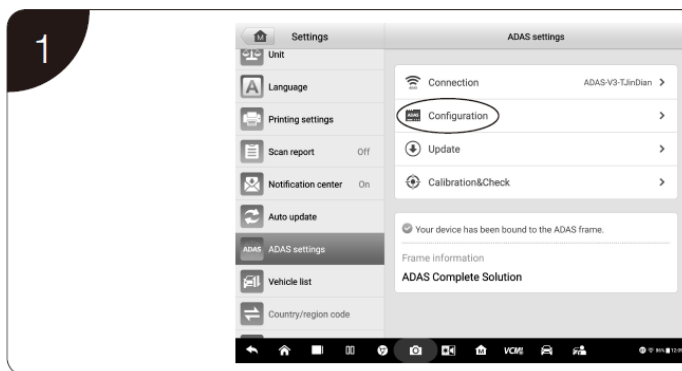

Figure 3-15 Tap Configuration

2. Tap the dropdown list and select your Wi-Fi network, and enter password when prompted.

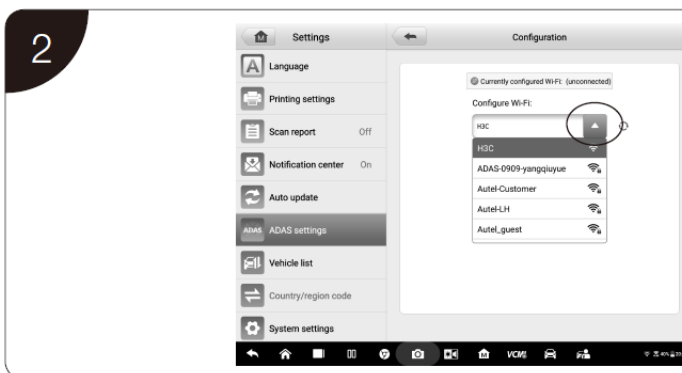

Figure 3-16 Select Wi-Fi network

3. Tap the **Connection configuration** button to connect to the selected Wi-Fi network. Once connected successfully, a message will display "Currently configured Wi-Fi: YOUR WI-FI NETWORK (connected)".

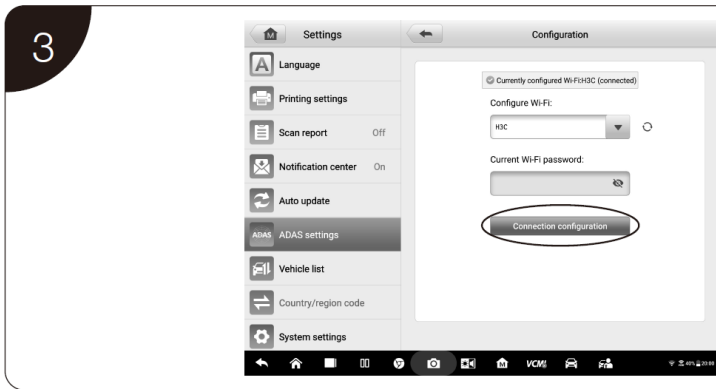

Figure 3-17 Connection Configuration

4 Maintenance and Service

Maintenance Instructions

- Keep the calibration tools clean at all times.
- Do not use any abrasive, corrosive cleansers, detergent, or
- Do not immerse the calibration tools in water or other fluids.
- Maintain the tools in dry conditions and keep them within normal operating temperatures.
- Do not store the tools in humid, dusty or dirty areas.
- Use only authorized battery chargers and accessories. Any malfunction or damage caused by the use of unauthorized battery charger and accessories will void the limited product warranty.
- Ensure that the battery charger does not come in contact with conductive objects.
- If the calibration tools should fail despite the care taken in manufacturing and testing procedures, repair should be carried out by an authorized after-sales service center for Autel tools.

DANGER

1. The built-in Lithium-ion Polymer battery is factory replaceable only; incorrect replacement or tampering with the battery pack may cause an explosion.
 2. Do not use a damaged battery charger.
-

Service Procedures

This section introduces information for technical support, repair service, and application for replacement or optional parts.

Technical Support

If you have any question or problem on the operation of the product, please contact us (see the following contact info) or your local distributor.

AUTEL CHINA HQ

- Phone: 0086-755-8614 7779
- Website: www.autel.com

- Email: support@autel.com
- Address: 6th-10th floor, Building B1, Zhiyuan, Xueyuan Road, Xili, Nanshan, Shenzhen, 518055, China

AUTEL NORTH AMERICA

- Phone: 855-AUTEL-US (855-288-3587) Monday-Friday 9am-6pm EST
- Website: www.autel.com
- Email: ussupport@autel.com
- Address: Suite 200, 175 Central Avenue, Farmingdale, New York, USA. 11735

AUTEL EUROPE

- Phone: 0049 (0) 61032000522
- Website: www.autel.eu
- Email: sales.eu@autel.com/support.eu@autel.com
- Address: Robert-Bosch-Strasse 25, 63225, Langen, Germany

AUTEL SOUTH AMERICA

- Phone: (+507) 308-7566
- Website: www.autel.com/es
- Email: sales.latin@autel.com/latsupport@autel.com
- Address: Office 103, Building 3845, International Business Park, Veracruz, Panamá Pacífico, Panamá

AUTEL AUSTRALIA

- Phone: 03 9480 2978 / +61 476293327
- Website: www.autel.com.au
- Email: sales@autel.com.au
- Address: 155 Islington Street, Melbourne, Collingwood, VIC

Repair Service

If it becomes necessary to return your device for repair, please download the repair service form from www.autel.com, and fill it in. The following information must be included:

- Contact name
- Return address
- Telephone number
- Product name
- Complete description of the problem

- Proof-of-purchase for warranty repairs
 - Preferred method of payment for non-warranty repairs
-

NOTE

For non-warranty repairs, payment can be made with Visa, Master Card, or with approved credit terms.

Send the device to your local agent, or to the below address:

8th Floor, Building B1, Zhiyuan,
Xueyuan Road, Xili, Nanshan,
Shenzhen, 518055, China

Other Services

You can purchase the optional accessories directly from Autel's authorized tool suppliers, and/or your local distributor or agent.

Your purchase order should include the following information:

- Contact information
- Product or part name
- Item description
- Purchase quantity

5 Compliance Information

FCC STATEMENT :

This device complies with Part 15 of the FCC Rules. Operation is subject to the following

two conditions:

- (1) This device may not cause harmful interference, and
 - (2) This device must accept any interference received, including interference that may cause undesired operation.
-

WARNING

Changes or modifications not expressly approved by the party responsible for compliance could void the user's authority to operate the equipment.

NOTE

NOTE: This equipment has been tested and found to comply with the limits for a Class B digital device, pursuant to Part 15 of the FCC Rules. These limits are designed to provide reasonable protection against harmful interference in a residential installation. This equipment generates uses and can radiate radio frequency energy and, if not installed and used in accordance with the instructions, may cause harmful interference to radio communications. However, there is no guarantee that interference will not occur in a particular installation. If this equipment does cause harmful interference to radio or television reception, which can be determined by turning the equipment off and on, the user is encouraged to try to correct the interference by one or more of the following measures:

- Reorient or relocate the receiving antenna.
- Increase the separation between the equipment and receiver.
- Connect the equipment into an outlet on a circuit different from that to which the receiver is connected.
- Consult the dealer or an experienced radio/TV technician for help.

This equipment complies with FCC radiation exposure limits set forth for an uncontrolled environment. This equipment should be installed and operated with minimum distance 20cm between the radiator & your body.

RoHS COMPLIANCE

This device is declared to be in compliance with the European RoHS Directive 2011/65/EU.

CE COMPLIANCE

This product is declared to conform to the essential requirements of the following Directives and carries the CE mark accordingly:

EMC Directive 2014/30/EU

R&TTE Directive 1999/5/EC

Low Voltage Directive 2014/35/EU

6 Warranty

Limited One Year Warranty

Autel Intelligent Technology Corp., Ltd. (the Company) warrants to the original retail purchaser of this MaxiCOM Diagnostic Device, that should this product or any part thereof during normal consumer usage and conditions, be proven defective in material or workmanship that results in product failure within one (1) year period from the date of purchase, such defect(s) will be repaired, or replaced (with new or rebuilt parts) with Proof of Purchase, at the Company's option, without charge for parts or labor directly related to the defect(s).

The Company shall not be liable for any incidental or consequential damages arising from the use, misuse, or mounting of the device. Some states do not allow limitation on how long an implied warranty lasts, so the above limitations may not apply to you.

This warranty does not apply to:

- a) Products subjected to abnormal use or conditions, accident, mishandling, neglect, unauthorized alteration, misuse, improper installation or repair or improper storage;
- b) Products whose mechanical serial number or electronic serial number has been removed, altered or defaced;
- c) Damage from exposure to excessive temperatures or extreme environmental conditions;
- d) Damage resulting from connection to, or use of any accessory or other product not approved or authorized by the Company;
- e) Defects in appearance, cosmetic, decorative or structural items such as framing and non-operative parts.
- f) Products damaged from external causes such as fire, dirt, sand, battery leakage, blown fuse, theft or improper usage of any electrical source.

! **IMPORTANT**

All contents of the product may be deleted during the process of repair. You should create a back-up copy of any contents of your product before delivering the product for warranty service.
