

BETWEEN TURNS
HAVE TO BE CLEARANCE
0.4 mm MINIMUM

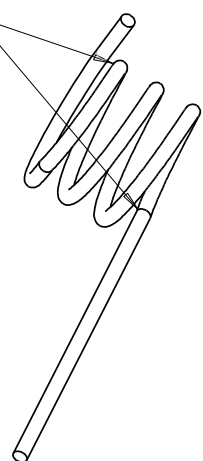

MATCH THE CAP
ACCORDING THE FOLLOWING:

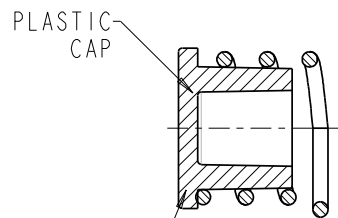
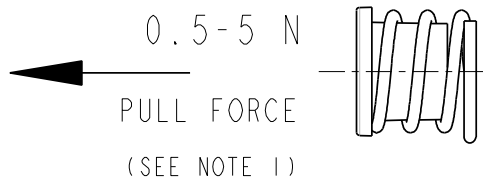

SAME CAP AS
H-301869 ANTENNA

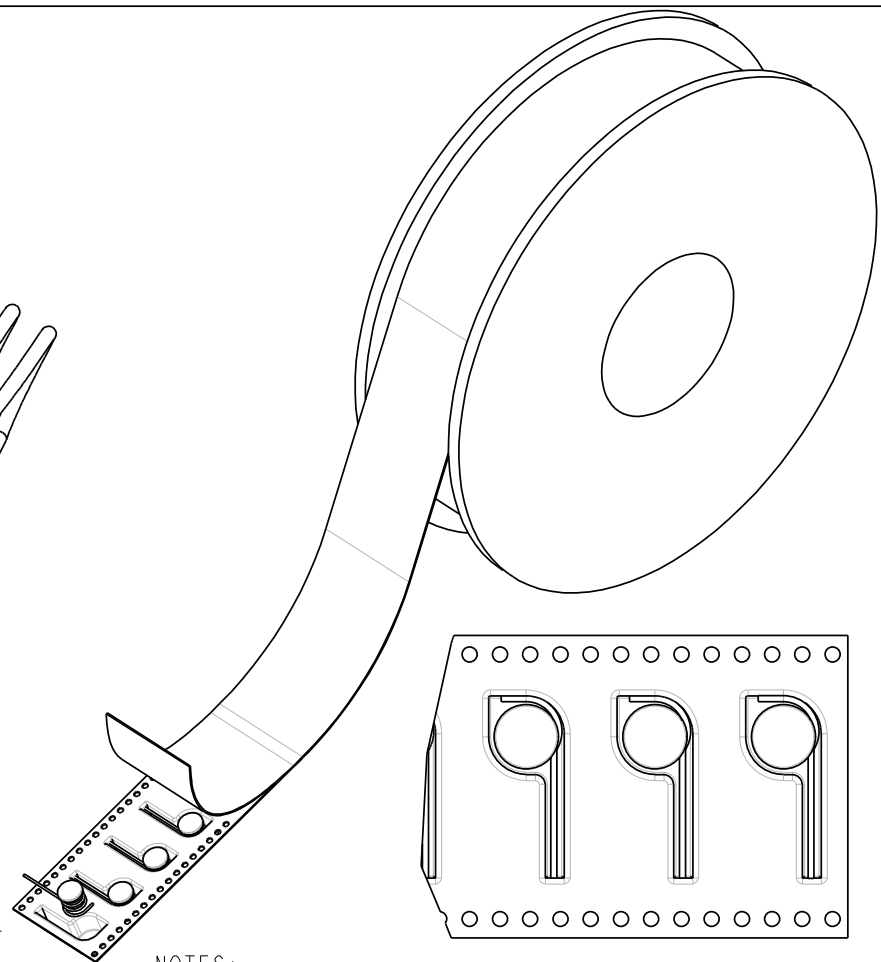

- NOTES:
1. SEPARATION PULL FORCE BETWEEN ANTENNA AND PLASTIC CAP MUST BE 5-50 N
 2. FINISH: BRIGHT TIN PLATE 1-5 mkm THICK.
 3. ALL MATERIALS HAVE TO BE ROHS COMPLIANT

SCALE: 2.5:1

		PRODUCT NAME:			WEIGHT (kg):	Upd.	ECOs
		PART NAME: RFD ANTENNA SMD (868)			MATERIAL: ST.S+	0	13087
APX. 2-1-3	NAME	DATE	SIGNATURE	MODEL REV.	DOC. REV.	TOLERANCES (In mm.)	1
DESIGNED	YIGAL B.	15.06.10		CATALOG No.		H14; h14; IT14/2	2
DREW	YIGAL B.			DRAWING No.		DRAFT ANGLES 1°	3
UPDATED				CAD FILE:			4
APPROVED	ZOHAR G.			SHEET #/of		UNLESS OTHERWISE STATED	5