

## Installing the Batteries

The RF2.4GHz Optical mouse use two AAA alkaline batteries.  
 The RF2.4GHz Optical keyboard use two AAA alkaline battery.  
 The RF2.4GHz Optical keyboard use one AAA alkaline battery.

### Installing Batteries in the Mouse

- Step 1. Open the battery compartment
- Step 2. Insert the batteries as shown inside the battery compartment
- Step 3. Replace the cover

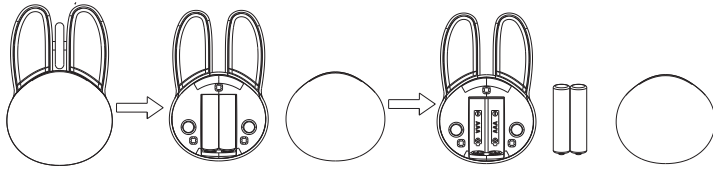

### Install the batteries in the keyboard

- Step1: Remove the battery compartment cover on the bottom of the keyboard by squeezing the cover in from the tab to release it
- Step2: Insert the batteries as shown inside the battery compartment
- Step3: Replace the cover

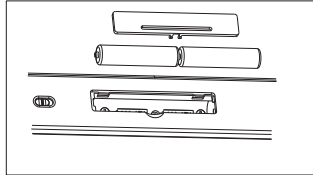

### Install the batteries in the keyboard

- Step1: Remove the battery compartment cover on the bottom of the keyboard by squeezing the cover in from the tab to release it
- Step2: Insert the batteries as shown inside the battery compartment
- Step3: Replace the cover

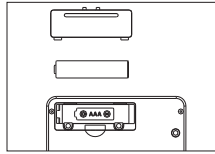

## Connecting the Receiver

The receiver is insert to USB port immediate, or by a extra USB cable.



USB Port

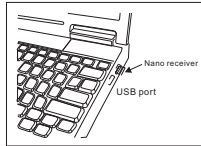

Connect the USB plug to USB port of your computer

## Obtain the receiver on the mouse

- 1: when you want use the mouse ,you can take out the receiver to computer by the list ① step;
- 2: when you need stop the work or to travel, you can store the receiver on the mouse for the moving by the list ② step.

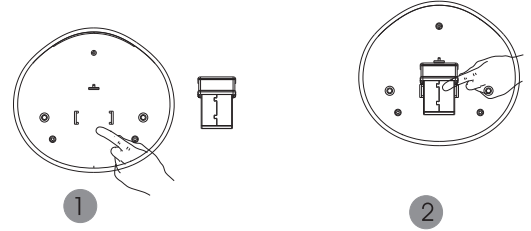

## Dpi shift function

Your optical 3D mouse is provide 1200 dpi .

## State of standby and wake up the mouse

Without any clicks or scroll movement for 8 minutes, the mouse will go into standby mode. Click any button or scroll the wheel to wake up the mouse.

Under this economize mode, the optical Red LED will turn of automatically and the mouse won't respond by moving it.

### FN+ functions:

FN+ESC=`	FN+ SHIFT+ ESC=~/
SHIFT+1=!	FN+1=F1
SHIFT+2=@	FN+2=F2
SHIFT+3=#	FN+3=F3
SHIFT+4=\$	FN+4=F4
SHIFT+5=%	FN+5=F5
SHIFT+6=^	FN+6=F6
SHIFT+7=&	FN+7=F7
SHIFT+8=*	FN+8=F8
SHIFT+9=(	FN+9=F9
SHIFT+0=)	FN+0=F10
SHIFT+- =_	FN+-=F11
SHIFT+= =+	FN+=F12

FN+Backspce=A Line function to flip the top

## FCC Warning Statement

Changes or modifications not expressly approved by the party responsible for compliance could void the user's authority to operate the equipment.

This equipment has been tested and found to comply with the limits for a Class B digital device, pursuant to Part 15 of the FCC Rules. These limits are designed to provide reasonable protection against harmful interference in a residential installation. This equipment generates uses and can radiate radio frequency energy and, if not installed and used in accordance with the instructions, may cause harmful interference to radio communications. However, there is no guarantee that interference will not occur in a particular installation. If this equipment does cause harmful interference to radio or television reception, which can be determined by turning the equipment off and on, the user is encouraged to try to correct the interference by one or more of the following measures:

- Reorient or relocate the receiving antenna.
- Increase the separation between the equipment and receiver.
- Connect the equipment into an outlet on a circuit different from that to which the receiver is connected.
- Consult the dealer or an experienced radio/TV technician for help.

This device complies with part 15 of the FCC rules. Operation is subject to the following two conditions (1) this device may not cause harmful interference, and (2) this device must accept any interference received, including interference that may cause undesired operation.

Model:SMK-676683M6AG

# Instruction Manual

## RF2.4GHz Auto-Link Two Keyboard & Optical Mouse

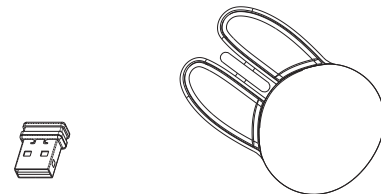
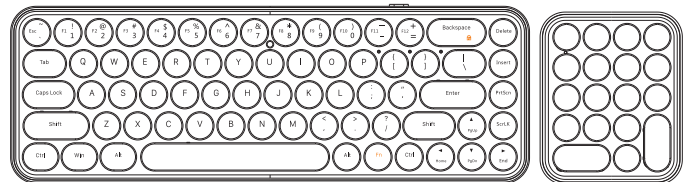

CAUTION: To use this device properly, please read the user's guide before installation.