

## Installing the Batteries

The Bluetooth mouse uses two AAA alkaline batteries.

### Installing Batteries In the Mouse

Step 1: Open the battery compartment.

Step 2: Insert the batteries as shown inside the battery compartment.

Step 3: Replace the cover.

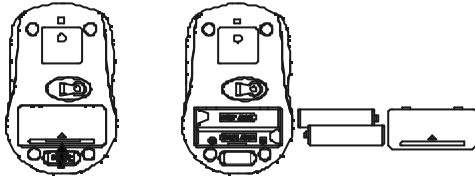

## Installing the mouse

Step 1: Check the bluetooth receiver is on your PC or notebook system.

If your PC or notebook had this bluetooth receiver, the setup applet's icon will appear on the window taskbar.



Bluetooth icon

If your PC or notebook hadn't this bluetooth receiver, the setup applet's icon will not appear on the window taskbar. Maybe you need insert a new bluetooth dongle to your PC or notebook USB port for used.

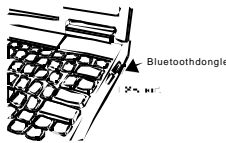

Bluetooth dongle

Step 2: When your PC or notebook had appear the bluetooth icon on the windows taskbar, you will can install your bluetooth mouse to your PC or notebook. Following the next guide...

1: Double click the bluetooth icon, and you will find the list show on your displayer



You will only need click the icon "add device"



For this step, you only need ✓ select the option and press "next".



When the system appears this window, please press the connect button of the mouse bottom side.

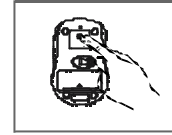

Need a few seconds, the search will finish, the system will appear this window, you can select the result of search and press "next".



Follow the display of window and select the "no password", press "next"



The system will auto finish the install and you need press "finish" only for this step.

The bluetooth device's installation is finished and you can enjoy your wireless bluetooth device's life.

## Power-Save function:

\* This mouse is equipped with Traveling-Power-Save function. When you are traveling with this mouse, the Laser LED of the mouse will be switched off automatically for the purpose of power-save, but the pre-condition is that the receiver is disconnected with your notebook or PC.

\* When your mouse has any click or scroll or moving, the mouse will come to sleep state for the economize after about 8 seconds, for the wake up, you can scroll the wheel or click any button for this

Model: SM305/306/309BT

# Instruction Manual

## Bluetooth Mouse



CAUTION: To use this device properly, please read the user's guide before installation.

## **FCC Statement**

This device complies with Part 15 of the FCC Rules.

Operation is subject to the following two conditions:

- (1) This device may not cause harmful interference, and
- (2) This device must accept any interference received, including interference that may cause undesired operation. Note: The manufacturer is not responsible for ANY interference, for example RADIO or TV interference, caused by unauthorized modifications to this equipment. Such modifications could void the user's authority to operate the equipment.

### **Note**

This equipment has been tested and found to comply with the limits for a Class B digital device, pursuant to part 15 of the FCC Rules.

These limits are designed to provide reasonable protection against harmful interference in a residential installation. This equipment generates, uses and can radiate radio frequency energy and, if not installed and used in accordance with the instructions, may cause harmful interference to radio communications. However, there is no guarantee that interference will not occur in a particular installation. If this equipment does cause harmful interference to radio or television reception, which can be determined by turning the equipment off and on, the user is encouraged to try to correct the interference by one or more of the following measures:

Reorient or relocate the receiving antenna. Increase the separation between the equipment and receiver. Connect the equipment into an outlet on a circuit different from that to which the receiver is connected. Consult the dealer or an experienced radio/TV technician for help.