

Customer:	Rondish
Date:	2021-03-17
Model:	WPAS-10
Type	Silk Screen
Art Ver.:	Art_WPAS-10_SC (20210317)
Size:	\
Color:	<div><div></div>Pantone 445C</div>

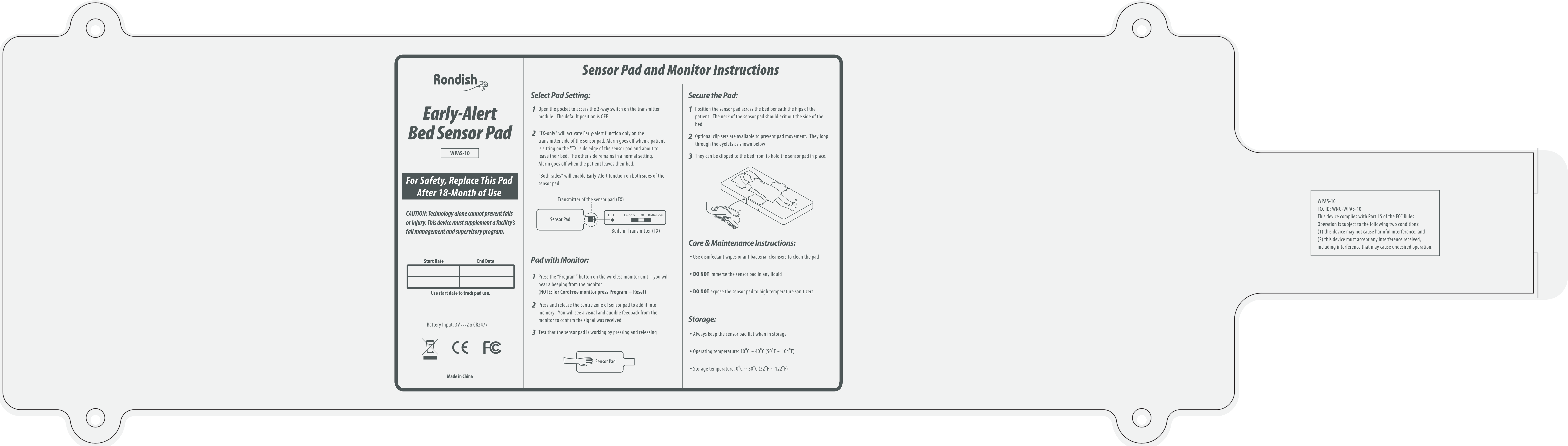

Customer:	Rondish
Date:	2020-12-01
Model:	WPAS-10
Type	Silk Screen
Art Ver.:	Art_WPAS-10_SC (20201201)
Size:	\
Color:	<div></div> Black

Transmitter

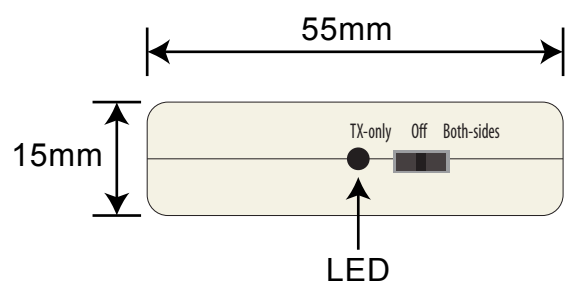



Early-Alert Bed Sensor Pad

WPAS-10

**For Safety, Replace This Pad
After 18-Month of Use**

CAUTION: Technology alone cannot prevent falls or injury. This device must supplement a facility's fall management and supervisory program.

Start Date

End Date

Use start date to track pad use.

Battery Input: 3V --- 2 x CR2477



Made in China

Sensor Pad and Monitor Instructions

Select Pad Setting:

- 1 Open the pocket to access the 3-way switch on the transmitter module. The default position is OFF
- 2 "TX-only" will activate Early-alert function only on the transmitter side of the sensor pad. Alarm goes off when a patient is sitting on the "TX" side edge of the sensor pad and about to leave their bed. The other side remains in a normal setting. Alarm goes off when the patient leaves their bed.

"Both-sides" will enable Early-Alert function on both sides of the sensor pad.

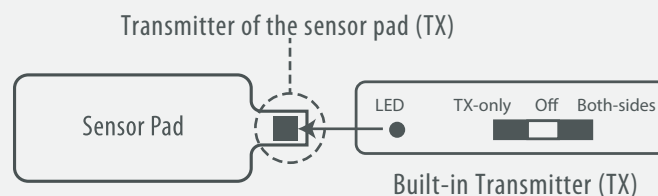

Pad with Monitor:

- 1 Press the "Program" button on the wireless monitor unit – you will hear a beeping from the monitor
(NOTE: for CordFree monitor press Program + Reset)
- 2 Press and release the centre zone of sensor pad to add it into memory. You will see a visual and audible feedback from the monitor to confirm the signal was received
- 3 Test that the sensor pad is working by pressing and releasing

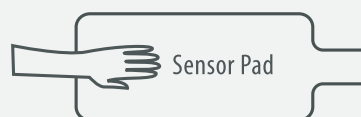

Secure the Pad:

- 1 Position the sensor pad across the bed beneath the hips of the patient. The neck of the sensor pad should exit out the side of the bed.
- 2 Optional clip sets are available to prevent pad movement. They loop through the eyelets as shown below
- 3 They can be clipped to the bed from to hold the sensor pad in place.

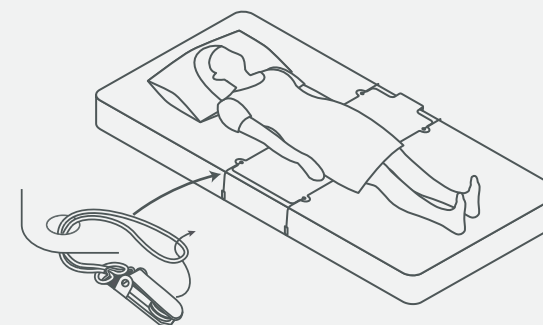

Care & Maintenance Instructions:

- Use disinfectant wipes or antibacterial cleansers to clean the pad
- **DO NOT** immerse the sensor pad in any liquid
- **DO NOT** expose the sensor pad to high temperature sanitizers

Storage:

- Always keep the sensor pad flat when in storage
- Operating temperature: 10°C ~ 40°C (50°F ~ 104°F)
- Storage temperature: 0°C ~ 50°C (32°F ~ 122°F)