

机密文件

CONFIDENTIAL DOCUMENTS

SKYWORTH
创维

- | | |
|--------------------------|--|
| 料号(Part No.): | 0750-HP45LCPK-06 |
| 展开尺寸(Unfolding Size): | 320*280 mm |
| 成品尺寸(Folded Size): | 160*140mm |
| 印刷颜色(Print Color): | <input checked="" type="checkbox"/> 黑色(Black) <input type="checkbox"/> 四色印刷(4-Color Print) |
| 材质(Material): | <input checked="" type="checkbox"/> 80g书纸(80g Writing paper)
<input type="checkbox"/> 105g双铜(105g Coated paper) |
| 表面处理(Surface finishing): | <input type="checkbox"/> 光油(Gloss Varnish) <input type="checkbox"/> 哑油(Matt Varnish) |

厂家/Manufacturer: Jiahui/Voion/Fuweizhi 设计/Designer: leiping 认证加签/Certification Audit: 审核/Audit:



物料通过RoHS环保要求



物料通过Reach环保要求

技术要求(NOTES):

- 公差(Tolerance): $\pm 2\text{mm}$
- 原材料及后处理工艺均能满足ROHS和WEEE的要求。
(Raw materials and the corresponding post processing should meet requirements defined in the ROHS and WEEE.)

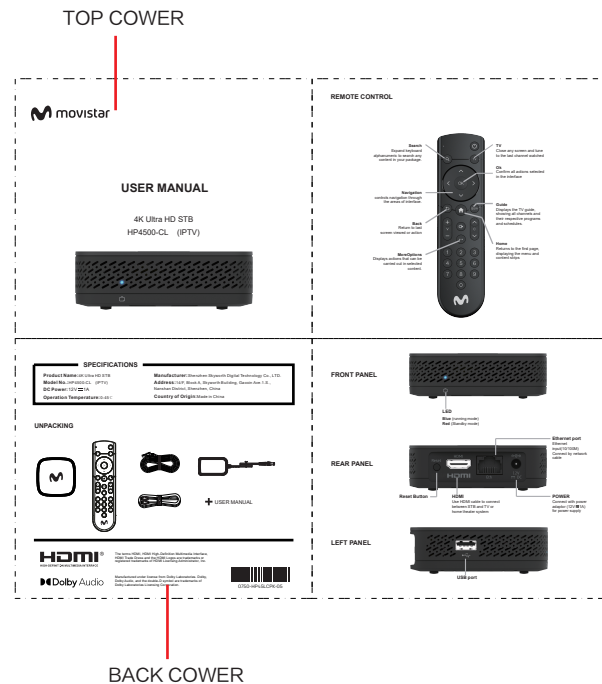



USER MANUAL

4K Ultra HD STB
HP4500-CL (IPTV)

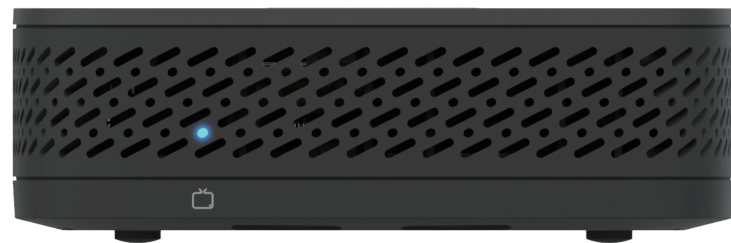

REMOTE CONTROL

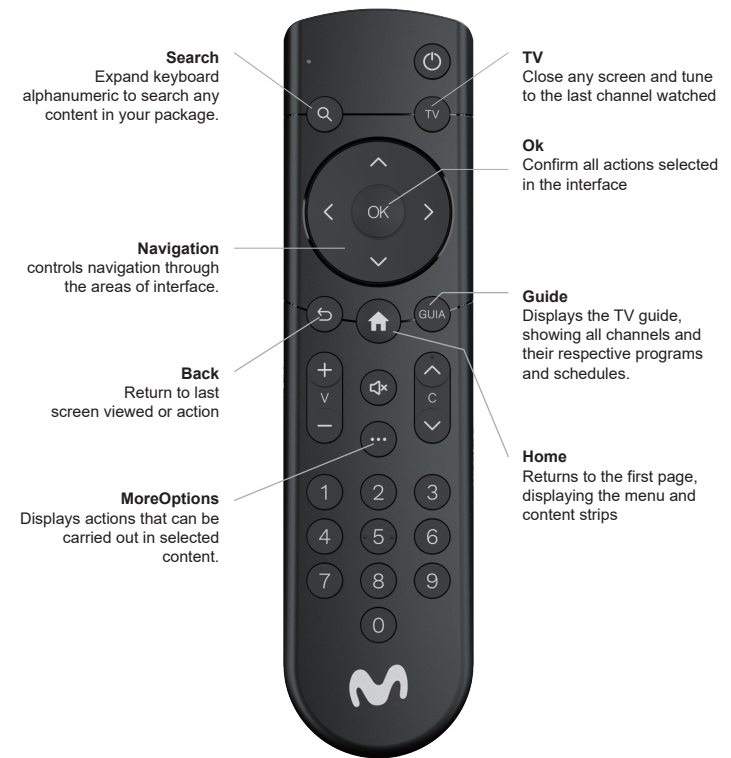

SPECIFICATIONS

Product Name: 4K Ultra HD STB	Manufacturer: Shenzhen Skyworth Digital Technology Co., LTD.
Model No.: HP4500-CL (IPTV)	Address: 14/F, Block A, Skyworth Building, Gaoxin Ave.1 S., Nanshan District, Shenzhen, China
DC Power: 12V 1A	Country of Origin: Made in China
Operation Temperature: 0-45 C	

UNPACKING

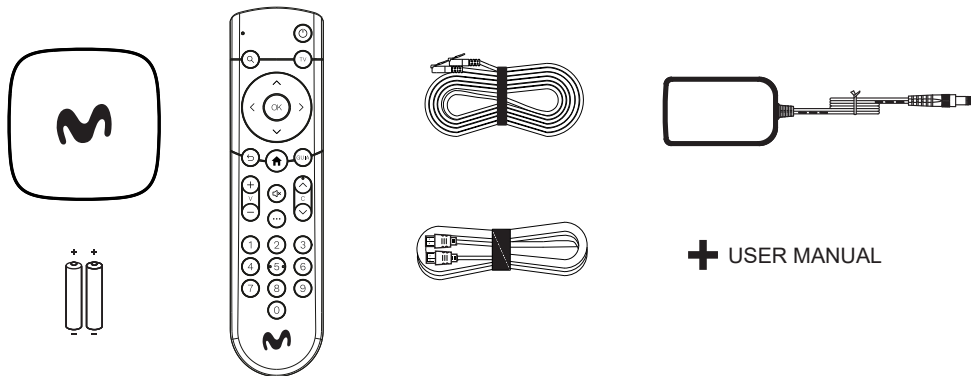

FRONT PANEL

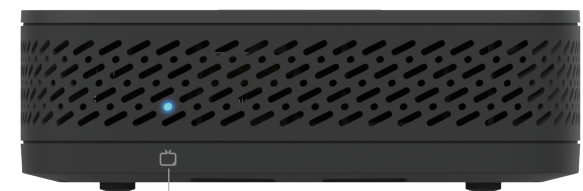

LED
Blue (running mode)
Red (Standby mode)

REAR PANEL

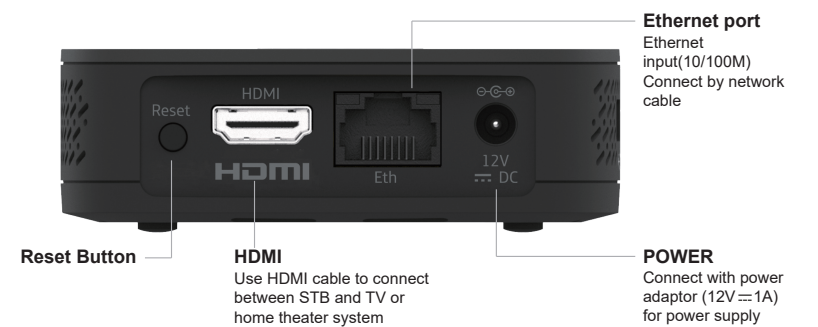

Reset Button

HDMI
Use HDMI cable to connect between STB and TV or home theater system

Ethernet port
Ethernet input(10/100M)
Connect by network cable

POWER
Connect with power adaptor (12V 1A) for power supply

LEFT PANEL

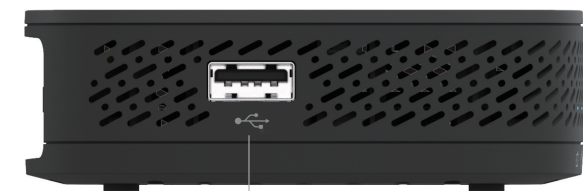

USB port



The terms HDMI, HDMI High-Definition Multimedia Interface, HDMI Trade Dress and the HDMI Logos are trademarks or registered trademarks of HDMI Licensing Administrator, Inc.



Manufactured under license from Dolby Laboratories. Dolby, Dolby Audio, and the double-D symbol are trademarks of Dolby Laboratories Licensing Corporation.



0750-HP45LCPK-06

CONNECTION INSTRUCTION



- Power on STB and TV set.
- Select correct HDMI input on TV.

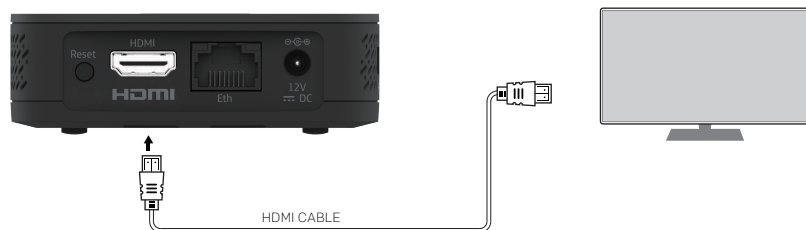

- Connect STB with router by Ethernet cable
- Make sure internet is available

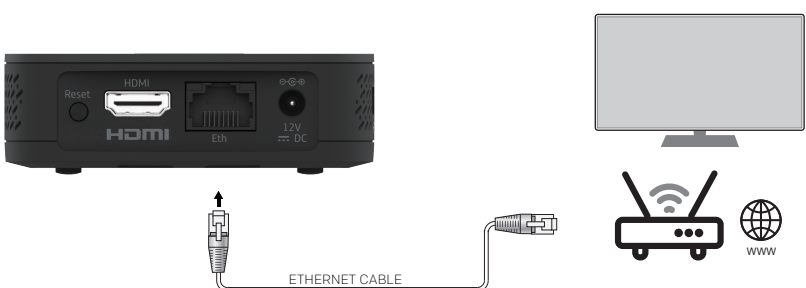

- Taking remote control for operation



SAFETY INSTRUCTION

Storage

Your device has been carefully checked and packed before shipping. When unpacking it, make sure that all the parts are included and keep the packaging away from children. We recommend that you keep the carton during the warranty period, to keep your device perfectly protected in the event of repair or warranty.

Software Description

This product includes a software that is restricted to be modified by a third party. The manufacture reserves the right to publish software updates for maintenance or introducing new features.

Operating Environment

Do not install this equipment in a confined space such as a bookcase or similar unit. Do not use the set near damp, and cold areas, protect the set from overheating. Keep away from direct sunlight. Do not use the set near dust place. Do not place candles near the opening area, to avoid flammable foreign material from entering the device.

WARNING

Only use attachments/accessories specified or provided by the manufacturer (such as Any other adapter may cause damage to the device. Such damage is not covered under warranty. Please refer to the information on the product enclosure for electrical and safety information before installing or operating the apparatus. To reduce the risk of fire or electric shock, do not expose this apparatus to rain or moisture. The apparatus shall not be exposed to dripping or splashing and that objects filled with liquids, such as vases, shall not be placed on apparatus. The ventilation should not be impeded by covering the ventilation openings with items, such as newspaper, table-cloths, curtains, etc. The batteries (battery pack or batteries installed) shall not be exposed to excessive heat such as sunshine, fire or the like. The mains plug/appliance coupler/direct plug-in adapter is used as disconnect device, the disconnect device shall remain readily operable.

CAUTION

Danger of explosion if battery is incorrectly replaced. Replace only with the same or equivalent type. Risk of explosion if the battery is replaced by an incorrect type. Disposal of a battery into fire or a hot oven, or mechanically crushing or cutting of a battery, that can result in an explosion; Leaving a battery in an extremely high temperature surrounding environment that can result in an explosion or the leakage of flammable liquid or gas; A battery subjected to extremely low air pressure that may result in an explosion or the leakage of flammable liquid or gas.



This equipment is a Class II or double insulated electrical appliance. It has been designed in such a way that it does not require a safety connection to electrical earth. For the terminals marked with symbol of " ⚡ " may be of sufficient magnitude to constitute a risk of electric shock. The external wiring connected to the terminals requires installation by an instructed person or the used of ready-made leads or cords.



CAUTION
RISK OF ELECTRIC SHOCK
DO NOT OPEN



Arrowhead symbol within an equilateral triangle is intended to alert the user to the presence of non-insulated "dangerous voltage" within the product's enclosure that may be of sufficient magnitude to constitute a risk of electric shock. Warning: To reduce the risk of electric shock, do not remove cover (or back) as there are no user-serviceable parts inside. Refer servicing to qualified personnel. The exclamation point within an equilateral triangle is intended to alert the user to do not remove cover (or back) as there are no user-serviceable parts inside. Refer servicing to qualified personnel. The exclamation point within an equilateral triangle is intended to alert the user to the presence of important operating and maintenance instructions in the literature accompanying the appliance.

WEEE Directive

Correct Disposal of this product. This marking indicates that this product should not be disposed with other household wastes throughout the EU. To prevent possible harm to the environment or human health from uncontrolled waste the sustainable reuse of material resources. To return your used device, please use the return and collection systems or contact the retailer where the product was purchased. They can take this product for environmentally safe recycling.

FCC compliance statement

This device complies with Part 15 of the FCC Rules. Operation is subject to the following two conditions: (1) this device may not cause harmful interference, and (2) this device must accept any interference received, including interference that may cause undesired operation.

changes or modifications not expressly approved by the party responsible for compliance could void the user's authority to operate the equipment.

This equipment has been tested and found to comply with the limits for a Class B digital device, pursuant to Part 15 of the FCC Rules. These limits are designed to provide reasonable protection against harmful interference in a residential installation. This equipment generates, uses and can radiate radio frequency energy and, if not installed and used in accordance with the instructions, may cause harmful interference to radio communications. However, there is no guarantee that interference will not occur in a particular installation.

If this equipment does cause harmful interference to radio or television reception, which can be determined by turning the equipment off and on, the user is encouraged to try to correct the interference by one or more of the following measures:

- Reorient or relocate the receiving antenna.
- Increase the separation between the equipment and receiver.
- Connect the equipment into an outlet on a circuit different from that to which the receiver is connected.
- Consult the dealer or an experienced radio/TV technician for help.

Radiation Exposure statement

This equipment complies with FCC radiation exposure limits set forth for an uncontrolled environment. This equipment should be installed and operated with minimum distance 20 cm between the radiator and your body.