

Document title Door transmitter CC rating artwork 433MHz NAM				Document no. BE1411_113REP	Revision 002
Issued by Anders Hermansson	Date 2015-06-01	Approved by: Anders Hermansson	Date: 2015-06-01	Info class: Confidential	

REVISION	DATE	PARAGRAPHS CHANGED	SIGN.
001	2015-02-27	Document released	CONAHE
001	2015-06-01	Rating artwork	CONAHE

1 Introduction

1.1 Scope and application

The scope of this document is the rating artwork for 433MHz NAM Door transmitter (BE1411). The intended audience for this document is certification.

2 Rating artwork

The information shown in Figure 1 below is printed on the back of the device on the location shown in Figure 2.

WEEE symbol size: 5.63 mm x 7.78 mm
 Header text size: 8.75 pt
 Text body size: 5.5 pt

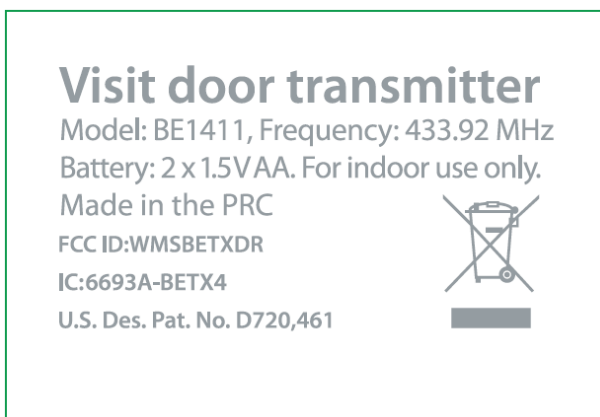

Figure 1 Rating artwork

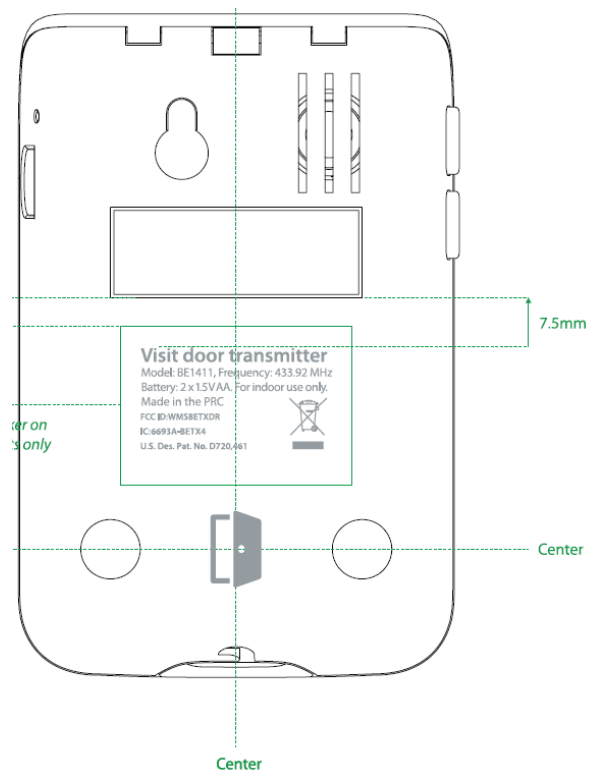

Figure 2 Placement of rating artwork

Note: Green not printed



Figure 3 Logo on front of the device