

polk

# SR2 Wireless Surrounds

Quick Start Guide

Thank you for your Polk purchase. If you have a question or comment, feel free to call or email us.

## Technical Assistance

In North America, call Polk Customer Service at 800-377-POLK(7655) (M-F 9:00 a.m.-5:30 p.m. EST)

Outside the US, call +1-410-358-3600

Email: [polkcs@polkaudio.com](mailto:polkcs@polkaudio.com)

Polk Audio, LLC  
5541 Fermi Court  
Carlsbad, CA 92008  
U.S.A.

The Polk SR2 surround speakers are compatible with several Polk sound bars.  
Please visit the [Polk website](#) for a list of all compatible sound bar models.

Polk Audio is a DEI Holdings, Inc. Company. Polk Audio and Polk, are registered trademarks of Polk Audio, LLC.  
All other trademarks, product names, logos, and brands referenced herein are the property of their respective owners.

# Graphics FPO

## What's in the Box

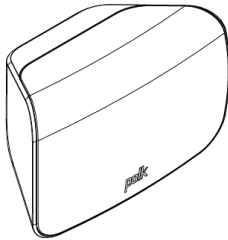

Left surround Speaker

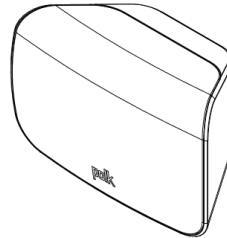

Right surround Speaker

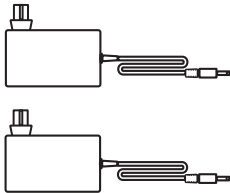

(2) Power supplies

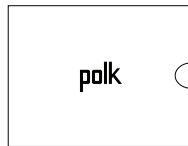

Product Literature



Wall-mount template

## Position your surround speakers

1. Place the surround speakers on the left and right sides and equidistant from the main listening position.
2. Make sure you place the speaker marked "LEFT" on the left and the speaker marked "RIGHT" on the right.
3. Plug the power supply into the speaker and then into a power outlet.

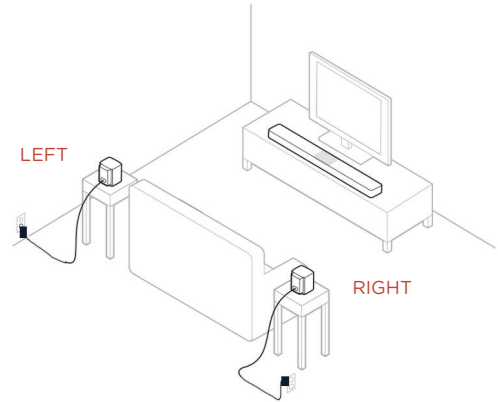

Note: If you want to mount the surrounds on your wall, please refer to the wall mounting template for instructions.

# Graphics FPO

## Connect to a Polk React or Polk Magnifi 2 sound bar

### Enter pairing mode on the sound bar.

1. Press and hold the CONNECT button on the back of the sound bar until the lights above the CONNECT button are blinking green (about 3 seconds).

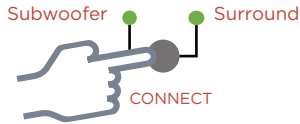

### Connect the surround speakers

2. Press and hold the CONNECT button on the back of the speaker. The light on the bottom changes from solid amber to blinking green (about 3 seconds).
3. Release the button when you hear a tone from the sound bar.

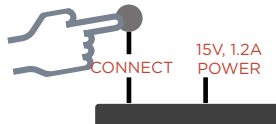

4. Repeat steps 2 and 3 for the other surround speaker.

# Graphics FPO

## Connect to a Polk React Fire TV Edition sound bar

### Enter pairing mode on the sound bar

1. Go to the Settings/Sound menu using the on-screen Fire TV menus.
2. Select "Sub & Surrounds".
3. Select "Connect" to enter pairing mode on the sound bar.



### Connect the surround speakers

4. Press and hold the CONNECT button on the back of the speaker. The light on the bottom changes from solid amber to blinking green (about 3 seconds) as it searches for a sound bar to connect to.
5. Release the button when you hear a tone from the sound bar. The light on the bottom will change to solid green when connected.

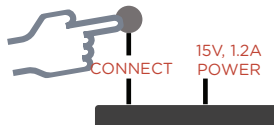

Repeat steps 4 and 5 for the other surround speaker.

## Troubleshooting

### I don't hear sound from my surround speakers.

If the light on the bottom of the surround speaker is:

- **Off**, verify that the power supply is connected to the speaker and to a working power outlet.
- **Amber**, make sure your sound bar is turned on, and connect the speaker to the sound bar using the instructions on the previous page.
- **Green**, turn up the surround volume using the remote control.

### My sound bar does not have a CONNECT button on the back.

Follow the on-screen instructions under the Settings/Sound menu to connect your SR2 surround speakers to your sound bar.

For more troubleshooting and information, please visit [polkaudio.com/support](https://polkaudio.com/support).

# polk

5541 Fermi Court  
Carlsbad, CA 92008  
U.S.A.

800-377-7655  
[www.polkaudio.com](http://www.polkaudio.com)

EU Importer:  
D&M Europe B.V.  
Beemdstraat 11, 5653 MA  
Eindhoven, The Netherlands



72-FTVSR2-QSGB1

HBP4476