

# User Manual

## aptX Low Latency Multipoint Bluetooth Transmitter Priva

[www.avantree.com](http://www.avantree.com)

### 1. Features

Avantree Priva is a Bluetooth audio transmitter incorporating the latest "aptX Low Latency" technology, for high quality audio streaming with virtually no delay. With multipoint receiver support, Priva allows you to share the fun and enjoyment of music with others.

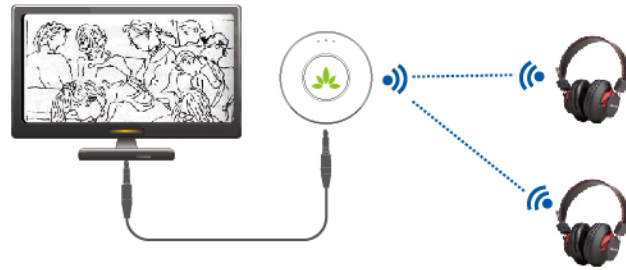

- 1 -

### 2. Overview

- ①. LED indicator Indicates Priva status. (Tips: Check page 9 for status details.)
- ②. Multi-Function Button (MFB) Pairing / Wake up / Connect
- ③. Micro USB charging socket
- ④. 3.5mm audio jack Incorporates power On/Off control
- ⑤. Battery / DC switch
- ⑥. Magnetic base

#### What's in the box:

- A. Avantree Priva
- B. Magnetic base
- C. 3.5mm audio cable
- D. RCA audio cable
- E. Micro USB charging cable
- F. User manual
- G. Quick start guide
- H. Warranty card

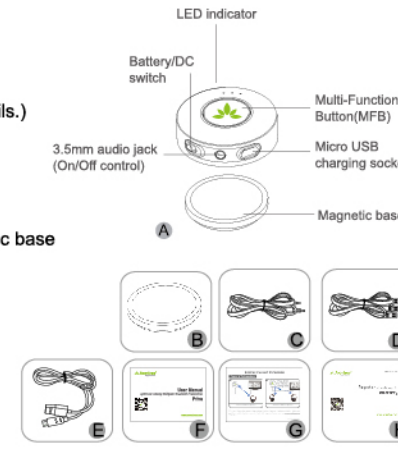

- 2 -

### 3. Charging

Avantree Priva comes with a built-in rechargeable battery.

- It can be used in two different ways –
1. Battery mode - Switch to battery mode for use as a portable device.
  2. DC mode - Switch to DC mode and connect to a DC power source for powered use to save using the internal battery.

In battery mode, users are advised to fully charge the battery before starting. This normally takes 3 hours. Switch to BATTERY MODE before charging.

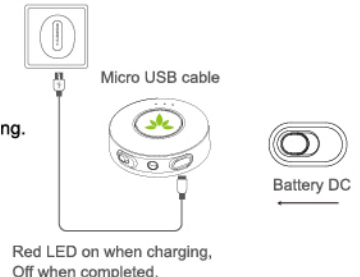

- 3 -

### 4. Getting Started

#### 4.1 Power On/Off

- When using with a power source (either in battery mode or DC mode), the 3.5mm audio cable gives the on/off signal to the device. Plug it to Priva to turn the device on and unplug it to turn the device off.

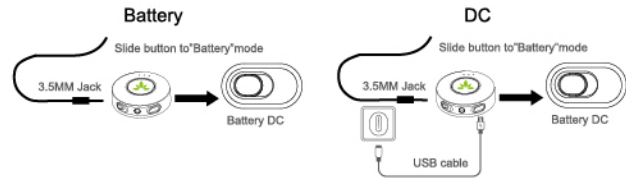

Once powered on, Priva will automatically search for the last paired device.

- If found, then it will connect.
- If not found, Priva enters pairing mode (see below)

- 4 -

#### 4.2 Pairing and connect



- Step-1:** Priva will automatically enter pairing mode after power on. (refer to above)  
**Step-2:** Put your headphones/speaker into pairing mode.  
**Step-3:** The two devices will contact and connect. Once connected, the LED indicator will slow down. (Details on Page 9)  
**Step-4:** Connect Priva to the sound source, such as your TV, and enjoy wireless audio streaming.

- 5 -

#### 4.3 Connect to the 2nd device (optional)

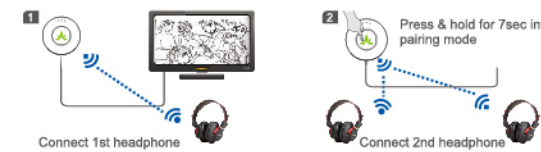

- Step-1:** Connect to your 1st device as above.  
**Step-2:** Press and hold the MFB for 7 seconds. Priva will enter pairing mode again.  
**Step-3:** Enter the 2nd device into pairing mode and wait until they connect.

Notes: When connected to two devices, Priva will be operate in SBC mode only.

- 6 -

### 5. Wake up and reconnect



- Auto off (Sleep mode):** Priva will automatically power off if not connected with any device for 10min.
- Wake up:** Priva can be woken up by pressing and holding MFB for 2s when in sleep mode.
- Auto reconnect:** Once powered up, Priva will auto-reconnect with the last connected device.
- Manual reconnect:** If auto-reconnect does not occur, reconnect can be activated by pressing and holding MFB for 2s

- 7 -

### 6. Restore Factory Default Settings



- Step-1:** Power off Priva.  
**Step-2:** Power on and let Priva enter into pairing mode.  
**Step-3:** Double click the MFB; Priva's BLUE and RED LEDs are both on.  
**Step-4:** Restart Priva.

- 8 -

### 7. LED indications

Status	LED indicator
Power on	Blue LED on for 1sec
Power off	Red LED on for 1sec
Pairing mode	LEDs blink blue and red alternately
Pairing success	Blue LED on for 3sec
Connected with SBC codec	Blue LED flashes once every 5sec
Connected with aptX codec	Blue LED flashes 2 times every 5sec
Connected with aptX-LL codec	Blue LED flashes 3 times every 5sec
Connected with Fast Stream codec	Blue LED flashes 4 times every 5sec
Disconnected	Blue LED flashes once every 10sec
Restored factory default settings	Both blue & red LEDs on for 2sec
Low battery	Red LED flashes twice every sec

- 9 -

### 8. Product Specifications

- Bluetooth 3.0 with EDR
- Bluetooth profile: A2DP
- Audio codec: aptX-LL, aptX, SBC, Fast Stream
- Operating Range: Class 2, 10 meters
- Supports pairing of 2 devices at once
- Play time: up to 8 hours
- Standby time: up to 120 hours
- Battery: 250mAH rechargeable Li-Po battery
- Weight: Body part approx. 23g; Base approx. 7g
- Size: 48mm(L) x 48mm(W) x 15mm(H)

Note:  
Working and standby times may vary when used with different Bluetooth devices, usage settings, usage styles and environments.



- 10 -

## **FCC Statement**

This device complies with part 15 of the FCC Rules. Operation is subject to the following two conditions: (1) This device may not cause harmful interference, and (2) this device must accept any interference received, including interference that may cause undesired operation.

Note: This equipment has been tested and found to comply with the limits for a Class B digital device, pursuant to part 15 of the FCC Rules. These limits are designed to provide reasonable protection against harmful interference in a residential installation. This equipment generates uses and can radiate radio frequency energy and, if not installed and used in accordance with the instructions, may cause harmful interference to radio communications. However, there is no guarantee that interference will not occur in a particular installation. If this equipment does cause harmful interference to radio or television reception, which can be determined by turning the equipment off and on, the user is encouraged to try to correct the interference by one or more of the following measures:

- Reorient or relocate the receiving antenna.
- Increase the separation between the equipment and receiver.
- Connect the equipment into an outlet on a circuit different from that to which the receiver is connected.
- Consult the dealer or an experienced radio/TV technician for help.

Any Changes or modifications not expressly approved by the party responsible for compliance could void the user' s authority to operate the equipment.

## **FCC Radiation Exposure Statement:**

This equipment complies with FCC radiation exposure limits set forth for an uncontrolled environment. This transmitter must not be co-located or operating in conjunction with any other antenna or transmitter.

## **IC RSS warning**

This device complies with Industry Canada licence-exempt RSS standard (s). Operation is subject to the following two conditions: (1) this device may not cause interference, and (2) this device must accept any interference,including interference that may cause undesired operation of the device.

Le présent appareil est conforme aux CNR d'Industrie Canada applicables aux appareils radio exempts de licence. L'exploitation est autorisée aux deux conditions suivantes:

- (1) l'appareil ne doit pas produire de brouillage, et
- (2) l'utilisateur de l'appareil doit accepter tout brouillage radioélectrique subi, même si le brouillage est susceptible d'en compromettre le fonctionnement.

## **IC Radiation Exposure Statement:**

This equipment complies with IC RF radiation exposure limits set forth for an uncontrolled environment. This transmitter must not be co-located or operating in conjunction with any other antenna or transmitter.

Any Changes or modifications not expressly approved by the party responsible for compliance could void the user' s authority to operate the equipment.